

**CITY OF SACRAMENTO**  
1231 I Street, Sacramento, CA 95814

**Permit No: 0106286**  
**Insp Area: 2**

**Site Address: 5550 JACINTO AV SAC**  
Parcel No: ARLINGTON PARK CREEKSIDE PHASE 3 LOT  
N

**Sub-Type: NSFR**  
**Housing (Y/N):**

CONTRACTOR  
LAJ CONSTRUCTION  
8603 MARBORO CT  
STOCKTON CA 95210

OWNER

ARCHITECT

**Nature of Work: MP 2002 2 STORY 9 ROOM SFR**

**CONSTRUCTION LENDING AGENCY:** I hereby affirm under penalty of perjury that there is a construction lending agency for the performance of the work for which this permit is issued (Sec. 3097, Civ. C.).

Lender's Name Grandia Capital Lender's Address \_\_\_\_\_

**LICENSED CONTRACTORS DECLARATION:** I hereby affirm under penalty of perjury that I am licensed under provisions of Chapter 9 (commencing with section 7000) of Division 3 of the Business and Professions Code and my license is in full force and effect.

License Class B License Number 577113 Date 5/22/01 Contractor Signature \_\_\_\_\_

**OWNER-BUILDER DECLARATION:** I hereby affirm under penalty of perjury that I am exempt from the contractors License Law for the following reason (Sec. 7031.5, Business and Professions Code, any city or county which requires a permit to construct, alter, improve, demolish, or repair any structure, prior to its issuance, also requires the applicant for such permit to file a signed statement that he or she is licensed pursuant to the provisions of the Contractors License Law (Chapter 9 (commencing with Section 7000) of Division 8 of the Business and Professions Code) or that he or she is exempt therefrom and the basis for the alleged exemption. Any violation of Section 7031.5 by any applicant for a permit subjects the applicant to a civil penalty of not more than five hundred dollars (\$500.00)

\_\_\_\_ I, as a owner of the property, or my employees with wages as their sole compensation, will do the work, and the structure is not intended or offered for sale (Sec. 7044, Business and Professional Code: The Contractors License Law does not apply to an owner of property who builds or improves thereon, and who does such work himself or herself or through his/her own employees, provided that such improvements are not intended or offered for sale. If, however, the building or improvement is sold within one year of completion, the owner-builder will have the burden of proving that he/she did not build or improve for the purpose of sale.)

I, as owner of the property, am exclusively contracting with licensed contractors to construct the project (Sec. 7044, Business and Professions Code). The Contractors License Law does not apply to an owner of property who builds or improves thereon, and who contracts for such projects with a contractor(s) licensed pursuant to the Contractors License Law)

\_\_\_\_ I am exempt under Sec. \_\_\_\_\_ B & PC for this reason: \_\_\_\_\_  
Date 5/22/01 Owner Signature Carolina Sharma

**IN ISSUING THIS BUILDING PERMIT,** the applicant represents, and the city relies on the representation of the applicant, that the applicant verified all measurements and locations shown on the application or accompanying drawings and that the improvement to be constructed does not violate any law or private agreement relating to permissible or prohibited locations for such improvements. This building permit does not authorize any illegal location of any improvement or the violation of any private agreement relating to location of improvements.

I certify that I have read this application and state that all information is correct. I agree to comply with all city and county ordinances and state laws relating to building construction and hereby authorize representative(s) of this city to enter upon the abovementioned property for inspection purposes.

Date 5/22/01 Applicant/Agent Signature Carolina Sharma

**WORKER'S COMPENSATION DECLARATION:** I hereby affirm under penalty of perjury one of the following declarations:  
\_\_\_\_ I have and will maintain a certificate of consent to self-insure for workers' compensation as provided for by Section 3700 of the Labor Code, for the performance of work for which the permit is issued

\_\_\_\_ I have and will maintain workers' compensation insurance, as required by Section 3700 of the Labor Code, for the performance of the work for which this permit is issued. My workers' compensation insurance carrier and policy number are:

Carrier \_\_\_\_\_ Policy Number \_\_\_\_\_ Exp Date \_\_\_\_\_

\_\_\_\_ (This section need not be completed if the permit is for \$100 or less) I certify that in the event that I should become subject to the workers' compensation laws of California and agree that if I should become subject to the workers' compensation provisions of Section 3700 of the Labor Code, I shall forthwith comply with those provisions.

Date 5/22/01 Applicant Signature Carolina Sharma

WARNING: FAILURE TO SECURE WORKER'S COMPENSATION COVERAGE IS UNLAWFUL AND SUBJECTS EMPLOYER TO CRIMINAL PENALTIES AND CIVIL FINES UP TO ONE HUNDRED THOUSAND DOLLARS (\$100,000) IN ADDITION TO THE COST OF COMPENSATION DAMAGES AS PROVIDED FOR IN SECTION 3706 OF THE LABOR CODE, INTEREST AND ATTORNEY FEES.

**THIS PERMIT SHALL EXPIRE BY LIMITATION IF WORK IS NOT COMMENCED WITHIN 180 DAYS.**

COUNTY SANITATION DISTRICT NO. 1  
 SACRAMENTO REGIONAL COUNTY SANITATION DISTRICT

**SEWER IMPACT FEE**  
 PERMIT AND CALCULATION SHEET

APPLICATION NO: CITY BLDG PERMITS SWD 2001-00174

GENERAL INFORMATION THIS PERMIT GOOD ONLY WHEN VALIDATED BY THE CASHIER

269625 *[Signature]*  
 4/5/01

THIS PERMIT TO CONNECT EXPIRES ONE YEAR FROM DATE OF ISSUANCE

FEE CALCULATION		BUILDING USE	
INSPECTION		RESIDENTIAL	SF <input checked="" type="checkbox"/> MF <input type="checkbox"/>
CSD - 1		COMMERCIAL USE	UNITS
SRCSD	2404		
CONSTRUCTION			
IN-LIEU			
<b>TOTAL FEE</b>	<b>2442</b>		

APN: 117-1880-019

DESCRIPTION / SUBDIVISION Arlington Park Geek side Phase #3 LOT: 19

PROPERTY ADDRESS Jacinto Ave

OWNER LAI Const Inc.

MAILING ADDRESS 8603 Marshall Ct

CITY-STATE-ZIP Stockton Ca PHONE 916 508-8539

ADDITIONAL FEES MAY BE DUE IF CHANGES IN USE INCREASE SEWER IMPACT.

APPLICANT SIGNATURE *[Signature]*

CONSOLIDATED UTILITY BILLING USE ONLY

ACCT \_\_\_\_\_ INPUT \_\_\_\_\_ START \_\_\_\_\_  
 INSPECTOR'S COPY

# Certification of Compliance

## School District Development Fees

(Print or Type) If Printing, press hard for four copies

### PART I To be completed by the APPLICANT

OWNER'S NAME LAD Const Inc  
 OWNER'S ADDRESS 5643 Marshall Court Sacramento Ca  
 PROJECT ADDRESS 5643 Marshall Court Sacramento Ca 95823  
 PARCEL NUMBER 117-1030-019 0000 LOT NO. 19  
 SUBDIVISION NAME Hobbsville Park Creekside Phase 2  
 NUMBER OF UNITS 1

Upon payment of the fees listed below, a 90-day approval period commences upon which the applicant paying the fees may protest such fees. Any failure to file such protest within the 90-day period shall result in forfeiture of any rights to challenge such fees, through litigation or otherwise.

APPLICANT'S SIGNATURE \_\_\_\_\_  
 TITLE OF APPLICANT Proprietor  
 DATE 3/22/01 PHONE NUMBER 916 508-8937

### PART II To be completed by BUILDING DEPARTMENT

PLAN IDENTIFICATION NUMBER 2002  
 BUILDING TYPE  
 RESIDENTIAL (  ) APARTMENT/CONDOMINIUM (  ) COMMERCIAL/INDUSTRIAL (  )  
 SQUARE FEET OF CHARGEABLE BUILDING AREA 1849  
 SIGNATURE \_\_\_\_\_  
 TITLE \_\_\_\_\_ DATE 3-22-01

### PART III To be completed by SCHOOL DISTRICT

SCHOOL DISTRICT 29028  
 DISTRICT CERTIFICATION NO. 29028  
 EXEMPT \_\_\_\_\_ COMMENTS \_\_\_\_\_

RESIDENTIAL/APT/CONDO	SQ FT	X \$	= \$
<u>1849</u>	<u>2.15</u>	<u>145</u>	<u>3,172.45</u>
<u>1849</u>	<u>1.31</u>	<u>187</u>	<u>2,474.57</u>
OTHER FEE TYPE	SQ FT	X \$	= \$
<b>TOTAL FEES COLLECTED</b>	<u>3.36</u>		<u>6,347.01</u>

This Certification covers only the amount of square footage indicated above. Any additions or corrections to the square footage for this project will require an amendment to the Certificate of Compliance.

As the authorized school district official, I hereby certify that the requirements of Government Code Section 65995 and any other authorized requirements have been complied with by the above signed applicant.

### AUTHORIZED SCHOOL DISTRICT OFFICIAL

SIGNATURE \_\_\_\_\_  
 TITLE \_\_\_\_\_ DATE 3/22/01

Original: School District    1st copy: School District    2nd copy: Building Department    3rd copy: Applicant

CRB 16, 110, 36

INSULATION CERTIFICATE

THIS IS TO CERTIFY THAT INSULATION HAS BEEN INSTALLED IN CONFORMANCE WITH THE CURRENT ENERGY REGULATIONS, CALIFORNIA ADMINISTRATION CODE, TITLE 24, STATE OF CALIFORNIA, IN THE BUILDING LOCATED AT:

SITE ADDRESS: LOT 19 ARLINGTON PARK ELK GROVE, CA  
STREET CITY STATE

CEILINGS:

BLOW: MANUFACTURER GREENSTONE THICKNESS 10.3" R/VALUE 38  
SQUARE FEET 870 # BAGS/LBS PER BAGS 30

BATTS: MANUFACTURER JOHNS MANVILLE THICKNESS 13" R-VALUE 38  
JOHNS MANVILLE 10.25" 30

EXTERIOR WALLS:

MANUFACTURER JOHNS MANVILLE THICKNESS 3.5" R/VALUE 13  
JOHNS MANVILLE

FLOOR INSULATION:

MANUFACTURER JOHNS MANVILLE THICKNESS 6.5" R/VALUE 19

AIR INFILTRATION: (TITLE 24)  
YES XX NO       

OTHER: \_\_\_\_\_

GENERAL CONTRACTOR: LAJ CONSTRUCTION LICENSE # \_\_\_\_\_

BY: \_\_\_\_\_ TITLE \_\_\_\_\_ DATE \_\_\_\_\_

INSULATION CONTRACTOR: WESTERN INSULATION LP LICENSE # 794484

BY: Jamie Blair TITLE AUTH. AGENT DATE 10/17/01  
JAMIE BLAIR

# OMEGA PRODUCTS INTERNATIONAL, INC.

DIAMOND WALL INSULATING STUCCO SYSTEM

JOB ADDRESS: Lot 19  
5550 Quinto Ave.  
Sacramento, CA 95823

ICBO Report #4004

Date of Job Completion 10/17/2001

## PLASTERING CONTRACTOR:

Name: Finest Kind plastering  
Address: 25262 Nutterfield Rd Acampo Ca 95220  
Telephone No: 209 518 7518  
Contractor Number of Diamond Wall System 2413

This is to certify that the exterior coating system on the building exterior at the above address has been installed in accordance with the evaluation report specified above and the manufacturer's instructions.

Date 10/17/2001

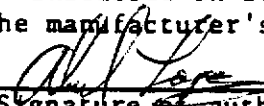
  
Signature of authorized representative of  
Plastering Contractor

This installation card must be presented to the building inspector after completion of work and before final inspection.

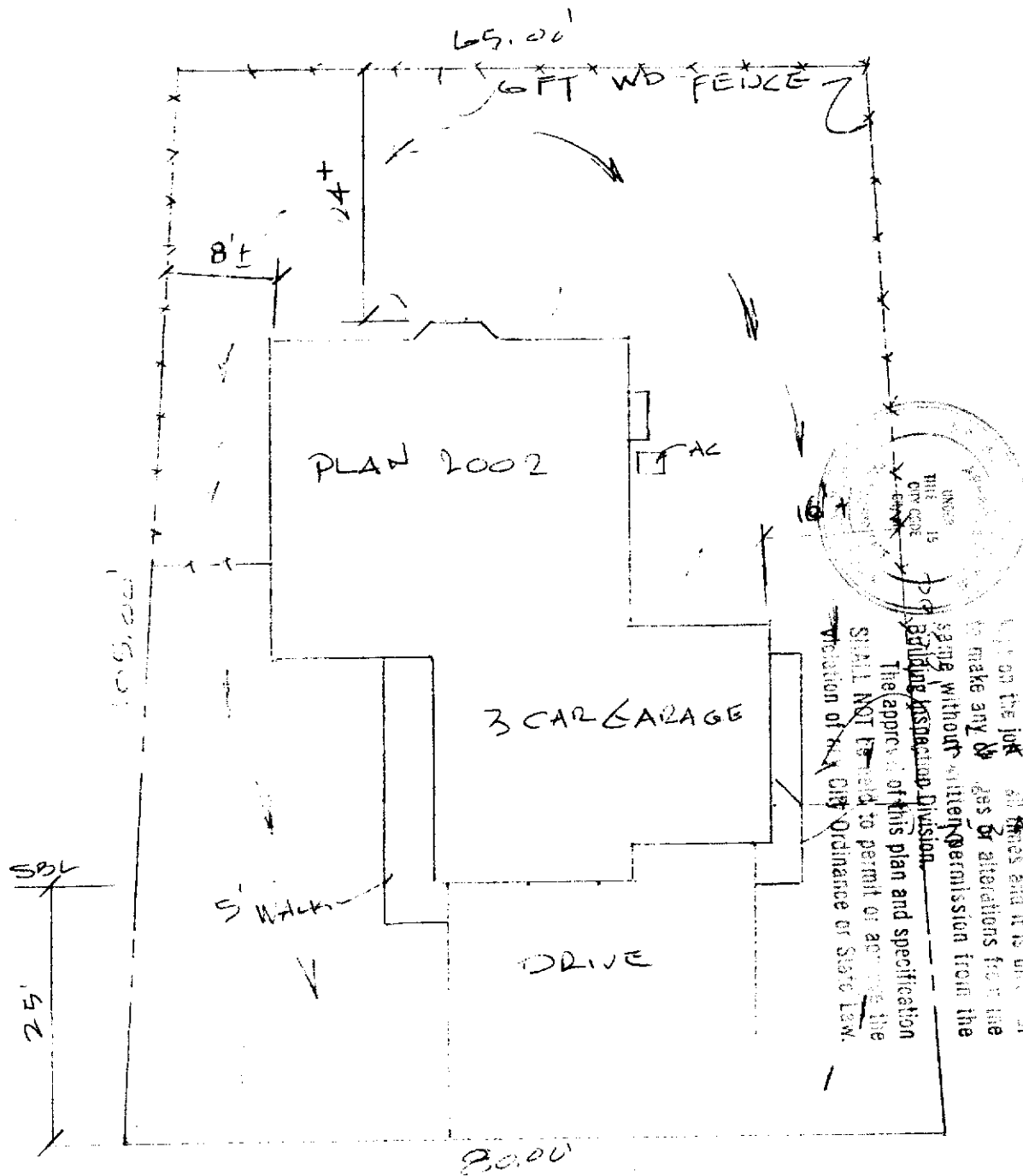

This set of ~~plans~~ specifications must be  
 approved by the City Engineer and it is understood  
 that the contractor shall be responsible for  
 making any changes or alterations for the  
 same without the written permission from the  
 Building Inspection Division.  
 The approval of this plan and specification  
 shall NOT be held to permit or approve the  
 violation of any City Ordinance or State Law.

JACINTO AVENUE

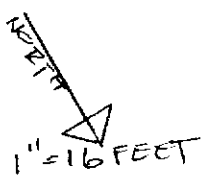

LAJ CONSTRUCTION, INC	PLOT PLAN LOT-19 - JACINTO AVE ARLINGTON PARK - CREEKSIDE SACRAMENTO, CA
-----------------------	---