

CITY OF SACRAMENTO
1231 I Street, Sacramento, CA 95814

Permit No: 0317451
Insp Area: 4
Thos Bros:
Sub-Type: NSFR
Housing (Y/N): N

Site Address: 3053 MUSKRAT WY SAC
Parcel No: 225-1950-001 PARKVIEW UNIT 5 LOT 1

CONTRACTOR
KIMBALL HILL HOMES
10535 EAST STOCKTON BL. STE. K
ELK GROVE CA. 95624

OWNER

ARCHITECT

Nature of Work: MP 1705 1 STORY 6 ROOM SFR

CONSTRUCTION LENDING AGENCY : I hereby affirm under penalty of perjury that there is a construction lending agency for the performance of the work for which this permit is issued (Sec. 3097, Civ. C).

Lender's Name _____ Lender's Address _____

LICENSED CONTRACTORS DECLARATION: I hereby affirm under penalty of perjury that I am licensed under provisions of Chapter 9 (commencing with section 7000) of Division 3 of the Business and Professions Code and my license is in full force and effect.

License Class B License Number 701803 Date 11/17/03 Contractor Signature R Kas

OWNER-BUILDER DECLARATION: I hereby affirm under penalty of perjury that I am exempt from the contractors License Law for the following reason (Sec. 7031.5, Business and Professions Code; any city or county which requires a permit to construct, alter, improve, demolish, or repair any structure, prior to its issuance, also requires the applicant for such permit to file a signed statement that he or she is licensed pursuant to the provisions of the Contractors License Law (Chapter 9 (commencing with Section 7000) of Division 8 of the Business and Professions Code) or that he or she is exempt therefrom and the basis for the alleged exemption. Any violation of Section 7031.5 by any applicant for a permit subjects the applicant to a civil penalty of not more than five hundred dollars (\$500.00);

____ I, as a owner of the property, or my employees with wages as their sole compensation, will do the work, and the structure is not intended or offered for sale (Sec. 7044, Business and Professional Code: The Contractors License Law does not apply to an owner of property who builds or improves thereon, and who does such work himself or herself or through his/her own employees, provided that such improvements are not intended or offered for sale. If, however, the building or improvement is sold within one year of completion, the owner-builder will have the burden of proving that he/she did not build or improve for the purpose of sale.)

____ I, as owner of the property, am exclusively contracting with licensed contractors to construct the project (Sec. 7044, Business and Professions Code: The Contractors License Law does not apply to an owner of property who builds or improves thereon, and who contracts for such projects with a contractor(s) licensed pursuant to the Contractors License Law).

____ I am exempt under Sec. _____ B & PC for this reason: _____

Date _____ Owner Signature _____

IN ISSUING THIS BUILDING PERMIT, the applicant represents, and the city relies on the representation of the applicant, that the applicant verified all measurements and locations shown on the application or accompanying drawings and that the improvement to be constructed does not violate any law or private agreement relating to permissible or prohibited locations for such improvements. This building permit does not authorize any illegal location of any improvement or the violation of any private agreement relating to location of improvements.

I certify that I have read this application and state that all information is correct. I agree to comply with all city and county ordinances and state laws relating to building construction and hereby authorize representative(s) of this city to enter upon the above mentioned property for inspection purposes.

Date 11/17/03 Applicant/Agent Signature R Kas

WORKER'S COMPENSATION DECLARATION: I hereby affirm under penalty of perjury one of the following declarations:

____ I have and will maintain a certificate of consent to self-insure for workers' compensation as provided for by Section 3700 of the Labor Code, for the performance of work for which the permit is issued.

R Kas I have and will maintain workers' compensation insurance, as required by Section 3700 of the Labor Code, for the performance of the work for which this permit is issued. My workers' compensation insurance carrier and policy number are:

Carrier TRAVELERS Policy Number WC59663000527 Exp Date 10/01/2004

____ (This section need not be completed if the permit is for \$100 or less) I certify that in the performance of the work for which this permit is issued, I shall not employ any person in any manner so as to become subject to the workers' compensation laws of California and agree that if I should become subject to the workers' compensation provisions of Section 3700 of the Labor Code, I shall forthwith comply with those provisions.

Date 11/17/03 Applicant Signature R Kas

WARNING: FAILURE TO SECURE WORKER'S COMPENSATION COVERAGE IS UNLAWFUL AND SHALL SUBJECT AN EMPLOYER TO CRIMINAL PENALTIES AND CIVIL FINES UP TO ONE HUNDRED THOUSAND DOLLARS (\$100,000) IN ADDITION TO THE COST OF COMPENSATION, DAMAGES AS PROVIDED FOR IN SECTION 3706 OF THE LABOR CODE, INTEREST AND ATTORNEY'S FEE.

THIS PERMIT SHALL EXPIRE BY LIMITATION IF WORK IS NOT COMMENCED WITHIN 180 DAYS.

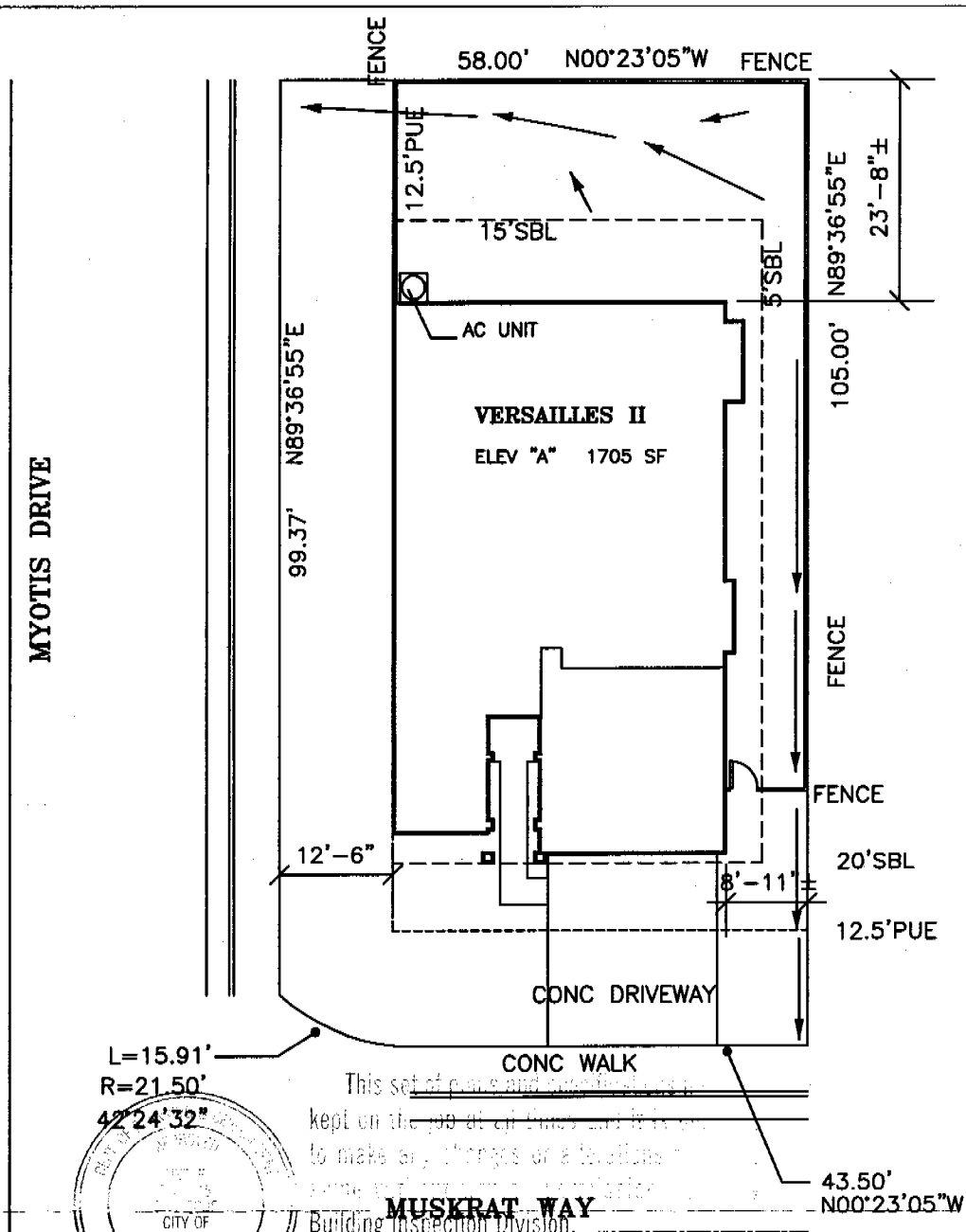

The approval of this plan and specifications SHALL NOT be held to permit or excuse the violation of any City Ordinance or State Law.

6064



BLOOM
Architectural
Developments
Incorporated

4437 Kenneth Avenue
Fair Oaks, CA 95628
(916)961-1553
(916)967-3011 Fax

www.BloomArchitect.com



Plot Plan Disclosure This plot plan approximates a general representation of lot dimensions, easements, fence and home placement, etc. This illustration is not a condition of Kimball Hill Homes sales agreement. The actual placement and measurements demonstrated on this diagram are subject to change without notice.

Signature _____

KHH California, Inc. (916)714-1153
10535 E. Stockton Blvd. Ste. K, Elk Grove, CA 95624

Job#	3075 01	Plan#	1705
Date	Oct 28 03	Draft	2
Plan	VERSAILLES2	Elev	A
Project	Parkview	Unit	5
Lot	01		
Address	3053 Muskrat Way		
City	Sacramento County CA		
APN			

➔

PLOT PLAN
Scale 1"=20'

RESIDENTIAL SUBDIVISION BUILDING PERMIT APPLICATION

Project Address: 3053 Muskrat way Assessor Parcel # 225
Lot Number: 1 Subdivision Parkview Village S

OWNER INFORMATION:

Legal Property Owner: Kimball Hill Homes Phone# 7141153
Owner Address: 10535 E. Stockton Bl City ELY GROVE State CA Zip 95624

CONTRACTOR INFORMATION:

Contractor: Kimball Hill Homes Lic. # 701803 Phone # 7141153 Fax 7141425

PROJECT INFORMATION:

Land Use Zone R1A Occupancy Group R3 Construction Type VN Fed Code 1A

No. of Stories: 1 No. of Rooms: 6 Street Width: _____

1st Floor Area 1705 2nd Floor Area _____ Basement _____ Roof Material _____

AREA IN SQUARE FOOT OF:

Dwelling/Living	<u>1705</u>
Garage/Storage	<u>418</u>
Decks/Balconies	<u>51</u>
Carports	_____

SCOPE OF WORK: NEW SINGLE FAMILY DWELLING

- Information Above Complete
- Violation Files Checked
- Standard Setbacks
- County Sewer
- AR Flood Waiver Required
- Flood Elevation Certificate Required
- Water Development Infill Area
- Planning Approval
- Design Review Approval
- Special Fee Districts Apply:

THE FOLLOWING MUST BE PROVIDED IN ORDER TO SUBMIT FOR PERMIT

- 2 COMPLETE PLOT PLANS, LEGIBLE & DRAWN TO SCALE
- 11 X 17 COPY OF FLOOR PLAN WITH FOLLOWING INFORMATION
 - a) Assessor's Parcel Number
 - b) New Floor Area
 - c) Owners Name
 - d) Project Address

OR
FICE
ISE
NLY

Date: _____ Received by: (staff) _____ Permit # _____



**F. RODGERS INSULATION
RESIDENTIAL, INC.**
THERMAL INSULATION CONTRACTORS
Residential

8754

7775 LAS POSITAS ROAD · LIVERMORE, CA 94551
(925) 294-9400 · FAX (925) 294-9475
1300 S RIVER RD. #125 · W. SACRAMENTO, CA 95691
(916) 386-9400 · FAX (916) 386-9446



STREET K.H.H. LOT # 1 TRACT # 7775-Paradise

CITY SAC.

EXTERIOR WALLS: MANUFACTURER o/c THICKNESS/TYPE o/c VALUE 13 R-

CEILINGS: BATT: MANUFACTURER o/c THICKNESS/TYPE 12 1/2 VALUE 30 R-

BLOWN IN: MANUFACTURER o/c THICKNESS 12 1/2 VALUE 30 R-

MANUFACTURER o/c THICKNESS/TYPE o/c VALUE 22 # R-

FLOORS & OVERHANGS: MANUFACTURER _____ THICKNESS/TYPE _____ VALUE _____ R-

OTHER: MANUFACTURER _____ THICKNESS/TYPE _____ VALUE _____ R-

MANUFACTURER _____ THICKNESS/TYPE _____ VALUE _____ R-

GENERAL CONTRACTOR _____ CALIFORNIA CONTRACTORS LICENSE # _____

DATE _____

SIGNATURE _____ TITLE _____

INSULATION CONTRACTOR F. RODGERS INSULATION RESIDENTIAL
CALIFORNIA CONTRACTORS LICENSE #771285

DATE 2/20/04

SIGNATURE Officer AA TITLE _____

COUNTY SANITATION DISTRICT 1
 SACRAMENTO REGIONAL COUNTY SANITATION DISTRICT

SEWER IMPACT FEE *11-14-03*
 PERMIT AND CALCULATION

APPLICATION NO: *ADD 2003-01024*

GENERAL INFORMATION THIS PERMIT GOOD ONLY WHEN VALIDATED BY THE CASHIER

City of Sacramento PAID 14 Nov 03

THIS PERMIT TO CONNECT EXPIRES ONE YEAR FROM DATE OF ISSUANCE

FEE CALCULATION BUILDING USE

INSPECTION	RESIDENTIAL	SE	MF
ASD-1 <i>1853-B</i>		<input checked="" type="checkbox"/>	
STROSD <i>15255M</i>			
CONSTRUCTION			
IN-LIEU			
TOTAL FEE			<i>1108</i>

APN: *725-1950-001*

DESCRIPTION/SUBDIVISION: *Parkview Village 5* LOT: *1*

PROPERTY ADDRESS: *3053 Muskraat way*

OWNER: *Kimball Will Evans*

MAILING ADDRESS: *10535 E SPETHA Blvd Suite K*

CITY-STATE-ZIP: *EVANSTON CA 95024* PHONE: *714-1153*

ADDITIONAL FEES MAY BE DUE IF CHANGES IN USE INCREASE SEWER IMPACT

APPLICANT SIGNATURE: *Jana Kasa*

CONSOLIDATED UTILITY BILLING USE ONLY

ACCT _____ INPUT _____ START _____

INSTALLATION CARD

OMEGA DIAMOND WALL INSULATING ONE COAT SYSTEM
OMEGA PRODUCTS INTERNATIONAL, INC.

Job Address:

LOT 501

3053 MUSKRAT WAY

SACRAMENTO, CA 95832

ICBO Evaluation Service, Inc.
Report 4004

2 | 16 | 04
Date of Job Completion

Plastering Contractor:

Name: Mid Valley Plastering, Inc.

Address: 4807 S. Airport Way, Unit # D
Stockton, CA 95206-4924

Telephone: (209) 234-2671

Approved Contractor Number as
Issued by the Coating Manufacturer Omega Diamond Wall No. 2315

This is to certify that the exterior system on the building exterior at the above address has been installed in accordance with the evaluation report specified above and the manufacturer's instructions

Jeff Chan
Signature of Plastering Contractor

2 | 18 | 04
Date

This installation card must be presented to the building inspector after completion of work and before final inspection