

CITY OF SACRAMENTO

1231 I Street, Sacramento, CA 95814

Permit No: 0503876

Insp Area: 1

Thos Bros: 297C4

Site Address: 1107 9TH ST SAC

Parcel No: 006-0102-001

Sub-Type: REM

Housing (Y/N): N

CONTRACTOR

BROWNING CONSTRUCTION INC
9050 RANCHVIEW CT
SACRAMENTO CA 95624

OWNER

MARVIN L OATES TRUST/BUZZ OATES DEVEL LP
8615 ELDER CREEK RD
SACRAMENTO, CA 95828

ARCHITECT

Nature of Work: INTERIOR REMODEL

CONSTRUCTION LENDING AGENCY : I hereby affirm under penalty of perjury that there is a construction lending agency for the performance of the work for which this permit is issued (Sec. 3097, Civ. C).

Lender's Name

Lender's Address

LICENSED CONTRACTORS DECLARATION: I hereby affirm under penalty of perjury that I am licensed under provisions of Chapter 9 (commencing with section 7000) of Division 3 of the Business and Professions Code and my license is in full force and effect.

License Class B License Number 461321 Date 6/6/05 Contractor Signature [Signature]

OWNER-BUILDER DECLARATION: I hereby affirm under penalty of perjury that I am exempt from the contractors License Law for the following reason (Sec. 7031.5, Business and Professions Code; any city or county which requires a permit to construct, alter, improve, demolish, or repair any structure, prior to its issuance, also requires the applicant for such permit to file a signed statement that he or she is licensed pursuant to the provisions of the Contractors License Law (Chapter 9 (commencing with Section 7000) of Division 8 of the Business and Professions Code) or that he or she is exempt therefrom and the basis for the alleged exemption. Any violation of Section 7031.5 by any applicant for a permit subjects the applicant to a civil penalty of not more than five hundred dollars (\$500.00);

I, as a owner of the property, or my employees with wages as their sole compensation, will do the work, and the structure is not intended or offered for sale (Sec. 7044, Business and Professional Code: The Contractors License Law does not apply to an owner of property who builds or improves thereon, and who does such work himself or herself or through his/her own employees, provided that such improvements are not intended or offered for sale. If, however, the building or improvement is sold within one year of completion, the owner-builder will have the burden of proving that he/she did not build or improve for the purpose of sale.)

I, as owner of the property, am exclusively contracting with licensed contractors to construct the project (Sec. 7044, Business and Professions Code: The Contractors License Law does not apply to an owner of property who builds or improves thereon, and who contracts for such projects with a contractor(s) licensed pursuant to the Contractors License Law).

I am exempt under Sec. _____ B & PC for this reason: _____

Date _____ Owner Signature _____

PAID
CITY OF SACRAMENTO

IN ISSUING THIS BUILDING PERMIT, the applicant represents, and the city relies on the representation of the applicant that the applicant verified all measurements and locations shown on the application or accompanying drawings and that the improvement to be constructed does not violate any law or private agreement relating to permissible or prohibited locations for such improvements. This building permit does not authorize any illegal location of any improvement or the violation of any private agreement relating to location of improvements.

I certify that I have read this application and state that all information is correct. I agree to comply with all city and county ordinances and state laws relating to building construction and hereby authorize representative(s) of this city to enter upon the abovementioned property for inspection purposes.

Date 6/6/05 Applicant/Agent Signature [Signature]

WORKER'S COMPENSATION DECLARATION: I hereby affirm under penalty of perjury one of the following declarations:

I have and will maintain a certificate of consent to self-insure for workers' compensation as provided for by Section 3700 of the Labor Code, for the performance of work for which the permit is issued.

B I have and will maintain workers' compensation insurance, as required by Section 3700 of the Labor Code, for the performance of the work for which this permit is issued. My workers' compensation insurance carrier and policy number are:

Carrier STATE FUND

Policy Number 713016444-2004

Exp Date 10/01/2005

(This section need not be completed if the permit is for \$100 or less) I certify that in the performance of the work for which this permit is issued, I shall not employ any person in any manner so as to become subject to the workers' compensation laws of California and agree that if I should become subject to the workers' compensation provisions of Section 3700 of the Labor Code, I shall forthwith comply with those provisions.

Date 6/6/05 Applicant Signature [Signature]

WARNING: FAILURE TO SECURE WORKER'S COMPENSATION COVERAGE IS UNLAWFUL AND SHALL SUBJECT AN EMPLOYER TO CRIMINAL PENALTIES AND CIVIL FINES UP TO ONE HUNDRED THOUSAND DOLLARS (\$100,000) IN ADDITION TO THE COST OF COMPENSATION, DAMAGES AS PROVIDED FOR IN SECTION 3706 OF THE LABOR CODE, INTEREST AND ATTORNEY'S FEE.

THIS PERMIT SHALL EXPIRE BY LIMITATION IF WORK IS NOT COMMENCED WITHIN 180 DAYS.



July 25, 2005

Browning Construction
9050 Ranch View Court
Elk Grove, CA 95624

RE: Marilyn's - Tenant Improvement
1107 9th Street, Terrace Level
PC# 0503876

CHANGE ORDER NO. 1

Remove one existing window in 1-Hr wall located between OPEN SPACE 101 and existing 1HR LOBBY. Reference drawing Sheet A2 dtd. 3/17/05, revised 7/25/05 Delta 2, a portion of which is attached hereto.

Clarification for Building Department

Per UBC Section 1004.3.4.3.2.2, the total area of 3/4 Hr fixed glazing assemblies shall be limited to 25% of the area of the wall separating OPEN SPACE 101 from the 1HR LOBBY. Area of the wall is 256 s.f. (32'-0" x 8'-0"). Area of two remaining windows is 48 s.f. (2 windows @ 4'-0" x 6'-0"). Area of windows is 19% of wall area (48 s.f./256 s.f.).



Richard K. Nielsen, Architect, A.I.A.

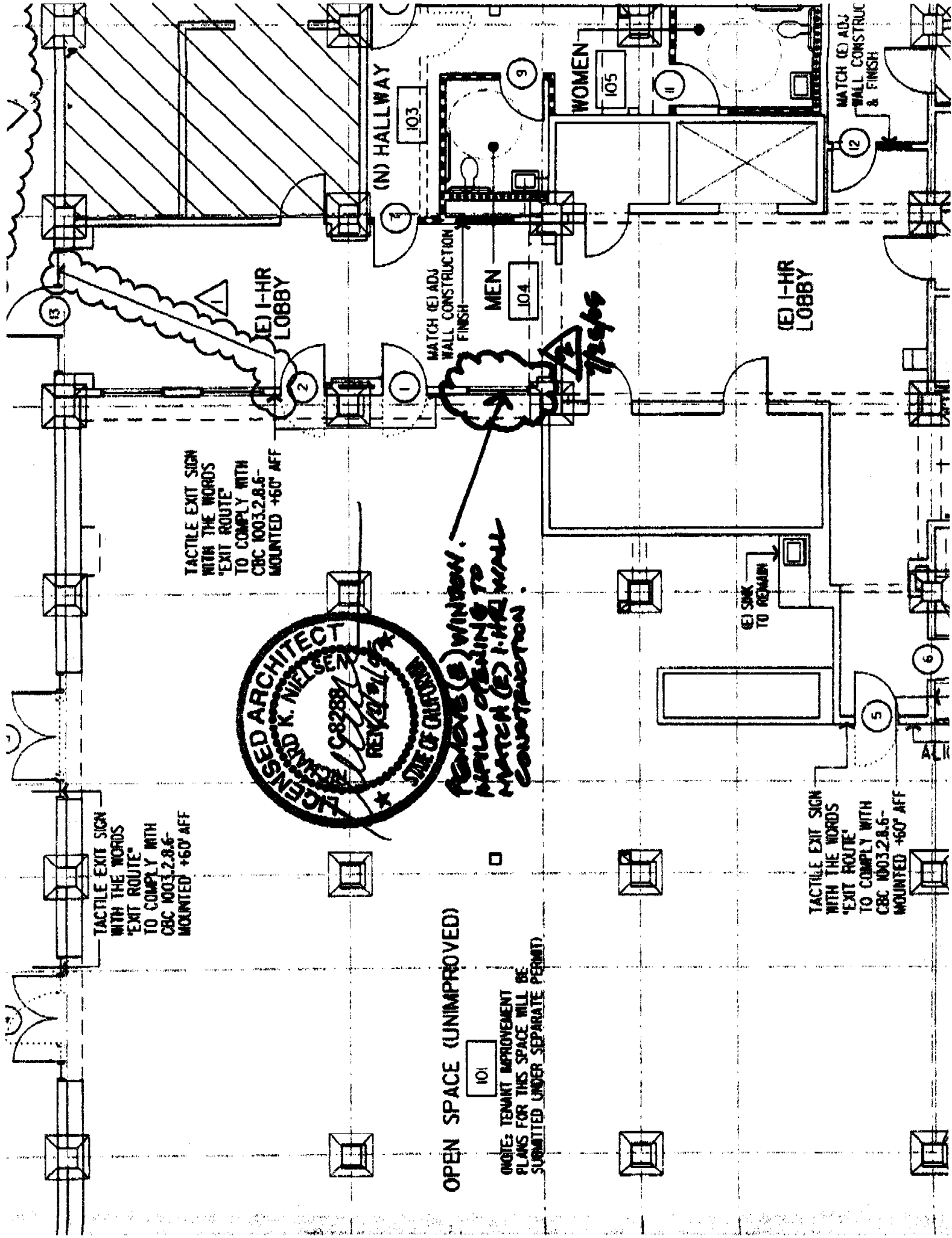

TACTILE EXIT SIGN WITH THE WORDS "EXIT ROUTE" TO COMPLY WITH CBC 1003.2.8.6- MOUNTED +60" AFF

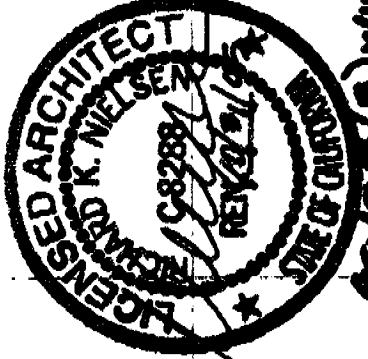

REMOVE (B) WINDOW. PARTIAL OPENING TO MATCH (E) I-HR WALL CONSTRUCTION.

TACTILE EXIT SIGN WITH THE WORDS "EXIT ROUTE" TO COMPLY WITH CBC 1003.2.8.6- MOUNTED +60" AFF

OPEN SPACE (UNIMPROVED)
101
(NOTE: TENANT IMPROVEMENT PLANS FOR THIS SPACE WILL BE SUBMITTED UNDER SEPARATE PERMIT)

TACTILE EXIT SIGN WITH THE WORDS "EXIT ROUTE" TO COMPLY WITH CBC 1003.2.8.6- MOUNTED +60" AFF

(E) SINK TO REMAIN

MATCH (E) ADJ WALL CONSTRUCTION & FINISH

MATCH (E) ADJ WALL CONSTRUCTION FINISH

(E) I-HR LOBBY

(E) I-HR LOBBY

(N) HALLWAY

WOMEN

MEN

13

2

1

7

103

9

105

11

12

5

6

APR