

**CITY OF SACRAMENTO**  
1231 I Street, Sacramento, CA 95814

**Permit No: 0108056**  
**Insp Area: 4**

**Site Address: 441 EASTBROOK WY SAC**  
Parcel No: 201-0420-038 NORTHBR 3-2 LOT 38

Sub-Type: NSFR  
Housing (Y/N): N

CONTRACTOR  
US HOME  
2366 GOLD MEADOW DR  
SFE # 100 95670

OWNER  
US HOME  
2366 GOLD MEADOW WY  
GOLD RIVER CA 95670

ARCHITECT

**Nature of Work: MP 2129 2 STORY 9 ROOM SFR**

**CONSTRUCTION LENDING AGENCY:** I hereby affirm under penalty of perjury that there is a construction lending agency for the performance of the work for which this permit is issued (Sec. 3097, Civ. C.)

Lender's Name \_\_\_\_\_ Lender's Address \_\_\_\_\_

**LICENSED CONTRACTORS DECLARATION:** I hereby affirm under penalty of perjury that I am licensed under provisions of Chapter 9 commencing with section 7000) of Division 3 of the Business and Professions Code and my license is in full force and effect.

License Class B License Number 451839 Date 7/24/01 Contractor Signature Don McCloskey

**OWNER-BUILDER DECLARATION:** I hereby affirm under penalty of perjury that I am exempt from the contractors License Law for the following reason (Sec. 7031.5, Business and Professions Code: any city or county which requires a permit to construct, alter, improve, demolish, or repair any structure, prior to its issuance, also requires the applicant for such permit to file a signed statement that he or she is licensed pursuant to the provisions of the Contractors License Law (Chapter 9 (commencing with Section 7000) of Division 8 of the Business and Professions Code) or that he or she is exempt therefrom and the basis for the alleged exemption. Any violation of Section 7031.5 by any applicant for a permit subjects the applicant to a civil penalty of not more than five hundred dollars (\$500.00).

I, as a owner of the property, or my employees with wages as their sole compensation, will do the work, and the structure is not intended or offered for sale (Sec. 7044, Business and Professional Code. The Contractors License Law does not apply to an owner of property who builds or improves thereon, and who does such work himself or herself or through his/her own employees, provided that such improvements are not intended or offered for sale. If, however, the building or improvement is sold within one year of completion, the owner-builder will have the burden of proving that he/she did not build or improve for the purpose of sale.)

I, as owner of the property, am exclusively contracting with licensed contractors to construct the project. (Sec. 7044, Business and Professions Code) The Contractors License Law does not apply to an owner of property who builds or improves thereon, and who contracts for such projects with a contractor(s) licensed pursuant to the Contractors License Law.

I am exempt under Sec \_\_\_\_\_ B & P for this reason: JUL 24 2001

Date \_\_\_\_\_ Owner Signature \_\_\_\_\_

**IN ISSUING THIS BUILDING PERMIT,** the applicant represents, and the city relies on the representations of the applicant, that the applicant verified all measurements and locations shown on the application or accompanying drawings and that the improvements to be constructed are in accordance with any law or private agreement relating to permissible or prohibited locations for such improvements. This building permit does not authorize any illegal location of any improvement or the violation of any private agreement relating to location of improvements.

I certify that I have read this application and state that all information is correct. I agree to comply with all city and county ordinances and state laws relating to building construction and hereby authorize representative(s) of this city to enter upon the abovementioned property for inspection purposes.

Date 7/24/01 Applicant Agent Signature Don McCloskey

**WORKER'S COMPENSATION DECLARATION:** I hereby affirm under penalty of perjury one of the following declarations:  
I have and will maintain a certificate of consent to self-insure for workers' compensation as provided for by Section 3700 of the Labor Code, for the performance of work for which the permit is issued

I have and will maintain workers' compensation insurance, as required by Section 3700 of the Labor Code, for the performance of the work for which this permit is issued. My workers' compensation insurance carrier and policy number are:

Carrier OLD REPUBLIC INS CO Policy Number MWC107468 00 Exp Date 11/01/2001

(This section need not be completed if the permit is for \$100 or less) I certify that in the performance of the work for which this permit is issued, I shall not employ any person in any manner so as to become subject to the workers' compensation laws of California and agree that if I should become subject to the workers' compensation provisions of Section 3700 of the Labor Code, I shall forthwith comply with those provisions.

Date 7/24/01 Applicant Signature Don McCloskey

**WARNING: FAILURE TO SECURE WORKER'S COMPENSATION COVERAGE IS UNLAWFUL AND SHALL SUBJECT AN EMPLOYER TO CRIMINAL PENALTIES AND CIVIL FINES UP TO ONE HUNDRED THOUSAND DOLLARS (\$100,000) IN ADDITION TO THE COST OF COMPENSATION, DAMAGES AS PROVIDED FOR IN SECTION 3706 OF THE LABOR CODE, INTEREST AND ATTORNEY'S FEE.**

**THIS PERMIT SHALL EXPIRE BY LIMITATION IF WORK IS NOT COMMENCED WITHIN 180 DAYS.**

RESIDENT SUBDIVISION BUILDING PERMIT APPLICATION

Project Address: 441 Eastbrook Way  
Lot Number: 38

Assessor Parcel # 201-0420-038  
Subdivision NORTHBOROUGH VILLAGE 3-2

OWNER INFORMATION:

Legal Property Owner: US HOME Phone# 858-3900  
Owner Address: 366 GOLD MEADOW WAY City GOLD RIVER State CA. Zip 95670

CONTRACTOR INFORMATION:

Contractor: US HOME Lic. # 451839 Phone # 858-3900 Fax 858-3925  
DON McCLOSKEY 719-9059

PROJECT INFORMATION:

Land Use Zone RIA Occupancy Group R3 Construction Type VN Fed Code 1A  
No. of Stories: 2 No. of Rooms: \_\_\_\_\_ Street Width: \_\_\_\_\_  
1<sup>st</sup> Floor Area 1281 2<sup>nd</sup> Floor Area 848 Basement \_\_\_\_\_ Roof Material \_\_\_\_\_  
AREA IN SQUARE FOOT OF:  
Dwelling/Living 2129  
Garage/Storage 462  
<sup>Porch</sup> Decks/Balconies 117  
Carports \_\_\_\_\_  
SCOPE OF WORK: \_\_\_\_\_

FOR OFFICE USE ONLY

- Information Above Complete
- Violation Files Checked
- Standard Setbacks
- County Sewer
- AR Flood Waiver Required
- Flood Elevation Certificate Required
- Water Development Infill Area
- Planning Approval
- Design Review Approval
- Special Fee Districts Apply:

**THE FOLLOWING MUST BE PROVIDED IN ORDER TO SUBMIT FOR PERMIT**

- 2 COMPLETE PLOT PLANS, LEGIBLE & DRAWN TO SCALE
- 11 X 17 COPY OF FLOOR PLAN WITH FOLLOWING INFORMATION
  - a) Assessors Parcel Number
  - b) New Floor Area
  - c) Owners Name
  - d) Project Address

Date: December 21, 2001

To: Sacramento Building Department  
From: BOB FUENTES US Home at NATOMAS TRADITIONS

Re: Final Grading

Due to a very wet conditions of recent rains, we have found that ascertaining proper drainage and finish grade on completed homes to be impossible at this time.

It is our intentions to complete grading on the below homes when the weather permits.

As of today's date this involves:

Lot # 238

Address 441 EASTBROOK WY

# CERTIFICATION OF INSULATION

ADDRESS OR TRACT <b>U.S. HOMES NATOMAS TRADITIONS</b>		LOT # <b>238</b>		SACRAMENTO INSULATION CONTRACTORS <input checked="" type="checkbox"/> P.O. BOX 854, WEST SACRAMENTO, CA 95891 LIC. #202028 <input type="checkbox"/> 1309 MELODY ROAD, MARYSVILLE, CA 95901 LIC. #202026 <input type="checkbox"/> P.O. BOX 9851, FRESNO, CA 93793-9851 LIC. #202025 <input type="checkbox"/> P.O. BOX 1831, RENO, NV 89505 LIC. #10575 <input type="checkbox"/> 3329 A PONDEROSA WAY, LAS VEGAS, NV 89118 LIC. #10675		
DATE INSULATION COMPLETED <b>1-9-02</b>						
WALLS		CEILING		FLOOR		
( SQUARE FEET)		( SQUARE FEET)		( SQUARE FEET)		
TYPE OF INSULATION		TYPE OF INSULATION		TYPE OF INSULATION		
MATERIAL <b>FIBERGLASS</b>		MATERIAL <b>FIBERGLASS</b>		MATERIAL <b>FIBERGLASS</b>		
FORM <b>BATTS</b>		FORM <b>BATTS &amp; BLOW</b>		FORM <b>BATTS</b>		
MANUFACTURER'S PRODUCT I.D.		MANUFACTURER'S PRODUCT I.D.		MANUFACTURER'S PRODUCT I.D.		
MANUFACTURER		MANUFACTURER		MANUFACTURER		
<b>OCF</b>		<b>OCF</b>		<b>OCF</b>		
		BAGS				
R-VALUE INSTALLED	APPLIED THICKNESS	R-VALUE INSTALLED	APPLIED THICKNESS	MIN. INSTALLED WEIGHT PER SQUARE FOOT	R-VALUE INSTALLED	APPLIED THICKNESS
<b>13</b>	<b>2 5/8</b>	<b>38</b>	<b>12 1/4</b>			
<b>19</b>	<b>5 1/2</b>	<b>38</b>	<b>14 3/4</b>			
KNEE WALLS IF R-VALUE IS OTHER THAN WALLS ABOVE						
MATERIAL <b>FIBERGLASS</b>		FORM <b>BATTS</b>		R-VALUE		MANUFACTURER <b>OCF</b>
MATERIAL <b>FOAM</b>				MANUFACTURER <b>W R GRACE</b>		
THIS IS TO CERTIFY THAT INSULATION AND/OR SEALANT HAS BEEN INSTALLED IN CONFORMANCE WITH APPLICABLE CODES, MATERIAL STANDARDS AND REGULATIONS.						
SIGNATURE—INSULATION CONTRACTOR <i>[Signature]</i>				TITLE <b>MANAGER</b>		DATE <b>1-9-02</b>
SIGNATURE—GENERAL CONTRACTOR <i>[Signature]</i>				TITLE		DATE
REMARKS						

Lot Area = 6,964 sf  
 Building Footprint = 1,799 sf  
 Gross Coverage = 25.8%  
 Porch Allowance = 56 sf  
 Net Coverage = 25.0%

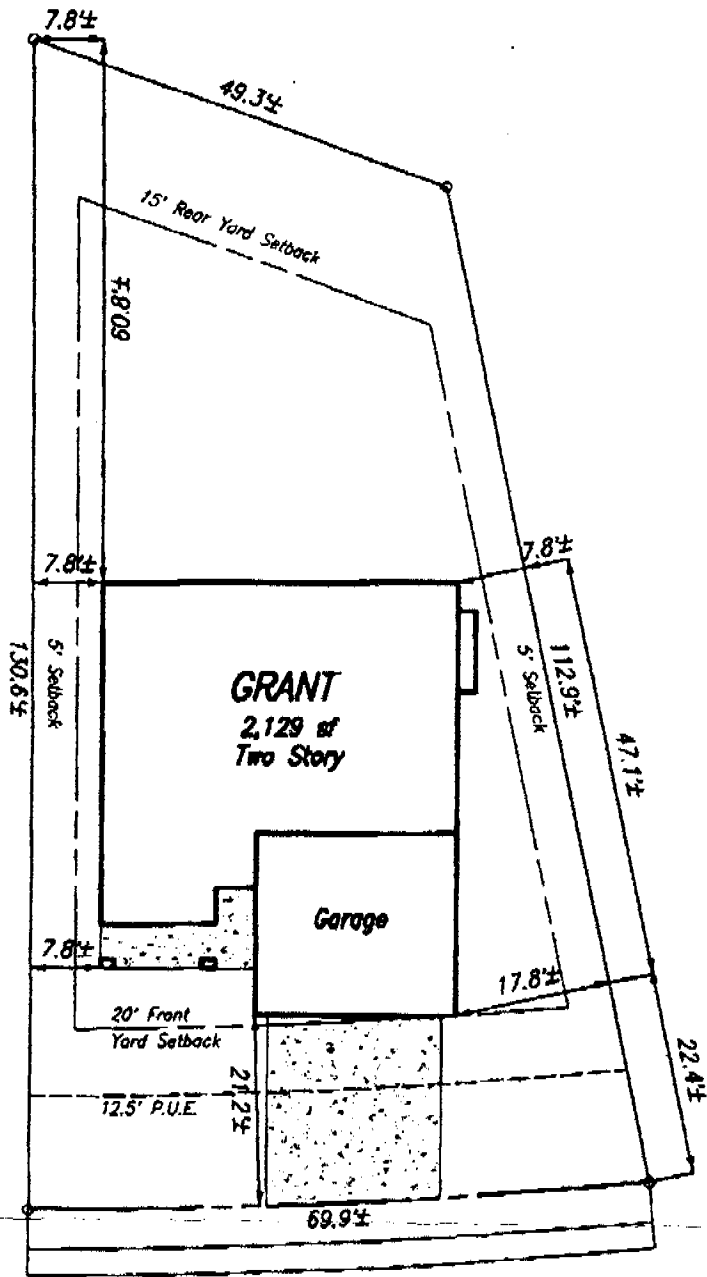
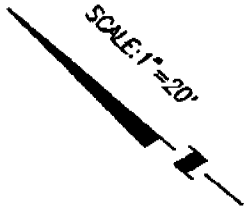

**GRANT**  
 2,129 sf  
 Two Story

Garage

APN:

201-042-038

Address:

441 Eastbrook Way

Owner:

Plan:

2129 R

441 Eastbrook Way

**Plot Plan for Lot 38 for Northborough Village 3-2  
 U.S.Home - Northborough - Traditions Series  
 City of Sacramento**

**Note:**

This plot plan has been prepared for the purpose of showing the building foundation relationship to the property line, proposed drainage elevations and direction of flow to conform to local ordinances and for the purpose of building permit issuance. Information shown is approximate except for those setbacks which are minimums required by ordinance. This plot does not reflect as-built conditions which will likely vary from this plan.

**Murray Smith & Associates  
 Engineering, Inc.**

3110 Gold Canal Drive  
 Rancho Cordova, CA 95670  
 Ph.: (916) 635-1511

May 7, 2001

PN: 99003

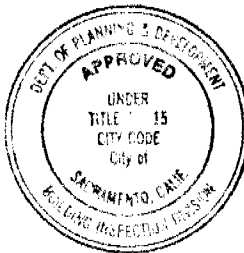

This set of plans and specifications must be kept on the job at all times and it is unlawful to make any changes or alterations from the same without written permission from the Building Inspection Division.

The approval of this plan and specification SHALL NOT be held to permit or approve the violation of any City Ordinance or State Law.