

CITY OF SACRAMENTO
1231 I Street, Sacramento, CA 95814

Permit No: 0403247
Insp Area: 4
Thos Bros: 257-B4

Site Address: 5842 NORTHBOROUGH DR SAC
Parcel No: 201-0590-065
N

HERITAGE @ NATOMAS PARK VII 19 LOT 8
Sub-Type: N1/2PLEX
Housing (Y/N):

CONTRACTOR
US HOME
2366 GOLD MEADOW DR STE 100
GOLD RIVER, CA 95670 77041

OWNER

ARCHITECT

Nature of Work: MP1557 1 STORY 5 ROOM SFR

CONSTRUCTION LENDING AGENCY : I hereby affirm under penalty of perjury that there is a construction lending agency for the performance of the work for which this permit is issued (Sec. 3097, Civ. C).

Lender's Name _____ Lender's Address _____

LICENSED CONTRACTORS DECLARATION: I hereby affirm under penalty of perjury that I am licensed under provisions of Chapter 9 (commencing with section 7000) of Division 3 of the Business and Professions Code and my license is in full force and effect.

License Class B License Number 451839 Date 3/15/04 Contractor Signature Don McCloskey

OWNER-BUILDER DECLARATION: I hereby affirm under penalty of perjury that I am exempt from the contractors License Law for the following reason (Sec. 7031.5, Business and Professions Code; any city or county which requires a permit to construct, alter, improve, demolish, or repair any structure, prior to its issuance, also requires the applicant for such permit to file a signed statement that he or she is licensed pursuant to the provisions of the Contractors License Law (Chapter 9 (commencing with Section 7000) of Division 8 of the Business and Professions Code) or that he or she is exempt therefrom and the basis for the alleged exemption. Any violation of Section 7031.5 by any applicant for a permit subjects the applicant to a civil penalty of not more than five hundred dollars (\$500.00);

I, as a owner of the property, or my employees with wages as their sole compensation, will do the work, and the structure is not intended or offered for sale (Sec. 7044, Business and Professional Code: The Contractors License Law does not apply to an owner of property who builds or improves thereon, and who does such work himself or herself or through his/her own employees, provided that such improvements are not intended or offered for sale. If, however, the building or improvement is sold within one year of completion, the owner-builder will have the burdens of proving that he/she did not build or improve for the purpose of sale.)

I, as owner of the property, am exclusively contracting with licensed contractors to construct the project (Sec. 7044, Business and Professions Code: The Contractors License Law does not apply to an owner of property who builds or improves thereon, and who contracts for such projects with a contractor(s) licensed pursuant to the Contractors License Law).

PAID
CITY OF SACRAMENTO
MAR 15 2004
NORTH PERMIT
CENTER

I am exempt under Sec. _____ B & PC for this reason: _____
Date _____ Owner Signature _____

IN ISSUING THIS BUILDING PERMIT, the applicant represents, and the city relies on the representation of the applicant, that the applicant verified all measurements and locations shown on the application or accompanying drawings and that the improvement to be constructed does not violate any law or private agreement relating to permissible or prohibited locations for such improvements. This building permit does not authorize any illegal location of any improvement or the violation of any private agreement relating to location of improvements.

I certify that I have read this application and state that all information is correct. I agree to comply with all city and county ordinances and state laws relating to building construction and hereby authorize representative(s) of this city to enter upon the abovementioned property for inspection purposes.

Date 3/15/04 Applicant/Agent Signature Don McCloskey

WORKER'S COMPENSATION DECLARATION: I hereby affirm under penalty of perjury one of the following declarations:
I have and will maintain a certificate of consent to self-insure for workers' compensation as provided for by Section 3700 of the Labor Code, for the performance of work for which the permit is issued.

I have and will maintain workers' compensation insurance, as required by Section 3700 of the Labor Code, for the performance of the work for which this permit is issued. My workers' compensation insurance carrier and policy number are:

Carrier OLD REPUBLIC INS. CO. Policy Number MWC10815000 Exp Date 11/01/2004

(This section need not be completed if the permit is for \$100 or less) I certify that in the performance of the work for which this permit is issued, I shall not employ any person in any manner so as to become subject to the workers' compensation laws of California and agree that if I should become subject to the workers' compensation provisions of Section 3700 of the Labor Code, I shall forthwith comply with those provisions.

Date 3/15/04 Applicant Signature Don McCloskey

WARNING: FAILURE TO SECURE WORKER'S COMPENSATION COVERAGE IS UNLAWFUL AND SHALL SUBJECT AN EMPLOYER TO CRIMINAL PENALTIES AND CIVIL FINES UP TO ONE HUNDRED THOUSAND DOLLARS (\$100,000) IN ADDITION TO THE COST OF COMPENSATION, DAMAGES AS PROVIDED FOR IN SECTION 3706 OF THE LABOR CODE, INTEREST AND ATTORNEY'S FEE.

THIS PERMIT SHALL EXPIRE BY LIMITATION IF WORK IS NOT COMMENCED WITHIN 180 DAYS.

THIS PLAN IS PREPARED TO SHOW THE DIMENSIONAL RELATIONSHIP FROM BUILDING FOUNDATION TO PROPERTY LINES, DRAINAGE CONTROL ELEVATIONS AND DIRECTION OF DRAINAGE FLOW. THIS IS DONE TO CONFORM TO LOCAL ORDINANCES FOR THE PURPOSE OF BUILDING PERMIT ISSUANCE. INFORMATION SHOWN ON THIS PLAN IS APPROXIMATE EXCEPT FOR MINIMUM SETBACKS WHICH ARE REQUIRED BY LOCAL ORDINANCE. THIS PLAN DOES NOT REFLECT AS BUILT CONDITIONS WHICH WILL VARY FROM THIS PLAN.

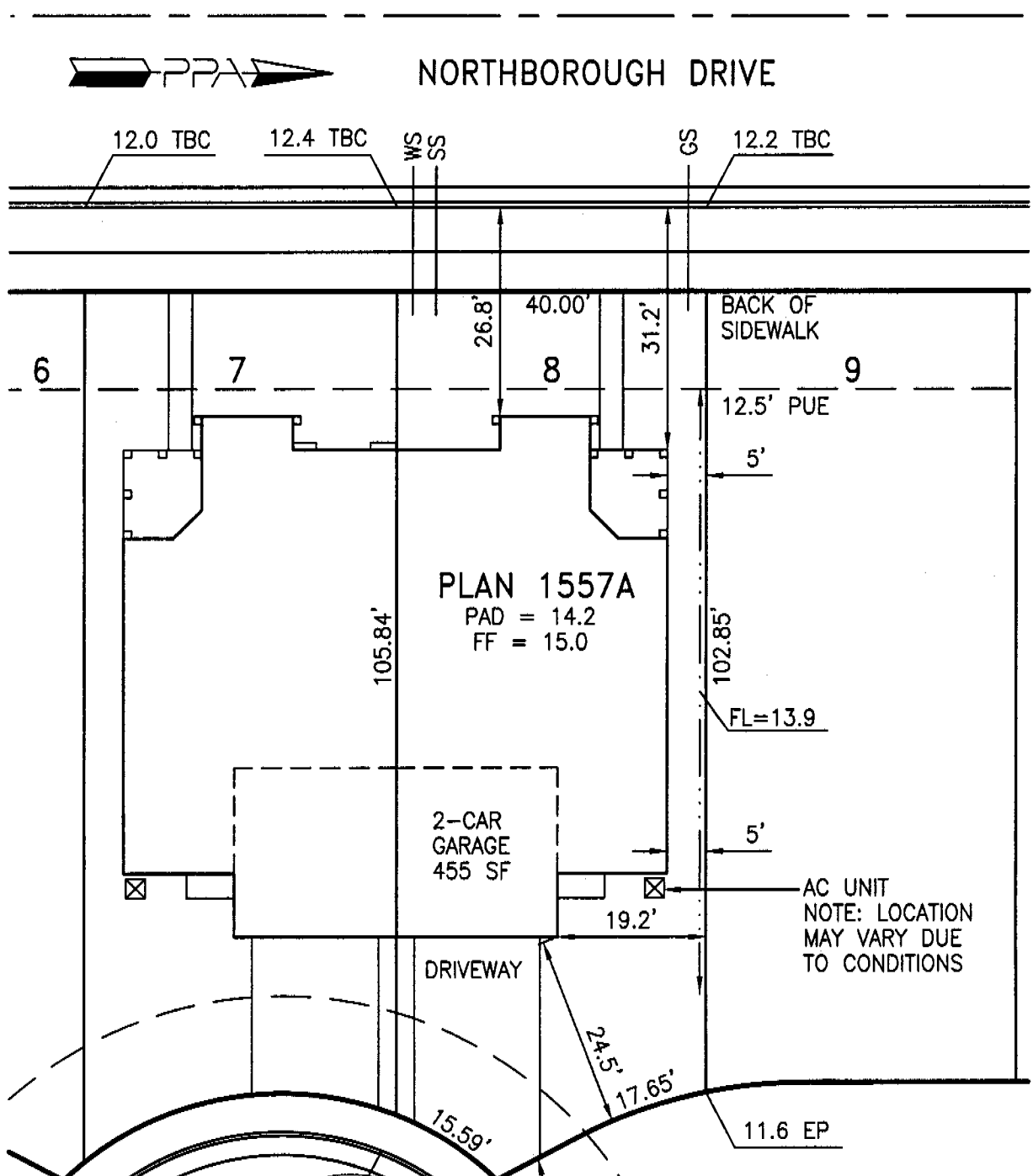

WHARFDALE PLACE

LOT B

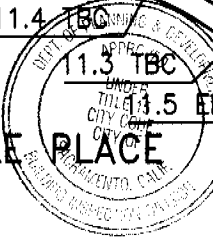

This set of plans and specifications must be kept on the job at all times and it is unlawful to make any changes or alterations from the same without written permission from the Building Inspection Division. The approval of this plan and specification SHALL NOT be held to apply to any other location or project.

Approved By:	US Home Corp. Rep.	Date
Revision	Approved By	Date
▲		
▲		

LOT AREA: 4332 SF
 ALLOWED LOT COVERAGE: 1949 SF = 45.0%
 ACTUAL LOT COVERAGE: 1792 SF = 41.4%
 REAR YARD AREA: 659 SF
 NUMBER OF BEDROOMS:

It is understood that the drainage areas, slopes and grades shall not be altered, changed, blocked, modified or in any way be reconstructed by Owner contrary to what is depicted on this Plot Plan. THESE CONDITIONS RUN WITH THE LAND AND ARE BINDING ON ALL SUBSEQUENT OWNERS. All setback dimensions and elevations as shown may be adjusted to fit field conditions.

Plot Plan for Heritage at Natomas Park Village 19 PPA Job #005010
Heritage Park - Coastal Lot 8
 5842 Northborough Drive, Sacramento, CA 95835 APN 201-0590-065

US Home Corporation - Sacramento Division
 2366 Gold Meadow Way, Suite 200, Gold River, CA 95670 Phone (916) 858-3900 Fax (916) 858-3925

Plot Plan Associates www.plotplans.org Date Drawn: 02/23/04 Scale: 1"=20'
 PO Box 435 Citrus Heights CA 95611-0435 (916) 769-9063 Date Revised: - Drawn By: KLM

D:\005010\Plotplans\Village19\51019008.dwg

LOT 308 5842 NORTH BROADWAY DR

INSTALLATION CERTIFICATE

Site Address US Home Corporation - Heritage Park Product Line 4 - Sacramento - Plan 1557 **CF-6R**

NO. 873 8014

Permit Number

An installation certificate is required to be posted at the building site or made available for all appropriate inspections. (The information provided on this form is required; however, use of this form to provide the information is optional.) After completion of final inspection a copy must be provided to the building department (upon request) and the building owner at occupancy, per Section 10-107(b).

HVAC SYSTEMS:
Heating Equipment

Equip. Type (kg Heat pump)	CEC Certified Mfr Name and Model #	# of Identical Systems	(1) Efficiency (AFUE, etc.) > CF-1R value	Duct Location (size, etc.)	Duct R-value	Heating Load (Btu/hr)	Heating Capacity (Btu/hr)
Furnace	York SP4HJA12U048	1	0.86	Attic	4.2	23,118	40,000

Cooling Equipment

Equip. Type (kg Heat pump)	CEC Certified Compressor Unit Mfr Name and Model #	# of Identical Systems	(1) Efficiency (SEER, etc.) > CF-1R value	Duct Location (size, etc.)	Duct R-value	Cooling Load (Btu/hr)	Cooling Capacity (Btu/hr)
A/C	York SP1RC024	1	12.0	Attic	4.2	20,813	28,480

(1) > reads greater than or equal to.
I, the undersigned, verify that equipment listed above is: 1) the actual equipment installed, 2) equivalent to or more efficient than that specified in the certificate of compliance (Form CF-1R) submitted for compliance with the Energy Efficiency Standards for residential buildings, and 3) equipment that meets or exceeds the appropriate requirements for manufactured devices (from the Appliance Efficiency Regulations Part 6), where applicable.

Anthony Chiodo
Signature, Date

Beuler Corporation
Installing Subcontractor (Co. Name)
OR General Contractor (Co. Name) OR Owner

WATER HEATING SYSTEMS:

Heater Type	CEC Certified Mfr Name & Model #	Disturbance Type (lit, vent, or any)	IF Recirculation Control Type	# of Identical Systems	Rated Input (kW or Btu/hr)	Task Volume (gal/Day)	(1) Efficiency (EF, RE)	(2) Standby Loss (%)	Exhaust Termination Review
GAS	IT Power 41-440M	STD	NA	0	40,000	40	.56	R-6.7	

(1) For small gas storage water heaters rated input of less than or equal to 75,000 Btu/hr, electric resistance and heat pump water heaters, list Energy Factor. For large gas storage water heaters rated input of greater than 75,000 Btu/hr, list Recovery Efficiency, Standby Loss and Rated Input. For instantaneous gas water heaters, list Recovery Efficiency and Rated Input.
(2) R-12 insulation is mandatory for storage water heaters with an energy factor of less than 0.56.

Floors & Slab-on-Grade:

All floors and the slab-on-grade installed are certified to the Commission, pursuant to Title 24, Part 6, Section 111.
I, the undersigned, verify that equipment listed above my signature is: 1) the actual equipment installed, 2) equivalent to or more efficient than that specified in the certificate of compliance (Form CF-1R) submitted for compliance with the Energy Efficiency Standards for residential buildings, and 3) equipment that meets or exceeds the appropriate requirements for manufactured devices (from the Appliance Efficiency Regulations or Part 6), where applicable.

David Offenberg
Signature, Date 04-04-03

Monarch Plumbing CO., INC.
Installing Subcontractor (Co. Name)
OR General Contractor (Co. Name) OR Owner

COPY TO: Building Department
HERS Provider (if applicable)
Building Owner at Occupancy

NO 1312 P. 7/19

APR. 3. 2003 3:33PM MAIL U.S. HOME HERITAGE PARK

INSTALLATION CERTIFICATE

CREATIVE WINDOW CONCEPTS

916 638 0882 P. 01/0

Site Address: **LOT 306 5842 NORTH BOROUGH DR.**

Form Number: **FORM NUMBER**

Window/Clazing:



Manufacturer/Brand Name (GROUP LIKE PRODUCTS)	Operator Type (e.g., Fixed, Sliding)	Manufacturer Product Labelled U-value (if CF-IR value)	Site/Build Number # of Panels	Default U-Value	Quantity (Ordered)	Total Square Feet	Comments/ Special Features
1. Philips SPON	SH	.38	2	NOT			Performance Plus Low
2.	HS	.38	2	APPLICABLE			
3.	FIX	.36	2				
4.	SGD	.35	2				
5.	Rollers	.35	2				
6.							
7.							
8.							
9.							
10.							
11.							
12.							
13.							
14.							
15.							

1) Installed U-value must be less than or equal to value from CF-IR. Alternatively, installed weighted average U-value for the total fenestration area is less than or equal to value from CF-IR.

I, the undersigned, verify that the fenestration/glazing listed above my signature: 1) is the actual fenestration product installed; 2) is equivalent to or more efficient than that specified in the certificate of compliance (Form CF-IR) submitted for compliance with the Energy Efficiency Standards for residential buildings; and 3) the product meets or exceeds the appropriate requirements for manufactured devices (from Part 6), where applicable.

Item #s
(if applicable)

[Signature]
Signature, Date

Creative Window Concepts
Installing Subcontractor (Co. Name) OR
General Contractor (Co. Name) OR Owner

Item #s
(if applicable)

Signature, Date

Installing Subcontractor (Co. Name) OR
General Contractor (Co. Name) OR Owner

Item #s
(if applicable)

Signature, Date

Installing Subcontractor (Co. Name) OR
General Contractor (Co. Name) OR Owner

COPY TO: Building Department
Building Owner at Occupancy

Revised March 1, 1996

CERTIFICATION OF INSULATION

U S Homes

LOT # 308

Duplexes @ Heritage Park

- P.O. BOX 654, WEST SACRAMENTO, CA 95661 LIC. #202026
- 1309 MELODY ROAD, MARYSVILLE, CA 95901 LIC. #202026
- P.O. BOX 9651, FRESNO, CA 93793-9651 LIC. #202026
- P.O. BOX 1631, RENO, NV 89505 LIC. #10675
- 3326 A PONDEROSA WAY, LAS VEGAS, NV 89118 LIC. #10675

DATE INSULATION COMPLETED

9-13-04

WALLS			CEILING			FLOOR		
SQ. FT.			SQ. FT.			SQ. FT.		
MATERIAL: FIBERGLASS			MATERIAL: FIBERGLASS			MATERIAL: FIBERGLASS		
FORM: BATTS			FORM: BATTS & BLOW			FORM: BATTS		
MANUFACTURER'S PRODUCT I.D.			MANUFACTURER'S PRODUCT I.D.			MANUFACTURER'S PRODUCT I.D.		
CT	OC	JM	CT	OC	JM	CT	OC	JM
13	3 1/2"	36	12	12	12			
19	5 1/2"		14 3/4"					
MATERIAL: FIBERGLASS		FORM: BATTS		MANUFACTURER		MANUFACTURER		
				CT		OC		JM
MATERIAL: Foam				MANUFACTURER		MANUFACTURER		
				HILTI		HANDY FOAM		

SIGNATURE — INSULATION CONTRACTOR	TITLE	DATE
<i>JC</i>	MANAGER	8/31/04
SIGNATURE — GENERAL CONTRACTOR	TITLE	DATE

REMARKS

ATTACH COPY