

CITY OF SACRAMENTO
1231 I Street, Sacramento, CA 95814

Permit No: 0404132
Insp Area: 4
Thos Bros: 256H3

Site Address: 330 GREG THATCH CR SAC
Parcel No: NATOMAS CREEK VIL. 1 LOT 281

Sub-Type: NSFR
Housing (Y/N): N

CONTRACTOR
D. R. HORTON INC.
4401 HAZEL AVE STE 135
FAIR OAKS, CA 95628

OWNER

ARCHITECT

Nature of Work: MP2240 2 STORY 9 ROOM SFR

CONSTRUCTION LENDING AGENCY : I hereby affirm under penalty of perjury that there is a construction lending agency for the performance of the work for which this permit is issued (Sec. 3097, Civ. C).

Lender's Name _____ Lender's Address _____

LICENSED CONTRACTORS DECLARATION: I hereby affirm under penalty of perjury that I am licensed under provisions of Chapter 9 (commencing with section 7000) of Division 3 of the Business and Professions Code and my license is in full force and effect.

License Class B License Number 750190 Date 4-1-04 Contractor Signature [Signature]

OWNER-BUILDER DECLARATION: I hereby affirm under penalty of perjury that I am exempt from the contractors License Law for the following reason (Sec. 7031.5, Business and Professions Code; any city or county which requires a permit to construct, alter, improve, demolish, or repair any structure, prior to its issuance, also requires the applicant for such permit to file a signed statement that he or she is licensed pursuant to the provisions of the Contractors License Law (Chapter 9 (commencing with Section 7000) of Division 8 of the Business and Professions Code) or that he or she is exempt therefrom and the basis for the alleged exemption. Any violation of Section 7031.5 by any applicant for a permit subjects the applicant to a civil penalty of not more than five hundred dollars (\$500.00);

____ I, as a owner of the property, or my employees with wages as their sole compensation, will do the work, and the structure is not intended or offered for sale (Sec. 7044, Business and Professional Code: The Contractors License Law does not apply to an owner of property who builds or improves thereon, and who does such work himself or herself or through his/her own employees, provided that such improvements are not intended or offered for sale. If, however, the building or improvement is sold within one year of completion, the owner-builder will have the burden of proving that he/she did not build or improve for the purpose of sale.)

____ I, as owner of the property, am exclusively contracting with licensed contractors to construct the project (Sec. 7044, Business and Professions Code: The Contractors License Law does not apply to an owner of property who builds or improves thereon, and who contracts for such projects with a contractor(s) licensed pursuant to the Contractors License Law).

____ I am exempt under Sec. _____ B & PC for this reason: _____
Date _____ Owner Signature _____

IN ISSUING THIS BUILDING PERMIT, the applicant represents, and the city relies on the representation of the applicant, that the applicant verified all measurements and locations shown on the application or accompanying drawings and that the improvement to be constructed does not violate any law or private agreement relating to permissible or prohibited locations for such improvements. This building permit does not authorize any illegal location of any improvement or the violation of any private agreement relating to location of improvements.

I certify that I have read this application and state that all information is correct. I agree to comply with all city and county ordinances and state laws relating to building construction and hereby authorize representative(s) of this city to enter upon the abovementioned property for inspection purposes.

Date 4-1-04 Applicant/Agent Signature [Signature]

WORKER'S COMPENSATION DECLARATION: I hereby affirm under penalty of perjury one of the following declarations:

____ I have and will maintain a certificate of consent to self-insure for workers' compensation as provided for by Section 3700 of the Labor Code, for the performance of work for which the permit is issued.

____ I have and will maintain workers' compensation insurance, as required by Section 3700 of the Labor Code, for the performance of the work for which this permit is issued. My workers' compensation insurance carrier and policy number are:

Carrier AMERICAN CASULTY CO Policy Number WC247856876 Exp Date 07/01/2004

____ (This section need not be completed if the permit is for \$100 or less) I certify that in the performance of the work for which this permit is issued, I shall not employ any person in any manner so as to become subject to the workers' compensation laws of California and agree that if I should become subject to the workers' compensation provisions of Section 3700 of the Labor Code, I shall forthwith comply with those provisions.

Date 4-1-04 Applicant Signature [Signature]

WARNING: FAILURE TO SECURE WORKER'S COMPENSATION COVERAGE IS UNLAWFUL AND SHALL SUBJECT AN EMPLOYER TO CRIMINAL PENALTIES AND CIVIL FINES UP TO ONE HUNDRED THOUSAND DOLLARS (\$100,000) IN ADDITION TO THE COST OF COMPENSATION, DAMAGES AS PROVIDED FOR IN SECTION 3706 OF THE LABOR CODE, INTEREST AND ATTORNEY'S FEE.

THIS PERMIT SHALL EXPIRE BY LIMITATION IF WORK IS NOT COMMENCED WITHIN 180 DAYS.

THIS PLOT PLAN IS NOT FOR SALES PURPOSES. THIS PLOT PLAN IS FOR THE PURPOSE OF INDICATING COMPLIANCE WITH ZONING SET BACKS, GENERAL DRAINAGE AND APPROXIMATE UTILITY CONNECTION. ALL OTHER DATA SHOWN HEREON IS CONCEPTUAL. THIS PLOT PLAN DOES NOT REFLECT AS-BUILT CONDITION. RETAINING WALLS ARE OPTIONAL, AND MAY OR MAY NOT BE CONSTRUCTED.

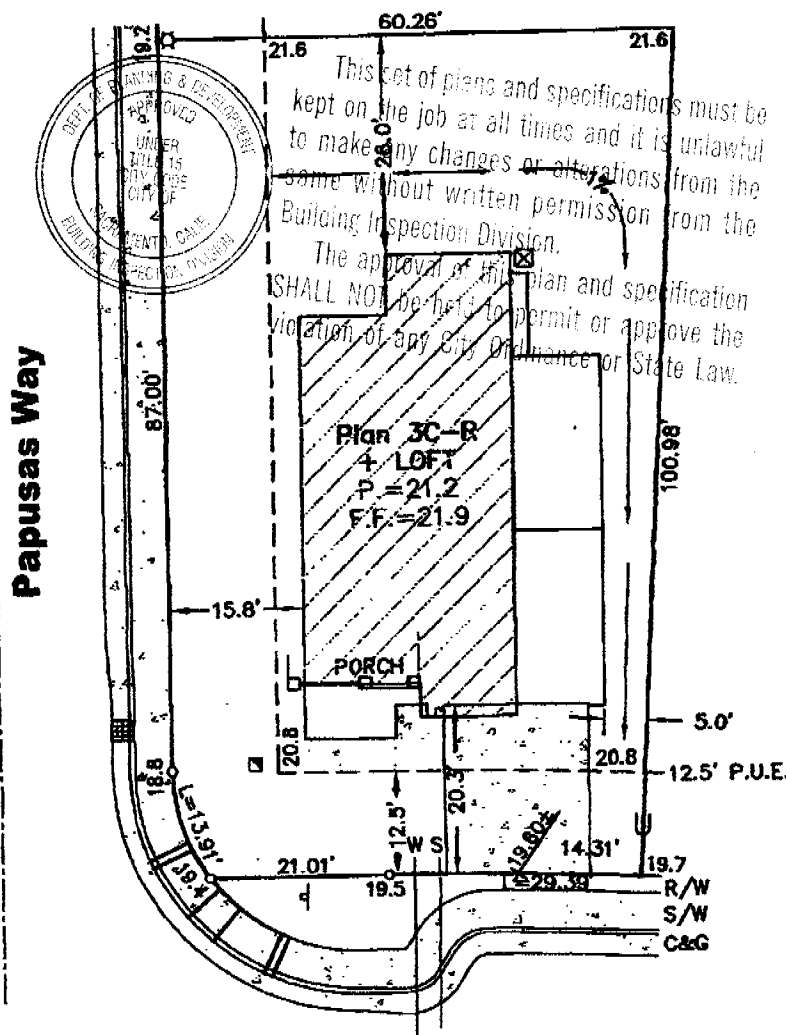
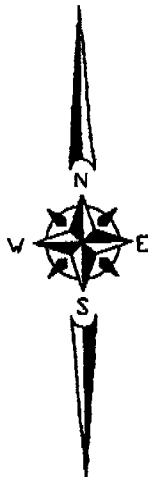
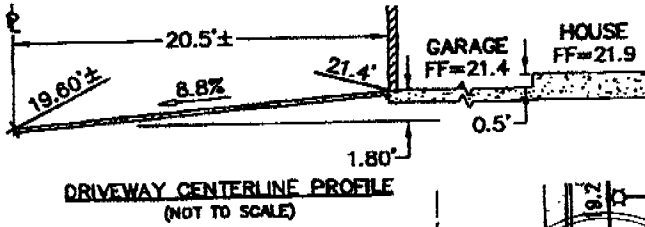

This set of plans and specifications must be kept on the job at all times and it is unlawful to make any changes or alterations to the same without written permission from the Building Inspection Division. The approval of this plan and specification SHALL NOT be held to permit or approve the violation of any City Ordinance or State Law.

LEGEND

- U --- UTILITY LOCATION
- ⊠ --- AIR CONDITIONER
- S --- SEWER
- W --- WATER
- --- DIMENSION POINT
- ☆ --- STREET LIGHT
- ⊡ --- STREET SIGN
- ⊞ --- SUREWEST VAULT
- --- DRAIN INLET

Greg Thatch Circle

NET LOT AREA = 5,737 SQ. FEET
FOOTPRINT AREA = 1,732 SQ. FEET
LOT COVERAGE = 30%

SCALE: 1" = 20'

**PLOT PLAN
LOT 281**
Natomas Creek Village 1
Cornerstone - Phase 12
City of Sacramento, State of California

**WECKER
SURVEYS**

1111 KENNEDY PLACE
SUITE 4
DAVIS, CA 95616
530-792-7252
FAX 530-758-2775



WALLACE - KUHL & ASSOCIATES INC.
 GEOTECHNICAL ENGINEERING • CONSTRUCTION TESTING

3050 Industrial Blvd.
 PO Box 1137
 West Sacramento
 California 95691
 916-372-1434

DATE 5-28-04		JOB NO. 5406-11		WEATHER P. SUNNY		TEMP. 70 ^s ° at		AM PM
PROJECT NATONAS CREEK HILL 2 (DR HORTON)				Technician I <input type="checkbox"/>		Staff E/G <input type="checkbox"/>		
LOCATION 1281				Technician II <input type="checkbox"/>		Project E/G <input type="checkbox"/>		
TYPE OF WORK PULL TEST				Technician III <input type="checkbox"/>		Senior E/G <input type="checkbox"/>		
Inside 50 mi. radius <input type="checkbox"/>		Outside 50 mi. radius <input type="checkbox"/>		Nuclear Densities <input type="checkbox"/>		Principal E/G <input type="checkbox"/>		
PERSONNEL		REG. HRS	OT HRS	TOTAL HRS	TRAVEL	ON JOB	VEHICLE	MILES
J VINCENT							29	18

OBSERVATIONS:
 ARRIVED ON SITE FOR PULL TEST. RESULTS WERE IN ACCORDANCE WITH SIMPSON SPECIFICATIONS

LOT	TYPE	DIA.	QTY	LRS.ACHIEVED	LOCATION
1001	14722	5/8"	2	5250 LBS	LEFT SIDE OF GARAGE
1281	PH06	7/8"	2	5860 LBS	EACH SIDE OF GARAGE OPENING

FIELD REPORT

Signed J Vincent



WALLACE-KUHL & ASSOCIATES, INC.
GEOTECHNICAL ENGINEERING • CONSTRUCTION TESTING

RE-INSPECTION REPORT

PROJECT D.R. HORTON CREEK SLOPE		JOB NO.		DATE OF RE-INSPECTION 10-10-01	
LOCATION/AREA Lot # 231 @ GREEN TRAIL			DATE OF ORIGINAL INSPECTION		
TYPE OF RE-INSPECTION TD11 Test			CONTRACTOR/BUILDER		
PERSONNEL	REGULAR HOURS	OVERTIME HOURS	TOTAL HOURS	TRAVEL	
Jose Martinez					
COMMENTS					
Tested 5' x 5' Area of ground from 10/10/01 at 0250. Found at tension (2000 PSI) and at 7/8" depth 1. 5300. Found at tension (2400 PSI) 5000 (2) per Super Table.					
# 3.111	Location	PASSED / PASSED			
2 5/8" urea	Front Entrance	PASSED			
1 7/8" urea	Under Slab	PASSED			
- All Tests passed Plus					

SIGNED Jose Martinez



WALLACE • KUHL & ASSOCIATES INC.
 GEOTECHNICAL ENGINEERING • CONSTRUCTION TESTING

3050 Industrial Blvd.
 PO Box 1137
 West Sacramento
 California 95691
 916-372-1434

DATE 06-29-04		JOB NO.		WEATHER		TEMP. ° at AM ° at PM	
PROJECT D.T. Horizontal CREEKSIDE				Technician I <input checked="" type="checkbox"/>		Staff E/G <input type="checkbox"/>	
LOCATION Lot # 231 @ Fireg tract				Technician II <input type="checkbox"/>		Project E/G <input type="checkbox"/>	
TYPE OF WORK Pull Test 6-25-04				Technician III <input type="checkbox"/>		Senior E/G <input type="checkbox"/>	
Inside 50 mi. radius <input checked="" type="checkbox"/>		Outside 50 mi. radius <input type="checkbox"/>		Nuclear Densities <input type="checkbox"/>		Principal E/G <input type="checkbox"/>	
PERSONNEL	REG. HRS	OT HRS	TOTAL HRS	TRAVEL	ON JOB	VEHICLE	MILES
Jose Matamor						# 51 29	218

OBSERVATIONS:

Tested 7/8" All thread anchor bolts for
 FHDL Horizontal to 5060 Pounds of Tension
 (2400 PSI spec IV) per Simpson Book

# Bolts	Lot #	Location	PASSED/FAILED
2 7/8" rods	231	Front Entrance/Garage	PASSED

- All Tested passed BLUE

FIELD REPORT

Signed _____



WALLACE - KUHL & ASSOCIATES INC.
 GEOTECHNICAL ENGINEERING • CONSTRUCTION TESTING

3050 Industrial Blvd.
 PO Box 1137
 West Sacramento
 California 95691
 916-372-1434

DATE 06-02-04		JOB NO.		WEATHER		TEMP. ° at		AM	
PROJECT D.R. HERRON (CREOSIDE)		Technician I <input checked="" type="checkbox"/>		Staff E/G <input type="checkbox"/>					
LOCATION Lot # 281 @ FIREB RST		Technician II <input type="checkbox"/>		Project E/G <input type="checkbox"/>					
TYPE OF WORK RUII Test		Technician III <input type="checkbox"/>		Senior E/G <input type="checkbox"/>					
Inside 50 mi. radius <input checked="" type="checkbox"/>		Outside 50 mi. radius <input type="checkbox"/>		Nuclear Densities <input type="checkbox"/>		Principal E/G <input type="checkbox"/>			
PERSONNEL		REG. HRS	OT HRS	TOTAL HRS	TRAVEL	ON JOB	VEHICLE	MILES	
Jose Matamoros							# 51	3.0	

OBSERVATIONS:

Tested 7/8" ~~...~~ bolts for
 PHDL Holddowns to 5860 Pounds of Tension
 (2400 PSI spec ID) Per Simpson Book

# Bolts	lot #	location	PASSED / FAILED
2 PHDL	281	Jammy Room	PASSED
1 PHDL	281	Under Stairs	PASSED
* 1 PHDL	281	Under Stairs	* FAILED *

* Mark with a blue (X) (Failed)

* All passed except mark with NK BLUE

FIELD REPORT Signed Jose Matamoros

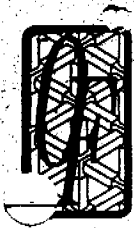

O'Connor Freeman & Associates, Inc.

Structural Engineering Services

July 26, 2002

Rich Coyle

D.R. Horton

4401 Hazel Avenue, Suite 135

Fair Oaks, CA 95628

Handwritten: [Signature] 5-26-04

Re: Simpson Wedge Anchor Repair for missing MAS or Shear Wall anchor bolts
O'Connor Freeman Job Number: E020105

Dear Rich:

This letter is to verify that the Simpson Wedge Anchors or equivalent may be used to repair missing mudsill anchor bolts for the following situations.

Type "A" Shear Wall:

(Allow: 260 plf)

- Install 1/2" Wedge-All anchor spaced at 24" on center for missing or incorrectly installed anchor bolts. Please note that a minimum edge distance of two inches (2") from the outside of the foundation to the centerline of the bolt must be obtained. In addition, the edge distance from the centerline of the bolt to the inside face of the wall plate must be greater than one inch (1"). Anchors must have a 2 1/4" embedment into the concrete slab.

Type "B" Shear Wall:

(Allow: 380 plf)

- Install 1/2" Wedge-All anchor spaced at 16" on center for missing or incorrectly installed anchor bolts. Please note that a minimum edge distance of two inches (2") from the outside of the foundation to the centerline of the bolt must be obtained. In addition, the edge distance from the centerline of the bolt to the inside face of the wall plate must be greater than one inch (1"). Anchors must have a 2 1/4" embedment into the concrete slab.

Type "C" Shear Wall:

(Allow: 490 plf)

- Install 5/8" Wedge-All anchor spaced at 24" on center for missing or incorrectly installed anchor bolts. Please note that a minimum edge distance of two inches (2") from the outside of the foundation to the centerline of the bolt must be obtained. In addition, the edge distance from the centerline of the bolt to the inside face of the wall plate must be greater than one inch (1"). Anchors must have a 2 3/4" embedment into the concrete slab.

Vertical stamp: This specification must be kept on file and it is to be used for all future projects. No alterations or additions shall be made without the approval of the Building Department. The approval of the Building Department shall be a condition of any violation of any...

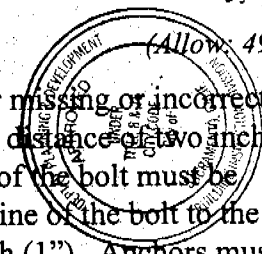

Type "D" Shear Wall:

(Allow: 600 plf)

- Install $\frac{5}{8}$ " Wedge-All anchor spaced at 16" on center for missing or incorrectly installed anchor bolts. Please note that a minimum edge distance of two inches (2") from the outside of the foundation to the centerline of the bolt must be obtained. In addition, the edge distance from the centerline of the bolt to the inside face of the wall plate must be greater than one inch (1"). Anchors must have a $2\frac{3}{4}$ " embedment into the concrete slab.

Type "E" Shear Walls:

(Allow: 770 plf)

- Install $\frac{5}{8}$ " Wedge-All anchor spaced at 12" on center for missing or incorrectly installed anchor bolts. Please note that a minimum edge distance of two inches (2") from the outside of the foundation to the centerline of the bolt must be obtained. In addition, the edge distance from the centerline of the bolt to the inside face of the wall plate must be greater than one inch (1"). Anchors must have a $2\frac{3}{4}$ " embedment into the concrete slab.

If you should have any further questions or comments please do not hesitate to call.

Sincerely,

O'Connor Freeman & Associates, Inc.

Joseph Goldbronn
Staff Engineer

cc: File

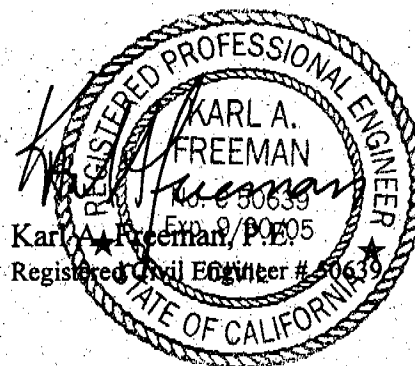

This set of plans and specifications must be kept on the job at all times and it is unlawful to make any changes or alterations from the same without written permission from the Building Inspection Division.
The approval of this plan and specification SHALL NOT be held to permit or approve the violation of any City Ordinance or State Law.

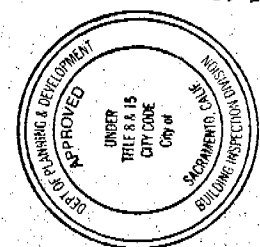

RESIDENTIAL SUBDIVISION BUILDING PERMIT APPLICATION

Project Address: 330 Grey Hatch Circle Assessor Parcel #: 101-1300-026/027/028/029
 Lot Number: 281 Subdivision: NATHANAS CREEK

OWNER INFORMATION:

Legal Property Owner: DR HORTON Phone# 916 965 2200
 Owner Address: 4401 HAZEL AVE STE 225 City FAIR OAKS State CA Zip 95628

CONTRACTOR INFORMATION:

Contractor: DR HORTON Lic. # 750190 Phone # 965 2200 Fax 965 2280

PROJECT INFORMATION:

Land Use Zone R1A Occupancy Group R3 Construction Type VN Fed Code 1A
 No. of Stories: 2 No. of Rooms: 4 Street Width: _____
 1st Floor Area 1084 2nd Floor Area 1156 Basement Roof Material CONCRETE TILE

AREA IN SQUARE FOOT OF:

Dwelling/Living	<u>2240</u>
Garage/Storage	<u>628</u>
Decks/Balconies	<u>0</u>
Carports	<u>0</u>

SCOPE OF WORK: _____

FOR OFFICE USE ONLY

- | | | |
|---|---|---|
| <input type="checkbox"/> Information Above Complete | <input type="checkbox"/> AR Flood Waiver Required | <input type="checkbox"/> Planning Approval |
| <input type="checkbox"/> Violation Files Checked | <input type="checkbox"/> Flood Elevation Certificate Required | <input type="checkbox"/> Design Review Approval |
| <input type="checkbox"/> Standard Setbacks | <input type="checkbox"/> Water Development Infill Area | <input type="checkbox"/> Special Fee Districts Apply: |
| <input type="checkbox"/> County Sewer | | |

~THE FOLLOWING MUST BE PROVIDED IN ORDER TO SUBMIT FOR PERMIT~

- 2 COMPLETE PLOT PLANS, LEGIBLE & DRAWN TO SCALE
- 11 X 17 COPY OF FLOOR PLAN WITH FOLLOWING INFORMATION

a) Assessor's Parcel Number	c) Owners Name
b) New Floor Area	d) Project Address

Date: _____ Received by: (staff) _____ Permit # _____

CERTIFICATION OF INSULATION

ADDRESS OR TRACT <i>D. R. Horton</i> LOT # <i>1281</i> <i>Cornestone - Creekside</i>	SACRAMENTO BUILDING PRODUCTS <input checked="" type="checkbox"/> P.O. BOX 854, WEST SACRAMENTO, CA 95691 LIC. #202026 <input type="checkbox"/> 1309 MELODY ROAD, MARYSVILLE, CA 95901 LIC. #202026 <input type="checkbox"/> P.O. BOX 9651, FRESNO, CA 93793-9651 LIC. #202026 <input type="checkbox"/> P.O. BOX 1631, RENO, NV 89505 LIC. #10675 <input type="checkbox"/> 3326 A PONDEROSA WAY, LAS VEGAS, NV 89118 LIC. #10675 DATE INSULATION COMPLETED
---	--

WALLS			CEILING			FLOORS		
(SQUARE FEET)			(SQUARE FEET)			(SQUARE FEET)		
TYPE OF INSULATION			TYPE OF INSULATION			TYPE OF INSULATION		
MATERIAL FIBERGLASS			MATERIAL FIBERGLASS			MATERIAL FIBERGLASS		
FORM BATTS			FORM BATTS & BLOW			FORM BATTS		
MANUFACTURER'S PRODUCT I.D.			MANUFACTURER'S PRODUCT I.D.			MANUFACTURER'S PRODUCT I.D.		
MANUFACTURER			MANUFACTURER			MANUFACTURER		
CT	OC	JM	CT	OC	JM	CT	OC	JM
BAGS								
R - VALUE INSTALLED	APPLIED THICKNESS	R - VALUE INSTALLED	APPLIED THICKNESS	MIN. INSTALLED WEIGHT PER SQUARE FOOT	R - VALUE INSTALLED	APPLIED THICKNESS	R - VALUE INSTALLED	APPLIED THICKNESS
<i>R-13</i>	<i>3 1/2"</i>	<i>38</i>	<i>13'</i>					
<i>R-19</i>	<i>5 1/2"</i>							
KNEE WALLS IF R-VALUE IS OTHER THAN WALLS ABOVE								
MATERIAL FIBERGLASS		FORM BATTS		R VALUE		MANUFACTURER		
						CT	OC	JM
AIR INFILTRATION SEALANT								
MATERIAL <i>Foam</i>				MANUFACTURER				
				HILTI		HANDY FOAM		

THIS IS TO CERTIFY THAT INSULATION AND/OR SEALANT HAS BEEN INSTALLED IN CONFORMANCE WITH APPLICABLE CODES, MATERIAL STANDARDS AND REGULATIONS.

SIGNATURE — INSULATION CONTRACTOR	<i>Jc</i>	TITLE	MANAGER	DATE	<i>7/12/04</i>
SIGNATURE — GENERAL CONTRACTOR		TITLE		DATE	
REMARKS					

KwikKote

No. 200-920899

**Stucco System
Installation Card**

Job Name: CREEKSIDE - CORNERSTONE
Address: GREG THATCH CIRCLE

Lot #: 0001281

Stucco System Trade Name: KWIK KOTE
Stucco System Manufacturer: KWIK KOTE CORP.

ICBO Evaluation Service, Inc.

Report No. 3607

Date of Job Completion:

6/23/04

Home Builder: D.R. HORTON INC.

Address: 4401 HAZEL AVE. SUITE 225
FAIR OAKS, CA

Stucco Contractor: KENYON PLASTERING, INC.

Address: PO BOX 2077

North Highlands, CA

Telephone Number: 916/349-8191

Approved Contractor Number as
issued by the Stucco Manufacturer: 1001

Card Print Date: 07/07/2004

This is to certify that the stucco system on the building exterior at the above address had been installed in accordance with the evaluation report specified above and the manufacturer's instructions.



Signature of authorized representative of stucco contractor



Date