

CITY OF SACRAMENTO

Permit No: 0002775

1231 I Street, Sacramento, CA 95814

Insp Area: 4

Site Address: 1511 EDMORE AV SAC

Sub-Type: NSFR

Parcel No: 225-1120-064

LOT 64 NORTHPT PK 14

Housing (Y/N): N

CONTRACTOR

OWNER

ARCHITECT

LENNAR RENAISSANCE INC.
2240 DOUGLAS BL
ROSEVILLE CA. 95661

Nature of Work: NSFR MP202 1 STORY 9 RMS

CONSTRUCTION LENDING AGENCY : I hereby affirm under penalty of perjury that there is a construction lending agency for the performance of the work for which this permit is issued (Sec. 3097, Civ. C).

Lender's Name Lender's Address

LICENSED CONTRACTORS DECLARATION: I hereby affirm under penalty of perjury that I am licensed under provisions of Chapter 9 (commencing with section 7000) of Division 3 of the Business and Professions Code and my license is in full force and effect.

License Class B License Number 7323-18 Date 2/28/01 Contractor Signature [Signature]

OWNER-BUILDER DECLARATION: I hereby affirm under penalty of perjury that I am exempt from the contractors License Law for the following reason (Sec. 7031.5, Business and Professions Code; any city or county which requires a permit to construct, alter, improve, demolish, or repair any structure. prior to its issuance, also requires the applicant for such permit to file a signed statement that he or she is licensed pursuant to the provisions of the Contractors License Law (Chapter 9 (commencing with Section 7000) of Division 8 of the Business and Professions Code) or that he or she is exempt therefrom and the basis for the alleged exemption. Any violation of Section 7031.5 by any applicant for a permit subjects the applicant to a civil penalty of not more than five hundred dollars (\$500.00);

I, as a owner of the property, or my employees with wages as their sole compensation, will do the work, and the structure is not intended or offered for sale (Sec. 7044, Business and Professional Code: The Contractors License Law does not apply to an owner of property who builds or improves thereon, and who does such work himself or herself or through his/her own employees, provided that such improvements are not intended or offered for sale. If, however, the building or improvement is sold within one year of completion, the owner-builder will have the burden of proving that he/she did not build or improve for the purpose of sale.)

I, as owner of the property, am exclusively contracting with licensed contractors to construct the project (Sec. 7044, Business and Professions Code: The Contractors License Law does not apply to an owner of property who builds or improves thereon, and who contracts for such projects with a contractor(s) licensed pursuant to the Contractors License Law).

I am exempt under Sec. B & PC for this reason:

Date Owner Signature

IN ISSUING THIS BUILDING PERMIT, the applicant represents, and the city relies on the representation of the applicant, that the applicant verified all measurements and locations shown on the application or accompanying drawings and that the improvement to be constructed does not violate any law or private agreement relating to permissible or prohibited locations for such improvements. This building permit does not authorize any illegal location of any improvement or the violation of any private agreement relating to location of improvements.

I certify that I have read this application and state that all information is correct. I agree to comply with all city and county ordinances and state laws relating to building construction and hereby authorize representative(s) of this city to enter upon the above mentioned property for inspection purposes.

Date 5-9-00 Applicant/Agent Signature [Signature]

WORKER'S COMPENSATION DECLARATION: I hereby affirm under penalty of perjury one of the following declarations:

I have and will maintain a certificate of consent to self-insure for workers' compensation as provided for by Section 3700 of the Labor Code, for the performance of work for which the permit is issued.

I have and will maintain workers' compensation insurance, as required by Section 3700 of the Labor Code, for the performance of the work for which this permit is issued. My workers' compensation insurance carrier and policy number are:

Carrier CONTINENTAL CAS. INC. Policy Number WC166792277 Exp Date 6/1/2000

(This section need not be completed if the permit is for \$100 or less) I certify that in the performance of the work for which this permit is issued, I shall not employ any person in any manner so as to become subject to the workers' compensation laws of California and agree that if I should become subject to the workers' compensation provisions of Section 3700 of the Labor Code, I shall forthwith comply with those provisions.

Date 5-9-00 Applicant Signature [Signature]

WARNING: FAILURE TO SECURE WORKER'S COMPENSATION COVERAGE IS UNLAWFUL AND SHALL SUBJECT AN EMPLOYER TO CRIMINAL PENALTIES AND CIVIL FINES UP TO ONE HUNDRED THOUSAND DOLLARS (\$100,000) IN ADDITION TO THE COST OF COMPENSATION, DAMAGES AS PROVIDED FOR IN SECTION 3706 OF THE LABOR CODE, INTEREST AND ATTORNEY'S FEE.

THIS PERMIT SHALL EXPIRE BY LIMITATION IF WORK IS NOT COMMENCED WITHIN 180 DAYS.

This Plot Plan is for the purpose of showing the house to be constructed on the lot and may not represent the final as-built configuration of the property or improvements thereon. Setbacks, other than minimum ordinance, are approximate only and must not be assumed to be precise.

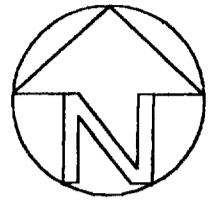

SCALE: 1" = 20'

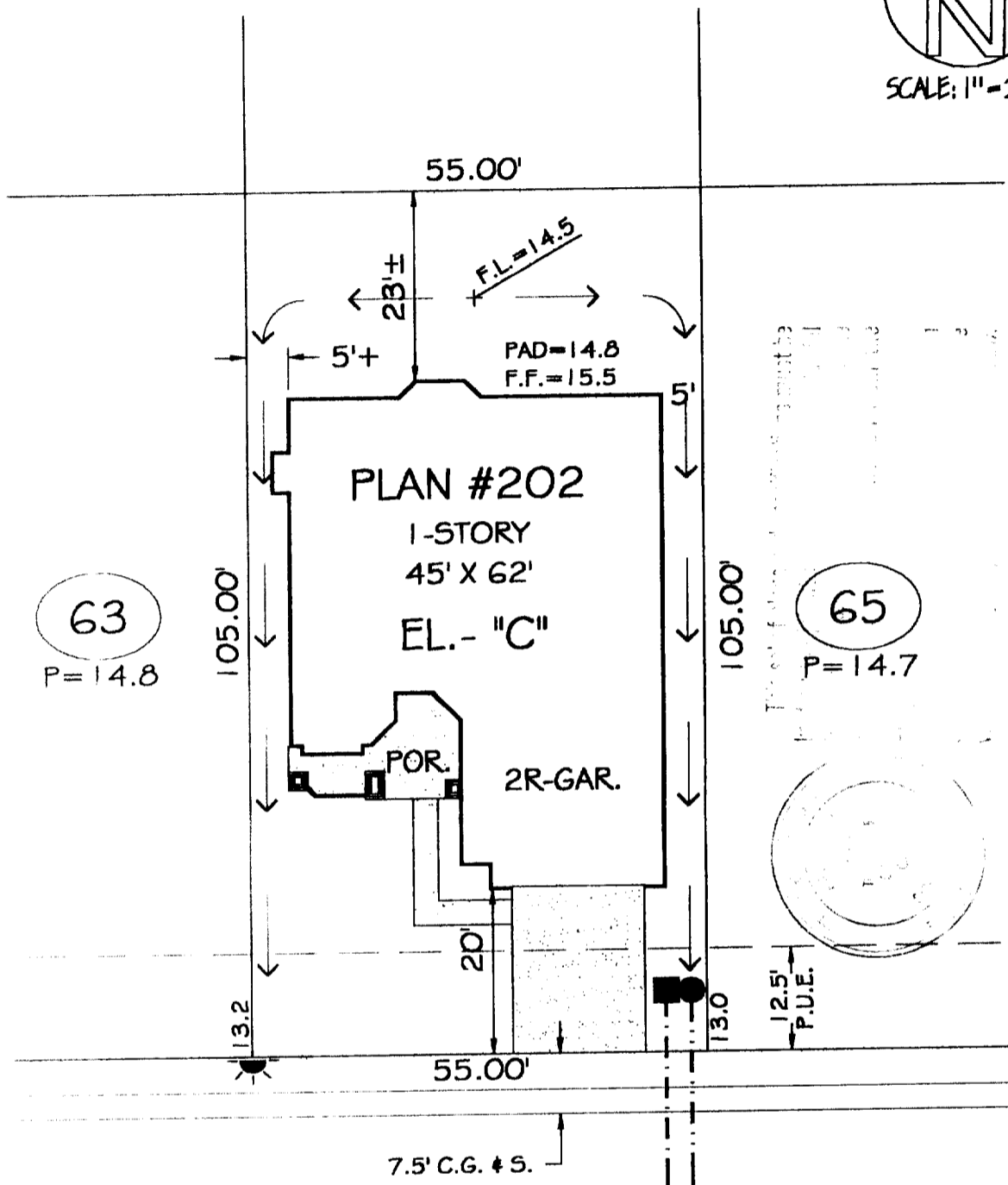

1511 EDGEMORE AVENUE

<p>LOT COVERAGE</p> <p>Lot Area: <u>5775</u> s.f. Building: <u>2299</u> s.f. Building/ Lot Area: <u>40</u> %</p>	<p>RETAINING WALL</p> <p>Height: _____ Length: _____ Distance From P.L.: _____</p>	<p>SYMBOLS</p> <p>Drainage Inlet: </p> <p>Fire Hydrant: </p> <p>Street Light: </p> <p>Sewer: </p> <p>Sign: </p> <p>Water: </p> <p>Transformer Pad: </p>	<p>Winncrest Homes</p>									
<p>NOTES</p> <p>1. MEASUREMENTS ALONG CURVED LINES ARE ARC LENGTHS, U.O.N.</p>		<p>Glenmere a Northpointe Park Village Community</p>										
<table border="1" style="width: 100%; border-collapse: collapse;"> <tr> <td style="width: 25%;">BCB</td> <td style="width: 25%;">2/22/00</td> <td style="width: 25%;">GRS</td> <td style="width: 25%;"></td> </tr> <tr> <td>DRAWN BY</td> <td>DATE</td> <td>CHK'D BY</td> <td>DATE</td> </tr> </table>		BCB	2/22/00	GRS		DRAWN BY	DATE	CHK'D BY	DATE	<p>1" = 20' DRWG SCALE</p>		<p>Home Site #64 @ NORTHPOINTE PARK VILLAGE No. 14 CITY OF SACRAMENTO, CALIFORNIA A.P.N.: 225-112-064-000</p>
BCB	2/22/00	GRS										
DRAWN BY	DATE	CHK'D BY	DATE									

RESIDENTIAL BUILDING PERMIT APPLICATION

New Construction Addition Remodels Other

Project Address: 1511 EDGE MORE AVENUE Assessor Parcel # 225-112-064

OWNER INFORMATION:

Legal Property Owner: LENNAR RENAISSANCE Phone # (916)773-7471
Owner Address: 2240 DOUGLAS BLVD. City ROSEVILLE State CA Zip 95661

CONTRACTOR INFORMATION:

Contractor: LENNAR RENAISSANCE Lic. # 732348 Phone # (916)773-747 Fax# (916)773-4086

PROJECT INFORMATION:

Land Use Zone RA Occupancy Group R3 Construction Type VN Fed Code IA
No. of stories: 1 No. of rooms: _____ Street width: 40 FT
1st Floor Area 1803 2nd Floor Area _____ Basement N.A. Roof Material TILE

AREA IN SQUARE FOOT OF:

	EXISTING	NEW
Dwelling/Living	<u>N/A</u>	<u>1803</u>
Garage/Storage	_____	<u>496</u>
Decks/Balconies	_____	<u>150</u>
Carports	_____	_____

SCOPE OF WORK: NEW CONSTRUCTION SFD

FOR OFFICE USE ONLY:

Information above complete AR Flood Waiver required Planning Approval
 Violation files checked Flood Elevation Certificate Required Design Review Approval
 Standard setbacks Water Development Infill Area Special Fee Districts Apply : _____
 County Sewer

NEW STRUCTURES & ADDITIONS

❖ THE FOLLOWING MUST BE PROVIDED IN ORDER TO SUBMIT FOR PLAN REVIEW

- 2 COMPLETE PLANS, LEGIBLE & DRAWN TO SCALE ❖ Plans to include: site plan, floor plan, elevations, roof/ceiling plan, foundation and structural framing details, and structural calculations for non-conforming structures.
- 3 SETS IF PROJECT IS IN A DESIGN REVIEW AREA
- Title 24 Energy Compliance documentation 11" x 17" copy of floor plan for County Assessor
- Grading and Erosion Control Questionnaire Plan Review Fees

Date: _____ Received by: (staff) _____

ACTIVITY/PERMIT #

COUNTY SANITATION DISTRICT NO. 1
 SACRAMENTO REGIONAL COUNTY SANITATION DISTRICT

SEWER IMPACT FEE ¹⁻²⁷⁻⁰⁰

PERMIT AND CALCULATION SHEET

APPLICATION NO: _____ BLDG PERMIT NO: **CITY**

GENERAL INFORMATION

THIS PERMIT GOOD ONLY WHEN
 VALIDATED BY THE CASHIER

238939

THIS PERMIT TO CONNECT EXPIRES
 ONE YEAR FROM DATE OF ISSUANCE

FEE CALCULATION

BUILDING USE

INSPECTION	
CSD-1	473
SRCSO	2404
CONSTRUCTION	
IN-LIEU	

RESIDENTIAL	SF <input checked="" type="checkbox"/>	MF <input type="checkbox"/>
COMMERCIAL USE		UNITS

TOTAL FEE 2877

APN: **225-112-064**

DESCRIPTION/SUBDIVISION **NORTHPOINTE PARK 14** LOT: **64**

PROPERTY ADDRESS **1511 EDGEMORE AVENUE**

OWNER **LENNAR RENAISSANCE**

MAILING ADDRESS **2240 DOUGLAS BLVD**

CITY-STATE-ZIP **ROSEVILLE CA 95661** PHONE **773-7471**

ADDITIONAL FEES MAY BE DUE IF CHANGES IN USE INCREASE SEWER IMPACT.

APPLICANT SIGNATURE 

CONSOLIDATED UTILITY BILLING USE ONLY

ACCT _____ INPUT _____ START _____

INSPECTOR'S COPY

Natomas Unified School District
 1515 Sports Drive, #1 • Sacramento, CA 95834-1905
 Phone 916/641-3300 • Fax 916/928-1629

SCHOOL DISTRICT DEVELOPMENT FEES

Property Owner's Name LENNAR RENAISSANCE	
Owner's Address 2240 DOUGLAS BLVD ROSEVILLE CA 95661	
Project Address 1500-1561-1511- EDGEMORE AVE	
Parcel Number 225-112-050-059-06A LOT 50/59/64	
Subdivision Name NORTH POINTE PARK UNIT 14	
Number of Units THREE (3)	
Print Applicant's Name DOUGLAS A. HORRELL	Applicant's Signature <i>[Signature]</i>
Title of Applicant PROCESSOR	
Date 3-11-00	Telephone Number 7737471
Plan Identification Number 000277SR, 0002776B, 0002777R	
Building Type (Check One)	
<input checked="" type="checkbox"/> Residential	<input type="checkbox"/> Apartment/Condominium
	<input type="checkbox"/> Commercial/Industrial
Square Feet of Chargeable Building Area 1803 X 3	
Signature _____	
Title _____	Date _____
District Certification Number 00: 1135-1137	
Fees Collected:	
Residential: 5409 Sq. Ft. X \$ 3.25	= \$ 17,579.25 17,579.25
Apartment/Condominium:	Sq. Ft. X \$ = \$
Commercial/Industrial:	Sq. Ft. X \$ = \$
NOTICE TO APPLICANT: Pursuant to government code section 66020 (d), this will serve to notify you that the 90-day approval period in which you may protest the fees, or other payment identified above, will begin to run on the date in which the building or installation permit for this project is issued, or on which they are paid to the District, or to another public entity authorized to collect them on behalf of the District, whichever is earlier.	
Applicant Signature: <i>[Signature]</i>	Date: 3-11-00

This certification covers only the amount of square footage indicated above. Any additions or corrections to the square footage for this project will require an amendment to the Certificate of Compliance.

As the authorized Natomas Unified School District official, I hereby certify that the requirements of Government Code Section 66020 have been complied with by the above signed applicant.

 TITLE: _____ DATE: **3/11/00**

CERTIFICATION OF INSULATION

PART I GENERAL

PART II AREAS INSULATED

PART III

ADDRESS OR TRACT <div style="font-size: 2em; font-family: cursive;">WINNCREST</div> <div style="font-size: 2em; font-family: cursive;">GLENMERE</div>	SACRAMENTO INSULATION CONTRACTORS <input checked="" type="checkbox"/> P.O. BOX 854, WEST SACRAMENTO, CA 95691 LIC. #202026 <input type="checkbox"/> 1309 MELODY ROAD, MARYSVILLE, CA 95901 LIC #202026 <input type="checkbox"/> P.O. BOX 9651, FRESNO, CA 93793-9651 LIC. #202026 <input type="checkbox"/> P.O. BOX 1631, RENO, NV 89505 LIC. #10675 <input type="checkbox"/> 3326 A PONDEROSA WAY, LAS VEGAS, NV 89118 LIC. #10675 DATE INSULATION COMPLETED
--	---

WALLS		CEILINGS			FLOORS	
SQUARE FEET)		SQUARE FEET)			(SQUARE FEET)	
TYPE OF INSULATION		TYPE OF INSULATION			TYPE OF INSULATION	
MATERIAL FIBERGLASS		MATERIAL FIBERGLASS			MATERIAL FIBERGLASS	
FORM BATTS		FORM BATTS & BLOW			FORM BATTS	
MANUFACTURER'S PRODUCT I D		MANUFACTURER'S PRODUCT I D			MANUFACTURER'S PRODUCT I D	
MANUFACTURER		MANUFACTURER			MANUFACTURER	
OCF		OCF			OCF	
R - VALUE INSTALLED	APPLIED THICKNESS	R - VALUE INSTALLED	APPLIED THICKNESS	MIN. INSTALLED WEIGHT PER SQUARE FOOT	R - VALUE INSTALLED	APPLIED THICKNESS
13	3 5/8"	3 3/8" 3 3/8"	12 1/4" 14 3/4"			
KNEE WALLS IF R-VALUE IS OTHER THAN WALLS ABOVE						
MATERIAL FIBERGLASS		FORM BATTS		R VALUE 19	MANUFACTURER OCF	
AIR INFILTRATION SEALANT						
MATERIAL FOAM				MANUFACTURER W R GRACE		

THIS IS TO CERTIFY THAT INSULATION AND/OR SEALANT HAS BEEN INSTALLED IN CONFORMANCE WITH APPLICABLE CODES, MATERIAL STANDARDS AND REGULATIONS.

SIGNATURE - INSULATION CONTRACTOR <div style="font-size: 1.5em; font-family: cursive;">Bill Swartz</div>	TITLE MANAGER	DATE 10-16-00
SIGNATURE - GENERAL CONTRACTOR	TITLE	DATE

REMARKS