

CITY OF SACRAMENTO
1231 I Street, Sacramento, CA 95814

Permit No: 0107394
Insp Area: 4

Site Address: 41 PINNACLES CR SAC
Parcel No: 225-1470-046 NORTHPT PK 6 LOT 46

Sub-Type: NSFR
Housing (Y/N): N

CONTRACTOR
WESTERN PACIFIC HOUSING
1210 CENTRAL BLVD
BRENTWOOD CA. 94513

OWNER

ARCHITECT

Nature of Work: NSFR MP2092/OPT 2 STORY 10 RMS

CONSTRUCTION LENDING AGENCY : I hereby affirm under penalty of perjury that there is a construction lending agency for the performance of the work for which this permit is issued (Sec. 3097, Civ. C.)

Lender's Name _____ Lender's Address _____

LICENSED CONTRACTORS DECLARATION: I hereby affirm under penalty of perjury that I am licensed under provisions of Chapter 9 (commencing with section 7000) of Division 3 of the Business and Professions Code and my license is in full force and effect.

License Class B License Number 675709 Date 6/15/01 Contractor Signature [Signature]

OWNER-BUILDER DECLARATION: I hereby affirm under penalty of perjury that I am exempt from the contractors License Law for the following reason (Sec. 7031.5, Business and Professions Code: any city or county which requires a permit to construct, alter, improve, demolish, or repair any structure, prior to its issuance, also requires the applicant for such permit to file a signed statement that he or she is licensed pursuant to the provisions of the Contractors License Law (Chapter 9 (commencing with Section 7000) of Division 8 of the Business and Professions Code) or that he or she is exempt therefrom and the basis for the alleged exemption: Any violation of Section 7031.5 by any applicant for a permit subjects the applicant to a civil penalty of not more than five hundred dollars (\$500.00).

I, as a owner of the property, or my employees with wages as their sole compensation, will do the work, and the structure is not intended or offered for sale (Sec. 7044, Business and Professional Code: The Contractors License Law does not apply to an owner of property who builds or improves thereon, and who does such work himself or herself or through his/her own employees, provided that such improvements are not intended or offered for sale. If, however, the building or improvement is sold within one year of completion, the owner-builder will have the burden of proving that he/she did not build or improve for the purpose of sale.)

I, as owner of the property, am exclusively contracting with licensed contractors to construct the project (Sec. 7044, Business and Professions Code: The Contractors License Law does not apply to an owner of property who builds or improves thereon, and who contracts for such projects with a contractor(s) licensed pursuant to the Contractors License Law).

I am exempt under Sec. _____ B & PC for this reason _____

Date _____ Owner Signature _____

RECORDS, PLANNING
PERMITTING SERVICES

IN ISSUING THIS BUILDING PERMIT, the applicant represents, and the city relies on the representation of the applicant, that the applicant verified all measurements and locations shown on the application or accompanying drawings and that the improvement to be constructed does not violate any law or private agreement relating to permissible or prohibited locations for such improvements. This building permit does not authorize any illegal location of any improvement or the violation of any private agreement relating to location of improvements.

I certify that I have read this application and state that all information is correct. I agree to comply with all city and county ordinances and state laws relating to building construction and hereby authorize representative(s) of this city to enter upon the abovementioned property for inspection purposes.

Date 6/15/01 Applicant/Agent Signature [Signature]

WORKER'S COMPENSATION DECLARATION: I hereby affirm under penalty of perjury one of the following declarations:

I have and will maintain a certificate of consent to self-insure for workers' compensation as provided for by Section 3700 of the Labor Code, for the performance of work for which the permit is issued

I have and will maintain workers' compensation insurance, as required by Section 3700 of the Labor Code, for the performance of the work for which this permit is issued. My workers' compensation insurance carrier and policy number are:

Carrier EAGLE INS. CO. Policy Number 4S-0000273 Exp Date 03/19/2001

(This section need not be completed if the permit is for \$100 or less) I certify that in the performance of the work for which this permit is issued, I shall not employ any person in any manner so as to become subject to the workers' compensation laws of California and agree that if I should become subject to the workers' compensation provisions of Section 3700 of the Labor Code, I shall forthwith comply with those provisions.

Date 6/15/01 Applicant Signature [Signature]

WARNING: FAILURE TO SECURE WORKER'S COMPENSATION COVERAGE IS UNLAWFUL AND SHALL SUBJECT AN EMPLOYER TO CRIMINAL PENALTIES AND CIVIL FINES UP TO ONE HUNDRED THOUSAND DOLLARS (\$100,000) IN ADDITION TO THE COST OF COMPENSATION. DAMAGES AS PROVIDED FOR IN SECTION 3706 OF THE LABOR CODE, INTEREST AND ATTORNEY'S FEE.

THIS PERMIT SHALL EXPIRE BY LIMITATION IF WORK IS NOT COMMENCED WITHIN 180 DAYS.

Project Address: 41 Pinnacles Circle
Lot Number: 46

Assessor Parcel # 225-1470-046
Subdivision Northpointe Park Unit # 6

OWNER INFORMATION:

Legal Property Owner: Western Pacific Housing Phone# (925) 634-6023
Owner Address: 1210 Central Boulevard, City Brentwood, State Ca. Zip 94513

CONTRACTOR INFORMATION:

Contractor: Western Pacific License# 075709/B Phone # (925) 634-6023 Fax 634-6166

PROJECT INFORMATION:

Land Use Zone RIA Occupancy Group R3 Construction Type VN Fed Code 1A
No. of Stories: 2 No. of Rooms: _____ Street Width: _____
1st Floor Area _____ 2nd Floor Area _____ Basement _____ Roof Material _____

AREA IN SQUARE FOOT OF:

Dwelling/Living 2300 2294
Garage/Storage 427 422
Decks/Balconies _____ 63
Carports _____

SCOPE OF WORK: _____

- Information Above Complete
- Violation Files Checked
- Standard Setbacks
- County Sewer
- AR Flood Waiver Required
- Flood Elevation Certificate Required
- Water Development Infill Area
- Planning Approval
- Design Review Approval
- Special Fee Districts Apply:

~THE FOLLOWING MUST BE PROVIDED IN ORDER TO SUBMIT FOR PERMIT~

- 2 COMPLETE PLOT PLANS, LEGIBLE & DRAWN TO SCALE
- 11 X 17 COPY OF FLOOR PLAN WITH FOLLOWING INFORMATION
 - a) Assessor's Parcel Number
 - b) New Floor Area
 - c) Owners Name
 - d) Project Address

Date: _____

Received by: (initials) _____

Permit # _____

CERTIFICATION OF INSULATION

<p style="font-size: 2em; font-family: cursive;">Western Pacific</p> <p style="font-size: 2em; font-family: cursive;">Sienna</p>	<p>LOT # 440</p>	<p><input checked="" type="checkbox"/> P.O. BOX 254, WEST SACRAMENTO, CA 95691 LIC. #202026</p> <p><input type="checkbox"/> 1399 MELODY ROAD, MARYSVILLE, CA 95901 LIC. #202026</p> <p><input type="checkbox"/> P.O. BOX 9651, FRESNO, CA 93793-9651 LIC. #202026</p> <p><input type="checkbox"/> P.O. BOX 1631, RENO, NV 89505 LIC. #10675</p> <p><input type="checkbox"/> 3326 A PONDEROSA WAY, LAS VEGAS, NV 89118 LIC. #10675</p>
<p>DATE INSULATION COMPLETED 10/1/01</p>		

SQUARE FEET)		SQUARE FEET)		SQUARE FEET)	
MATERIAL FIBERGLASS		MATERIAL FIBERGLASS		MATERIAL FIBERGLASS	
FORM BATTS		FORM BATTS & BLOW		FORM BATTS	
MANUFACTURER'S PRODUCT I.D.		MANUFACTURER'S PRODUCT I.D.		MANUFACTURER'S PRODUCT I.D.	
OCF		OCF		OCF	
R-VALUE		APPLIED		R-VALUE	
APPLIED		R-VALUE		APPLIED	
MATERIAL		FORM		R-VALUE	
MATERIAL		MANUFACTURER		R-VALUE	

13	35 1/2"	30	30	9'	12'		
MATERIAL FIBERGLASS		FORM BATTS		R-VALUE		MANUFACTURER OCF	
MATERIAL FOAM				MANUFACTURER W R GRACE			

SIGNATURE - INSULATION CONTRACTOR <i>[Signature]</i>	TITLE MANAGER	DATE 9-5-01
SIGNATURE - GENERAL CONTRACTOR	TITLE	DATE
REMARKS		



BASALITE®
 PACIFIC STUCCO SYSTEMS

4290 Roseville Road
 North Highlands, CA 95660-5710
 (916) 486-4094
 Fax (916) 486-4187

Installation Card
 Fiber Reinforced Stucco

Job Name and Address : WESTERN PACIFIC
SIENA

ICBO# 5269

9-07-01
 Date of job completion
LOT-46

Plastering Contractor

Name: VISION PLASTERING

Address: 8974 GREEN BAY LN

Telephone No. () 987 3324

Approved contractor as issued by Basalite/Pacific Stucco

This is to certify the exterior coating system at the above address, has been installed in accordance with the evaluation report specified above and the manufacturers instructions.

[Signature]
 Signature of authorized representative of
 plastering contractor

9-28-01
 Date

This installation card must be presented to the building inspector after completion of work and before final inspection.



CAPITOL ENGINEERING LABORATORIES, INC.

631 Commerce Drive, Suite #200 • Roseville, California 95678 • (916) 786-2488

JOB REPORT

PAGE: 1

PROJECT NAME: Siena FILE NO. 5317

INSPECTOR: [Signature] DATE: 7-31-01

PERSONS CONTACTED: [Signature] PERMIT #:

REFERENCE DOCUMENTS: Test Report #4745 WEATHER: Sunny

SERVICE PROVIDED: CONCRETE (INSP / SAMPLE ONLY / PU) MASONRY WELDING (SHOP / FIELD) SOILS

OTHER Proof load Epoxy anchors

Lot #46 proof loaded one 5/8" Epoxy anchor bolts (615 lbs)
Test #4745 without measurement

Lot #47 proof loaded two 5/8" Epoxy anchors to (615 lbs)
Test #4745 without measurement

Lot #49 proof loaded two 5/8" Epoxy anchors to (615 lbs)
Test #4745 without measurement

COMPLIANCE OF WORK: Acceptable

ATTACHMENTS:

EQUIPMENT/SUPPLIES USED: Hydraulics

NEXT VISIT:

REMARKS:

REVIEWED BY: [Signature] DATE: 7-31-01

→ SWALE
 □ MAILBOX

* WOOD FENCE
 ○ SIDEYARD GATE

LEGEND

SS SEWER SERVICE
 WS WATER SERVICE

□ UTILITY SERVICE
 F.F. FINISH FLOOR

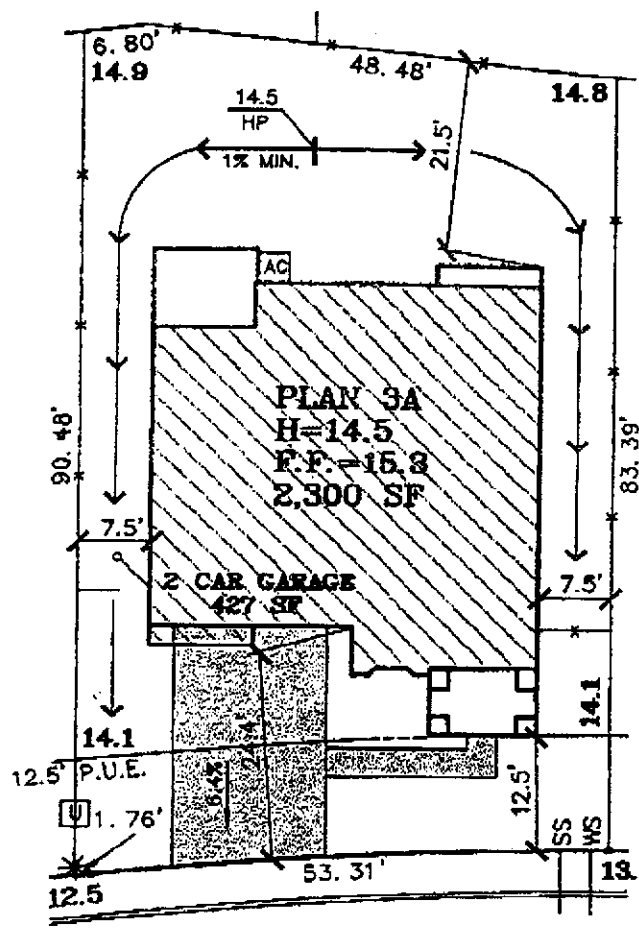

PINNACLES CIRCLE

LOT 46
 PLAN 3A
 A.P.N.:
 ADDRESS: 41 PINNACLES CIRCLE
 LOT AREA: 4,788 SF

DUE TO THE UNIQUE CONDITIONS OF THIS LOT, THE BUYER HAS WALKED AND APPROVED THE SITE. FINAL GRADING CONDITIONS MAY VARY. THE INFORMATION ON THIS PLOT PLAN IS PROVIDED FOR YOUR CONVENIENCE AS A GUIDE TO THE GENERAL LOCATION OF THE SUBJECT PROPERTY. THE ACCURACY OF THIS PLOT PLAN IS NOT GUARANTEED NOR IS IT A PART OF ANY POLICY, REPORT OR GUARANTEE TO WHICH IT MAY BE ATTACHED. ACTUAL DIMENSIONS MAY VARY OR CHANGE WITHOUT PRIOR NOTICE DUE TO ACTUAL SITE CONDITIONS.

PLAN: 3
 ELEVATION: A
 ORIENTATION: L
 COLOR: 172

SIGNED (BUYER) _____ DATE _____

The Splink Corporation
 2590 VENTURE OAKS WAY
 SACRAMENTO, CA 95833
 PH: (916) 925-5550 FAX: (916) 921-9274

 **Western Pacific Housing**
 1210 Central Boulevard
 Brentwood, CA 94513
 office: (925) 634-6023
 fax: (925) 634-6063

SIENA
 NORTHPOINTE PARK UNIT 6
 City of Sacramento, California
 Scale: 1"=20' April 20, 2001

9026-159/APS/S/148

May. 15 2001 08:33AM P13

PHONE NO. : 916 991 1200

FROM : D.C.C.C.S.