

CITY OF SACRAMENTO  
1231 I Street, Sacramento, CA 95814

Permit No: 0104019

Insp Area: 4

Site Address: 3344 CALLA LILY WY SAC  
Parcel No: 274-0500-059 NATOMAS W 2 LOT 19

Sub-Type: NSFR  
Housing (Y/N): N

CONTRACTOR  
KAUFMAN AND BROAD  
511 ORANGE DR  
VACAVILLE CA 95687

OWNER

ARCHITECT

Nature of Work: NSFR MP1706 8 RMS 1 STORY

**CONSTRUCTION LENDING AGENCY** : I hereby affirm under penalty of perjury that there is a construction lending agency for the performance of the work for which this permit is issued (Sec. 3097, Civ. C.)

Lender's Name \_\_\_\_\_ Lender's Address \_\_\_\_\_

**LICENSED CONTRACTORS DECLARATION**: I hereby affirm under penalty of perjury that I am licensed under provisions of Chapter 9 (commencing with section 7000) of Division 3 of the Business and Professions Code and my license is in full force and effect.

License Class B License Number 761976 Date 4-09-01 Contractor Signature [Signature]

**OWNER-BUILDER DECLARATION**: I hereby affirm under penalty of perjury that I am exempt from the contractors License Law for the following reason (Sec. 7031.5, Business and Professions Code: any city or county which requires a permit to construct, alter, improve, demolish, or repair any structure, prior to its issuance, also requires the applicant for such permit to file a signed statement that he or she is licensed pursuant to the provisions of the Contractors License Law (Chapter 9 commencing with Section 7000) of Division 8 of the Business and Professions Code) or that he or she is exempt therefrom and the basis for the alleged exemption: Any violation of Section 7031.5 by any applicant for a permit subjects the applicant to a civil penalty of not more than five hundred dollars (\$500.00).

I, as a owner of the property, or my employees with wages as their sole compensation, will do the work, and the structure is not intended or offered for sale (Sec. 7044, Business and Professional Code). The Contractors License Law does not apply to an owner of property who builds or improves thereon, and who does such work himself or herself or through his/her own employees, provided that such improvements are not intended or offered for sale. If, however, the building or improvement is sold within one year of completion, the owner-builder will have the burden of proving that he/she did not build or improve for the purpose of sale.

I, as owner of the property, am exclusively contracting with licensed contractors to construct the project (Sec. 7044, Business and Professions Code). The Contractors License Law does not apply to an owner of property who builds or improves thereon, and who contracts for such projects with a contractor(s) licensed pursuant to the Contractors License Law.

I am exempt under Sec. \_\_\_\_\_ B & PC for this reason: PAID

Date \_\_\_\_\_ Owner Signature [Signature]

**IN ISSUING THIS BUILDING PERMIT**, the applicant represents, and the city relies on the representation of the applicant, that the applicant verified all measurements and locations shown on the application or accompanying drawings and that the improvements to be constructed does not violate any law or private agreement relating to permissible or prohibited locations for such improvements. Building permit does not authorize any illegal location of any improvement or the violation of any private agreement relating to location of improvement.

I certify that I have read this application and state that all information is correct. I agree to comply with all city and county ordinances and state laws relating to building construction and hereby authorize representative(s) of this city to enter upon the abovementioned property for inspection purposes.

Date 4-09-01 Applicant/Agent Signature [Signature]

**WORKER'S COMPENSATION DECLARATION**: I hereby affirm under penalty of perjury one of the following declarations:  
I have and will maintain a certificate of consent to self-insure for workers' compensation as provided for by Section 3700 of the Labor Code, for the performance of work for which the permit is issued.

I have and will maintain workers' compensation insurance, as required by Section 3700 of the Labor Code, for the performance of the work for which this permit is issued. My workers' compensation insurance carrier and policy number are:

Carrier: CONTINENTAL CAS CO Policy Number: WC188899094 Exp Date: 05/01/2000

(This section need not be completed if the permit is for \$100 or less) I certify that in the performance of the work for which this permit is issued, I shall not employ any person in any manner so as to become subject to the workers' compensation laws of California and agree that if I should become subject to the workers' compensation provisions of Section 3700 of the Labor Code, I shall forthwith comply with those provisions.

Date 4-09-01 Applicant Signature [Signature]

**WARNING**. FAILURE TO SECURE WORKER'S COMPENSATION COVERAGE IS UNLAWFUL AND SHALL SUBJECT AN EMPLOYER TO CRIMINAL PENALTIES AND CIVIL FINES UP TO ONE HUNDRED THOUSAND DOLLARS (\$100,000) IN ADDITION TO THE COST OF COMPENSATION, DAMAGES AS PROVIDED FOR IN SECTION 3706 OF THE LABOR CODE, INTEREST AND ATTORNEY'S FEE.

**THIS PERMIT SHALL EXPIRE BY LIMITATION IF WORK IS NOT COMMENCED WITHIN 180 DAYS.**

RESIDENTIAL SUBDIVISION BUILDING PERMIT APPLICATION

Project Address: 3344 Calla Lily Way Assessor Parcel # 274-0500-059  
Lot Number: 19 Subdivision Natomas West Village 1

OWNER INFORMATION:

KBNW1706

Legal Property Owner: KB Home Phone# 707-469-2464  
Owner Address: 611 Orange dr City Vacaville State CA Zip 95687

CONTRACTOR INFORMATION:

Contractor: KB Home Lic. # 761970 Phone # 707-469-2464 Fax 469-2405

PROJECT INFORMATION:

Land Use Zone RIA Occupancy Group R3 Construction Type VN Fed Code 1A

No. of Stories: 1 No. of Rooms: \_\_\_\_\_ Street Width: \_\_\_\_\_

1<sup>st</sup> Floor Area 1700 2<sup>nd</sup> Floor Area \_\_\_\_\_ Basement \_\_\_\_\_ Roof Material \_\_\_\_\_

AREA IN SQUARE FOOT OF:

Dwelling/Living 1700  
Garage/Storage 433  
~~Decks/Balconies~~ Porch 78  
Carports \_\_\_\_\_

SCOPE OF WORK: New Single Family Dwelling

FOR OFFICE USE ONLY

- Information Above Complete
- Violation Files Checked
- Standard Setbacks
- County Sewer
- AR Flood Waiver Required
- Flood Elevation Certificate Required
- Water Development Infill Area
- Planning Approval
- Design Review Approval
- Special Fee Districts Apply: \_\_\_\_\_

THE FOLLOWING MUST BE PROVIDED IN ORDER TO SUBMIT FOR PERMIT

- 2 COMPLETE PLOT PLANS, LEGIBLE & DRAWN TO SCALE
- 11 X 17 COPY OF FLOOR PLAN WITH FOLLOWING INFORMATION
  - a) Assessor's Parcel Number
  - b) New Floor Area
  - c) Owners Name
  - d) Project Address

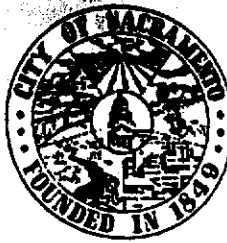

NEIGHBORHOODS, PLANNING,  
AND DEVELOPMENT  
SERVICES DEPARTMENT

**CITY OF SACRAMENTO**  
CALIFORNIA

1231 I STREET  
ROOM 300  
SACRAMENTO, CA  
95814-2998

PLANNING  
916-264-5381  
FAX 916-264-5328

FOR  
FINAL

### MEMORANDUM

Date: December 21, 1998  
To: David Hay, Building Inspector III  
From: Thomas S. Pace, Assistant Planner

**SUBJECT:** Natomas West/California Gardens Plot Plans (P98-020)

I have reviewed the plot plans for Village 1, Lots 29-32, and determined that they comply with the Special Permit conditions and the PUD Guidelines.

For future reference, there are some special conditions which apply to this subdivision relating to reduced front setbacks for porches (12.5') and fronts of houses (15', but garage doors must be at 20'), and lot coverage, which is normally a 40% maximum, (but up to 10% of all lots can have up to 45% coverage, and another 10% of all lots can have up to 50% coverage, and 2 lots with standard 40% coverage or less must separate any lots exceeding 40% coverage). Three street trees are required on corner lots, and one tree each on interior lots, placed 4' from back of walk. Also, certain lots along the freeway must be one-story homes (see attached map).

I am attaching the Special Permit conditions, the PUD Guidelines, and the Mitigation Monitoring Plan. Call me at 264-6848 if you have any questions.

c: P98-020

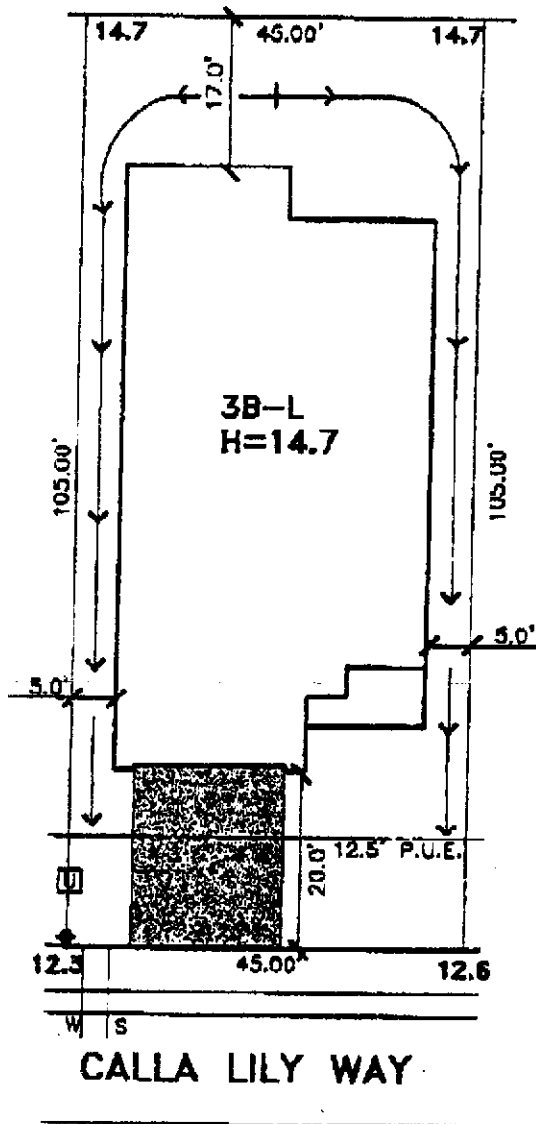

DATE: 3-14-01  
 A.P.N.: 274-0500-059  
 ADDRESS: 3344 CALLA LILY WAY

LOT AREA: 4,725 SF  
 LOT COVERAGE: 47%

**The Spink Corporation**  
 2590 VENTURE OAKS WAY  
 SACRAMENTO, CA. 95833  
 PH (916)925-5550 FAX (916)921-9274

**NATOMAS WEST VILLAGE 2**  
 LOT 19  
 PLAN 3B

**CALIFORNIA GARDENS**  
 45%  
 CITY OF SACRAMENTO, CA  
 CLIENT: KAUFMAN & BROAD