

CITY OF SACRAMENTO

Permit No: 0109625

1231 I Street, Sacramento, CA 95814

Insp Area: 4

Site Address: 12 CASWELL CT SAC

Sub-Type: NSFR

Parcel No: 226-0410-002

MOONEY ESTATES LOT 2

Housing (Y/N): N

CONTRACTOR

OWNER

ARCHITECT

RIVERLAND HOMES
530 B ST STE. 1720
SAN DIEGO CA. 92101

Nature of Work: MP 1822 1 STORY 8 ROOM SFR

CONSTRUCTION LENDING AGENCY: I hereby affirm under penalty of perjury that there is a construction lending agency for the performance of the work for which this permit is issued (Sec. 3097, Civ. C).

Lender's Name Lender's Address

LICENSED CONTRACTORS DECLARATION: I hereby affirm under penalty of perjury that I am licensed under provisions of Chapter 9 (commencing with section 7000) of Division 3 of the Business and Professions Code and my license is in full force and effect.

License Class License Number 783707 Date 8-15-01 Contractor Signature

OWNER-BUILDER DECLARATION: I hereby affirm under penalty of perjury that I am exempt from the contractors License Law for the following reason (Sec. 7031.5, Business and Professions Code; any city or county which requires a permit to construct, alter, improve, demolish, or repair any structure, prior to its issuance, also requires the applicant for such permit to file a signed statement that he or she is licensed pursuant to the provisions of the Contractors License Law (Chapter 9 (commencing with Section 7000) of Division 8 of the Business and Professions Code) or that he or she is exempt therefrom and the basis for the alleged exemption. Any violation of Section 7031.5 by any applicant for a permit subjects the applicant to a civil penalty of not more than five hundred dollars (\$500.00);

I, as a owner of the property, or my employees with wages as their sole compensation, will do the work, and the structure is not intended or offered for sale (Sec. 7044, Business and Professional Code: The Contractors License Law does not apply to an owner of property who builds or improves thereon, and who does such work himself or herself or through his/her own employees, provided that such improvements are not intended or offered for sale. If, however, the building or improvement is sold within one year of completion, the owner-builder will have the burden of proving that he/she did not build or improve for the purpose of sale.)

I, as owner of the property, am exclusively contracting with licensed contractors to construct the project (Sec. 7044, Business and Professions Code: The Contractors License Law does not apply to an owner of property who builds or improves thereon, and who contracts for such projects with a contractor(s) licensed pursuant to the Contractors License Law).

I am exempt under Sec. B & PC for this reason:

Date Owner Signature

IN ISSUING THIS BUILDING PERMIT, the applicant represents, and the city relies on the representation of the applicant, that the applicant verified all measurements and locations shown on the application or accompanying drawings and that the improvement to be constructed does not violate any law or private agreement relating to permissible or prohibited locations for such improvements. This building permit does not authorize any illegal location of any improvement or the violation of any private agreement relating to location of improvements.

I certify that I have read this application and state that all information is correct. I agree to comply with all city and county ordinances and state laws relating to building construction and hereby authorize representative(s) of this city to enter upon the abovementioned property for inspection purposes.

Date 8-15-01 Applicant/Agent Signature

WORKER'S COMPENSATION DECLARATION: I hereby affirm under penalty of perjury one of the following declarations:

I have and will maintain a certificate of consent to self-insure for workers' compensation as provided for by Section 3700 of the Labor Code, for the performance of work for which the permit is issued.

I have and will maintain workers' compensation insurance as required by Section 3700 of the Labor Code, for the performance of the work for which this permit is issued. My workers' compensation insurance carrier and policy number are:

Carrier

Policy Number

Exp Date

(This section need not be completed if the permit is for \$100 or less. If the permit is for more than \$100, I shall not employ any person in any manner so as to become subject to the workers' compensation laws of California and agree that if I should become subject to the workers' compensation provisions of Section 3700 of the Labor Code, I shall forthwith comply with those provisions.

Date 8-15-01 Applicant Signature

WARNING: FAILURE TO SECURE WORKER'S COMPENSATION COVERAGE IS UNLAWFUL AND SHALL SUBJECT AN EMPLOYER TO CRIMINAL PENALTIES AND CIVIL FINES UP TO ONE HUNDRED THOUSAND DOLLARS (\$100,000) IN ADDITION TO THE COST OF COMPENSATION, DAMAGES AS PROVIDED FOR IN SECTION 3706 OF THE LABOR CODE, INTEREST AND ATTORNEY'S FEE.

THIS PERMIT SHALL EXPIRE BY LIMITATION IF WORK IS NOT COMMENCED WITHIN 180 DAYS.

Certification of Compliance

School District Development Fees

PART I To be completed by APPLICANT

Owner's Name & Address Riverwood Homes, Inc.
 Project Address 12 Caswell Ct
 Parcel Number 216 0410 102 Lot No. 2
 Subdivision Name Blaney Number of Units _____
 Applicant's Signature & Title [Signature] President
 Date 8-15-01 Phone No. 916-764-9421

NOTICE TO APPLICANT: Pursuant to Government Code Section 66020(d), this will serve to notify you that the 90-day approval period in which you may protest the fees or other payment identified above will begin to run on the date in which the building or installation permit for this project is issued or on which they are paid to the district(s) or to another public entity authorized to collect them on behalf of the district(s), whichever is earlier.

PART II To be completed by BUILDING DEPARTMENT

Plan Identification Number 041625 B Building Type (CHECK ONE)
 Square Feet of Chargeable Building Area 512 Residential
 Signature [Signature] () Apartment / Condominium
 Title Blde Insp () Commercial / Industrial
 Date 7/30/01

PART III To be completed by SCHOOL DISTRICTS

Grant Joint Union High School District	
District Certification No.	<u>032-02</u>
EXEMPT _____	
Comments _____	
RESIDENTIAL / APARTMENT / CONDOMINIUM	
<u>1822</u> Sq. Ft. X \$ <u>116</u>	= \$ <u>211352</u>
COMMERCIAL / INDUSTRIAL	
_____ Sq. Ft. X \$ _____	= \$ _____
OTHER FEE: TYPE _____	
_____ Sq. Ft. X \$ _____	= \$ _____
TOTAL FEES COLLECTED = \$ <u>211352</u>	

Robla Elementary School District	
District Certification No.	<u>02-004</u>
EXEMPT _____	
Comments _____	
RESIDENTIAL / APARTMENT / CONDOMINIUM	
<u>1822</u> Sq. Ft. X \$ <u>96</u>	= \$ <u>174912</u>
COMMERCIAL / INDUSTRIAL	
_____ Sq. Ft. X \$ _____	= \$ _____
OTHER FEE: TYPE _____	
_____ Sq. Ft. X \$ _____	= \$ _____
TOTAL FEES COLLECTED = \$ <u>174912</u>	

This Certification covers only the amount of square footage indicated above. Any additions or corrections to the square footage for this project will require an amendment to the Certificate of Compliance.

As the authorized school district official, I hereby certify that the requirements of Government Code Section 65995 and any other authorized requirements have been complied with by the above signed applicant.

GRANT	Authorized School District Official	ROBLA
Signature <u>[Signature]</u>	Signature <u>[Signature]</u>	Signature _____
Title <u>Secretary</u>	Title _____	Title _____
Date <u>8-15-01</u>	Date _____	Date _____

Original: Grant Joint Union High School District
 1st Copy: Robla Elementary School District
 2nd Building Department
 3rd Copy: Applicant

INSULATION CERTIFICATE

THIS IS TO CERTIFY THAT INSULATION HAS BEEN INSTALLED IN CONFORMANCE WITH THE CURRENT ENERGY REGULATIONS, CALIFORNIA ADMINISTRATION CODE, TITLE 24, STATE OF CALIFORNIA, IN THE BUILDING LOCATED AT:

SITE ADDRESS: 12 CASWELL COURT SACRAMENTO, CA
STREET CITY STATE

CEILINGS:

BLOW: MANUFACTURER GREENSTONE THICKNESS 10.3" R-VALUE 38
SQUARE FEET 1400 # BAGS/LBS PER BAGS 58

BATTS: MANUFACTURER JOHNS MANVILLE THICKNESS 13" R-VALUE 38
JOHNS MANVILLE

EXTERIOR WALLS:

MANUFACTURER JOHNS MANVILLE THICKNESS 3.5" R-VALUE 13
JOHNS MANVILLE

FLOOR INSULATION:

MANUFACTURER JOHNS MANVILLE THICKNESS N/A R-VALUE N/A

AIR INFILTRATION:

(TITLE 24)

YES XX NO

OTHER: _____

GENERAL CONTRACTOR: RIVERLAND HOMES LICENSE # _____

BY: _____ TITLE _____ DATE _____

INSULATION CONTRACTOR: WESTERN INSULATION LP LICENSE # 784484

BY: Jamie Blair TITLE AUTH. AGENT DATE 12/20/01
JAMIE BLAIR

DIAMOND WALL INSULATING STUCCO SYSTEM

ICBO Report #4004

JOB ADDRESS:

112 Caswell
San Jose

Date of Job Completion 3/4/02

PLASTERING CONTRACTOR:

Name: McCann Plastering, Inc.

Address: 300 California Street, San Jose, CA 95128

Telephone No: (415) 784-2274

Contractor Number of Diamond Wall System # 2264

This is to certify that the exterior coating system on the building exterior at the above address has been installed in accordance with the evaluation report specified above and the manufacturer's instructions.

3/4/02
Date

Jerry Lantieri
Signature of authorized representative of
Plastering Contractor

This installation card must be presented to the building inspector after completion of work and before final inspection.

min setback no less than 15'

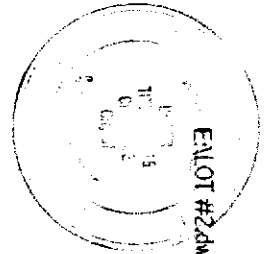

ENLOT #244mg, 06/27/01 02:24 PM S of Cassell Court
 This is a preliminary plan and shall not be used for any other purpose without the approval of the City of San Diego. Violation of any City Ordinance or State Law.

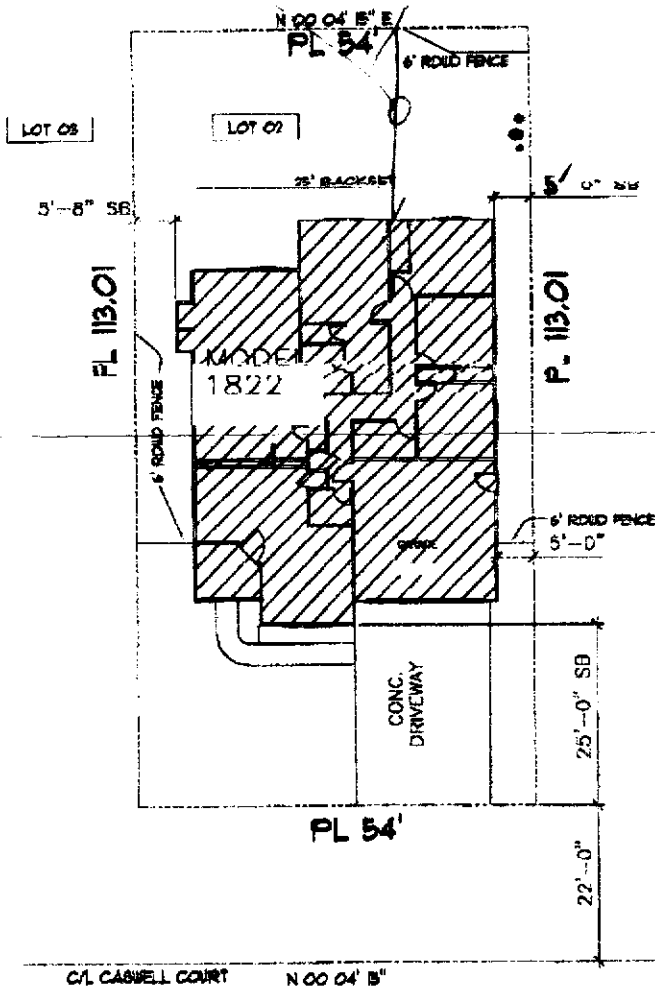

PLOT PLAN LOT 02
 SCALE = 1/40'
 MOONEY ESTATES

PLOT PLAN

DATE: 06/27/01 DRAWN BY: [Signature] CHECKED BY: [Signature]	NEW RESIDENCE LOT #	RIVERLAND HOMES, INC 530 B STREET, SUITE 1720 SAN DIEGO, CA, 92101 619-237-4604	EVERGREEN DEVELOPMENT 309 Suite A CONNORS CT. CHICO, CA, 95926 530-894-5520	SHEET NO. TOTAL SHEETS
		1 1	1 1	1 1