

CITY OF SACRAMENTO
1231 I Street, Sacramento, CA 95814

Permit No: 0102706
Insp Area: 4

Site Address: 2579 MAYBROOK DR SAC
Parcel No: 201-0420-005 NORTHBOROUGH VIL 3-2 LOT 5
N

Sub-Type: NSFR
Housing (Y/N):

CONTRACTOR
US HOME
2366 GOLD MEADOW DR STE 100
GOLD RIVER, CA 95670 77041

OWNER

ARCHITECT

Nature of Work: NSFR MP1725 8 RMS

CONSTRUCTION LENDING AGENCY: I hereby affirm under penalty of perjury that there is a construction lending agency for the performance of the work for which this permit is issued (Sec. 3097, Civ. C.).

Lender's Name _____ Lender's Address _____

LICENSED CONTRACTORS DECLARATION: I hereby affirm under penalty of perjury that I am licensed under provisions of Chapter 9 (commencing with section 7000) of Division 3 of the Business and Professions Code and my license is in full force and effect.

License Class B License Number 45333 Date 3/20/01 Contractor Signature Don McCloskey

OWNER-BUILDER DECLARATION: I hereby affirm under penalty of perjury that I am exempt from the contractors License Law for the following reason (Sec. 7031.5, Business and Professions Code): any city or county which requires a permit to construct, alter, improve, demolish, or repair any structure, prior to its issuance, also requires the applicant for such permit to file a signed statement that he or she is licensed pursuant to the provisions of the Contractors License Law (Chapter 9 (commencing with Section 7000) of Division 8 of the Business and Professions Code) or that he or she is exempt therefrom and the basis for the alleged exemption. Any violation of Section 7031.5 by any applicant for a permit subjects the applicant to a civil penalty of not more than five hundred dollars (\$500.00).

I, as a owner of the property, or my employees with wages as their sole compensation, will do the work, and the structure is not intended or offered for sale (Sec. 7044, Business and Professional Code). The Contractors License Law does not apply to an owner of property who builds or improves thereon, and who does such work himself or herself or through his/her own employees, provided that such improvements are not intended or offered for sale. If, however, the building or improvement is sold within one year of completion, the owner-builder will have the burden of proving that he/she did not build or improve for the purpose of sale.

I, as owner of the property, am exclusively contracting with licensed contractors to construct the project (Sec. 7044, Business and Professions Code). The Contractors License Law does not apply to an owner of property who builds or improves thereon, and who contracts for such projects with a contractor(s) licensed pursuant to the Contractors License Law.

I am exempt under Sec. _____ B & P for this reason _____

Date _____ Owner Signature _____

IN ISSUING THIS BUILDING PERMIT, the applicant represents, and the city relies on the representation of the applicant, that the applicant verified all measurements and locations shown on the application or accompanying drawings and that the improvement to be constructed does not violate any law or private agreement relating to permissible or prohibited locations for such improvements. This building permit does not authorize any illegal location of any improvement or the violation of any private agreement relating to location of improvements.

I certify that I have read this application and state that all information is correct. I agree to comply with all city and county ordinances and state laws relating to building construction and hereby authorize representative(s) of this city to enter upon the abovementioned property for inspection purposes.

Date 3/20/01 Applicant/Agent Signature Don McCloskey

WORKER'S COMPENSATION DECLARATION: I hereby affirm under penalty of perjury one of the following declarations:
I have and will maintain a certificate of consent to self-insure for workers' compensation as provided for by Section 3700 of the Labor Code, for the performance of work for which the permit is issued.

I have and will maintain workers' compensation insurance, as required by Section 3700 of the Labor Code, for the performance of the work for which this permit is issued. My workers' compensation insurance carrier and policy number are:

Carrier OLD REPUBLIC INS. CO. Policy Number MWC107468 00 Exp Date 11/01/2001

(This section need not be completed if the permit is issued for the performance of the work for which this permit is issued, I shall not employ any person in any manner so as to become subject to the workers' compensation laws of California and agree that if I should become subject to the workers' compensation provisions of Section 3700 of the Labor Code, I shall forthwith comply with those provisions.

Date 3/20/01 Applicant Signature Don McCloskey

WARNING: FAILURE TO SECURE WORKER'S COMPENSATION COVERAGE IS UNLAWFUL AND SHALL SUBJECT AN EMPLOYER TO CRIMINAL PENALTIES AND CIVIL FINES UP TO ONE HUNDRED THOUSAND DOLLARS (\$100,000) IN ADDITION TO THE COST OF COMPENSATION, DAMAGES AS PROVIDED FOR IN SECTION 3706 OF THE LABOR CODE, INTEREST AND ATTORNEY'S FEE.

THIS PERMIT SHALL EXPIRE BY LIMITATION IF WORK IS NOT COMMENCED WITHIN 180 DAYS.



WesPac

insulation
a MASCO Company



809 North Market Blvd., Ste. 11 • Sacramento, CA 95834
 (916) 927-7149 • Fax (916) 927-4257
 Lic. #487478

Installed Insulation Certificate

We certify that the building insulation listed herein is installed in conformance with current energy conservation regulations, California Administrative Code, Title 24, State of California

RECTOR	AREA	TYPE	INCHES/BAGS (BLOWN)
R19	CEILING AREA	PERFORATED BATT	12.5 / 100
R19	CEILING AREA	PERFORATED BATT	12.5 / 100
R19	EXTERIOR WALL AREA	PERFORATED BATT	12.5 / 100

Certified by *Lewnik/Stiles*

Title Secretary

USHO NATOMAS TRADITION
 USHO NATOMAS TRAD/265
 Address or Lot Number 07/18/01 Phase #
 Date Installed

NORMAN SCHEEL STRUCTURAL ENGINEER

SACRAMENTO
5022 SUNRISE BOULEVARD
FAIR OAKS, CA 95628
PHONE (916) 536-9585
FAX (916) 536-0260

DAVIS
213 E STREET SUITE B
DAVIS, CA 95616
PHONE (530) 753-5300
FAX (530) 753-5380

PROJECT: 1725 NATOMAS LOT 205

CLIENT: USHOME

JOB NO: US357

DATE: 5-21-01

CALCULATED BY: TH

SHEET NO: 1 OF 1

USHOME NATOMAS PARK LOT 205 1725 PLAN (US357)

SHEATHWALL REPAIR AT REAR WALL LINE.

PROBLEM: HOLDOWNS / A.B.'S NOT INSTALLED IN CORRECT LOCATIONS

- REPAIR:
- ① SEE PLAN SECTION BELOW; INSTALL HOLDOWNS W/I/W MASTER BATH WALLS ON THE INSIDE FACE OF THE 4X4 HOLDOWN POSTS.
 - ② INSTALL OTHER MISSING HOLDOWNS AT ORIGINAL PLAN SPECIFIED LOCATIONS.

FOR ALL RETROFIT HOLDOWNS USE SIMPSON HTT22 ON 4X4#2 DF POST W/ 5/8" ϕ A307 ROD EPOXIED 10" INTO CONCRETE USING SIMPSON SET EPOXY

INSTALL 5/8" ϕ A.B. @ 32" O.C. MAX SPACING ALONG SHEATHWALL USE 5/8" ϕ A307 ROD EPOXIED 5" INTO CONCRETE W/ SIMPSON SET EPOXY.

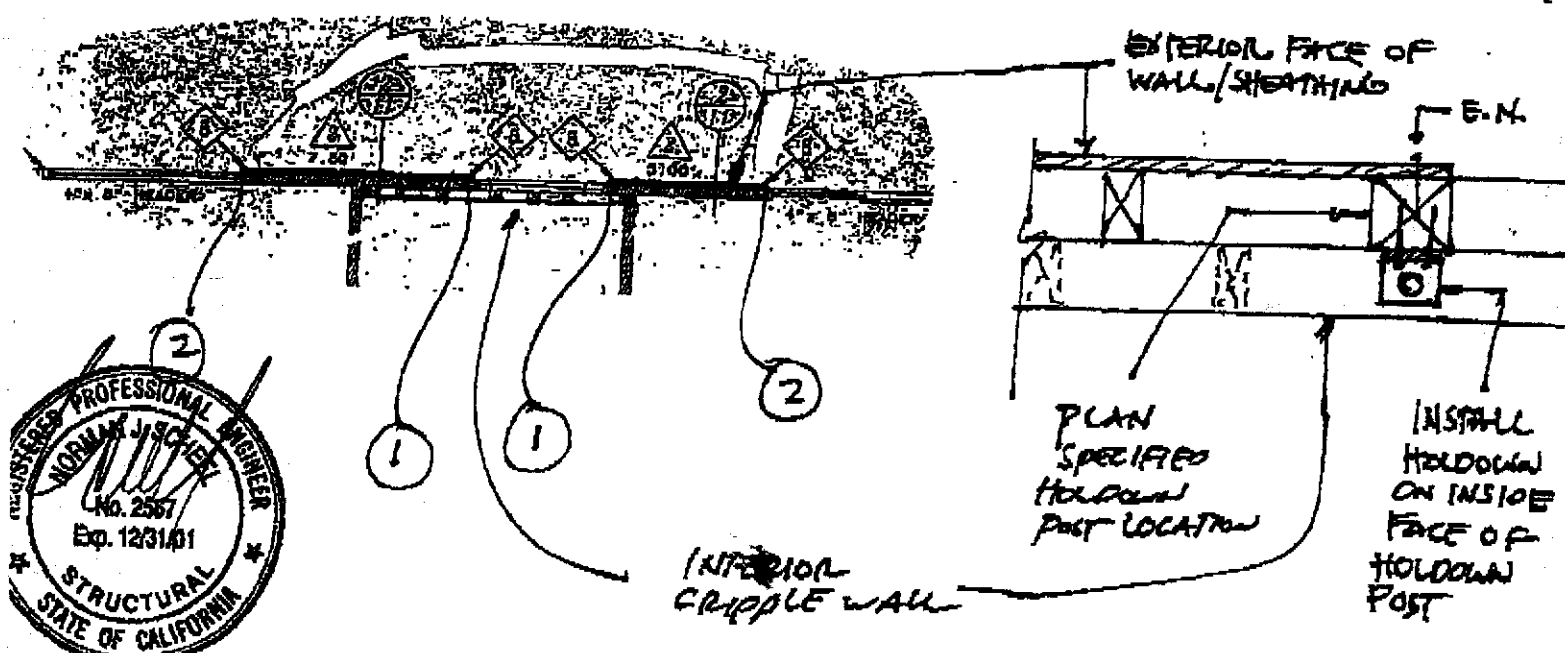

NORMAN SCHEEL STRUCTURAL ENGINEER

SACRAMENTO
5022 SUNRISE BOULEVARD
FAIR OAKS, CA 95628
PHONE (916) 856-9588
FAX (916) 536-0280

DAVIS
213 E STREET SUITE B
DAVIS, CA 95616
PHONE (530) 753-5380
FAX (530) 753-5380

PROJECT: 1857 NATOMAS PARK

CLIENT: USHOME

JOB NO: US35B

DATE: 5-7-01

CALCULATED BY: TH

SHEET NO: 1 OF 1

USHOME NATOMAS PARK PLAN 1857 (US35B)

REQUIRED PULL TEST LOADS:

Holdown	Type	Req'd Pull Test Load
HDBA	14	11,190#
SSTB34		
HRAHT22-2P	8	685#

HDBA
SSTB34

14

USE HDBA w/
7/8" ϕ A307
ROD EPOXIED 12"
INTO CONCRETE w/ SET
EPOXY

11,190#

8

HRAHT22-2P

USE HTT22
w/ 5/8" ϕ A307
ROD EPOXIED
10" INTO CONCRETE
w/ SIMPSON SET EPOXY

685#



RESIDENTIAL SUBDIVISION BUILDING PERMIT APPLICATION

Project Address: 2579 Maybrook Drive Assessor Parcel # 201-0120-005
Lot Number: 5 Subdivision NORTHBOROUGH VILLAGE 3-2

OWNER INFORMATION:

0102706

Legal Property Owner: US HOME Phone# 858-3900
Owner Address: 366 GOLD MEADOW WAY City GOLD RIVER State CA. Zip 95670

CONTRACTOR INFORMATION:

Contractor: US HOME Lic. # 451839 Phone # 858-3900 Fax 858-3925
DON McCLOSKEY 719-9050

PROJECT INFORMATION:

Land Use Zone R1A Occupancy Group R3 Construction Type VN Fed Code 1A
No. of Stories: 1 No. of Rooms: _____ Street Width: _____
1st Floor Area 1721 2nd Floor Area _____ Basement _____ Roof Material _____
AREA IN SQUARE FOOT OF:
Dwelling/Living 1721
Garage/Storage 403
Decks/Balconies 147
Carports _____
SCOPE OF WORK: _____

FOR OFFICE USE ONLY

- Information Above Complete
- Violation Files Checked
- Standard Setbacks
- County Sewer
- AR Flood Waiver Required
- Flood Elevation Certificate Required
- Water Development Infill Area
- Planning Approval
- Design Review Approval
- Special Fee Districts Apply:

THE FOLLOWING MUST BE PROVIDED IN ORDER TO SUBMIT FOR PERMIT

- 2 COMPLETE PLOT PLANS, LEGIBLE & DRAWN TO SCALE
- 11 X 17 COPY OF FLOOR PLAN WITH FOLLOWING INFORMATION
 - a) Assessor's Parcel Number
 - b) New Floor Area
 - c) Owners Name
 - d) Project Address

Date: _____ Received by: (staff) _____ Permit # _____

Lot Area = 5,469 sf
 Building Footprint = 2,272 sf
 Gross Coverage = 41.5%
 Porch Allowance = 148 sf
 Net Coverage = 38.8%

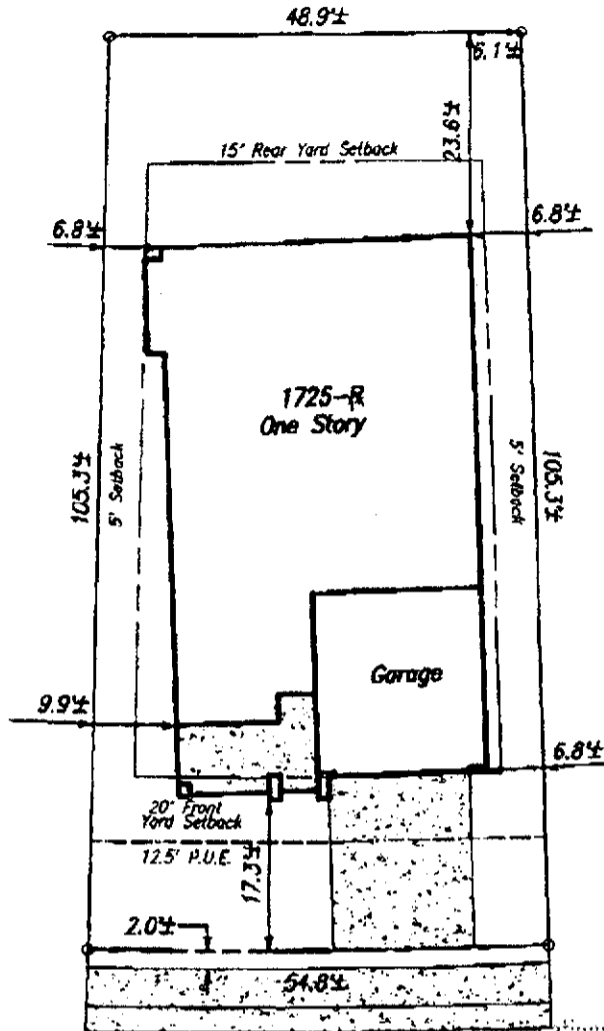
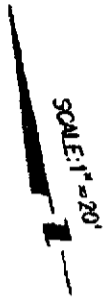

APN:

201-042-005

Address:

2579 Maybrook Drive

Owner:

Plan:

1725 R



Maybook Drive

Plot Plan for Lot 5 for Northborough Village 3-2
 U.S.Home - Northborough - Traditions Series
 City of Sacramento

Note:

This plot plan has been prepared for the purpose of showing the building foundation relationship to the property line, proposed drainage elevations and direction of flow to conform to local ordinances and for the purpose of building permit issuance. Information shown is approximate except for those setbacks which are minimums required by ordinance. This plot does not reflect as-built conditions which will likely vary from this plan.

Murray Smith & Associates
 Engineering, Inc.
 3110 Gold Canal Drive
 Rancho Cordova, CA 95670
 Ph.: (916) 635-1511

February 1, 2001

PN: 99003