

CITY OF SACRAMENTO
1231 T Street, Sacramento, CA 95814

Permit No: 0106720
Insp Area: 4

Site Address: 3835 BROADLAND ST SAC
Parcel No: 225-1440-039 NATOMAS CROSS 23 LOT 39

Sub-Type: NSFR
Housing (Y/N): N

CONTRACTOR
RYLAND HOMES
1380 LEAD HILL BLVD STE 108
ROSEVILLE CA 95661

OWNER

ARCHITECT

Nature of Work: MP 2023 2 STORY 9 ROOM SFR

CONSTRUCTION LENDING AGENCY: I hereby affirm under penalty of perjury that there is a construction lending agency for the performance of the work for which this permit is issued (Sec. 3097, Civ. C.).

Lender's Name _____ Lender's Address _____

LICENSED CONTRACTORS DECLARATION: I hereby affirm under penalty of perjury that I am licensed under provisions of Chapter 9 (commencing with section 7000) of Division 3 of the Business and Professions Code and my license is in full force and effect.

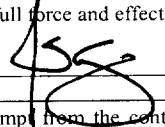
License Class **B** License Number 054648 Date 6-11-01 Contractor Signature 

OWNER-BUILDER DECLARATION: I hereby affirm under penalty of perjury that I am exempt from the contractors License Law for the following reason (Sec. 7031.5, Business and Professions Code, any city or county which requires a permit to construct, alter, improve, demolish, or repair any structure, prior to its issuance, also requires the applicant for such permit to file a signed statement that he or she is licensed pursuant to the provisions of the Contractors License Law (Chapter 9 (commencing with Section 7000) of Division 8 of the Business and Professions Code) or that he or she is exempt therefrom and the basis for the alleged exemption. Any violation of Section 7031.5 by any applicant for a permit subjects the applicant to a civil penalty of not more than five hundred dollars (\$500.00).

I, as a owner of the property, or my employees with wages as their sole compensation, will do the work, and the structure is not intended or offered for sale (Sec. 7044, Business and Professional Code). The Contractors License Law does not apply to an owner of property who builds or improves thereon, and who does such work himself or herself or through his/her own employees, provided that such improvements are not intended or offered for sale. If, however, the building or improvement is sold within one year of completion, the owner-builder will have the burden of proving that he/she did not build or improve for the purpose of sale.

I, as owner of the property, am exclusively contracting with licensed contractors to construct the project (Sec. 7044, Business and Professions Code). The Contractors License Law does not apply to an owner of property who builds or improves thereon, and who contracts for such projects with a contractor(s) licensed pursuant to the Contractors License Law.

I am exempt under Sec. _____ B & PC for this reason: FAIL
Date _____ Owner Signature CITY OF SACRAMENTO

IN ISSUING THIS BUILDING PERMIT, the applicant represents, and the city relies on the representation of the applicant that the applicant verified all measurements and locations shown on the application or accompanying drawings and that the improvement to be constructed does not violate any law or private agreement relating to permissible or prohibited locations for such improvements. This includes the location of any improvement or the violation of any private agreement relating to location of improvements. **NEIGHBORHOODS, PLANNING AND DEVELOPMENT SERVICES**

I certify that I have read this application and state that all information is correct. I agree to comply with all city and county ordinances and state laws relating to building construction and hereby authorize representative(s) of this city to enter upon the abovementioned property for inspection purposes.

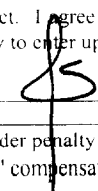
Date 6-11-01 Applicant/Agent Signature 

WORKER'S COMPENSATION DECLARATION: I hereby affirm under penalty of perjury one of the following declarations:
I have and will maintain a certificate of consent to self-insure for workers' compensation as provided for by Section 3700 of the Labor Code, for the performance of work for which the permit is issued

I have and will maintain workers' compensation insurance, as required by Section 3700 of the Labor Code, for the performance of the work for which this permit is issued. My workers' compensation insurance carrier and policy number are:
Carrier AMERICAN PROTECTION Policy Number 4BR003219-01 Exp Date 06/01/2001

(This section need not be completed if the permit is for \$100 or less) I certify that in the performance of the work for which this permit is issued, I shall not employ any person in any manner so as to become subject to the workers' compensation laws of California and agree that if I should become subject to the workers' compensation provisions of Section 3700 of the Labor Code, I shall forthwith comply with those provisions.

Date 6-11-01 Applicant Signature 

WARNING: FAILURE TO SECURE WORKER'S COMPENSATION COVERAGE IS UNLAWFUL AND SHALL SUBJECT AN EMPLOYER TO CRIMINAL PENALTIES AND CIVIL FINES UP TO ONE HUNDRED THOUSAND DOLLARS (\$100,000) IN ADDITION TO THE COST OF COMPENSATION, DAMAGES AS PROVIDED FOR IN SECTION 3706 OF THE LABOR CODE, INTEREST AND ATTORNEY'S FEE.

THIS PERMIT SHALL EXPIRE BY LIMITATION IF WORK IS NOT COMMENCED WITHIN 180 DAYS.

Project Address: 3835 Broadland St
Lot Number: 39

Assessor Parcel # _____
Subdivision Natomas Crossing Unit# 23

REVISED

OWNER INFORMATION:

Legal Property Owner: Ryland Homes Phone# 784-1330 #14
Owner Address: 1380 Lead Hill Rd. City Roseville State CA Zip 95661

CONTRACTOR INFORMATION:

Contractor: Ryland Homes Lic. # 54648 Phone # 784-1330#14 Fax 784-9805

PROJECT INFORMATION: Plan Two MP2023 w/ Tandem Garage

Land Use Zone R1A Occupancy Group R3 Construction Type VN Fed Code 1A
No. of Stories: 2 No. of Rooms: 10 Street Width: 41'
1st Floor Area 1007 2nd Floor Area 1016 Basement _____ Roof Material Tile
AREA IN SQUARE FOOT OF:
Dwelling/Living 2023
Garage/Storage 605
Decks/Balconies _____
Carports _____
SCOPE OF WORK: SFD.

OR
ICE
SE
LY

- Information Above Complete
- Violation Files Checked
- Standard Setbacks
- County Sewer
- AR Flood Waiver Required
- Flood Elevation Certificate Required
- Water Development Infill Area
- Planning Approval
- Design Review Approval
- Special Fee Districts Apply:

THE FOLLOWING MUST BE PROVIDED IN ORDER TO SUBMIT FOR PERMIT

- 2 COMPLETE PLOT PLANS, LEGIBLE & DRAWN TO SCALE
- 11 X 17 COPY OF FLOOR PLAN WITH FOLLOWING INFORMATION
 - a) Assessor's Parcel Number
 - b) New Floor Area
 - c) Owners Name
 - d) Project Address

Date: _____ Received by: (staff) _____ Permit # _____



WesPac

insulation
a MASCO Company



809 North Market Blvd., Ste. 11 • Sacramento, CA 95834
(916) 927-7149 • Fax (916) 927-4257
Lic. #487478

Installed Insulation Certificate

We certify that the building insulation listed herein is installed in conformance with current energy conservation regulations, California Administrative Code, Title 24, State of California

R FACTOR	AREA	TYPE	INCHES/BAGS (BLOWN)
R 30	Ceiling AREA	FiberGlass Blow	12" / 19 BAG
R 30	Ceiling AREA	FiberGlass Batt	10.25"
R 13	Ext. WALL AREA	FiberGlass Batt	3.5"

Certified by Wesley Williams Ryland/Heritage @ Natomas / Lot 39
Address or Lot Number
Title Secretary 10-20-01
Date Installed

NORMAN

Scheel

Structural

Engineer

Sacramento
5022 Sunrise Blvd.
Fair Oaks, CA 95628
(916) 536-9585
(916) 536-0260 (fax)

NORMAN SCHEEL
Structural Engineer
Email: norm@nsse.com

ROBERT COON
Project Manager
Email: rob@nsse.com

PAULO IBANEZ, P.E.
Project Manager
Email: paulo@nsse.com

TIM SLOAN, P.E.
Project Manager
Email: tim@nsse.com

STEVE COOKSEY
CAD Supervisor
Email: steve@nsse.com

STACY MARLIN
Office Manager
Email: stacy@nsse.com

Davis
213 E Street Suite F
Davis, CA 95616
(530)753-5301
(530)753-5380(fax)

TRACY HARRIS, P.E.
Project Manager
Email: tracy@nsse@davis.com

DARRELL PEREIRA
Design Engineer
Email: darrell@nsse@davis.com

October 2, 2001

Ryland Homes
1380 Lead Hill #108
Roseville, CA 95661

RE: Various framing issues - Lot 39 (Plan 2) - Heritage
(#20028)

To whom it may concern:

This letter is to verify that for the above lot the following framing items have been addressed by this office:

- The over-bored stud at the tandem garage 2X4 framing may be repaired using a Simpson HSS2 Shoe.
- For the as-built connection of girder truss M4 (HGUS26-2), the B2 Truss bottom chord against the rim must be connected with a minimum of (10) 16d Sinkers within 18" of the hanger. The other side of the hanger is currently attached to a 2X block. This block must also have a minimum of (10) 16d Sinkers installed into the rim within 18" of the hanger.

If you have any questions, please contact Paulo Ibanez.

NORMAN SCHEEL
STRUCTURAL ENGINEER

PJP

Cew
10/15/01



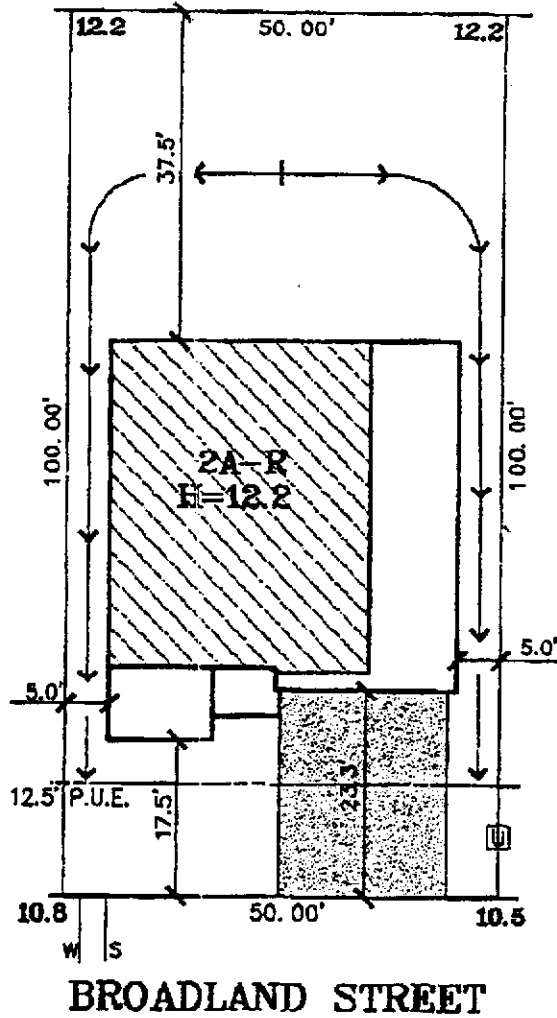

This plan is prepared and specifications are for the purpose of obtaining a building permit and it is not to be used for any other purpose or alterations for any other purpose without the written permission from the City of Sacramento.

LEGEND

- PUBLIC UTILITY EASEMENT
- S SEWER SERVICE
- W WATER SERVICE
- ☐ UTILITY BOX
- * STREET LIGHT
- ▣ DRAIN INLET
- ◆ FIRE HYDRANT

DATE: 5-15-01 REV
LOT AREA: 5,000 SF
LOT COVERAGE: 31%

THIS PLAN IS PREPARED TO SHOW THE DIMENSIONAL RELATIONSHIP FROM BUILDING FOUNDATION TO PROPERTY LINE, DESIGN DRAINAGE CONTROL ELEVATIONS, AND DIRECTION OF DRAINAGE FLOW TO CONFORM WITH LOCAL ORDINANCES FOR THE PURPOSE OF BUILDING PERMIT ISSUANCE. INFORMATION SHOWN IS APPROXIMATE EXCEPT FOR THOSE SETBACKS WHICH ARE MINIMUMS REQUIRED BY ORDINANCE. THIS PLOT PLAN DOES NOT REFLECT AS BUILT CONDITIONS WHICH WILL LIKELY VARY FROM THIS PLAN.

The Splink Corporation
 2590 VENTURE OAKS WAY
 SACRAMENTO, CA 95833
 PH: (916) 925-5550 FAX: (916) 921-9274

NATOMAS CROSSING
VILLAGE 23
 3835 BROADLAND ST.
 A.P.N.:
LOT 39
PLAN 2A

RYLAND HERITAGE
 CITY OF SACRAMENTO, CA.
 CLIENT: RYLAND HOMES
 CONTACT: LINDA STEINFELDT
 PHONE: 916-784-1330
 JOB NO.: 7684-003