

SACRAMENTO CITY PLANNING COMMISSION

REPORT OF CITY PLANNING DIRECTOR--R.L. RATIFON
December 19, 1961

APPLICATION FOR SPECIAL USE PERMIT

APPLICANT: Lester L. & Florence E. Jessee, 703 Elefa Street,
Roseville, Calif.

OWNERS: Victor J. & Rachel Damiano, 2621 $\frac{1}{2}$ Bdw'y, Sacto.
Sidney E. & Eva L. Herbert, P.O. Box 505, Elk Grove,
Calif.

PROPERTY: Lot 55 and East 88' Lots 56 & 57 New Glendale Sub.

LOCATION: NW Corner 26th Ave. and Warwick Ave.

ZONING: R-1 One-Family Zone

SIZE: Two lots forming an L-shaped parcel, one lot 66' X
140', and the other lot 88' X 101'.

EXISTING USE: Vacant land

PROPOSED USE: Church with Off-Street Parking Area.

REQUEST: Permission to develop R-1 One-Family Zoned property
with a Church and off-street parking area, according
to submitted plot plan.

1. Submitted plans indicate a 1-story Church building of approximately 1500 sq. ft. of floor area. The meeting room of approximately 900 sq. ft. will have seating capacity for 100 people. Parking area shows 18 parking spaces, which meets the requirements of Off-Street Parking Ordinance.

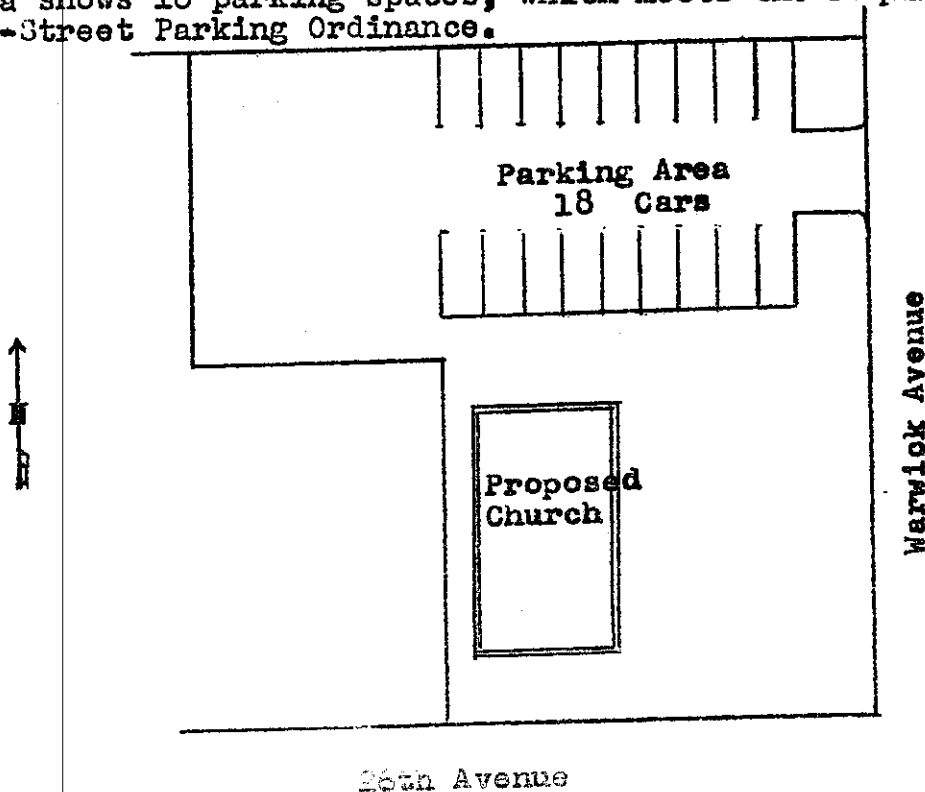

P7049

61-215

26th Avenue