

**THIS IS A 2 PART FORM  
WRITE ON A FIRM SURFACE**

**USE BLACK INK BALL POINT PEN - PRESS FIRMLY  
SIGN PERMIT APPLICATION**

*MA*

CONSTRUCTION LENDING AGENCY

I hereby affirm under penalty of perjury that I am a construction lending agency for the City of Sacramento and am authorized to provide the permit as provided by SCS 9997 (C.C.C.).

Name: \_\_\_\_\_  
Address: \_\_\_\_\_

LICENSED CONTRACTORS DECLARATION

I hereby affirm under penalty of perjury that I am licensed under provisions of Chapter 9 of the Commercial Code (Section 7000) of Division 3 of the Business and Professions Code and my license is in full force and effect.

License Class: \_\_\_\_\_ Lic. Number: 545163  
Date: 9/21/00 Contractor: \_\_\_\_\_  
(Signature): *[Signature]*

OWNER - BUILD PER DECLARATION

I hereby affirm under penalty of perjury that I am exempt from the Contractors License Law for the following reason: See BPS Business and Professions Code. Any city or county ordinance that requires a contractor license for the performance of repair and maintenance work is hereby declared null and void. I request you report any violation of this ordinance to the City of Sacramento, Department of Public Works, 1000 J Street, Sacramento, CA 95833. Any violation of Section 7001 of the Business and Professions Code is a misdemeanor and is punishable by a fine of up to five hundred dollars.

I hereby affirm under penalty of perjury that I am exempt from the Contractors License Law for the following reason: See BPS Business and Professions Code. Any city or county ordinance that requires a contractor license for the performance of repair and maintenance work is hereby declared null and void. I request you report any violation of this ordinance to the City of Sacramento, Department of Public Works, 1000 J Street, Sacramento, CA 95833. Any violation of Section 7001 of the Business and Professions Code is a misdemeanor and is punishable by a fine of up to five hundred dollars.

I hereby affirm under penalty of perjury that I am exempt from the Contractors License Law for the following reason: See BPS Business and Professions Code. Any city or county ordinance that requires a contractor license for the performance of repair and maintenance work is hereby declared null and void. I request you report any violation of this ordinance to the City of Sacramento, Department of Public Works, 1000 J Street, Sacramento, CA 95833. Any violation of Section 7001 of the Business and Professions Code is a misdemeanor and is punishable by a fine of up to five hundred dollars.

SITE ADDRESS

7770 COLLEGE TOWN DRIVE

SUITE

INSR. AREA  
1

ASSESSOR PARCEL NO. 079-0010-038

PERMIT NO. 0011283

NAME OF APPLICANT

ADDRESS

ZIP CODE

PHONE NO.

LICENSED CONTRACTOR  
**EULTS & EULTS**

1111 JEWETS WAY  
SACRAMENTO, CA

95815

(916) 424-1936

BUSINESS OWNER

7770 COLLEGE TOWN DR.

"THE GARDEN I CREDIT"

SIGN INFORMATION

- ATTACHED
- ILLUMINATED
- INDIVIDUAL LETTERS
- METAL
- PLASTIC
- WOODEN
- INTERIOR / EXTER.
- NON-ILLUMINATED
- PAINTED ON BUILDING
- POLE
- MONUMENT
- PROJECTING
- SINGLE FACED
- BILLBOARD / SUBDIVISION
- LOGO
- DOUBLE FACED
- VINYL/GATOR FOAM
- REFACE

SIGN COPY "THE GARDEN I CREDIT UNION"

521335

CITY OF SACRAMENTO PERMIT SERVICES  
BUILDING INSPECTION DIVISION 264-7619

WORKER'S COMPENSATION DECLARATION

I hereby affirm under penalty of perjury that the following declarations:

- I have and will maintain a certificate of suspension of all claims on workers' compensation as provided in Section 4700 of the Labor Code for the performance of work for which the permit is issued.
- I have and will provide workers' compensation for all employees of my firm. A Section 4700 of the Labor Code for the performance of work for which this permit is issued. My workers' compensation insurance policy number and policy number are \_\_\_\_\_.

Carrier: \_\_\_\_\_  
Policy Number: \_\_\_\_\_

I hereby affirm under penalty of perjury that the information on this permit application is true and correct. I shall not employ any person in any manner so as to become subject to the workers' compensation laws of California and agree that if I should become subject to the workers' compensation provisions of Section 4700 of the Labor Code, I shall report such work to the appropriate authority.

*[Signature]*

APPLICANT'S SIGNATURE AND TITLE: \_\_\_\_\_  
DATE: \_\_\_\_\_

THIS PERMIT SHALL EXPIRE BY LIMITATION IF WORK AUTHORIZED IS NOT COMMENCED WITHIN 180 DAYS

<p>(A) HEIGHT <u>3' 1"</u> (B) LENGTH <u>5'</u></p> <p>(A X B) SIGN AREA <u>15 1/2</u></p> <p>POLE SIZE _____ FOOTING SIZE _____</p> <p>STREET FRONTAGE (FT) _____</p> <p>OCCUPANCY FRONTAGE (FT) _____</p>	<p>OFFICE USE ONLY</p> <p>INDEXING REQUIRED: YES NO APPROVED BY _____</p> <p>DESIGN REVIEW REQUIRED: YES NO APPROVED BY _____</p> <p>SPECIAL PERMIT REQUIRED: YES NO BY _____</p> <p>VARIED REQUIRED: YES NO BY _____</p> <p>ON-APPROVAL: YES NO WHEREBY: <u>Collyer Town</u></p>	<p>DATE: <u>9-21-00</u></p> <p>AMOUNT: <u>300</u></p> <p>DATE: <u>1-24-01</u></p> <p>DATE: <u>1-22-00</u></p>	<p>RECEIVED</p> <p>DATE: _____</p> <p>AMOUNT: _____</p> <p>DATE: <u>1-24-01</u></p> <p>AMOUNT: _____</p>
---	---	---	--

OTHER	TOTAL FEES \$
<p>PERMIT FEE</p> <p>INSURANCE FEE</p> <p>STAMP FEE</p> <p>REVIEW FEE</p>	<p><u>300</u></p>

HORNET ROAD

15'  
L.H. CORN

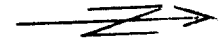

PROPOSED SIGN LOCATION

COLLEGE TOWN DRIVE

PARKING

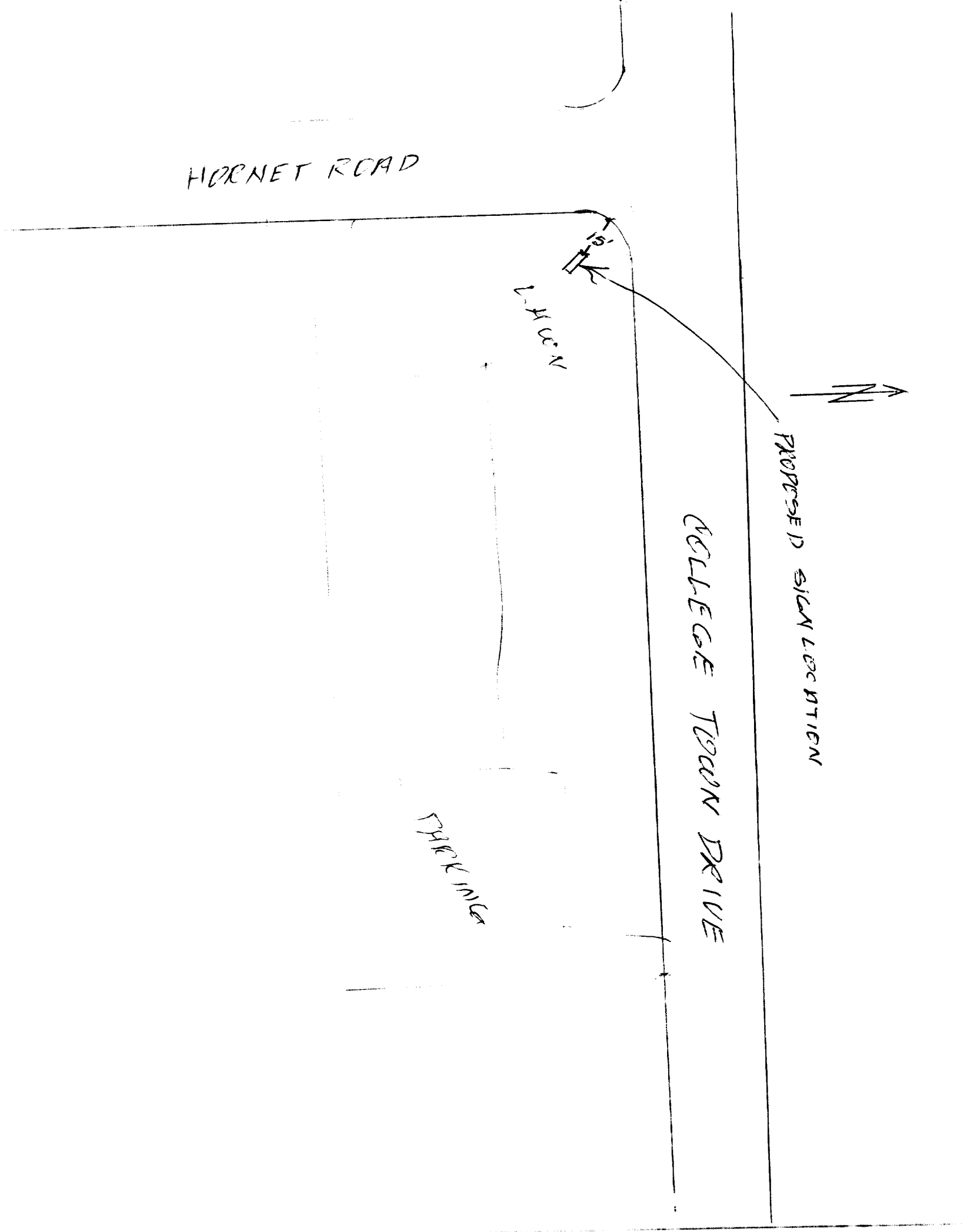



916 • 924 • 1936 FAX • 916 • 924 • 3133  
1111 Joells Way, Sacramento, CA 95815  
Contractor's License #545767

In order to comply with Sections 3097 and 3098 of the California Civil Code, concerning the giving of preliminary notice, the following information is required from you as part of our contract. The giving of such a notice does not constitute a lien, nor is it a reflection on the integrity of any contractor or sub contractor.

Request for information prior to filing required preliminary lien notice.

Please return this information by \_\_\_\_\_

Sold To:

The Golden 1 Credit Union  
6507 4th Ave.  
Sacramento, Ca

Date:

9-14-00

Job Name:

The Golden 1 Credit Union

Job Address:

7770 College Union Drive, Sac.

Legal Description:

Owner's name and address

The Golden 1 Credit Union  
P.O. Box 15966  
Sacramento, CA 95822-1966

General Contractor's name and address

Ellis & Ellis  
1111 Joells  
Sac. CA 95815

Lending institution's name and address

\_\_\_\_\_  
\_\_\_\_\_  
\_\_\_\_\_

Bonding company's name and address

\_\_\_\_\_  
\_\_\_\_\_  
\_\_\_\_\_

Bond Number \_\_\_\_\_

\_\_\_\_\_  
\_\_\_\_\_  
\_\_\_\_\_

Agent's name and address

\_\_\_\_\_  
\_\_\_\_\_  
\_\_\_\_\_

Estimated total price of the labor, services,  
equipment or material described hereon.

\$ \_\_\_\_\_

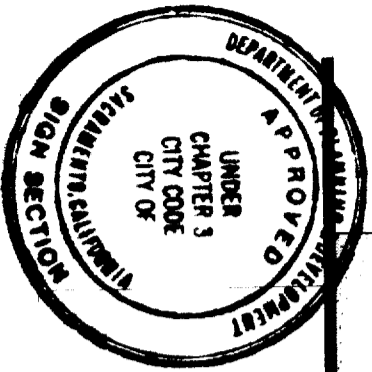
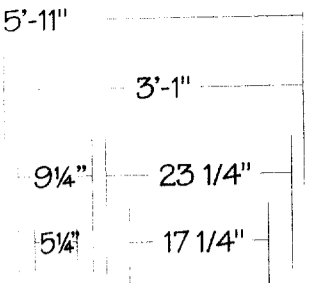

All electrical work must be U.L. labeled or be of equivalent standards, N.E.C. Sec. 90.6/and comply with chapter 14, Div. 2 of Sacramento City Code.  
 EQUIPMENT MUST BE USED AS DESIGN INTENDED  
 ALL SIGN INSTALLATIONS ARE SUBJECT TO FIELD INSPECTIONS

This set of plans and specifications must be kept on the job at all times and it is unlawful to make any changes or alterations from the same without written permission from the City of Sacramento Sign Section. CONCRETE FOOTING The approval of this plan and specifications SHALL NOT be held to permit or approve the violation of any City Ordinance or State Law

*10-3-00 JTW*

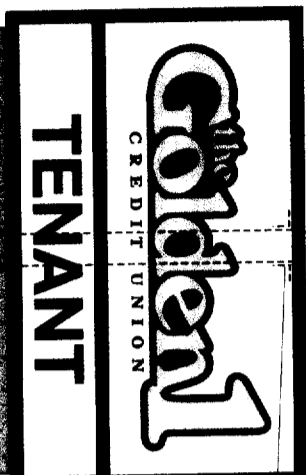

TENANT

PIPE THRU-BOLTED TO ALUM. ANGLE SADDLE

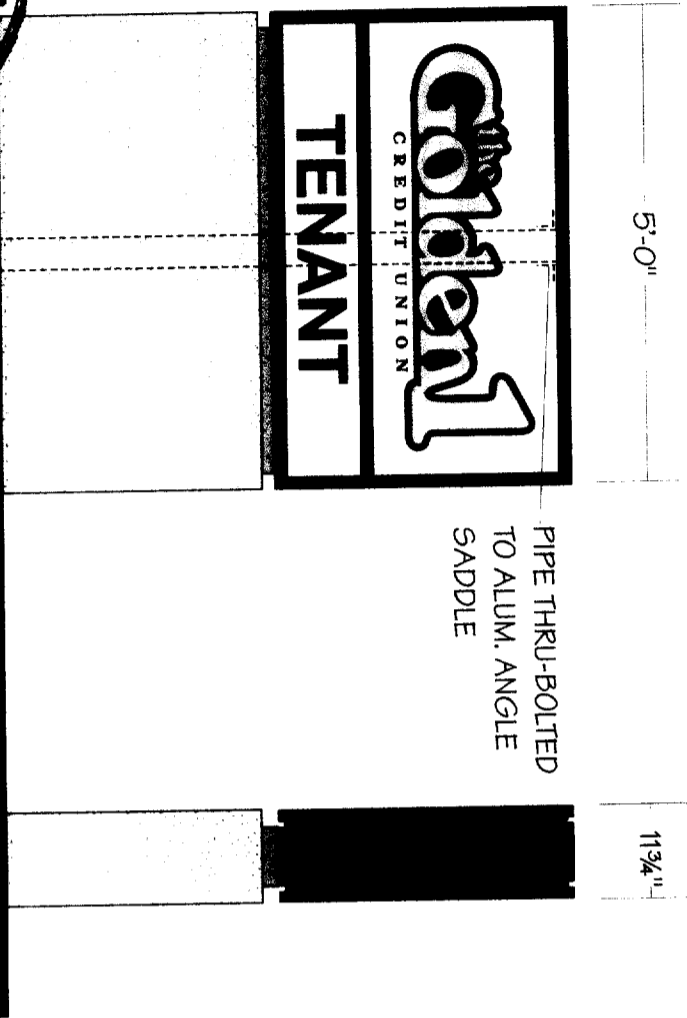

D/E MONUMENT SIGN - INTERNAL ILLUMINATION  
 SIGN COMP EXTRUDED ALUMINUM CABINET - MED. BODY  
 W/ 1 1/2" RETAINERS - PAINT DURANODIC BRONZE  
 WHITE LEXAN FACES - VINYL DECORATED;  
 BLACK & 230-25 SUNFLOWER LOGO,  
 1 1/2" DIVIDER - 230-69 DURANODIC BRONZE  
 HIGH OUTPUT FLUORESCENT LAMPS  
 FABRICATED ALUMINUM BASE W/ 1 1/2" REVEAL  
 - TEXCOTE & PAINT BEIGE

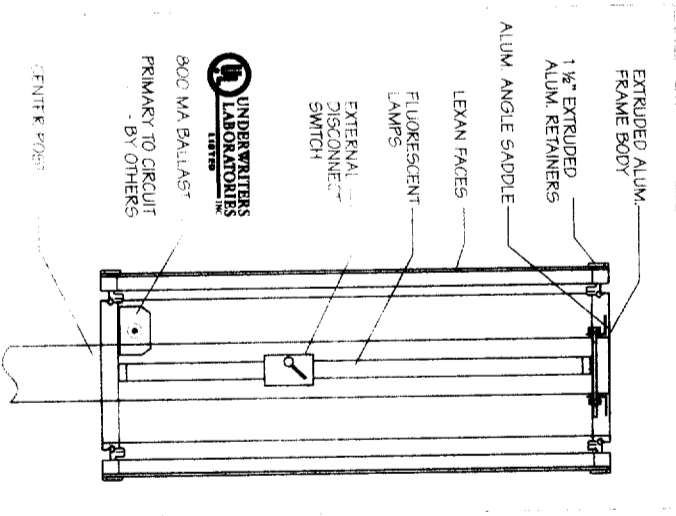

**Ellis Ellis**

S I G N S • D I S P L A Y S

916 • 924 • 1936 FAX • 916 • 924 • 3133  
 1117 Joellis Way, Sacramento, CA 95815  
 CONTRACTOR'S LICENSE #545167

Project: The Golden 1 Credit Union.

Address: 7770 College Town Drive  
 Sacramento, CA

Date: 8-9-00 8-10-00 8-31-00

Art No: 4348

Job No:

Scale: 1/2" = 1'

Rep: Chuck

Drawn by: Jeff

Notes:

Sheet: 1 of 1

All ideas, designs, arrangements, and plans indicated represented by this drawing are owned by the property of Ellis & Ellis, and were created, evolved and developed for use on and in connection with the specified project. None of such ideas, designs, arrangements, or plans shall be used by or disclose to any person, firm or corporation for any purpose whatsoever without the written permission of the designer. Within dimensions on these drawings shall have precedence over scaled dimensions.

FILE COPY

*521355*