



# CITY OF SACRAMENTO

CITY MANAGER'S OFFICE  
**RECEIVED**  
FEB 17 1982

DEPARTMENT OF ENGINEERING  
915 I STREET SACRAMENTO, CALIFORNIA 95814  
CITY HALL ROOM 207 TELEPHONE (916) 449-5281

February 16, 1982

R. H. PARKER  
CITY ENGINEER  
J. F. VAROZZA  
ASSISTANT CITY ENGINEER

City Council  
Sacramento, California

Honorable Members in Session:

**SUBJECT:** Revocable Encroachment Permit - James A. Sowards

**SUMMARY:**

James A. Sowards has applied for a revocable encroachment permit for the purpose of constructing a canopy. The City Engineer recommends that the permit be granted.

**BACKGROUND:**

The area for which this request is being made consists of an area adjacent to permittee's property. An area 2' wide by 20' along the west side of 11th Street between 45' and 65' south of J Street at 1030 J Street (easterly portion of County Assessor's Parcel No. 6-103-9).

**RECOMMENDATION:**

The City Engineer recommends that the attached resolution be passed granting a revocable encroachment permit to James A. Sowards in the area and for the purpose outlined above.

Respectfully submitted,

R. H. PARKER  
City Engineer

Recommendation Approved:

Walter J. Slife, City Manager

14-R-030-00-0

cc: Glenn Marshall, Engineering  
Dick Hastings, Planning  
Tim Sullivan, Building Inspections

**APPROVED**  
BY THE CITY COUNCIL

FEB 23 1982

OFFICE OF THE  
CITY CLERK

February 23, 1982  
District No. 1

# RESOLUTION NO. 82-113

ADOPTED BY THE SACRAMENTO CITY COUNCIL ON DATE OF

RESOLUTION GRANTING REVOCABLE ENCROACHMENT TO:

JAMES A. SOWARDS

BE IT RESOLVED BY THE COUNCIL OF THE CITY OF SACRAMENTO:

That a revocable encroachment permit for the purpose of

Constructing a canopy

is hereby granted to JAMES A. SOWARDS, whose  
address is as follows: 14724 Ventura Blvd, Suite 610, Sherman Oaks, CA 91403.

The encroachment area is described as follows:

An area adjacent to permittee's property. An area 2' wide by 20' along the west side of 11th Street between 45' and 65' south of J Street at 1030 J Street (easterly portion of County Assessor's Parcel No. 6-103-9).

This permit is granted subject to the "General Provisions - Revocable Encroachment Permit", which were adopted by the City Council in Resolution No. 77-611 dated October 4, 1977, and the hereinafter specified special conditions, if any. This permit shall be effective only after the applicant files with the Department of Finance of the City of Sacramento, the insurance certificates required by the General Provisions.

**APPROVED**  
BY THE CITY COUNCIL

FEB 23 1982

OFFICE OF THE  
CITY CLERK

SPECIAL CONDITIONS

1. Permittee shall comply with requirements of the City Planning Department, Building Inspections Division and the City Sign Ordinance.

---

MAYOR

ATTEST:

---

CITY CLERK

W STREET

11th STREET

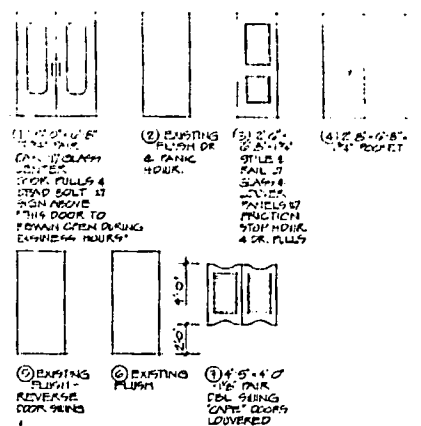
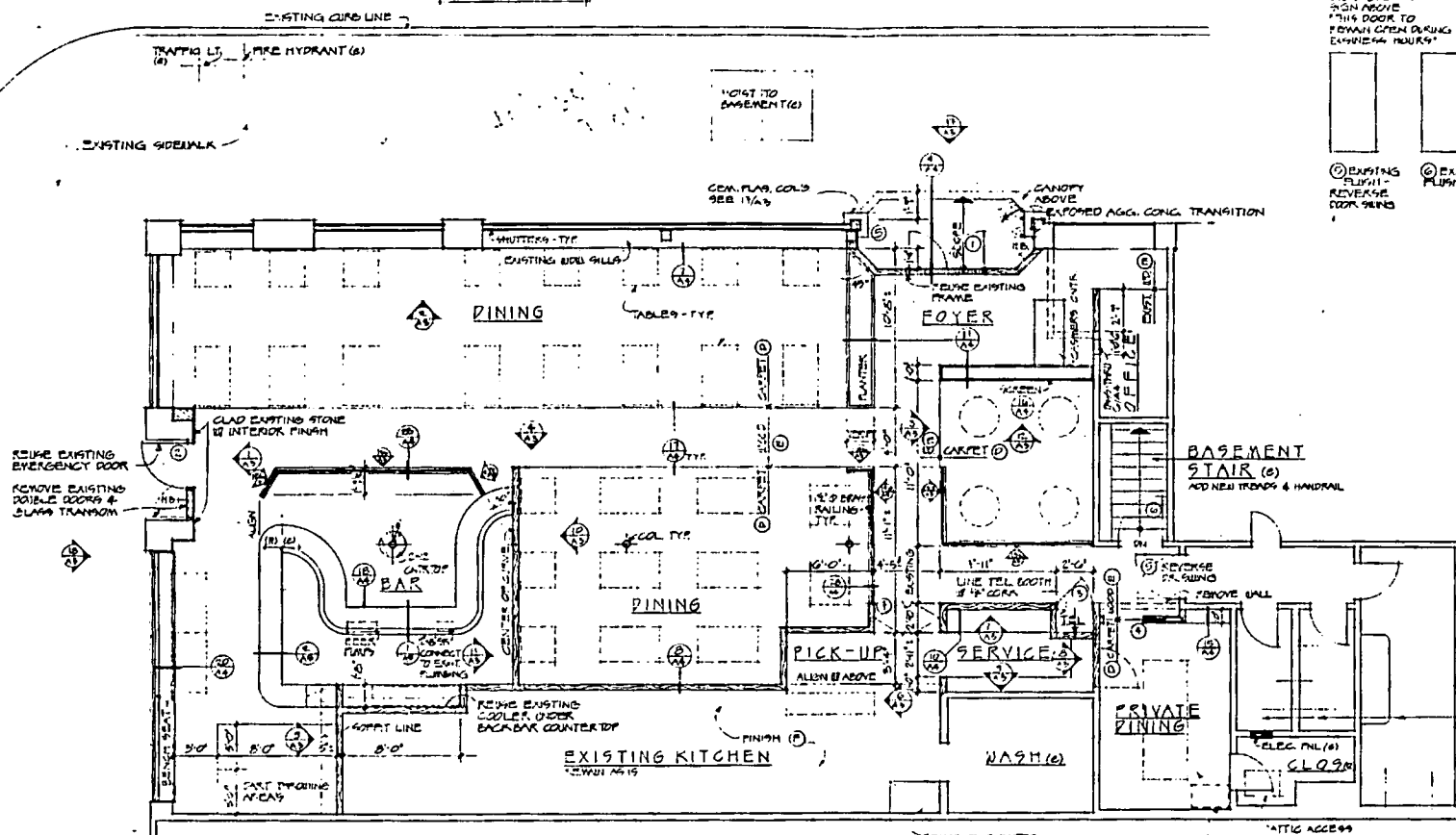

FLOOR PLAN



LEGEND

- EXISTING WALLS TO REMAIN - SEE SHT. A-3 FOR NEW FINISHES
- EXISTING WALLS TO BE REMOVED
- NEW WALLS - 2"x4" @ 16" OC W/ 1/2" GYPSUM BOARD EACH SIDE  
1/2" TYPE 'X' RESISTANT IN KITCHEN AREA
- (G) EXISTING
- (N) NEW

DATA

DINING, BAR, FOYER, AND OFFICE	2071	S.F.
KITCHEN, WASH, PICK-UP AND SERVICE	929	
TOILETS AND CORRIDOR (JOINT USE)	244	
TOTAL SQUARE FOOTAGE	2344	
DINING SEATING	110	
STAND-UP BAR	30	
TOTAL CLIENTELE	190	

FINISHES

- (A) WALL PAPER ON GYP. BR - SELECTED BY ARCH.
- (B) PAINT ON TEXTURED GYP. BR - COLOR BY ARCH.
- (C) PAINT ON TEXTURED GYP. BR - COLOR BY ARCH.
- (D) 1/2" OZ CARPET @ HEAVY DUTY PAD - SEL. BY ARCH.
- (E) BRUCE 3'-5'-1" HEARRINGBLOK - DBL. BACK PATTERN
- (F) CONCRETE SEALER
- (G)
- (H)

EXISTING TOILETS  
REMAIN AS IS -  
NO WORK IS TO  
BE DONE IN THIS AREA