

**CITY OF SACRAMENTO**  
1231 I Street, Sacramento, CA 95814

**Permit No: 0112926**  
**Insp Area: 4**  
Thos Bros:  
Sub-Type: NSFR  
Housing (Y/N):

**Site Address: 1750 BAINES AV SAC**  
Parcel No: 225-1110-025  
N

NORTHPOINTE PARK VIL. 12 LOT 25

CONTRACTOR  
LENNAR RENAISSANCE INC  
2240 DOUGLAS BL  
ROSEVILLE, CA 95661

OWNER

ARCHITECT

**Nature of Work: MP 655 2 STORY 10 ROOM SFR**

**CONSTRUCTION LENDING AGENCY:** I hereby affirm under penalty of perjury that there is a construction lending agency for the performance of the work for which this permit is issued (Sec. 3097, Civ. C).

Lender's Name \_\_\_\_\_ Lender's Address \_\_\_\_\_

**LICENSED CONTRACTORS DECLARATION:** I hereby affirm under penalty of perjury that I am licensed under provisions of Chapter 9 (commencing with section 7000) of Division 3 of the Business and Professions Code and my license is in full force and effect.

License Class B License Number 732348 Date 10/19/01 Contractor Signature J. Price

**OWNER-BUILDER DECLARATION:** I hereby affirm under penalty of perjury that I am exempt from the contractors License Law for the following reason (Sec. 7031.5, Business and Professions Code; any city or county which requires a permit to construct, alter, improve, demolish, or repair any structure, prior to its issuance, also requires the applicant for such permit to file a signed statement that he or she is licensed pursuant to the provisions of the Contractors License Law (Chapter 9 (commencing with Section 7000) of Division 8 of the Business and Professions Code) or that he or she is exempt therefrom and the basis for the alleged exemption. Any violation of Section 7031.5 by any applicant for a permit subjects the applicant to a civil penalty of not more than five hundred dollars (\$500.00);

\_\_\_\_ I, as a owner of the property, or my employees with wages as their sole compensation, will do the work, and the structure is not intended or offered for sale (Sec. 7044, Business and Professional Code: The Contractors License Law does not apply to an owner of property who builds or improves thereon, and who does such work himself or herself or through his/her own employees, provided that such improvements are not intended or offered for sale. If, however, the building or improvement is sold within one year of completion, the owner-builder will have the burden of proving that he/she did not build or improve for the purpose of sale.)

\_\_\_\_ I, as owner of the property, am exclusively contracting with licensed contractors to construct the project (Sec. 7044, Business and Professions Code: The Contractors License Law does not apply to an owner of property who builds or improves thereon, and who contracts for such projects with a contractor(s) licensed pursuant to the Contractors License Law).

\_\_\_\_ I am exempt under Sec. \_\_\_\_\_ B & PC for this reason: \_\_\_\_\_

Date \_\_\_\_\_ Owner Signature \_\_\_\_\_

**IN ISSUING THIS BUILDING PERMIT,** the applicant represents, and the city relies on the representation of the applicant, that the applicant verified all measurements and locations shown on the application or accompanying drawings and that the improvement to be constructed does not violate any law or private agreement relating to permissible or prohibited locations for such improvements. This building permit does not authorize any illegal location of any improvement or the violation of any private agreement relating to location of improvements.

I certify that I have read this application and state that all information is correct. I agree to comply with all city and county ordinances and state laws relating to building construction and hereby authorize representative(s) of this city to enter upon the above mentioned property for inspection purposes.

Date 10/19/01 Applicant/Agent Signature J. Price

**WORKER'S COMPENSATION DECLARATION:** I hereby affirm under penalty of perjury one of the following declarations:

\_\_\_\_ I have and will maintain a certificate of consent to self-insure for workers' compensation as provided for by Section 3700 of the Labor Code, for the performance of work for which the permit is issued.

AP I have and will maintain workers' compensation insurance, as required by Section 3700 of the Labor Code, for the performance of the work for which this permit is issued. My workers' compensation insurance carrier and policy number are:

Carrier CNA INSURANCE COMPANY Policy Number WC138201151 Exp Date 06/01/2002

\_\_\_\_ (This section need not be completed if the permit is for \$100 or less) I certify that in the performance of the work for which this permit is issued, I shall not employ any person in any manner so as to become subject to the workers' compensation laws of California and agree that if I should become subject to the workers' compensation provisions of Section 3700 of the Labor Code, I shall forthwith comply with those provisions.

Date 10/19/01 Applicant Signature J. Price

**WARNING: FAILURE TO SECURE WORKERS COMPENSATION COVERAGE IS UNLAWFUL AND SHALL SUBJECT AN EMPLOYER TO CRIMINAL PENALTIES AND CIVIL FINES UP TO ONE HUNDRED THOUSAND DOLLARS (\$100,000) IN ADDITION TO THE COST OF COMPENSATION, DAMAGES AS PROVIDED FOR IN SECTION 3706 OF THE LABOR CODE, INTEREST AND ATTORNEYS FEE.**

**THIS PERMIT SHALL EXPIRE BY LIMITATION IF WORK IS NOT COMMENCED WITHIN 180 DAYS.**

# ENGEL INSULATION, INC.

CALIFORNIA CONTRACTOR'S LICENSE #745646

460 Roseville Road • Roseville, CA 95678

(916) 786-2088 / (916) 969-6191

THIS IS TO CERTIFY THAT INSULATION HAS BEEN INSTALLED IN CONFORMANCE WITH CURRENT ENERGY REGULATIONS; CALIFORNIA ADMINISTRATIVE CODE, TITLE 24, STATE OF CALIFORNIA, IN THE BUILDING LOCATED AT:

TRACT 5011111111 LOT 35 MANOR  
STREET \_\_\_\_\_ CITY SHERMAN

EXTERIOR WALLS: CT 2 1/4 THICKNESS 3/8 R-VALUE 13  
MANUFACTURER CT 2 1/4 THICKNESS 3/8 R-VALUE 19

CEILING AREA: BATTS  
MANUFACTURER CT THICKNESS 1 1/2 R-VALUE 38

CEILINGS: BLOWN IN  
MANUFACTURER CELLULOSE THICKNESS 1 1/4 R-VALUE 38

SQUARE FOOTAGE 1000 NUMBER OF BAGS USED 51  
FLOOR AREA: 1000

MANUFACTURER CT THICKNESS 1 1/4 R-VALUE 19  
EXTERIOR-KNEEWALL:  
MANUFACTURER CT THICKNESS 1 1/4 R-VALUE 19

INTERIOR KNEEWALL:  
MANUFACTURER CT THICKNESS 1 1/4 R-VALUE 19

APPLIED CAULK & SEALANT TO ALL EXTERIOR OPENINGS & PENETRATIONS  
YES  NO \_\_\_\_\_

GENERAL CONTRACTOR \_\_\_\_\_  
CALIFORNIA CONTRACTORS  
LICENSE # \_\_\_\_\_ DATE \_\_\_\_\_

SIGNATURE \_\_\_\_\_ TITLE \_\_\_\_\_  
INSULATION CONT. SIGNATURE Alan H. Hensley TITLE \_\_\_\_\_ DATE \_\_\_\_\_

RESIDENTIAL BUILDING PERMIT APPLICATION

New Construction     Addition     Remodels     Other Lot: 25

Project Address: 1750 Barnes Ave. Assessor Parcel # 225-1110-02500

OWNER INFORMATION: North Pointe Park Village #12

Legal Property Owner: LENNAR RENAISSANCE Phone # (916)773-7471  
 Owner Address: 2240 DOUGLAS BLVD. City ROSEVILLE State CA Zip 95601

CONTRACTOR INFORMATION:

Contractor: LENNAR RENAISSANCE Lic. # 732348 Phone # (916)773-747 Fax # (916)773-4086

PROJECT INFORMATION:

Land Use Zone R/A Occupancy Group R3 Construction Type UN Fed Code 1A  
 No. of stories: 2 No. of rooms: \_\_\_\_\_ Street width: 40'  
 1<sup>st</sup> Floor Area 1798 2<sup>nd</sup> Floor Area 1824 Basement N/A Roof Material TILE

AREA IN SQUARE FOOT OF:	EXISTING	NEW
Dwelling/Living	_____	<u>3622</u>
Garage/Storage	_____	<u>700</u>
Decks/Balconies	_____	_____
Carports	_____	_____

SCOPE OF WORK: NEW CONSTRUCTION SFD

FOR OFFICE USE ONLY:

- Information above complete
- Violation files checked
- Standard setbacks
- County Sewer
- AR Flood Waiver required
- Flood Elevation Certificate Required
- Water Development Infill Area
- Planning Approval
- Design Review Approval
- Special Fee Districts Apply: \_\_\_\_\_

NEW STRUCTURES & ADDITIONS

\*THE FOLLOWING MUST BE PROVIDED IN ORDER TO SUBMIT FOR PLAN REVIEW\*

- 2 COMPLETE PLANS, LEGIBLE & DRAWN TO SCALE
  - 3 SETS IF PROJECT IS IN A DESIGN REVIEW AREA
  - Title 24 Energy Compliance documentation
  - Grading and Erosion Control Questionnaire
  - 11" x 17" copy of floor plan for County Assessor
  - Plan Review Fees
- \* Plans to include: site plan, floor plan, elevations, roof/ceiling plan, foundation and structural framing details, and structural calculations for non-conforming structures.

Date: \_\_\_\_\_ Received by (staff): \_\_\_\_\_

ACTIVITY/PERMIT # \_\_\_\_\_

# KwikKote

No. 200-005225

## Stucco System Installation Card

**Job Name:** SOMERSET  
**Address:** 1750 BAINES AVE.  
SACRAMENTO, CA  
**Lot #:** 0000025

**Stucco System Trade Name:** KWIK KOTE  
**Stucco System Manufacturer:** KWIK KOTE CORP.

**ICBO Evaluation Service, Inc.**  
**Report No.** 3607  
**Date of Job Completion:**

**Home Builder:** LENNAR RENAISSANCE  
**Address:** 2240 DOUGLAS BLVD #250  
ROSEVILLE, CA

**Stucco Contractor:** KENYON PLASTERING, INC.  
**Address:** PO BOX 2077  
North Highlands, CA

**Telephone Number:** 916/349-8191

**Approved Contractor Number as  
issued by the Stucco Manufacturer:** 1001

**Card Print Date:** 02/14/2002

This is to certify that the stucco system on the building exterior at the above address had been installed in accordance with the evaluation report specified above and the manufacturer's instructions.

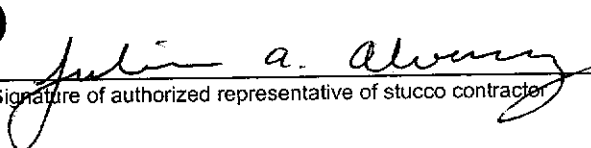
  
\_\_\_\_\_  
Signature of authorized representative of stucco contractor

4-23-02  
\_\_\_\_\_  
Date

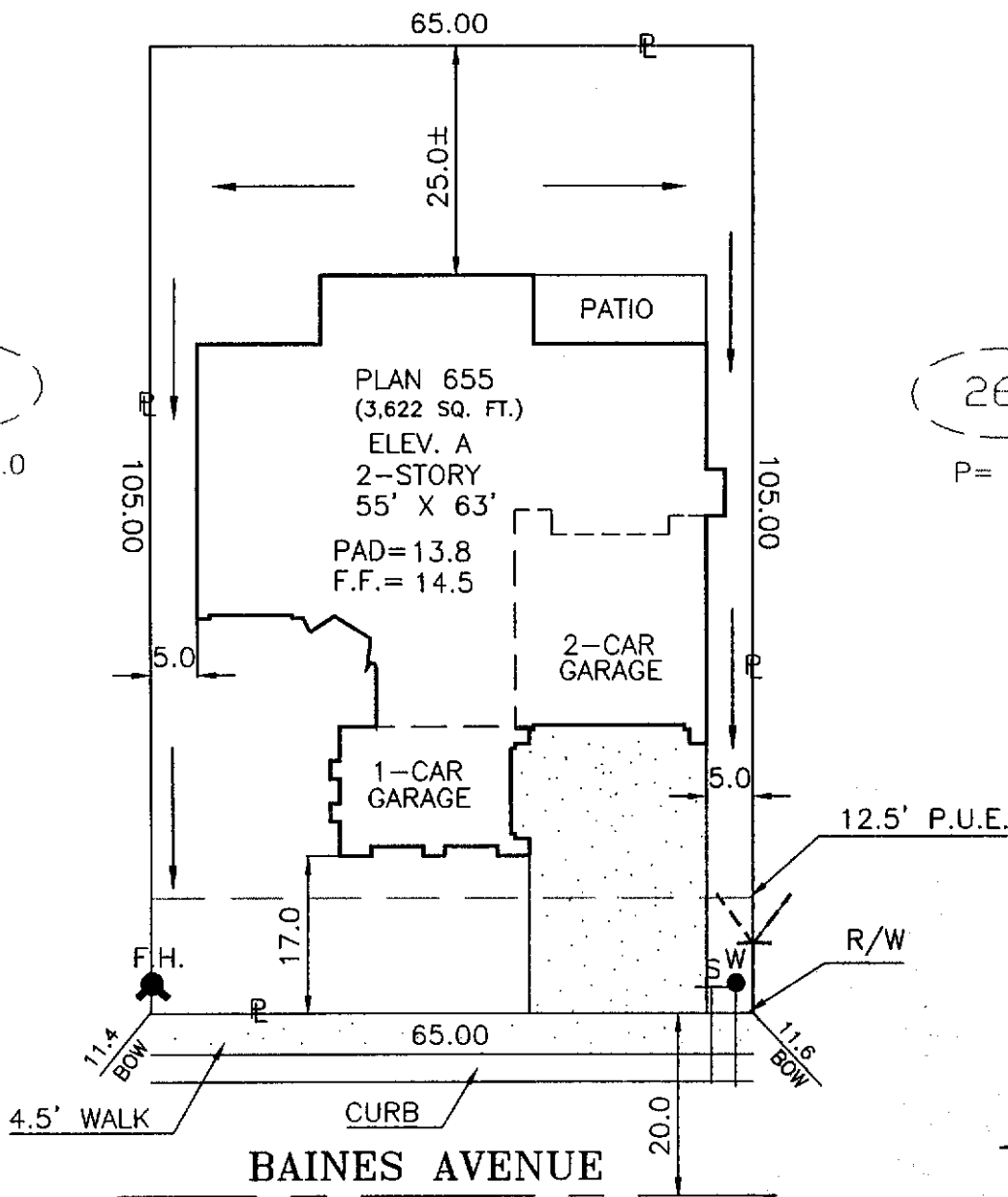

24  
P= 14.0

26  
P= 13.3

DIMENSIONS SHOWN ARE APPROXIMATE EXCEPT FOR MINIMUMS REQUIRED BY ORDINANCE. THIS PLOT DOES NOT REFLECT AS BUILT CONDITIONS AND MAY VARY FROM THIS PLAN.

<b>RENAISSANCE HOMES</b> 2240 DOUGLAS BLVD. SUITE 250, ROSEVILLE, CALIFORNIA 95661 PHONE (916) 773-4083 FAX (916) 773-4086		SOMERSET		PLOT PLAN	
		NORTHPOINTE PARK UNIT 12 CITY OF SACRAMENTO SACTO. COUNTY CALIFORNIA		NOTES:	
ADDRESS: 1750 BAINES AVENUE		LOT COV: 36.4 %		APN:	
PLAN NO.: 655-A	LOT SQ. FT.: 6,825	REAR YARD COVERAGE:		%	
DRAWN BY: R.P.	APPROVED BY: <i>[Signature]</i>	DATE: 8/31/01	SCALE: 1"=20'	LOT 25	