

CITY OF SACRAMENTO
1231 I Street, Sacramento, CA 95814

Permit No: 9908107
Insp Area: 4

Site Address: 1426 MAYFIELD ST SAC
Parcel No: 225-1120-028
N

NORTHPOINTE PARK UNIT 14 LOT 28
Sub-Type: NSFR
Housing (Y/N):

CONTRACTOR
11 NNAR RENAISSANCE INC.
2240 DOUGLAS BL.
ROSEVILLE CA. 95661

OWNER

ARCHITECT

Nature of Work: MP 2136 2 STORY 10 ROOM SFR

CONSTRUCTION LENDING AGENCY: I hereby affirm under penalty of perjury that there is a construction lending agency for the performance of the work for which this permit is issued (Sec. 3097, Civ. C).

Lender's Name _____ Lender's Address _____

LICENSED CONTRACTORS DECLARATION: I hereby affirm under penalty of perjury that I am licensed under provisions of Chapter 9 (commencing with section 7000) of Division 3 of the Business and Professions Code and my license is in full force and effect.

License Class B License Number 732348 Date 2/28/01 Contractor Signature [Signature]

OWNER-BUILDER DECLARATION: I hereby affirm under penalty of perjury that I am exempt from the contractors License Law for the following reason (Sec. 7031.5, Business and Professions Code, any city or county which requires a permit to construct, alter, improve, demolish, or repair any structure, prior to its issuance, also requires the applicant for such permit to file a signed statement that he or she is licensed pursuant to the provisions of the Contractors License Law (Chapter 9 (commencing with Section 7000) of Division 8 of the Business and Professions Code) or that he or she is exempt therefrom and the basis for the alleged exemption. Any violation of Section 7031.5 by any applicant for a permit subjects the applicant to a civil penalty of not more than five hundred dollars (\$500.00).

_____ as a owner of the property, or my employees with wages as their sole compensation, will do the work, and the structure is not intended or offered for sale (Sec. 7044, Business and Professional Code: The Contractors License Law does not apply to an owner of property who builds or improves thereon, and who does such work himself or herself or through his/her own employees, provided that such improvements are not intended or offered for sale. If, however, the building or improvement is sold within one year of completion, the owner-builder will have the burden of proving that he/she did not build or improve for the purpose of sale.)

_____ as owner of the property, am exclusively contracting with licensed contractors to construct the project (Sec. 7044, Business and Professions Code. The Contractors License Law does not apply to an owner of property who builds or improves thereon, and who contracts for such projects with a contractor(s) licensed pursuant to the Contractors License Law).

I am exempt under Sec. _____ B & PC for this reason: _____

Date _____ Owner Signature _____

IN ISSUING THIS BUILDING PERMIT, the applicant represents, and the city relies on the representation of the applicant, that the applicant verified all measurements and locations shown on the application or accompanying drawings and that the improvement to be constructed does not violate any law or private agreement relating to permissible or prohibited locations for such improvements. This building permit does not authorize any illegal location of any improvement or the violation of any private agreement relating to location of improvements.

I certify that I have read this application and state that all information is correct. I agree to comply with all city and county ordinances and state laws relating to building construction and hereby authorize representative(s) of this city to enter upon the abovementioned property for inspection purposes.

Date 11-15-99 Applicant/Agent Signature [Signature]

WORKER'S COMPENSATION DECLARATION: I hereby affirm under penalty of perjury one of the following declarations:

_____ I have and will maintain a certificate of consent to self-insure for workers' compensation as provided for by Section 3700 of the Labor Code, for the performance of work for which the permit is issued.

_____ I have and will maintain workers' compensation insurance, as required by Section 3700 of the Labor Code, for the performance of the work for which this permit is issued. My workers' compensation insurance carrier and policy number are:

Carrier CONTINENTAL CAS. INC. Policy Number WC166792277 Exp Date 06/01/2000

_____ (This section need not be completed if the permit is for \$100 or less) I certify that in the performance of the work for which this permit is issued, I shall not employ any person in any manner so as to become subject to the workers' compensation laws of California and agree that if I should become subject to the workers' compensation provisions of Section 3700 of the Labor Code, I shall forthwith comply with those provisions.

Date 11-15-99 Applicant Signature [Signature]

WARNING - FAILURE TO SECURE WORKER'S COMPENSATION COVERAGE IS UNLAWFUL AND SHALL SUBJECT AN EMPLOYER TO CRIMINAL PENALTIES AND CIVIL FINES UP TO ONE HUNDRED THOUSAND DOLLARS (\$100,000) IN ADDITION TO THE COST OF COMPENSATION, DAMAGES AS PROVIDED FOR IN SECTION 3706 OF THE LABOR CODE, INTEREST AND ATTORNEY'S FEE.

THIS PERMIT SHALL EXPIRE BY LIMITATION IF WORK IS NOT COMMENCED WITHIN 180 DAYS.

OMEGA PRODUCTS INTERNATIONAL, INC.

DIAMOND WALL INSULATING STUCCO SYSTEM

JOB ADDRESS:

WINCHEST Homes
E. K. MOORE

ICBO Report #4004

Date of Job Completion 3-24-00

PLASTERING CONTRACTOR:

Name: STUCCO WORKS INC.

Address: 5900 WAREHOUSE WAY, SACRAMENTO, CALIF.

Telephone No: (916) 383-6699

Contractor Number of Diamond Wall System 2175

This is to certify that the exterior coating system on the building exterior at the above address has been installed in accordance with the evaluation report specified above and the manufacturer's instructions.

[Signature]
Signature of authorized representative of
Plastering Contractor

This evaluation card must be presented to the building inspector after work is completed for final inspection.

RESIDENTIAL BUILDING PERMIT APPLICATION

New Construction Addition Remodels Other

Project Address: 1426 MAYFIELD STREET Assessor Parcel # 225-112-028

OWNER INFORMATION: LOT # 28

Legal Property Owner: LENNAR RENAISSANCE Phone # (916) 773-7471
Owner Address: 2240 DOUGLAS BLVD. City ROSEVILLE State CA Zip 95661

CONTRACTOR INFORMATION:

Contractor: LENNAR RENAISSANCE Lic. # 732348 Phone # (916) 773-7471 Fax # (916) 773-4086

PROJECT INFORMATION:

Land Use Zone R1A Occupancy Group R3 Construction Type UM Fed Code 1A
No. of stories: 2 No. of rooms: 5 Street width: _____
1st Floor Area 1116 2nd Floor Area 1020 Basement _____ Roof Material TILE

AREA IN SQUARE FOOT OF:	EXISTING	NEW
Dwelling/Living	_____	<u>2136</u>
Garage/Storage	_____	<u>469</u>
Decks/Balconies	_____	<u>126</u>
Carports	_____	_____

SCOPE OF WORK: NEW CONSTRUCTION SFD MAP 203

FOR OFFICE USE ONLY:

Information above complete AR Flood Waiver required Planning Approval
 Violation files checked Flood Elevation Certificate Required Design Review Approval
 Standard setbacks Water Development Infill Area Special Fee Districts Apply : _____
 County Sewer

NEW STRUCTURES & ADDITIONS

❖ THE FOLLOWING MUST BE PROVIDED IN ORDER TO SUBMIT FOR PLAN REVIEW

2 COMPLETE PLANS, LEGIBLE & DRAWN TO SCALE ❖ Plans to include: site plan, floor plan, elevations, roof/ceiling plan, foundation and structural framing details, and structural calculations for non-conforming structures.
 3 SETS IF PROJECT IS IN A DESIGN REVIEW AREA
 Title 24 Energy Compliance documentation 11" x 17" copy of floor plan for County Assessor
 Grading and Erosion Control Questionnaire Plan Review Fees

Date _____ Received by: (staff) _____

ACTIVITY/PERMIT # _____



3050 Industrial Blvd.
 PO Box 1137
 West Sacramento
 California 95691
 916-372-1434

WALLACE • KUHL & ASSOCIATES INC.
 GEOTECHNICAL ENGINEERING • CONSTRUCTION TESTING

DATE 2-29-00		JOB NO			WEATHER		TEMP. ° at		AM	
PROJECT		Technician I <input type="checkbox"/>			Staff E/G <input type="checkbox"/>					
LOCATION Lot # 26, 27, 29		Technician II <input type="checkbox"/>			Project E/G <input type="checkbox"/>					
TYPE OF WORK Pull TEST		Technician III <input type="checkbox"/>			Senior E/G <input type="checkbox"/>					
Inside 50 mi. radius <input type="checkbox"/>		Outside 50 mi. radius <input type="checkbox"/>			Nuclear Densities <input type="checkbox"/>		Principal E/G <input type="checkbox"/>			
PERSONNEL		REG. HRS	OT HRS	TOTAL HRS	TRAVEL	ON JOB	VEHICLE		MILES	

OBSERVATIONS:

All anchors passed pull TEST, Anchors pulled are at the following locations

FIELD REPORT Signed _____

CERTIFICATION OF INSULATION

PART GENERAL

PART AREAS INSULATED

DATE

ADDRESS OR TRACT

SACRAMENTO INSULATION CONTRACTORS

WINDMILLST

LOT # *28*

- P.O. BOX 854, WEST SACRAMENTO, CA 95691 LIC. #202026
- 1309 MELODY ROAD, MARYSVILLE, CA 95901 LIC. #202026
- P.O. BOX 9651, FRESNO, CA 93793-9651 LIC. #202026
- P.O. BOX 1631, RENO, NV 89505 LIC. #10675
- 3326 A PONDEROSA WAY, LAS VEGAS, NV 89118 LIC. #10675

GLENMERE

DATE INSULATION COMPLETED

3-31-00

WALLS

CEILING

FLOORS

(SQUARE FEET)

(SQUARE FEET)

(SQUARE FEET)

TYPE OF INSULATION

TYPE OF INSULATION

TYPE OF INSULATION

MATERIAL

FIBERGLASS

MATERIAL

FIBERGLASS

MATERIAL

FIBERGLASS

FORM

BATTS

FORM

BATTS & BLOW

FORM

BATTS

MANUFACTURER'S PRODUCT I.D.

MANUFACTURER'S PRODUCT I.D.

MANUFACTURER'S PRODUCT I.D.

MANUFACTURER

OCF

MANUFACTURER

OCF

BAGS

MANUFACTURER

OCF

R-VALUE
INSTALLED

APPLIED
THICKNESS

R-VALUE
INSTALLED

APPLIED
THICKNESS

MIN. INSTALLED
WEIGHT PER
SQUARE FOOT

R-VALUE
INSTALLED

APPLIED
THICKNESS

*13
19*

*5 1/4"
5 1/2"*

*38
38*

*12 1/4"
14 3/4"*

KNEE WALLS IF R-VALUE IS OTHER THAN WALLS ABOVE

MATERIAL

FIBERGLASS

FORM

BATTS

R VALUE

MANUFACTURER

OCF

AIR INFILTRATION SEALANT

MATERIAL

FORM

MANUFACTURER

W R GRACE

THIS IS TO CERTIFY THAT INSULATION AND/OR SEALANT HAS BEEN INSTALLED IN CONFORMANCE WITH APPLICABLE CODES, MATERIAL STANDARDS AND REGULATIONS.

SIGNATURE - INSULATION CONTRACTOR

Bill Harding

TITLE

MANAGER

DATE

3-21-00

SIGNATURE - GENERAL CONTRACTOR

[Signature]

TITLE

CONST. MGR.

DATE

9/26/00

REMARKS

This Plot Plan is for the purpose of showing the house to be constructed on the lot and may not represent the final as-built configuration of the property or improvements thereon. Setbacks, other than minimum ordinance, are approximate only and must not be assumed to be precise.

ISSUED

1994

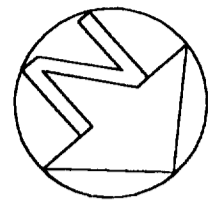

SCALE: 1" = 20'

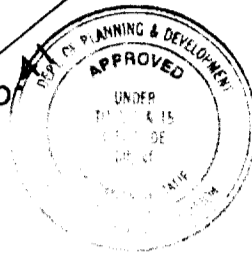

This set of plans and specifications must be kept on the job at all times and it is unlawful to make any changes or alterations from the same without written permission from the Building Inspection Division.

The approval of this plan and specification SHALL NOT be held to permit or approve the violation of any City Ordinance or State Law.

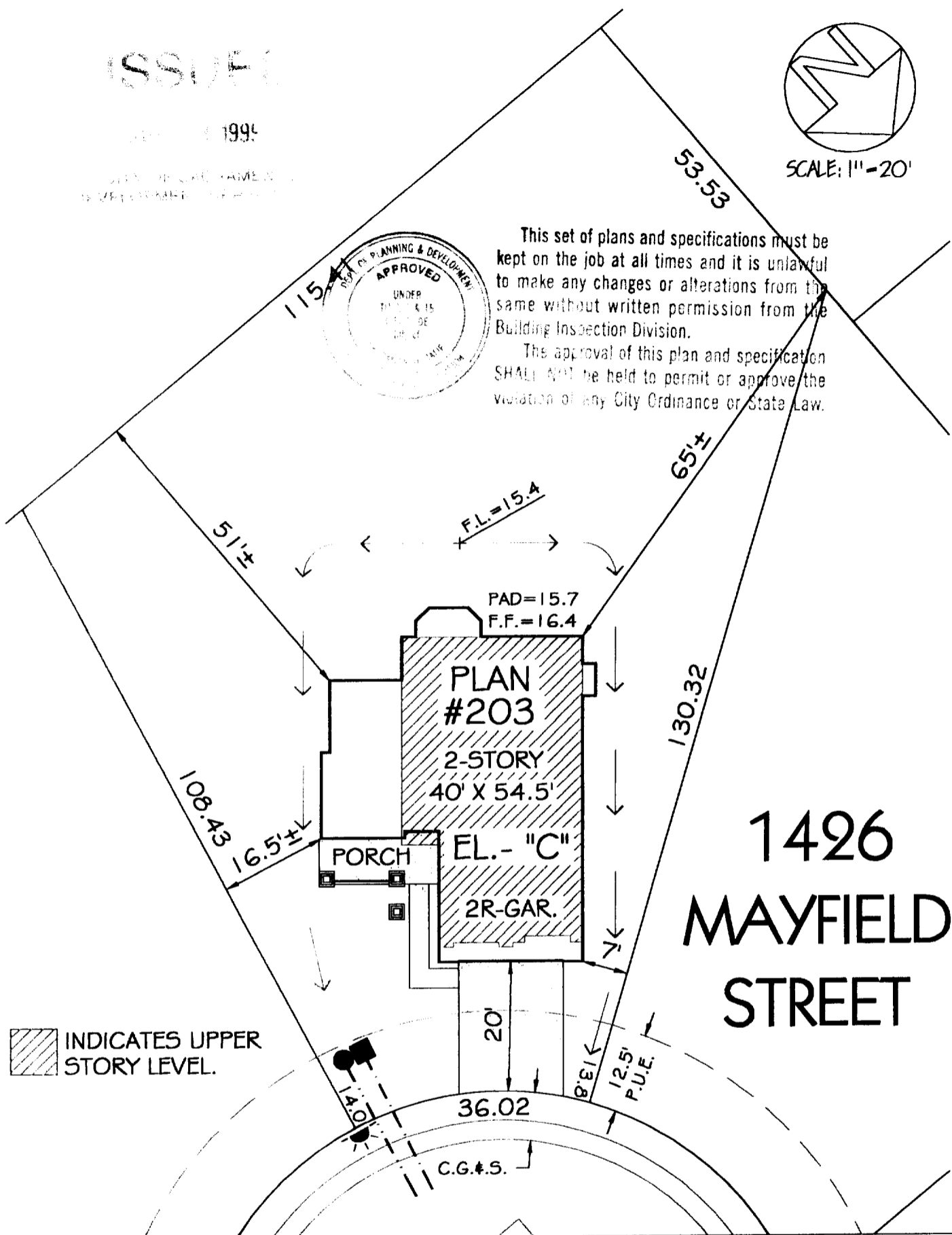

1426
MAYFIELD
STREET

INDICATES UPPER STORY LEVEL.

LOT COVERAGE	
Lot Area:	11904 s.f.
Building:	1585 s.f.
Building/Lot Area:	13 %

RETAINING WALL	
Height:	_____
Length:	_____
Distance From P.L.:	_____

SYMBOLS	
Drainage Inlet:	
Fire Hydrant:	
Street Light:	
Sewer:	
Sign:	
Water:	
Transformer Pad:	

Winncrest Homes
A Lennar Company

Glenmere
a Northpointe Park Village Community

Home Site #28
@
NORTHPOINTE PARK VILLAGE No. 14
CITY OF SACRAMENTO, CALIFORNIA
A.P.N.: 225-112-028-000

NOTES
1. MEASUREMENTS ALONG CURVED LINES ARE ARC LENGTHS, U.O.N.

BCB	6/22/99	GRS	
DRAWN BY	DATE	CHK'D BY	DATE

1" = 20'
DRWG SCALE