



Parks and Recreation Commission
October 4, 2007

AGENDA ITEM 9

DEPARTMENT OF
PARKS AND RECREATION

CITY OF SACRAMENTO
CALIFORNIA

915 I STREET
5th Floor
SACRAMENTO, CA
95814

Park Planning, & Development
Services

September 19, 2007

PH 916-808-5200
FAX 916-808-8266

Parks and Recreation Commission
Sacramento, California

Honorable Members in Session:

SUBJECT: Golden Poppy Park (Park 6E) Master Plan and Park Name

LOCATION AND COUNCIL DISTRICT: 5765 Tres Pieza Drive
Planning Area 10, Council District 1

RECOMMENDATION: Staff recommends supporting the naming of Park 6E to Golden Poppy Park and supporting the Proposed Golden Poppy Park Master Plan.

CONTACT PERSON: J.P. Tindell, Park Planning & Development Manager, 808-1955

FOR COMMISSION MEETING: October 4, 2007

SUMMARY:

Staff seeks support to name Park 6E as Golden Poppy Park as well as support of the proposed Golden Poppy Park Master Plan.

BACKGROUND INFORMATION:

Park 6E is a 2-acre neighborhood park located off Elkhorn Boulevard, east of Highway 99 (Attachment A, page 4).

Two public workshops were held with the community to develop the proposed Golden Poppy Park Master Plan. Community input for the park design was obtained from the first meeting. The community reviewed and supported the proposed Golden Poppy Park Master Plan at the final public meeting on August 6, 2007.



Optimize the Experience of Living!

The proposed Golden Poppy Park Master Plan includes the following amenities: a continuous decomposed granite jogging trail along the park's perimeter, meandering pedestrian pathways throughout the park, an adventure play area with swings, interactive water-play misters, seating areas, a sheltered large group picnic area with picnic tables, barbeque grills, trash receptacles, a multi-purpose turf field, a basketball court with a seating and viewing area, and landscape development of the entire site with turf mounds, canopy shade trees, shrubs, and ground cover.

The Parks and Recreation Commission's Park Planning, Design and Development Committee reviewed and supported the Golden Poppy Park Master Plan on September 17, 2007.

The park is expected to begin construction in spring of 2008 and be completed by winter 2009.

FINANCIAL CONSIDERATIONS:

There are adequate funds from Park Development Impact Fees (\$695,000) in the project's budget.

ENVIRONMENTAL CONSIDERATIONS:

Staff will prepare all necessary environmental review provisions for this master plan as required under the California Environmental Quality Act.

POLICY CONSIDERATIONS:

Providing parks and recreation facilities is consistent with the City's strategic plan to achieve sustainability and liveability and to expand economic development throughout the City. This is part of the Park Development Process for park planning as stated in the *Parks and Recreation Master Plan 2005-2010*.

CONSISTENCY WITH GOALS OF THE CITY OF SACRAMENTO GREENPRINT:

The goals of the Greenprint are to optimize the benefits of trees throughout our region, to create sustainable urban forests, and to build community-wide appreciation for our urban forests.

The master plan for Golden Poppy Park provides a significant addition to the City's urban forest particularly in the area of tree species with large canopies and tree species suited to the Sacramento climate. In addition, the trees proposed in this master plan will make a contribution to clean air and water, stormwater runoff reduction, energy conservation, improved public health, and increased property values.

Therefore, the City of Sacramento Parks and Recreation Commission finds that adoption of the proposed master plan for Golden Poppy Park is consistent with the Greenprint.

ESBD CONSIDERATIONS:

No goods or services are being purchased in association with this report.

Recommendation Approved:



J.P. TINDELL, M.S.

Planning and Development Manager

Attachment A – Project Location Map

Attachment B – Golden Poppy Park Master Plan

Attachment A – Project Location Map



City of Sacramento Department of Parks and Recreation Golden Poppy Park

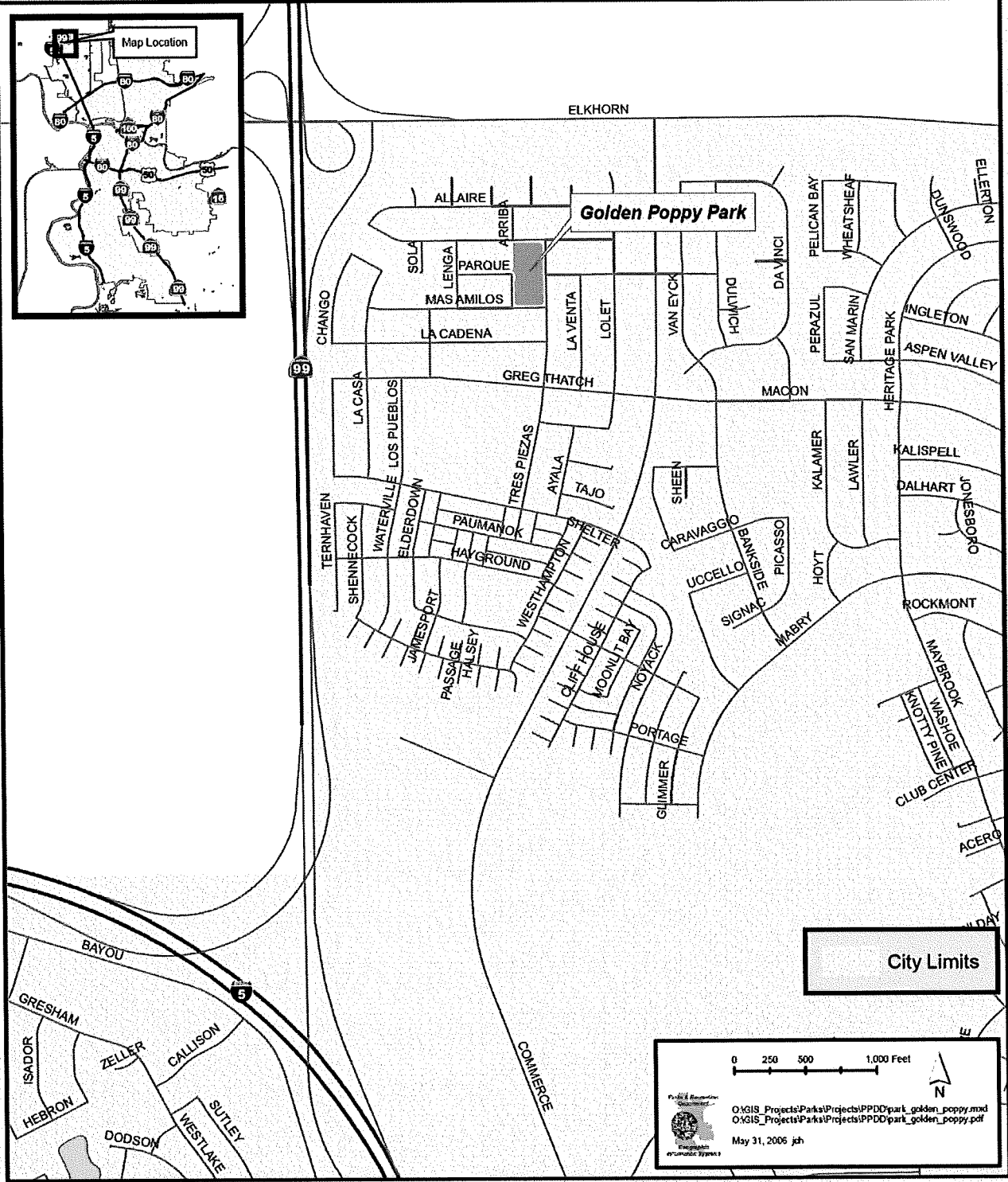
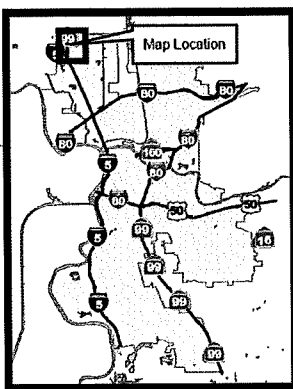

Attachment B – Golden Poppy Park Master Plan

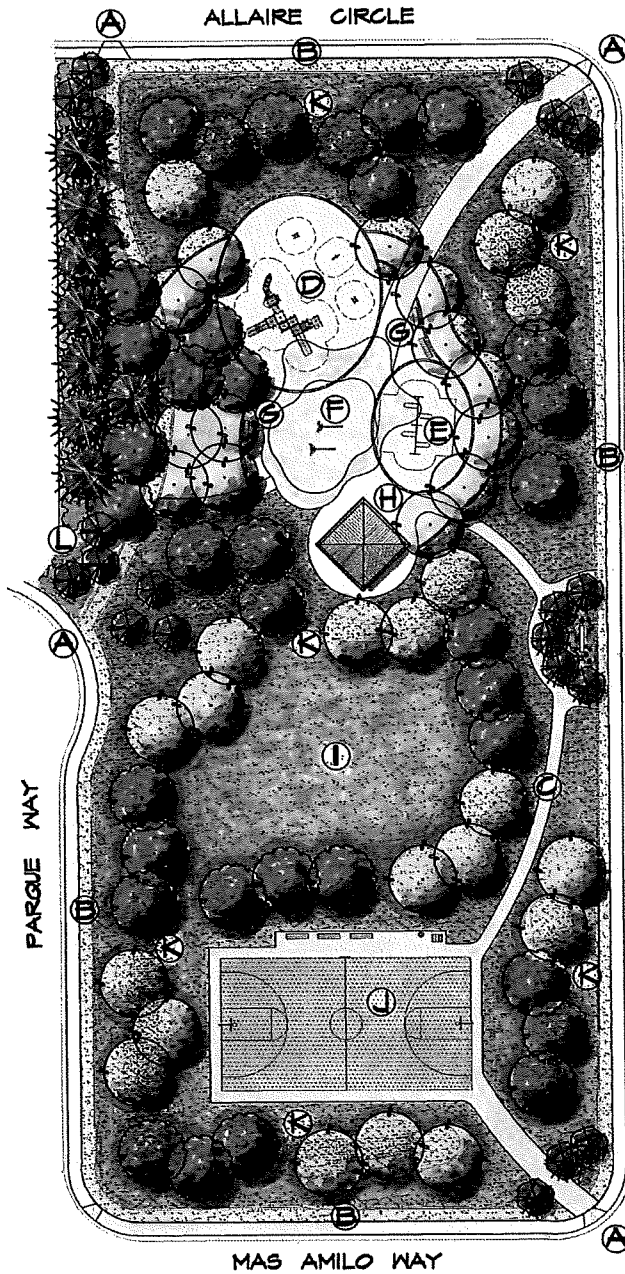

PARK ELEMENTS

- A. MAIN PARK ENTRY**
-Park signage with accent tree and shrub plantings.
- B. JOGGING TRAIL**
-Continuous decomposed granite jogging trail along the park's perimeter.
- C. MEANDERING PEDESTRIAN PATHWAY**
-Walking paths to all areas within the park.
- D. ADVENTURE PLAY AREA**
-Playground for older children (5-12 year olds).
- E. SWINGS**
- F. MISTER**
-Interactive water play mister.
- G. SEATING AREA**
-Shaded sitting area that overlooks the adventure play and mister area.
- H. GAZEBO**
-Sheltered picnic facility with picnic tables, BBQ grills and trash receptacles for families or large groups.
- I. MULTI-PURPOSE TURF FIELD**
-Open, flat turf area for active informal game play.
- J. BASKETBALL COURT**
-Basketball court with seating and ADA accessible viewing area.
- K. BERMING**
-Earth mounds provide topography, informal seating opportunities, definition of space and buffer from the adjacent streets.
- L. NATURAL AREAS**
-Dense tree groves with drought tolerant landscaping to buffer adjacent residential homes from the park site.

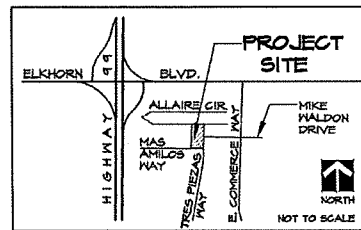

VICINITY MAP

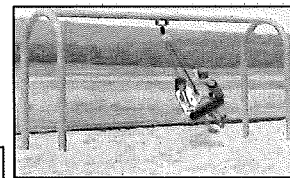
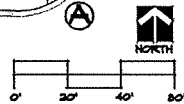

TIRE SWING

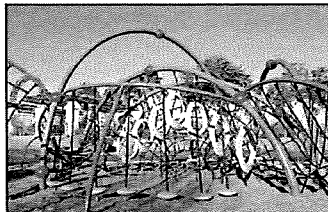

ADVENTURE PLAY (AGES 5- 12)

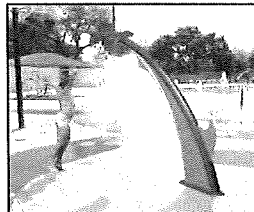

MISTER

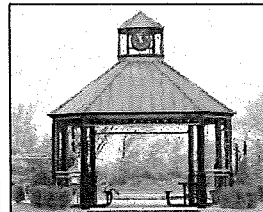

GAZEBO



CONCRETE WHALE

GOLDEN POPPY PARK MASTER PLAN
2 ACRE NEIGHBORHOOD PARK

CITY OF SACRAMENTO
 DEPARTMENT OF PARKS AND RECREATION
 LANDSCAPE ARCHITECTURE SECTION



DATE: AUGUST 13, 2007