

CITY OF SACRAMENTO
1231 I Street, Sacramento, CA 95814

Permit No: 0517885
Insp Area: 4
Thos Bros:
Sub-Type: NSFR
Housing (Y/N): N

Site Address: 3018 BUCHMAN CR SAC
Parcel No: RIVERDALE NORTH VIL 2 LOT 4

CONTRACTOR
BEAZER HOMES
3721 DOUGLAS BL. STE. 100
ROSEVILLE CA 95661

OWNER

ARCHITECT

Nature of Work: MP 1775 2 STORY 8 RM SFR

CONSTRUCTION LENDING AGENCY : I hereby affirm under penalty of perjury that there is a construction lending agency for the performance of the work for which this permit is issued (Sec. 3097, Civ. C).

Lender's Name _____ Lender's Address _____

LICENSED CONTRACTORS DECLARATION: I hereby affirm under penalty of perjury that I am licensed under provisions of Chapter 9 (commencing with section 7000) of Division 3 of the Business and Professions Code and my license is in full force and effect.

License Class B License Number 724191 Date 12/22/05 Contractor Signature N. Collins

OWNER-BUILDER DECLARATION: I hereby affirm under penalty of perjury that I am exempt from the contractors License Law for the following reason (Sec. 7031.5, Business and Professions Code; any city or county which requires a permit to construct, alter, improve, demolish, or repair any structure, prior to its issuance, also requires the applicant for such permit to file a signed statement that he or she is licensed pursuant to the provisions of the Contractors License Law (Chapter 9 (commencing with Section 7000) of Division 8 of the Business and Professions Code) or that he or she is exempt therefrom and the basis for the alleged exemption. Any violation of Section 7031.5 by any applicant for a permit subjects the applicant to a civil penalty of not more than five hundred dollars (\$500.00);

____ I, as a owner of the property, or my employees with wages as their sole compensation, will do the work, and the structure is not intended or offered for sale (Sec. 7044, Business and Professional Code: The Contractors License Law does not apply to an owner of property who builds or improves thereon, and who does such work himself or herself or through his/her own employees, provided that such improvements are not intended or offered for sale. If, however, the building or improvement is sold within one year of completion, the owner-builder will have the burden of proving that he/she did not build or improve for the purpose of sale.)

____ I, as owner of the property, am exclusively contracting with licensed contractors to construct the project (Sec. 7044, Business and Professions Code: The Contractors License Law does not apply to an owner of property who builds or improves thereon, and who contracts for such projects with a contractor(s) licensed pursuant to the Contractors License Law).

____ I am exempt under Sec. _____ B & PC for this reason: _____

Date _____ Owner Signature _____

IN ISSUING THIS BUILDING PERMIT, the applicant represents, and the city relies on the representation of the applicant, that the applicant verified all measurements and locations shown on the application or accompanying drawings and that the improvement to be constructed does not violate any law or private agreement relating to permissible or prohibited locations for such improvements. This building permit does not authorize any illegal location of any improvement or the violation of any private agreement relating to location of improvements.

I certify that I have read this application and state that all information is correct. I agree to comply with all city and county ordinances and state laws relating to building construction and hereby authorize representative(s) of this city to enter upon the abovementioned property for inspection purposes.

Date 12/22/05 Applicant/Agent Signature N. Collins

WORKER'S COMPENSATION DECLARATION: I hereby affirm under penalty of perjury one of the following declarations:

____ I have and will maintain a certificate of consent to self-insure for workers' compensation as provided for by Section 3700 of the Labor Code, for the performance of work for which the permit is issued.

I have and will maintain workers' compensation insurance, as required by Section 3700 of the Labor Code, for the performance of the work for which this permit is issued. My workers' compensation insurance carrier and policy number are:

Carrier LIBERTY MUTUAL INS CO. Policy Number WA2-65D-004147-082 Exp Date 04/01/2005

____ (This section need not be completed if the permit is for \$100 or less) I certify that in the performance of the work for which this permit is issued, I shall not employ any person in any manner so as to become subject to the workers' compensation laws of California and agree that if I shall become subject to the workers' compensation provisions of Section 3700 of the Labor Code, I shall forthwith comply with those provisions.

Date 12/22/05 Applicant Signature N. Collins

WARNING: FAILURE TO SECURE WORKER'S COMPENSATION COVERAGE IS UNLAWFUL AND SHALL SUBJECT AN EMPLOYER TO CRIMINAL PENALTIES AND CIVIL FINES UP TO ONE HUNDRED THOUSAND DOLLARS (\$100,000) IN ADDITION TO THE COST OF COMPENSATION, DAMAGES AS PROVIDED FOR IN SECTION 3706 OF THE LABOR CODE, INTEREST AND ATTORNEY'S FEES.

THIS PERMIT SHALL EXPIRE BY LIMITATION IF WORK IS NOT COMMENCED WITHIN 180 DAYS.

CITY OF SACRAMENTO
DEC 22 2005
PLANNING AND DEVELOPMENT SERVICES

3018 Buchman Str.

INSTALLATION CERTIFICATE	(Page 2 of 12) CF-6R
Site Address THE SURPRISE COLLECTION AT RIVERDALE NORTH - BOSTON	Permit Number 0517885

An installation certificate is required to be posted at the building site or made available for all appropriate inspections. (The information provided on this form is required) After completion of final inspection, a copy must be provided to the building department (upon request) and the building owner at occupancy, per Section 10-103(a).

FENESTRATION/GLAZING:

Item	Manufacturer/Brand Name (GROUP LIKE PRODUCTS)	Product U-factor ¹ (± CF-1R value) ²	Product SHGC ¹ (± CF-1R value) ²	# of Panels	Total Quantity of Like Product (Optional)	Area Square Foot	Exterior Shading Device or Overhang	Comments/Location/Special Features
1.	XO NO GLAZ	.35	.32	2				
2.	XO GLAZ	.35	.29	2				
3.	SH NO GLAZ	.35	.32	2				
4.	SH GLAZ	.35	.29	2				
5.	PJ NO GLAZ	.34	.35	2				
6.	PJ GLAZ	.34	.31	2				
7.	PATIO DOOR	.35	.34	2				
8.								
9.								
10.								
11.								
12.								
13.								
14.								
15.								

- ¹ Use values from a fenestration product's NFRC label. For fenestration products without an NFRC label, use the default values from Section 116 of the Energy Efficiency Standards.
- ² Installed U-factor must be less than or equal to values from CF-1R. Installed SHGC must be less than or equal to values from CF-1R, or a shading device (exterior or overhang) is installed as specified on the CF-1R. Alternatively, installed weighted average U-factors for the total fenestration area are less than or equal to values from CF-1R. If using default table SHGC values from §116 identify whether tinted or not.

I, the undersigned, verify that the fenestration/glazing listed above my signature: 1) is the actual fenestration product installed; 2) is equivalent to or has a lower U-factor and lower SHGC than that specified in the certificate of compliance (Form CF-1R) submitted for compliance with the *Energy Efficiency Standards* for residential buildings; and 3) the product meets or exceeds the appropriate requirements for manufactured devices (from Part 6), where applicable.

Item #s (if applicable) 1-7	Signature Dennis Mad	Date 3/30/06	Installing Subcontractor (Co. Name) OR General Contractor (Co. Name) OR Owner OR Window Distributor
Item #s (if applicable)	Signature	Date	Installing Subcontractor (Co. Name) OR General Contractor (Co. Name) OR Owner OR Window Distributor
Item #s (if applicable)	Signature	Date	Installing Subcontractor (Co. Name) OR General Contractor (Co. Name) OR Owner OR Window Distributor

Copies to: Building Department, HERS Rater (if applicable) Building Owner at Occupancy

INSTALLATION CERTIFICATE

(page 1 of 4)

CF-6R

Beazer Homes 3018

Buchman Str
0517885

Sunrise Collection
Permit Number

An installation certificate is required to be posted at the building site or made available for all appropriate inspections. (The information provided on this form is required; however, use of this form to provide the information is optional.) After completion of final inspection, a copy must be provided to the building department (upon request) and the building owner at occupancy, per Section 10-103(b).

Plan 1775

HVAC SYSTEMS:

Heating Equipment

Equip. Type (pkg. heat pump)	CEC Certified Mfr Name and Model Number	# of Identical Systems	Efficiency (AFUE, etc.) ¹ (≥CF-1R value)	Duct Location (attic, etc.)	Duct or Piping R-value	Heating Load (Btu/hr)	Heating Capacity (Btu/hr)

Cooling Equipment

Equip. Type (pkg. heat pump)	CEC Certified Compressor Unit Mfr Name and Model Number	# of Identical Systems	Efficiency (SEER, etc.) ¹ (≥CF-1R value)	Duct Location (attic, etc.)	Duct R-value	Cooling Load (Btu/hr)	Cooling Capacity (Btu/hr)

1. ≥ reads greater than or equal to.

I, the undersigned, verify that equipment listed above is: 1) is the actual equipment installed; 2) equivalent to or more efficient than that specified in the certificate of compliance (Form CF-1R) submitted for compliance with the Energy Efficiency Standards for residential buildings; and 3) equipment that meets or exceeds the appropriate requirements for manufactured devices (from the Appliance Efficiency Regulations or Part 6), where applicable.

Signature, Date

Installing Subcontractor (Co. Name)
OR General Contractor (Co. Name) OR Owner

WATER HEATING SYSTEMS:

Heater Type	CEC Certified Mfr Name & Model Number	Distribution Type (Std. Point-of-Use)	If Recirculation Control Type	# of Identical Systems	Rated ² Input (kW or Btu/hr)	Tank Volume (gallons)	Efficiency ² (EF, RE)	Standby ¹ Loss (%)	External Insulation R-value
GAS	A.O. Smith GVR-50	STD	N/A	1	40,000	50	62	N/A	R-20

2 For small gas storage (rated input of less than or equal to 75,000 Btu/hr), electric resistance and heat pump water heaters, list Energy Factor. For large gas storage water heaters (rated input of greater than 75,000 Btu/hr), list Recovery Efficiency, Standby Loss and Rated Input. For instantaneous gas water heaters, list Recovery Efficiency and Rated Input.

Faucets & Shower Heads:

All faucets and showerheads installed are certified to the Commission, pursuant to Title 24, Part 6, Subchapter 2, Section 111.

I, the undersigned, verify that equipment listed above my signature: 1) is the actual equipment installed; 2) is equivalent to or more efficient than that specified in the certificate of compliance (Form CF-1R) submitted for compliance with the Energy Efficiency Standards for residential buildings; and 3) the equipment meets or exceeds the appropriate requirements for manufactured devices (from the Appliance Efficiency Regulations or Part 6), where applicable.

Signature, Date
3/27/06

J.R. Pierce Plumbing Co.
Installing Subcontractor (Co. Name) OR
General Contractor (Co. Name) OR Owner

COPY TO: Building Department
Building Owner at Occupancy

Site Address

An installation certificate is required to be posted at the building site or made available for all appropriate inspections. (The information provided on this form is required; however, use of this form to provide the information is optional.) After completion of final inspection a copy must be provided to the building department (upon request) and the building owner at occupancy, per Section 10-103(b).

HVAC SYSTEMS:

Heating Equipment

Equip. Type (pkg. Heat pump)	CEC Certified Mfr name and Model #	# of Identical Systems	(1) Efficiency (AFUE, etc.) > CF-1R value	Duct Location (attic, etc.)	Duct or Piping R-value	Heating Load (Btu/hr)	Heating Capacity (Btu/hr)	
Furnace	York, #LY8S040A12	1	0.80	Attic	R-6.0	25,259	40,000	PLAN 1007
Furnace	YORK, #LY8S060A12	1	0.80	Attic	R-6.0	28,259	60,000	PLAN 1007/ OPT
Furnace	YORK, #LY8S060A12	1	0.80	Attic	R-6.0	27,354	60,000	PLAN 1385
Furnace	YORK, #LY8S060A12	1	0.80	Attic	R-4.2	31,992	60,000	PLAN 1559
Furnace	YORK, #LY8S060A12	1	0.80	Attic	R-4.2	33,117	60,000	PLAN 1775
Furnace	YORK, #LY8S060A12	1	0.80	Attic	R-4.2	34,131	60,000	PLAN/ SITTING

Cooling Equipment

Equip. Type (pkg. Heat pump)	CEC Certified Compressor Unit Mfr Name and Model #	# of Identical Systems	(1) Efficiency (SEER, etc.) > CF-1R Value	Duct Location (attic, etc.)	Duct R-value	Cooling Load (Btu/hr)	Cooling Capacity (Btu/hr)	
A/C	YORK, #H1RD024	1	13.0	Attic	R-6.0	16,882	20,800	PLAN 1007
A/C	YORK, #H1RD024	1	13.0	Attic	R-6.0	18,286	20,800	PLAN 1007/ OPT
A/C	YORK, #H1RD024	1	13.0	Attic	R-6.0	17,603	20,800	PLAN 1385
A/C	YORK, #H1RD030	1	13.0	Attic	R-4.2	21,364	26,900	PLAN 1559
A/C	YORK, #H1RD030	1	13.0	Attic	R-4.2	23,377	26,900	PLAN 1775
A/C	YORK, #H1RD030	1	13.0	Attic	R-4.2	24,020	26,900	PLAN/ SITTING

(1) > reads greater than or equal to.

I, the undersigned, verify that equipment listed above is: 1) the actual equipment installed, 2) equivalent to or more efficient than that specified in the certificate of compliance (Form CF-1R) submitted for compliance with the *Energy Efficiency Standards* for residential buildings, and 3) equipment that meets or exceeds the appropriate requirements for manufactured devices (from the *Appliance Efficiency Regulations* or Part 6), where applicable.

Signature, Date

Beutler Corporation

Installing Subcontractor (Co. Name)
 OR General Contractor (Co. Name) OR Owner

WATER HEATING SYSTEMS:

Heater Type	CEC Certified Mfr Name & Model #	Distribution Type (Std. point of use)	If Recirculation Control Type	# of Identical Systems	(2) Rated Input (kW or Btu/hr)	Tank Volume (gallons)	(2) Efficiency (EF, RE)	(2) Standby Loss (%)	External Insulation R-value

(2) For small gas storage (rated input of less than or equal to 75,000 Btu/hr), electric resistance and heat pump water heaters, list Energy Factor. For large gas storage water heaters (rated input of greater than 75,000 Btu/hr), list Recovery Efficiency, Standby Loss and Rated Input. For instantaneous gas water heaters, list Recovery efficiency and Rated Input.
 (3) R-12 external insulation is mandatory for storage water heaters with an energy factor of less than 0.58.

Faucets & Shower Heads:

All faucets and showerheads installed are certified to the Commission, pursuant to Title 24, Part 6, Section 111.

I, the undersigned, verify that equipment listed above my signature is: 1) the actual equipment installed; 2) equivalent to or more efficient than that specified in the certificate of compliance (Form CF-1R) submitted for compliance with the *Energy Efficiency Standards* for residential buildings; and 3) equipment that meets or exceeds the appropriate requirements for manufactured devices (from the *Appliance Efficiency Regulations* or Part 6), where applicable.

Signature, Date

Installing Subcontractor (Co. Name)
 OR General Contractor (Co. Name) OR Owner

COPY TO: Building Department
 HERS Provider (if applicable)
 Building Owner at Occupancy

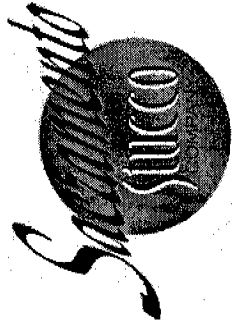

INSTALLATION CARD

Western 1 Kote Exterior Stucco System
Sacramento Stucco Company

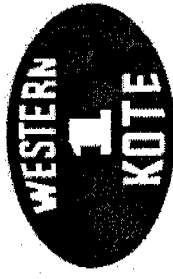

Job Address

BEAZER HOMES

SUNRISE COLLECTION

LOT: 4

ICC Evaluation Services, Inc.
Evaluation Report ESR-1607

Date of Job Completion: March 10, 2006

*3018 Buchman St
0517885*

Plastering Contractor

Name: STUCCO WORKS, INC.

Address: 5900 WAREHOUSE WAY, SACRAMENTO CA 95826

Telephone No.: PHONE: (916) 383-6699 FAX: (916) 383-6668

Approved contractor number as issued by coating manufacturer: 511

This is to certify that the exterior coating system on the building exterior at the above address has been installed in accordance with the evaluation report specified above and the manufacturer's instructions.

[Signature]

Signature of authorized representative or plastering contractor

March 24, 2006

Date

This installation card must be presented to the building inspector after completion of work and before final inspection



INSULATION CONTRACTORS ASSOCIATION OF AMERICA

INSULATION CERTIFICATE

0517885

1321 DUKE STREET, SUITE 303 • ALEXANDRIA, VA 22314 • (703) 739-0356

THIS IS TO CERTIFY THAT INSULATION HAS BEEN INSTALLED IN CONFORMANCE WITH CURRENT ENERGY REGULATIONS, CALIFORNIA ADMINISTRATIVE CODE, TITLE 24, STATE OF CALIFORNIA, IN THE BUILDING LOCATED AT:

BEAZER HOME LOT # F TRACT # AMERICAN
STREET 3018 BOCHMAN St CITY NATOMAS

EXTERIOR WALLS:

MANUFACTURER FR THICKNESS/TYPE 3 1/8 R-VALUE 13/19

CEILINGS:

BATTS: MANUFACTURER FR THICKNESS/TYPE 10 1/4 R-VALUE 30

BLOWN IN: MANUFACTURER CF THICKNESS 12 R-VALUE 30

SQUARE FOOTAGE COVERED 1198 NUMBER OF BAGS USED 21

FLOORS:

MANUFACTURER THICKNESS/TYPE R-VALUE

SLAB ON GRADE: MANUFACTURER THICKNESS/TYPE R-VALUE

WIDTH OF INSULATION INCHES

FOUNDATION WALLS:

MANUFACTURER THICKNESS/TYPE R-VALUE

GENERAL CONTRACTOR CALIFORNIA CONTRACTORS LICENSE # DATE

SIGNATURE TITLE

INSULATION CONTRACTOR ALCAL ARCADE CONTRACTING
CALIFORNIA CONTRACTORS LICENSE #815286
NEVADA CONTRACTORS LICENSE #0055201 DATE 3-6-06

SIGNATURE TITLE

THIS PLOT PLAN IS NOT FOR SALES PURPOSES. THIS PLOT PLAN IS FOR THE PURPOSES OF INDICATING COMPLIANCE WITH ZONING SET BACKS, GENERAL DRAINAGE DIRECTION, AND APPROXIMATE UTILITY CONNECTION. ALL OTHER DATA SHOWN HEREON IS CONCEPTUAL. THIS PLOT PLAN DOES NOT REFLECT AS-BUILT CONDITION, RETAINING WALLS ARE OPTIONAL AND MAY OR MAY NOT BE CONSTRUCTED.

SCALE: 1" = 20'

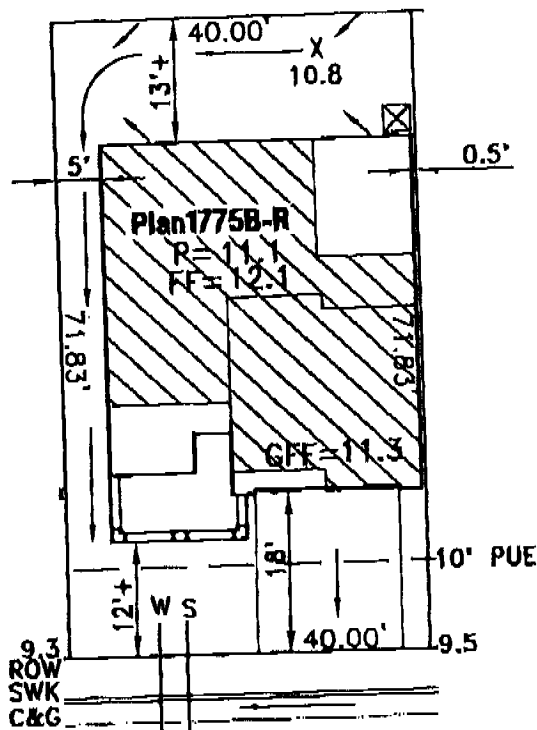

REVISED

ROUTING/APPROVAL		
	✓	INITIALS
President		
Project Development		
Construction		
Marketing		
Admin.		
Accounting		

This set of plans and specifications must be held in full force and effect at all times and it is unlawful to alter, amend, modify, change, or alter in any way the plans and specifications or to make any changes or alterations from the original plans and specifications without the written consent of the engineer. No part of this plan and specification shall be held to permit or approve the violation of any City Ordinance or State Law.

- - UTILITY SERVICE BOX
- - DRAIN INLET
- - STREET LIGHT
- ▲ - TRANSFORMER
- SL - SERVICE POINT
- ⊙ - FIRE HYDRANT
- GFF = GARAGE FINISHED FLOOR

RIVERDALE VILLAGE 2
 "THE SUNRISE COLLECTION" FOR BEAZER HOMES
 PLOT PLAN FOR LOT 04

A.P.N.:
 LOT AREA: 2873 S.F.
 ADDRESS:
 CITY OF SACRAMENTO, CALIFORNIA

WOOD RODGERS
 engineering - planning - mapping - surveying
 3301 C STREET, BLDG. 100-B, SACRAMENTO, CA 95816
 phone: (916) 341-7782 fax: (916) 341-7767
 DATE: 9-22-05 DRAWN: GDM 1055.029