

CITY OF SACRAMENTO
1231 I Street, Sacramento, CA 95814

Permit No: 0108607
Insp Area: 4

Site Address: 190 FORASTERA CR SAC
Parcel No: 225-1650-054 RIVERVIEW 2-3A LOT 54

Sub-Type: NSFR
Housing (Y/N): N

CONTRACTOR
D. R. HORTON INC
110 BLUE RAVINE RD STE. 209
FOLSOM CA. 95630

OWNER

ARCHITECT

Nature of Work: MP 1430 - 1 STORY 6 ROOM SFR

CONSTRUCTION LENDING AGENCY: I hereby affirm under penalty of perjury that there is a construction lending agency for the performance of the work for which this permit is issued (Sec. 3097, Civ. C.).

Lender's Name _____ Lender's Address _____

LICENSED CONTRACTORS DECLARATION: I hereby affirm under penalty of perjury that I am licensed under provisions of Chapter 9 (commencing with section 7000) of Division 3 of the Business and Professions Code and my license is in full force and effect.

License Class B License Number 750190 Date 7/1/00 Contractor Signature N. Collins

OWNER-BUILDER DECLARATION: I hereby affirm under penalty of perjury that I am exempt from the contractors License Law for the following reason (Sec. 7031.5, Business and Professions Code, any city or county which requires a permit to construct, alter, improve, demolish, or repair any structure, prior to its issuance, also requires the applicant for such permit to file a signed statement that he or she is licensed pursuant to the provisions of the Contractors License Law (Chapter 9, commencing with Section 7000) of Division 8 of the Business and Professions Code) or that he or she is exempt therefrom and the basis for the alleged exemption: Any violation of Section 7031.5 by any applicant for a permit subjects the applicant to a civil penalty of not more than five hundred dollars (\$500.00).

_____, I, as a owner of the property, or my employees with wages as their sole compensation, will do the work, and the structure is not intended or offered for sale (Sec. 7044, Business and Professional Code). The Contractors License Law does not apply to an owner of property who builds or improves thereon, and who does such work himself or herself or through his/her own employees, provided that such improvements are not intended or offered for sale. If, however, the building or improvement is sold within one year of completion, the owner-builder will have the burden of proving that he/she did not build or improve for the purpose of sale.

_____, I, as owner of the property, am exclusively contracting with licensed contractors to construct ~~the project~~ (Sec. 7044, Business and Professions Code). The Contractors License Law does not apply to an owner of property who builds or improves thereon, and who contracts for such projects with a contractor(s) licensed pursuant to the Contractors License Law.

I am exempt under Sec. _____ B & P.C. for this reason: _____
Date _____ Owner Signature _____

DATE
JUL 17 2000
NEIGHBORHOODS, PLANNING
AND DEVELOPMENT SERVICES

IN ISSUING THIS BUILDING PERMIT, the applicant represents, and the city relies on the representation of the applicant, that the applicant verified all measurements and locations shown on the application or accompanying drawings and that the improvement to be constructed does not violate any law or private agreement relating to permissible or prohibited locations for such improvements. This building permit does not authorize any illegal location of any improvement or the violation of any private agreement relating to location of improvements.

I certify that I have read this application and state that all information is correct. I agree to comply with all city and county ordinances and state laws relating to building construction and hereby authorize representative(s) of this city to enter upon the abovementioned property for inspection purposes.

Date 7/1/00 Applicant Agent Signature N. Collins

WORKER'S COMPENSATION DECLARATION: I hereby affirm under penalty of perjury one of the following declarations:
_____, I have and will maintain a certificate of consent to self-insure for workers' compensation as provided for by Section 3700 of the Labor Code, for the performance of work for which the permit is issued.

I have and will maintain workers' compensation insurance, as required by Section 3700 of the Labor Code, for the performance of the work for which this permit is issued. My workers' compensation insurance carrier and policy number are:

Carrier ARGONAUT INS CO Policy Number WC62600115505 Exp Date 07/01/2000

_____, (This section need not be completed if the permit is for \$100 or less) I certify that in the performance of the work for which this permit is issued, I shall not employ any person in any manner so as to become subject to the workers' compensation laws of California and agree that if I should become subject to the workers' compensation provisions of Section 3700 of the Labor Code, I shall forthwith comply with those provisions.

Date 7/1/00 Applicant Signature N. Collins

WARNING: FAILURE TO SECURE WORKER'S COMPENSATION COVERAGE IS UNLAWFUL AND SHALL SUBJECT AN EMPLOYER TO CRIMINAL PENALTIES AND CIVIL FINES UP TO ONE HUNDRED THOUSAND DOLLARS (\$100,000) IN ADDITION TO THE COST OF COMPENSATION, DAMAGES AS PROVIDED FOR IN SECTION 3706 OF THE LABOR CODE, INTEREST AND ATTORNEY'S FEE.

THIS PERMIT SHALL EXPIRE BY LIMITATION IF WORK IS NOT COMMENCED WITHIN 180 DAYS.

Lot-54

OMEGA PRODUCTS CORP.
DIAMOND WALL INSULATING STUCCO SYSTEM

JOB ADDRESS:

1000 Report 11004

D.R. HONAN
PAVE VIEW

Date of Job Completion 7/8/01

PLASTERING CONTRACTOR:

Name: STUCCO WORKS INC.

Address: 5900 WAREHOUSE WAY, SACRAMENTO, CAL.

Telephone No: (916) 383-6699

Contractor Number of Diamond Wall System 2175

This is to certify that the exterior coating system on the building exterior at the above address has been installed in accordance with the evaluation report specified above and the manufacturer's instructions.

Date 7/29/01

Signature of authorized representative of
Plastering Contractor

This installation card must be presented to the building inspector after completion of work and before final inspection.

CERTIFICATION OF INSULATION

PART I GENERAL

ADDRESS OR TRACT <div style="font-size: 2em; font-family: cursive;">D. A. HORTON</div> <div style="font-size: 1.5em; font-family: cursive; margin-top: 10px;">PARKWEST</div>	LOT # 54	SACRAMENTO INSULATION CONTRACTORS <input checked="" type="checkbox"/> P.O. BOX 854, WEST SACRAMENTO, CA 95691 LIC. #202026 <input type="checkbox"/> 1309 MELODY ROAD, MARYSVILLE, CA 95901 LIC. #202026 <input type="checkbox"/> P.O. BOX 9651, FRESNO, CA 93793-9651 LIC. #202026 <input type="checkbox"/> P.O. BOX 1631, RENO, NV 89505 LIC. #10675 <input type="checkbox"/> 3326 A PONDEROSA WAY, LAS VEGAS, NV 89118 LIC. #10675 DATE INSULATION COMPLETED
---	----------	--

WALLS		CEILINGS			FLOORS	
SQUARE FEET)		SQUARE FEET)			SQUARE FEET)	
TYPE OF INSULATION		TYPE OF INSULATION			TYPE OF INSULATION	
MATERIAL FIBERGLASS		MATERIAL FIBERGLASS			MATERIAL FIBERGLASS	
FORM BATTS		FORM BATTS & BLOW			FORM BATTS	
MANUFACTURER'S PRODUCT I.D.		MANUFACTURER'S PRODUCT I.D.			MANUFACTURER'S PRODUCT I.D.	
MANUFACTURER		MANUFACTURER			MANUFACTURER	
OCF		OCF			OCF	
R - VALUE INSTALLED		APPLIED THICKNESS		R - VALUE INSTALLED	APPLIED THICKNESS	MIN. INSTALLED WEIGHT PER SQUARE FOOT
13		3 5/8"		30	9"	30
				30	12"	
KNEE WALLS IF R-VALUE IS OTHER THAN WALLS ABOVE						
MATERIAL FIBERGLASS		FORM BATTS		R VALUE	MANUFACTURER OCF	
AIR INFILTRATION SEALANT						
MATERIAL FOAM				MANUFACTURER W R GRACE		

THIS IS TO CERTIFY THAT INSULATION AND/OR SEALANT HAS BEEN INSTALLED IN CONFORMANCE WITH APPLICABLE CODES, MATERIAL STANDARDS AND REGULATIONS.

SIGNATURE—INSULATION CONTRACTOR <div style="font-family: cursive; font-size: 1.5em;">[Signature]</div>	TITLE MANAGER	DATE 9-20-01
SIGNATURE—GENERAL CONTRACTOR	TITLE	DATE
REMARKS		

PART II AREAS INSULATED



Post-It[®] Fax Note 7671

To: <i>Wat McPhetridge</i>	Date: <i>9/4/01</i>	# of pages: <i>1</i>
Co./Dept: <i>D. R. Horton</i>	From: <i>Betty</i>	
Phone #:	Co.: <i>DuPont</i>	
Fax: <i>(916) 965-2201</i>	Phone #: <i>(800) 418-9835</i>	Fax #:

Stucco Wrap - Before & After Windows



Tyvek
StuccoWrap

Installation Guidelines

How to install Tyvek[®] StuccoWrap[®] on Vertical Walls, BEFORE Windows or Doors are installed

Wrapping Vertical Walls:

1 UNWRAP roll at corner, leaving 8"-12" overlap.

NOTE: Apply wrap with grooved surface pattern in **VERTICAL** position for proper drainage.

2 Roll should be plumb. Bottom roll edge should extend over sill plate interface.

SHINGLE StuccoWrap[®] over back edge of weep screed for proper water drainage. For maximum air leakage reduction, seal wrap with caulk or tape to weep screed. Don't block weep holes.

3 Secure Tyvek[®] every 12"-18" on vertical stud line. With wood, insulated sheathing board or

exterior gypsum board, use large head or plastic washer head nails, as a best practice. Wide staples with 1.0 inch minimum crown can also be used. When attaching to masonry, use adhesives with polyurethane, elastomeric or latex base.

4 Unroll directly over windows and doors. Upper roll overlaps bottom roll by 6" horizontally.

5 COVER interface of upper and lower top plates with Tyvek[®]. As a best practice, **TAPE** all horizontal seams at band joints, headers and roll overlaps with 2 or 3" DuPont Contractor tape. Tape any accidental tears or damage.

6 Make a modified "I" CUT in Tyvek[®]

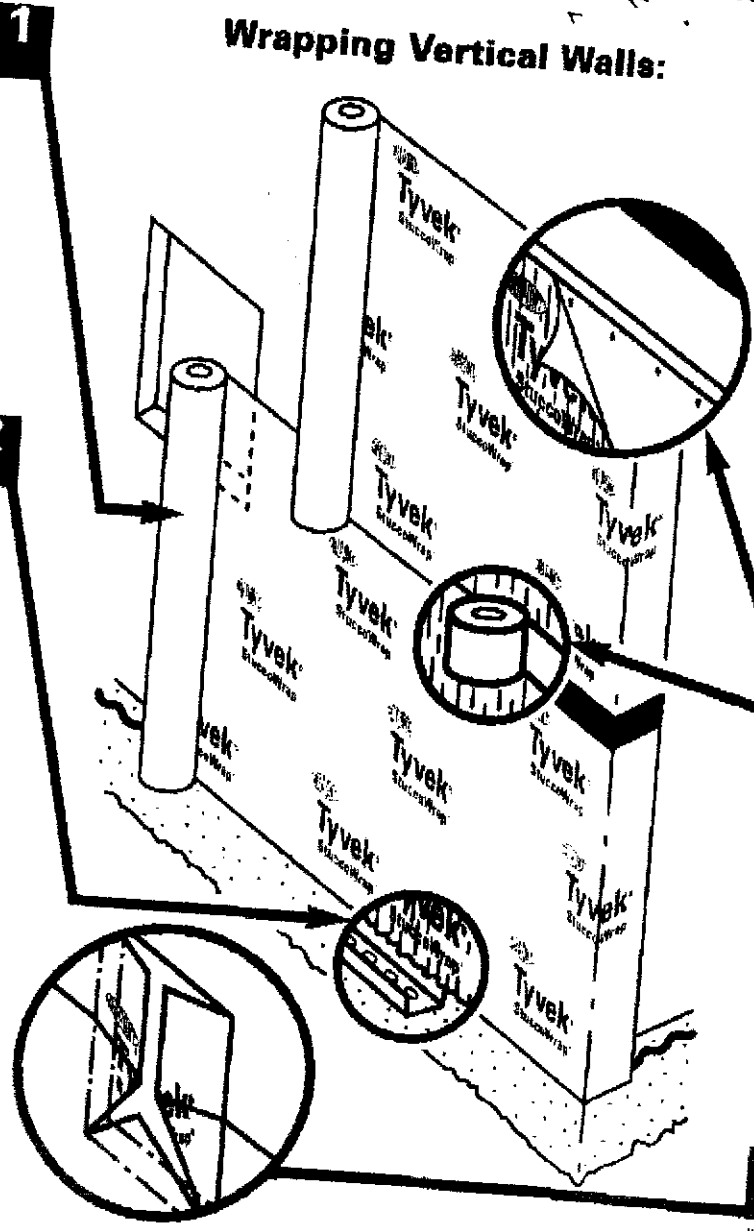

Typical Window or Door Detailing:

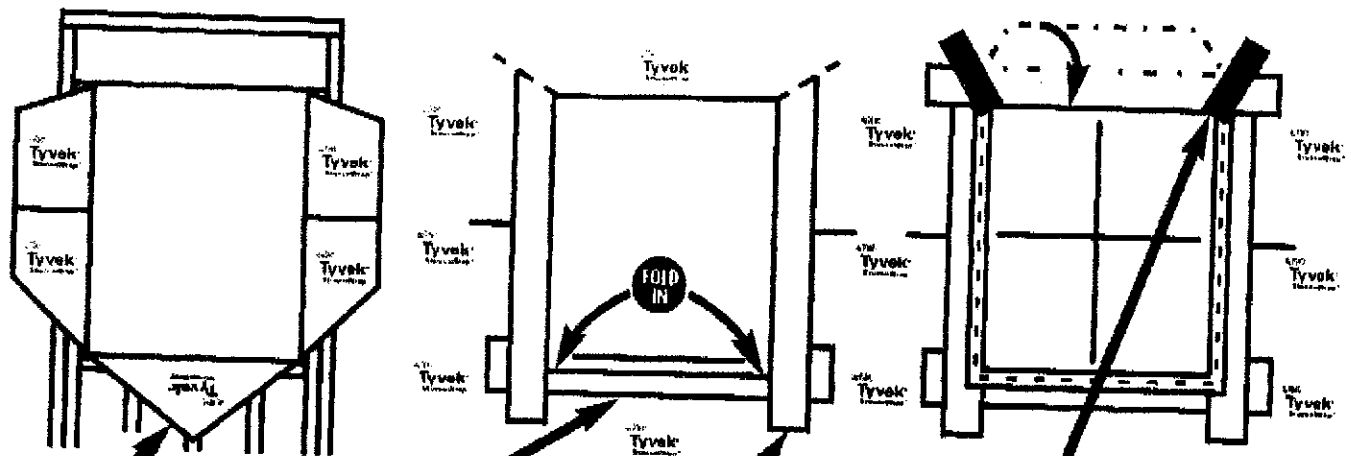

7 FOLD flaps inside around window or door openings. Fasten every 6". Trim excess Tyvek®

8 Tack up bottom sill flashing, overlapping rough sill by 4"-5". As a best practice, make two vertical corner cuts in the flashing. **FOLD flashing inside over rough sill.**

9 Tack up side flashings. **OVERLAPPING bottom sill flashing.** Cut two 45° angles in Tyvek® from each top window corner. Then, install window or door according to manufacturer instructions.

10 Install head flashing UNDER top flap of Tyvek® OVER window flange. Extend flashing out OVER side flashings by 3-4". Fold top flap of Tyvek® OVER head flashing. **TAPE both diagonal cuts.**

BUILDING CODE REPORTS: ICC-ES E-1000, BCCA ES-98-46, SBCCI PST&ES-95105D. Meets the ASTM E1677 Type 1 Air Retarder when installed according to Tyvek® Weatherization Systems best practices. See installation instructions on label.

TECHNICAL SPECIFICATIONS: Tyvek® used in construction products is made from 100% flash-spunbonded high density polyethylene fibers which have been bonded together by heat and pressure, without binders or fillers, into a tough, durable sheet structure. Additives have been incorporated into the polyethylene to provide ultraviolet light resistance. DuPont recommends that Tyvek® be covered within four months of installation.

PRODUCT GUARANTEE: DuPont will replace any Tyvek® Weatherization System product damaged during installation by weather or normal handling if it is installed according to procedures published by DuPont. If you have any questions, call DuPont Tyvek® Weatherization Systems at 1-800-44-TYVEK®.

WARNING: Tyvek® is slippery and should not be used in any application where it will be walked on, in addition, because it is slippery. DuPont recommends using kickjacks or scaffolding for exterior work above the first floor. If ladders

must be used, extra caution must be taken to use them safely by following the requirements set forth in ANSI Standards 14.1, 14.2 and 14.6 for ladders made of wood, aluminum, and fiberglass, respectively. Tyvek® is combustible and should be protected from a flame and other high heat sources. If the temperature of Tyvek® reaches 750° F (400° C), it will burn and the fire may spread and fall away from the point of ignition. For more information, call 1-800-44-TYVEK®.

NOTE: To achieve the greatest energy savings potential and weather-resistance, any tears, breaks, holes, etc., created during normal construction should be repaired by taping or patching. Tyvek® is a weather-resistive barrier, not a primary water barrier (the outer facade is the primary barrier). Contamination of Tyvek® StuccoWrap® and building papers with building site chemicals which increase their wettability (e.g., surfactants) will adversely affect their water-resistance and, therefore, their contribution to the overall water-resistance of the wall system. Tyvek® StuccoWrap® is recommended only for use as outlined in this brochure. For additional information on proper installation practices, consult Tyvek® Tech Talk "Building to Resist Bulk Water Penetration" (H-17168S). For maximum protection against bulk water penetration, a system

combining a quality exterior facade, a good secondary weather-resistive membrane and an exterior sheathing, with particular attention to proper installation of each component, is recommended. In a system where no exterior sheathing is used and Tyvek® is installed directly over the wall studs, exterior facade materials should be selected to ensure maximum protection against water intrusion. Careful workmanship installing each component of the wall system is also very important.

For more information:
1-800-44-TYVEK®
www.tyvek.com



Tyvek® StuccoWrap®
Build it once, build it right.

THIS PLAN IS PREPARED TO SHOW THE DIMENSIONAL RELATIONSHIP FROM BUILDING FOUNDATION TO PROPERTY LINE, DESIGN DRAINAGE CONTROL ELEVATIONS, AND DIRECTION OF DRAINAGE FLOW TO CONFORM WITH LOCAL ORDINANCES FOR THE PURPOSE OF BUILDING PERMIT ISSUANCE. INFORMATION SHOWN IS APPROXIMATE EXCEPT FOR THOSE SETBACKS WHICH ARE MINIMUMS REQUIRED BY ORDINANCE. THIS PLOT DOES NOT REFLECT AS BUILT CONDITIONS WHICH WILL LIKELY VARY FROM THIS PLAN.

SCALE: 1" = 20'

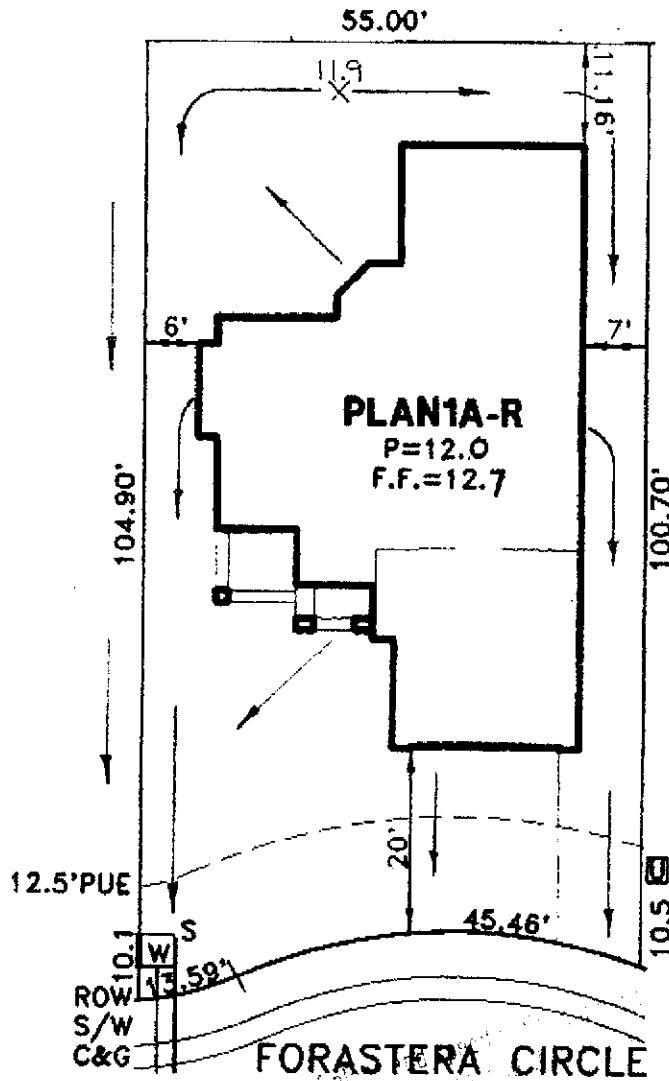

2/25/16
[Signature]

☐ - UTILITY SERVICE BOX

PLOT PLAN
LOT 54
 RIVERVIEW#2, UNIT 3A
 FOR
 D.R.HORTON INC.
 SACRAMENTO CALIFORNIA

WOOD RODGERS INC.
 ENGINEERING PLANNING MAPPING SURVEYING
 330 ' C STREET, BLOB. 100-B SACRAMENTO, CA 95818
 PHONE: (916) 341-7768 FAX: (916) 341-7767

DATE:	DRAWN:	CHECKED:	PROJECT NO:
MAY 2001	MJG	<i>FMTL</i>	1055.014

J:\JOBS\RIVERVIEW\DWG\CIVIL\ PLOT PLANS SAMPLER\3A-LOT54.DWG 05/10/01 15:22