

CITY OF SACRAMENTO

1231 I Street, Sacramento, CA 95814

Permit No: 0113187

Insp Area: 4

Site Address: 2506 MABRY DR SAC

Thos Bros:

Parcel No: NORTHBOROUGH II VIL. 9 LOT 2

Sub-Type: NSFR

N

Housing (Y/N):

CONTRACTOR

OWNER

ARCHITECT

CENTEX HOMES
3300 DOUGLAS BLVD
STE. 210 95661

Nature of Work: MP 2890 2 STORY 9 ROOM SFR W/ SUP FAM RM OPT.

CONSTRUCTION LENDING AGENCY : I hereby affirm under penalty of perjury that there is a construction lending agency for the performance of the work for which this permit is issued (Sec. 3097, Civ. C).

Lender's Name N/A Lender's Address _____

LICENSED CONTRACTORS DECLARATION: I hereby affirm under penalty of perjury that I am licensed under provisions of Chapter 9 (commencing with section 7000) of Division 3 of the Business and Professions Code and my license is in full force and effect.

License Class B License Number 734094 Date 11/2/01 Contractor Signature Debbie Stowers

OWNER-BUILDER DECLARATION: I hereby affirm under penalty of perjury that I am exempt from the contractors License Law for the following reason (Sec. 7031.5, Business and Professions Code; any city or county which requires a permit to construct, alter, improve, demolish, or repair any structure, prior to its issuance, also requires the applicant for such permit to file a signed statement that he or she is licensed pursuant to the provisions of the Contractors License Law (Chapter 9 (commencing with Section 7000) of Division 8 of the Business and Professions Code) or that he or she is exempt therefrom and the basis for the alleged exemption. Any violation of Section 7031.5 by any applicant for a permit subjects the applicant to a civil penalty of not more than five hundred dollars (\$500.00);

____ I, as a owner of the property, or my employees with wages as their sole compensation, will do the work, and the structure is not intended or offered for sale (Sec. 7044, Business and Professional Code: The Contractors License Law does not apply to an owner of property who builds or improves thereon, and who does such work himself or herself or through his/her own employees, provided that such improvements are not intended or offered for sale. If, however, the building or improvement is sold within one year of completion, the owner-builder will have the burden of proving that he/she did not build or improve for the purpose of sale.)

____ I, as owner of the property, am exclusively contracting with licensed contractors to construct the project (Sec. 7044, Business and Professions Code: The Contractors License Law does not apply to an owner of property who builds or improves thereon, and who contracts for such projects with a contractor(s) licensed pursuant to the Contractors License Law).

____ I am exempt under Sec. _____ B & PC for this reason: _____

Date _____ Owner Signature _____

IN ISSUING THIS BUILDING PERMIT, the applicant represents, and the city relies on the representation of the applicant, that the applicant verified all measurements and locations shown on the application or accompanying drawings and that the improvement to be constructed does not violate any law or private agreement relating to permissible or prohibited locations for such improvements. This building permit does not authorize any illegal location of any improvement or the violation of any private agreement relating to location of improvements.

I certify that I have read this application and state that all information is correct. I agree to comply with all city and county ordinances and state laws relating to building construction and hereby authorize representative(s) of this city to enter upon the abovementioned property for inspection purposes.

Date 11/2/01 Applicant/Agent Signature Debbie Stowers

WORKER'S COMPENSATION DECLARATION: I hereby affirm under penalty of perjury one of the following declarations:

____ I have and will maintain a certificate of consent to self-insure for workers' compensation as provided for by Section 3700 of the Labor Code, for the performance of work for which the permit is issued.

I have and will maintain workers' compensation insurance, as required by Section 3700 of the Labor Code, for the performance of the work for which this permit is issued. My workers' compensation insurance carrier and policy number are:

Carrier ZURICH AMERICAN INS CO Policy Number WC8322098WI Exp Date 10/01/2002

____ (This section need not be completed if the permit is for \$100 or less) I certify that in the performance of the work for which this permit is issued, I shall not employ any person in any manner so as to become subject to the workers' compensation laws of California and agree that if I should become subject to the workers' compensation provisions of Section 3700 of the Labor Code, I shall forthwith comply with those provisions.

Date 11/2/01 Applicant Signature Debbie Stowers

WARNING: FAILURE TO SECURE WORKER'S COMPENSATION COVERAGE IS UNLAWFUL AND SHALL SUBJECT AN EMPLOYER TO CRIMINAL PENALTIES AND CIVIL FINES UP TO ONE HUNDRED THOUSAND DOLLARS (\$100,000) IN ADDITION TO THE COST OF COMPENSATION, DAMAGES AS PROVIDED FOR IN SECTION 3706 OF THE LABOR CODE, INTEREST AND ATTORNEY'S FEE.

THIS PERMIT SHALL EXPIRE BY LIMITATION IF WORK IS NOT COMMENCED WITHIN 180 DAYS.

RESIDENTIAL BUILDING PERMIT APPLICATION

New Construction

Addition

Remodels

Other

Project Address: 2506 Mabry Way

Assessor Parcel # _____

OWNER INFORMATION:

LOT 2

Legal Property Owner: Center Homes Phone # 786-8693
 Owner Address: 3700 Douglas Blvd #150 City Roseville State CA Zip 95661

CONTRACTOR INFORMATION:

0113187

Contractor: Center Homes Lic. # 734094 Phone # 786-8693 Fax# 786-6802

PROJECT INFORMATION:

Land Use Zone RIA Occupancy Group R3 Construction Type VN Fed Code 1A
 No. of stories: 2 No. of rooms: _____ Street width: _____
 1st Floor Area 1872 2nd Floor Area 1374 Basement _____ Roof Material _____

AREA IN SQUARE FOOT OF:	EXISTING	NEW
Dwelling/Living	_____	<u>3246</u>
Garage/Storage	_____	<u>549</u>
Decks/Balconies	_____	_____
Carpports	_____	_____

SCOPE OF WORK: MP 2890 New SFR

FOR OFFICE USE ONLY

- | | | |
|---|---|--|
| <input type="checkbox"/> Information above complete | <input type="checkbox"/> AR Flood Waiver required | <input type="checkbox"/> Planning Approval |
| <input type="checkbox"/> Violation files checked | <input type="checkbox"/> Flood Elevation Certificate Required | <input type="checkbox"/> Design Review Approval |
| <input type="checkbox"/> Standard setbacks | <input type="checkbox"/> Water Development Infill Area | <input type="checkbox"/> Special Fee Districts Apply : _____ |
| <input type="checkbox"/> County Sewer | | |

NEW STRUCTURES & ADDITIONS

◆ THE FOLLOWING MUST BE PROVIDED IN ORDER TO SUBMIT FOR PLAN REVIEW

- | | |
|---|---|
| <input type="checkbox"/> 2 COMPLETE PLANS, LEGIBLE & DRAWN TO SCALE | ◆ Plans to include: site plan, floor plan, elevations, roof/ceiling plan, foundation and structural framing details, and structural calculations for non-conforming structures. |
| <input type="checkbox"/> 3 SETS IF PROJECT IS IN A DESIGN REVIEW AREA | |
| <input type="checkbox"/> Title 24 Energy Compliance documentation | <input type="checkbox"/> 11" x 17" copy of floor plan for County Assessor |
| <input type="checkbox"/> Grading and Erosion Control Questionnaire | <input type="checkbox"/> Plan Review Fees |

Date: _____

Received by: (staff) _____



INSULATION CERTIFICATE

THIS IS TO CERTIFY THAT INSULATION HAS BEEN INSTALLED IN CONFORMANCE WITH THE CURRENT ENERGY REGULATIONS, CALIFORNIA ADMINISTRATION CODE, TITLE 24, STATE OF CALIFORNIA, IN THE BUILDING LOCATED AT.

Page 2

SITE ADDRESS LOT 2 SKYLINE SACRAMENTO CA
 NUMBER STREET CITY STATE

CEILING:

BLOW: MANUFACTURER GREENSTONE THICKNESS 10.5" R-VALUE 38
 SQUARE FEET 1447 #BAGS/LBS PER BAGS 60

BATT: MANUFACTURER JOHNS MANVILLE THICKNESS 13" R-VALUE 38
JOHNS MANVILLE

EXTERIOR WALLS:

MANUFACTURER JOHNS MANVILLE THICKNESS 3.5" R-VALUE 13
JOHNS MANVILLE

FLOOR INSULATION:

MANUFACTURER JOHNS MANVILLE THICKNESS 6.5" R-VALUE 19

AIR INFILTRATION:

(TITLE 24)
 YES XX NO

OTHER: _____

GENERAL CONTRACTOR: CENTEX HOMES LICENSE # _____

BY: _____ TITLE _____ DATE _____

INSULATION CONTRACTOR: WESTERN INSULATION LP LICENSE # 784484

BY: Jamie Blair TITLE AUTH. AGENT DATE 2/15/02
JAMIE BLAIR

March 14, 2002

Centex Homes Sacramento

To: City of Sacramento Building Department

**From: Centex Homes Sacramento
Ray Ferrarini
Area Construction Manager**

**Re: Model Conversion
2506 Mabry Dr.
Sacramento, CA**

Lot 2

To Whom It May Concern:

This letter is to confirm that Centex Homes will convert the above single family residence at the completion of our Skyline neighborhood. Included in this conversion will be; return all electrical and mechanical equipment and systems to compliance with all applicable building codes, removal of temporary walkways, removal of trap fencing. In addition, standard 6 foot tall good neighbor fencing shall be installed between the above property and neighboring properties. This list is in addition to all other standard requirements of the City of Sacramento's Building Department will be completed prior to any close of escrow between Centex Homes and another party.

If you have any further questions or concerns please feel free to contact me at the numbers listed below.

Sincerely,

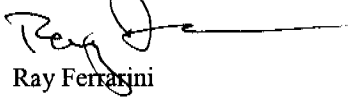

Ray Ferrarini
Area Construction Manager
Centex Homes Sacramento
916 786 6100 ext. 222
916 765 3188



This set of plans and specifications must be kept on the job at all times and it is unlawful to make any changes or alterations from the same without written permission from the Building Inspection Division.

The approval of this plan and specifications SHALL NOT be held to justify approval or violation of any City Ordinance or State law.

CENTEX APPROVALS	
LAND DEVELOPER	DATE
CONS. MANAGER	DATE
SALES APPL.	DATE
FIELD MANAGER	DATE

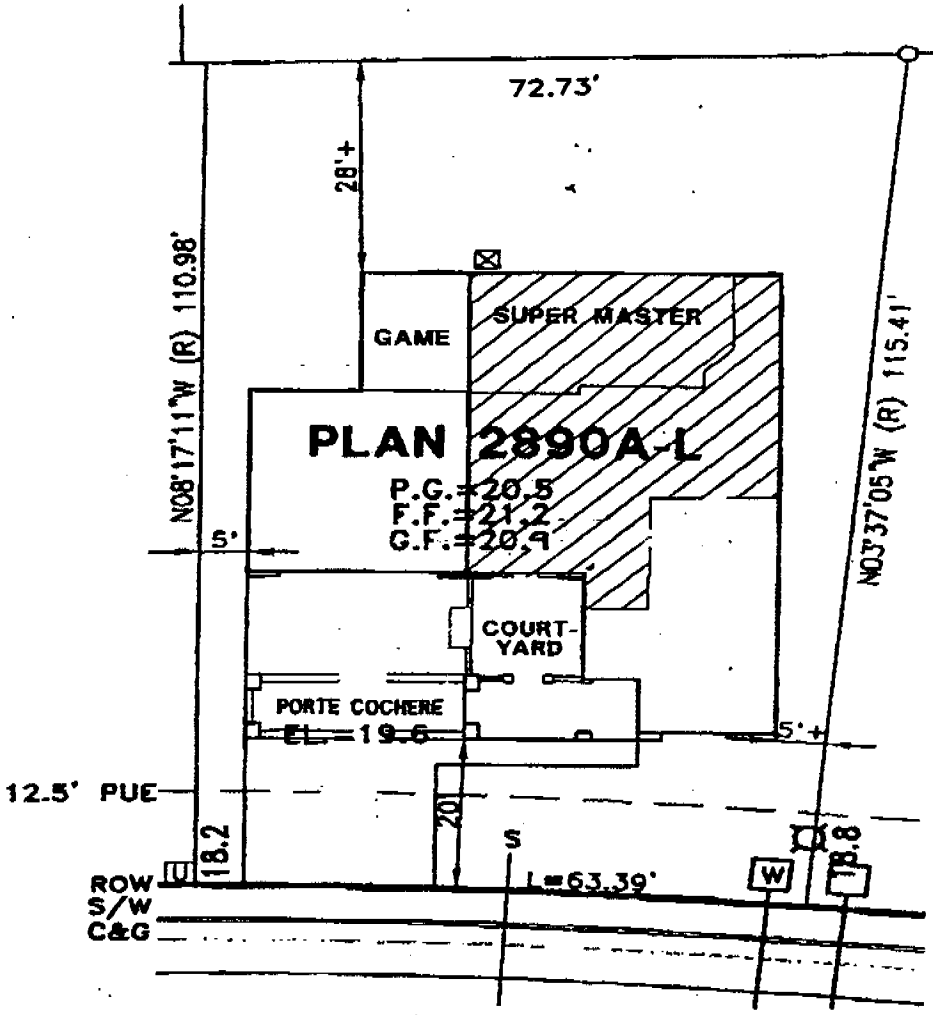
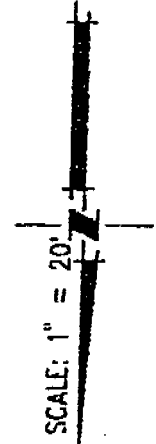

2506 MABRY Drive

THIS PLOT PLAN HAS BEEN PREPARED FOR THE PURPOSE OF SHOWING THE BUILDING FOUNDATION RELATIONSHIP TO THE PROPERTY LINE, PROPOSED DRAINAGE ELEVATIONS AND DIRECTIONS OF FLOW TO CONFORM TO LOCAL ORDINANCES AND FOR THE PURPOSE OF BUILDING PERMIT ISSUANCE, INFORMATION SHOWN IS APPROXIMATE EXCEPT FOR THOSE SETBACKS WHICH ARE MINIMUMS REQUIRED BY ORDINANCE. THIS PLOT DOES NOT REFLECT AS-BUILT CONDITIONS WHICH WILL LIKELY VARY FROM THIS PLAN. RETAINING WALLS MAY BE ADDED, DELETED, OR CHANGED AS FIELD CONDITIONS WARRANT.

LEGEND: W - WATER SERVICE S - SEWER SERVICE [U] - UTILITY SERVICE [T] - TRANSFORMER

NORTHBOROUGH II VILLAGE 9
PLOT PLAN FOR LOT A02

CENTEX HOMES
 3700 Douglas Blvd, Ste 150
 Roseville, CA 95661

A.P.N.:
 LOT FOOTAGE: SQ. FT.
 ADDRESS: 2506 MABRY DRIVE
 COUNTY: SACRAMENTO COUNTY

WOOD RODGERS INC.
 ENGINEERING PLANNING SURVEYING
 2201 G STREET, BLDG. 100-8 SACRAMENTO, CA 95814
 PHONE: (916) 947-7700 FAX: (916) 947-7707
SEPT 2001 **1015.057**

File: J:\085\NORTHBOROUGH II VILLAGE 08-1\1\LOT PLANS\LOT-A02.DWG Last edited: 10/03/01 by: leo