

**CITY OF SACRAMENTO**  
1231 I Street, Sacramento, CA 95814

**Permit No: 0005404**  
**Insp Area: 4**

**Site Address: 500 LYMAN CR SAC**  
Parcel No: 225-1290-031  
N

LOT 31 NORTHPOINTE PARK 13-1

**Sub-Type: NSFR**  
**Housing (Y/N):**

CONTRACTOR  
WESTERN PACIFIC HOUSING  
1210 CENTRAL BLVD  
BRENTWOOD CA. 94513

OWNER

ARCHITECT

**Nature of Work: NSFR MP3582 2 STORY 10 RMS**

**CONSTRUCTION LENDING AGENCY:** I hereby affirm under penalty of perjury that there is a construction lending agency for the performance of the work for which this permit is issued (Sec. 3097, Civ. C).

Lender's Name \_\_\_\_\_ Lender's Address \_\_\_\_\_

**LICENSED CONTRACTORS DECLARATION:** I hereby affirm under penalty of perjury that I am licensed under provisions of Chapter 9 (commencing with section 7000) of Division 3 of the Business and Professions Code and my license is in full force and effect.

License Class B License Number 65709 Date 5/23/00 Contractor Signature Steve Hall

**OWNER-BUILDER DECLARATION:** I hereby affirm under penalty of perjury that I am exempt from the contractors License Law for the following reason (Sec. 7031.5, Business and Professions Code; any city or county which requires a permit to construct, alter, improve, demolish, or repair any structure, prior to its issuance, also requires the applicant for such permit to file a signed statement that he or she is licensed pursuant to the provisions of the Contractors License Law (Chapter 9 (commencing with Section 7000) of Division 8 of the Business and Professions Code) or that he or she is exempt therefrom and the basis for the alleged exemption. Any violation of Section 7031.5 by any applicant for a permit subjects the applicant to a civil penalty of not more than five hundred dollars (\$500.00);

\_\_\_\_ I, as a owner of the property, or my employees with wages as their sole compensation, will do the work, and the structure is not intended or offered for sale (Sec. 7044, Business and Professional Code: The Contractors License Law does not apply to an owner of property who builds or improves thereon, and who does such work himself or herself or through his/her own employees, provided that such improvements are not intended or offered for sale. If, however, the building or improvement is sold within one year of completion, the owner-builder will have the burden of proving that he/she did not build or improve for the purpose of sale.)

\_\_\_\_ I, as owner of the property, am exclusively contracting with licensed contractors to construct the project (Sec. 7044, Business Professions Code: The Contractors License Law does not apply to an owner of property who builds or improves thereon, and who contracts for such projects with a contractor(s) licensed pursuant to the Contractors License Law).

**NEIGHBORHOODS, PLANNING AND DEVELOPMENT SERVICES**

\_\_\_\_ I am exempt under Sec. \_\_\_\_\_ B & PC for this reason: \_\_\_\_\_

Date \_\_\_\_\_ Owner Signature \_\_\_\_\_

**IN ISSUING THIS BUILDING PERMIT,** the applicant represents, and the city relies on the representation of the applicant, that the applicant verified all measurements and locations shown on the application or accompanying drawings and that the improvement to be constructed does not violate any law or private agreement relating to permissible or prohibited locations for such improvements. This building permit does not authorize any illegal location of any improvement or the violation of any private agreement relating to location of improvements.

I certify that I have read this application and state that all information is correct. I agree to comply with all city and county ordinances and state laws relating to building construction and hereby authorize representative(s) of this city to enter upon the above mentioned property for inspection purposes.

Date 5/23/00 Applicant/Agent Signature Steve Hall

**WORKER'S COMPENSATION DECLARATION:** I hereby affirm under penalty of perjury one of the following declarations:

\_\_\_\_ I have and will maintain a certificate of consent to self-insure for workers' compensation as provided for by Section 3700 of the Labor Code, for the performance of work for which the permit is issued.

\_\_\_\_ I have and will maintain workers' compensation insurance, as required by Section 3700 of the Labor Code, for the performance of the work for which this permit is issued. My workers' compensation insurance carrier and policy number are:

Carrier EAGLE INS. CO.

Policy Number 4S-0000273

Exp Date 03/19/2001

\_\_\_\_ (This section need not be completed if the permit is for \$100 or less) I certify that in the performance of the work for which this permit is issued, I shall not employ any person in any manner so as to become subject to the workers' compensation laws of California and agree that if I should become subject to the workers' compensation provisions of Section 3700 of the Labor Code, I shall forthwith comply with those provisions.

Date 5/23/00 Applicant Signature Steve Hall

**WARNING:** FAILURE TO SECURE WORKER'S COMPENSATION COVERAGE IS UNLAWFUL AND SHALL SUBJECT AN EMPLOYER TO CRIMINAL PENALTIES AND CIVIL FINES UP TO ONE HUNDRED THOUSAND DOLLARS (\$100,000) IN ADDITION TO THE COST OF COMPENSATION, DAMAGES AS PROVIDED FOR IN SECTION 3706 OF THE LABOR CODE, INTEREST AND ATTORNEY'S FEE.

**THIS PERMIT SHALL EXPIRE BY LIMITATION IF WORK IS NOT COMMENCED WITHIN 180 DAYS.**

RESIDENTIAL SUBDIVISION BUILDING PERMIT APPLICATION

Project Address: 500 LYMAN CIRCLE Assessor Parcel # 225-1290-031-0000  
Lot Number: 31 Subdivision BELLARIO

OWNER INFORMATION:

Legal Property Owner: WESTERN PACIFIC HOUSING Phone# (925) 634-6023  
Owner Address: 1210 CENTRAL BLVD. City BRENTWOOD State CA. Zip 94513

CONTRACTOR INFORMATION:

Contractor: WESTERN PACIFIC HOUSING Lic. # 675709 Phone # 419-7293 Fax 419-7295

PROJECT INFORMATION:

Land Use Zone R1A Occupancy Group R3 Construction Type VN Fed Code 1A  
No. of Stories: 2 No. of Rooms: \_\_\_\_\_ Street Width: 25'-0"  
1<sup>st</sup> Floor Area 1815 2<sup>nd</sup> Floor Area 1777 Basement \_\_\_\_\_ Roof Material CONC. TILE  
AREA IN SQUARE FOOT OF:  
Dwelling/Living 3582  
Garage/Storage 636  
Decks/Balconies \_\_\_\_\_  
Carports \_\_\_\_\_  
SCOPE OF WORK: \_\_\_\_\_

FOR OFFICE USE ONLY

- Information Above Complete
- Violation Files Checked
- Standard Setbacks
- County Sewer
- AR Flood Waiver Required
- Flood Elevation Certificate Required
- Water Development Infill Area
- Planning Approval
- Design Review Approval
- Special Fee Districts Apply: \_\_\_\_\_

THE FOLLOWING MUST BE PROVIDED IN ORDER TO SUBMIT FOR PERMIT

- 2 COMPLETE PLOT PLANS, LEGIBLE & DRAWN TO SCALE
- 11 X 17 COPY OF FLOOR PLAN WITH FOLLOWING INFORMATION
  - a) Assessors Parcel Number
  - b) New Floor Area
  - c) Owners Name
  - d) Project Address

Date: \_\_\_\_\_ Received by: (staff) \_\_\_\_\_ Permit # \_\_\_\_\_

20028



### INSTALLATION CARD

Job Address

Western Pacific Housing  
Bellagio lot # 31  
500 Lyman Cir. SAC

Stucco System Trade Name: KWIK KOTE  
Name Stucco Manufacturer: KWIK KOTE CORP.

ICBO Evaluation Service, Inc.  
Report No. 3607  
Date of Job Completion \_\_\_\_\_

Stucco Contractor Kenyon Construction  
Name John W. Kenyon, III  
Address P.O. Box 2077  
North Highlands, CA 95660  
Telephone Number (916) 349-8191  
Approved Contractor Number as issued by the Stucco Manufacturer: 1

This is to certify that the stucco system on the building exterior at the above address had been installed in accordance with the evaluation report specified above and the manufacturer's instructions.

Signature of authorized representative of stucco contractor

Date

8/15/2000



**LEGEND**

→ SWALE  
 □ MAILBOX

\* WOOD FENCE  
 ○ SIDEYARD GATE

SS SEWER SERVICE  
 WS WATER SERVICE

□ UTILITY SERVICE  
 F.F. FINISH FLOOR

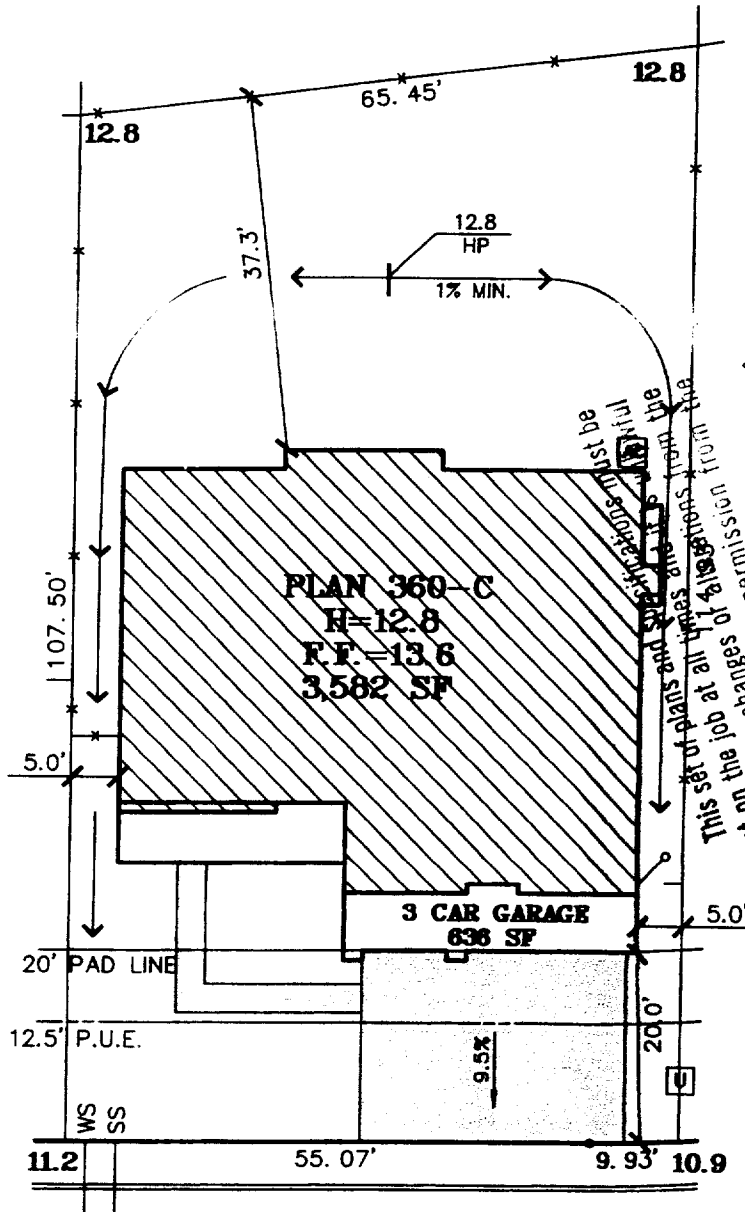

This set of plans and specifications must be kept on the job at all times and no changes or alterations shall be made without written permission from the Building Inspection Division. The applicant shall be held responsible for any violations of the Building Code.

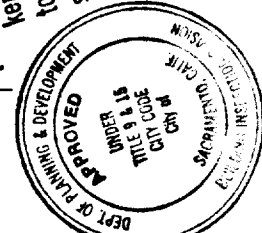

**LOT 31**  
**PLAN 360-C**  
**A.P.N.:**  
**ADDRESS: 500 LYMAN CIRCLE**  
**LOT AREA: 7,237 SF**

**LYMAN CIRCLE**

DUE TO THE UNIQUE CONDITIONS OF THIS LOT, THE BUYER HAS WALKED AND APPROVED THE SITE. FINAL GRADING CONDITIONS MAY VARY. THE INFORMATION ON THIS PLOT PLAN IS PROVIDED FOR YOUR CONVENIENCE AS A GUIDE TO THE GENERAL LOCATION OF THE SUBJECT PROPERTY. THE ACCURACY OF THIS PLOT PLAN IS NOT GUARANTEED NOR IS IT A PART OF ANY POLICY, REPORT OR GUARANTEE TO WHICH IT MAY BE ATTACHED. ACTUAL DIMENSIONS MAY VARY OR CHANGE WITHOUT PRIOR NOTICE DUE TO ACTUAL SITE CONDITIONS.

PLAN: <u>360</u>	SIGNED (BUYER) _____	DATE _____
ELEVATION: <u>C</u>	_____	_____
ORIENTATION: <u>R</u>	PROJECT SUPERINTENDENT APPROVAL _____	DATE _____
COLOR: <u>120</u>	SITE SUPERINTENDENT APPROVAL _____	DATE _____
	ESTIMATING APPROVAL _____	DATE _____
	SALES APPROVAL _____	DATE _____
	CONSTRUCTION APPROVAL _____	DATE _____

2590 VENTURE OAKS WAY  
 SACRAMENTO, CA 95833  
 PH:(916)925-5560 FAX:(916)921-9274

**Western Pacific Housing**  
 1210 Central Boulevard  
 Brentwood, CA 94513  
 office: (925) 634-8023  
 fax: (925) 634-8063

**BELLAGIO**  
 NORTHPOINTE PARK VILLAGE 13 PHASE 1  
 City of Sacramento, California  
 Scale: 1"=20'  
 April 27, 2000

0005404

20028



INSTALLATION CARD

Job Address:

Waters Pacific Housing  
Bellagio Lot # 31  
500 Lyman Ave. SAC

Stucco System Trade Name: KWIK KOTE

Name Stucco Manufacturer: KWIK KOTE CORP.

ICBO Evaluation Service, Inc.

Report No. 3607

Date of Job Completion

Stucco Contractor Kenyon Construction

Name John W. Kenyon, III

Address P.O. Box 2077

North Highlands, CA 95660

Telephone Number (916) 349-8191

Approved Contractor Number as issued by the Stucco Manufacturer

1

7

This card certifies that the stucco system on the building exterior at the above address had been installed in accordance with the evaluation report specified above and the manufacturer's instructions.

Signature of authorized representative of stucco contractor

Date

8/15/2000

# CERTIFICATION OF INSULATION

PARTY GENERAL

WESTERN PACIFIC HOUSING  
 LOT # 31  
 500 Lyman Cu  
 BLUCCIO

- P.O. BOX 854, WEST SACRAMENTO, CA 95691 LIC. #202026
- 1309 MELODY ROAD, MARYSVILLE, CA 95901 LIC. #202026
- P.O. BOX 9651, FRESNO, CA 93793-9651 LIC. #202026
- P.O. BOX 1631, RENO, NV 89505 LIC. #10675
- 3326 A PONDEROSA WAY, LAS VEGAS, NV 89118 LIC. #10675

DATE INSULATION COMPLETED

PARTY INSULATED AREA

WALLS		CEILING			FLOORS	
( SQUARE FEET)		( SQUARE FEET)			( SQUARE FEET)	
TYPE OF INSULATION		TYPE OF INSULATION			TYPE OF INSULATION	
MATERIAL <b>FIBERGLASS</b>		MATERIAL <b>FIBERGLASS</b>			MATERIAL <b>FIBERGLASS</b>	
FORM <b>BATTS</b>		FORM <b>BATTS &amp; BLOW</b>			FORM <b>BATTS</b>	
MANUFACTURER'S PRODUCT ID		MANUFACTURER'S PRODUCT ID			MANUFACTURER'S PRODUCT ID	
MANUFACTURER		MANUFACTURER			MANUFACTURER	
OCF		OCF			OCF	
OCF		OCF			OCF	
OCF		OCF			OCF	
OCF		OCF			OCF	
R-VALUE INSTALLED	APPLIED THICKNESS	R-VALUE INSTALLED	APPLIED THICKNESS	MIN. INSTALLED WEIGHT PER SQUARE FOOT	R-VALUE INSTALLED	APPLIED THICKNESS
R-13	3 5/8"	R-30	1 3/4"			

KNEE WALLS IF R-VALUE IS OTHER THAN WALLS ABOVE			
MATERIAL <b>FIBERGLASS</b>	FORM <b>BATTS</b>	R VALUE	MANUFACTURER <b>OCF</b>

AIR INFILTRATION SEALANT	
MATERIAL <b>FOAM</b>	MANUFACTURER <b>W R GRACE</b>

**THIS IS TO CERTIFY THAT INSULATION AND/OR SEALANT HAS BEEN INSTALLED IN CONFORMANCE WITH APPLICABLE CODES, MATERIAL STANDARDS AND REGULATIONS.**

SIGNATURE - INSULATION CONTRACTOR 	TITLE MANAGER	DATE 11-3-00
SIGNATURE - GENERAL CONTRACTOR	TITLE	DATE

REMARKS