

CITY OF SACRAMENTO
1231 I Street, Sacramento, CA 95814

Permit No: 0104700

Insp Area: 4

Site Address: 2207 SHADY ARBOR WY SAC
Parcel No: 274-0490-008 LOT 8 NATOMAS W 1

Sub-Type: N1/2PLEX
Housing (Y/N): N

CONTRACTOR
KAUFMAN & BROAD
51 NORTH SUNRISE AV #1012
ROSEVILLE CA 95661

OWNER

ARCHITECT

Nature of Work: NSFR HALF-PLEX. MP1114. 4 RMS

CONSTRUCTION LENDING AGENCY: I hereby affirm under penalty of perjury that there is a construction lending agency for the performance of the work for which this permit is issued (Sec. 3097, Civ. C.)

Lender's Name _____ Lender's Address _____

LICENSED CONTRACTORS DECLARATION: I hereby affirm under penalty of perjury that I am licensed under provisions of Chapter 9 (commencing with section 7000) of Division 3 of the Business and Professions Code and my license is in full force and effect.

License Class B License Number 255425 Date 5/03/01 Contractor Signature [Signature]

OWNER-BUILDER DECLARATION: I hereby affirm under penalty of perjury that I am exempt from the contractors License Law for the following reason (Sec. 7031.5, Business and Professions Code: any city or county which requires a permit to construct, alter, improve, demolish, or repair any structure, prior to its issuance, also requires the applicant for such permit to file a signed statement that he or she is licensed pursuant to the provisions of the Contractors License Law (Chapter 9 (commencing with Section 7000) of Division 8 of the Business and Professions Code) or that he or she is exempt therefrom and the basis for the alleged exemption: Any violation of Section 7031.5 by any applicant for a permit subjects the applicant to a civil penalty of not more than five hundred dollars (\$500.00).

I, as a owner of the property, or my employees with wages as their sole compensation, will do the work, and the structure is not intended or offered for sale (Sec. 7044, Business and Professional Code: The Contractors License Law does not apply to an owner of property who builds or improves thereon, and who does such work himself or herself or through his/her own employees, provided that such improvements are not intended or offered for sale. If, however, the building or improvement is sold within one year of completion, the owner-builder will have the burden of proving that he/she did not build or improve for the purpose of sale.)

I, as owner of the property, am exclusively contracting with licensed contractors to construct the project (Sec. 7044, Business and Professions Code: The Contractors License Law does not apply to an owner of property who builds or improves thereon, and who contracts for such projects with a contractor(s) licensed pursuant to the Contractors License Law)

I am exempt under Sec. _____ B & PC for this reason: _____

Date _____ Owner Signature _____

IN ISSUING THIS BUILDING PERMIT, the applicant represents, and the city relies on the representation of the applicant, that the applicant verified all measurements and locations shown on the application or accompanying drawings and that the improvement to be constructed does not violate any law or private agreement relating to permissible or prohibited locations for such improvements. This building permit does not authorize any illegal location of any improvement or the violation of any private agreement relating to location of improvements.

I certify that I have read this application and state that all information is correct. I agree to comply with all city and county ordinances and state laws relating to building construction and hereby authorize representative(s) of this city to enter upon the above mentioned property for inspection purposes.

Date 5/03/2001 Applicant/Agent Signature [Signature]

WORKER'S COMPENSATION DECLARATION: I hereby affirm under penalty of perjury one of the following declarations:

I have and will maintain a certificate of consent to self-insure for workers' compensation as provided for by Section 3700 of the Labor Code, for the performance of work for which the permit is issued

I have and will maintain workers' compensation insurance, as required by Section 3700 of the Labor Code, for the performance of the work for which this permit is issued. My workers' compensation insurance carrier and policy number are:

Carrier _____ Policy Number _____ Exp Date _____

(This section need not be completed if the permit is for \$100 or less) I certify that in the performance of the work for which this permit is issued, I shall not employ any person in any manner so as to become subject to the workers' compensation laws of California and agree that if I should become subject to the workers' compensation provisions of Section 3700 of the Labor Code, I shall forthwith comply with those provisions.

Date 5/03/01 Applicant Signature [Signature]

WARNING: FAILURE TO SECURE WORKER'S COMPENSATION COVERAGE IS UNLAWFUL AND SHALL SUBJECT AN EMPLOYER TO CRIMINAL PENALTIES AND CIVIL FINES UP TO ONE HUNDRED THOUSAND DOLLARS (\$100,000) IN ADDITION TO THE COST OF COMPENSATION, DAMAGES AS PROVIDED FOR IN SECTION 3706 OF THE LABOR CODE, INTEREST AND ATTORNEY'S FEE.

THIS PERMIT SHALL EXPIRE BY LIMITATION IF WORK IS NOT COMMENCED WITHIN 180 DAYS.

CERTIFICATION OF INSULATION

ADDRESS OR TRACT

SACRAMENTO INSULATION CONTRACTORS

*H4B
CALIF. Garden
Sacto. CA*

LOT # *30*

- P.O. BOX 854, WEST SACRAMENTO, CA 95691 LIC. #202026
- 1309 MELODY ROAD, MARYSVILLE, CA 95901 LIC. #202026
- P.O. BOX 9651, FRESNO, CA 93793-9651 LIC. #202026
- P.O. BOX 1631, RENO, NV 89505 LIC. #10675
- 3326 A PONDEROSA WAY, LAS VEGAS, NV 89118 LIC. #10675

DATE INSULATION COMPLETED

PART I GENERAL

PART II AREAS INSULATED

WALLS	CEILINGS	FLOORS				
(SQUARE FEET)	(SQUARE FEET)	(SQUARE FEET)				
TYPE OF INSULATION	TYPE OF INSULATION	TYPE OF INSULATION				
MATERIAL FIBERGLASS	MATERIAL FIBERGLASS	MATERIAL FIBERGLASS				
FORM BATTS	FORM BATTS & BLOW	FORM BATTS				
MANUFACTURER'S PRODUCT I.D.	MANUFACTURER'S PRODUCT I.D.	MANUFACTURER'S PRODUCT I.D.				
MANUFACTURER	MANUFACTURER	MANUFACTURER				
OCF	OCF	OCF				
	BAGS					
R-VALUE INSTALLED	APPLIED THICKNESS	R-VALUE INSTALLED	APPLIED THICKNESS	WEIGHT PER SQUARE FOOT	R-VALUE INSTALLED	APPLIED THICKNESS
<i>13</i>	<i>3 1/2"</i>	<i>38</i>				
		<i>38 Batts</i>				

KNEE WALLS IF R-VALUE IS OTHER THAN WALLS ABOVE

MATERIAL	FORM	R VALUE	MANUFACTURER
FIBERGLASS	BATTS		OCF

AIR INFILTRATION SEALANT

MATERIAL	MANUFACTURER
<i>FOAM</i>	W R GRACE

THIS IS TO CERTIFY THAT INSULATION AND/OR SEALANT HAS BEEN INSTALLED IN CONFORMANCE WITH APPLICABLE CODES, MATERIAL STANDARDS AND REGULATIONS.

SIGNATURE—INSULATION CONTRACTOR <i>JEFF Cady</i>	TITLE MANAGER	DATE
SIGNATURE—GENERAL CONTRACTOR	TITLE	DATE

REMARKS:

PART III CERTIFICATION

MEMORANDUM OF SUPPLEMENTAL INSTRUCTIONS

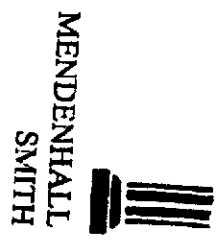

Date: Aug. 2, 2001

To: Greg Wilson/ Todd Fulton
Company: KB Homes
Fax Number:

From: Robert Mildenhall
Subject: PT Slab Clarifications
Project: California Gardens

CL Todd Fulton
772-7590
Total Pages: 1
(including this one)

REMARKS:

Todd,

Lateral vent piping at drain areas may be run up to four feet within the slab thickness. Piping diameter shall not exceed 2".
Should further clarifications of the above items be required, please feel free to call me at 916-652-7801.
Thank you.

Robert Mildenhall, P. E.

3571 RED ROCK STREET, SUITE A
LAS VEGAS, NEVADA 89103
P.O. BOX 702367 LAS VEGAS, NV 89103
FAX 702.367.2727

8/2/01

RESIDENTIAL SUBDIVISION BUILDING PERMIT APPLICATION

Project Address: 2207 Shady Arbor Dr Assessor Parcel # 274-049-008
Lot Number: 8A Subdivision Natomas West Village 1

OWNER INFORMATION:

Legal Property Owner: KB Home Phone# 707-469-2464
Owner Address: 611 Orange dr City Vacaville State CA Zip 95687

CONTRACTOR INFORMATION:

Contractor: KB Home Lic. # 761970 Phone # 707-469-2464 Fax 469-2405

PROJECT INFORMATION:

Land Use Zone R1A Occupancy Group R3 Construction Type VN Fed Code 1A
No. of Stories: 1 No. of Rooms: 6 Street Width: _____
1st Floor Area 1114 2nd Floor Area _____ Basement _____ Roof Material _____
AREA IN SQUARE FOOT OF:
Dwelling/Living 1114
Garage/Storage 230
Decks/Balconies 30
Carports _____
SCOPE OF WORK: New Single Family Dwelling

FOR OFFICE USE ONLY

- Information Above Complete
- Violation Files Checked
- Standard Setbacks
- County Sewer
- AR Flood Waiver Required
- Flood Elevation Certificate Required
- Water Development Infill Area
- Planning Approval
- Design Review Approval
- Special Fee Districts Apply:

THE FOLLOWING MUST BE PROVIDED IN ORDER TO SUBMIT FOR PERMIT

- 2 COMPLETE PLOT PLANS, LEGIBLE & DRAWN TO SCALE
- 11 X 17 COPY OF FLOOR PLAN WITH FOLLOWING INFORMATION
 - a) Assessor's Parcel Number
 - b) New Floor Area
 - c) Owners Name
 - d) Project Address

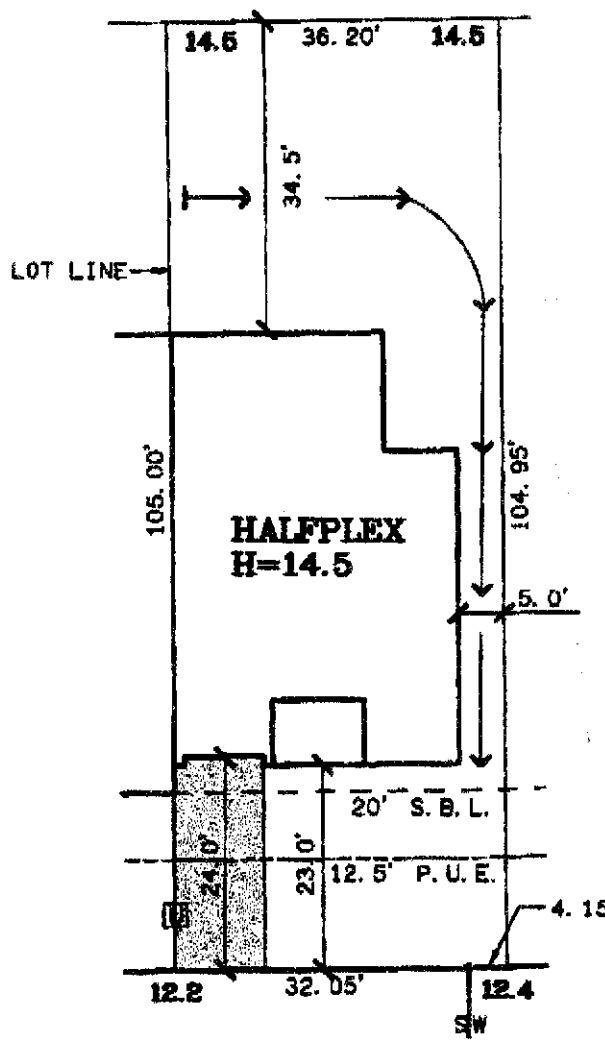

SHADY ARBOR DRIVE

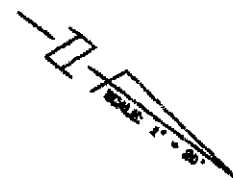

DATE: 12/4/88

A.P.N.:

ADDRESS: SHADY ARBOR DRIVE

LOT AREA: 3,801 SF

LOT COVERAGE: 36%

The Splink Corporation

2590 VENTURE OAKS WAY
SACRAMENTO, CA 95833

PH (916)925-5550 FAX (916)921-9274

**NATOMAS WEST
VILLAGE 1**

**LOT 8
PLAN HP**

CALIFORNIA GARDENS

CITY OF SACRAMENTO, CA
CLIENT: KAUFMAN & BROAD