

CITY OF SACRAMENTO

Permit No: 9804767

1231 I Street, Sacramento, CA 95814

Insp Area: 1

Site Address: 2526 L ST SAC

Sub-Type: REM

Parcel No: 0070163007

Housing (Y/N): N

CONTRACTOR

OWNER

ARCHITECT

HOUSING AUTHORITY/CITY OF SACRAMENTO
6020 RUTLAND DR #12
CARMICHAEL CA 95608

Nature of Work: SHRA / REPLACE 7 DAMAGED SECURITY LIGHTS

CONSTRUCTION LENDING AGENCY: I hereby affirm under penalty of perjury that there is a construction lending agency for the performance of the work for which this permit is issued (Sec. 3097, Civ. C).

Lender's Name _____ Lender's Address _____

LICENSED CONTRACTORS DECLARATION: I hereby affirm under penalty of perjury that I am licensed under provisions of Chapter 9 (commencing with section 7000) of Division 3 of the Business and Professions Code and my license is in full force and effect.

License Class _____ License Number _____ Date _____ Contractor Signature _____

OWNER-BUILDER DECLARATION: I hereby affirm under penalty of perjury that I am exempt from the contractors License Law for the following reason (Sec. 7031.5, Business and Professions Code; any city or county which requires a permit to construct, alter, improve, demolish, or repair any structure, prior to its issuance, also requires the applicant for such permit to file a signed statement that he or she is licensed pursuant to the provisions of the Contractors License Law (Chapter 9 (commencing with Section 7000) of Division 8 of the Business and Professions Code) or that he or she is exempt therefrom and the basis for the alleged exemption. Any violation of Section 7031.5 by any applicant for a permit subjects the applicant to a civil penalty of not more than five hundred dollars (\$500.00);

Ge I, as a owner of the property, or my employees with wages as their sole compensation, will do the work, and the structure is not intended or offered for sale (Sec. 7044, Business and Professional Code: The Contractors License Law does not apply to an owner of property who builds or improves thereon, and who does such work himself or herself or through his/her own employees, provided that such improvements are not intended or offered for sale. If, however, the building or improvement is sold within one year of completion, the owner-builder will have the burden of proving that he/she did not build or improve for the purpose of sale.)

I, as owner of the property, am exclusively contracting with licensed contractors to construct the project (Sec. 7044, Business and Professions Code: The Contractors License Law does not apply to an owner of property who builds or improves thereon, and who contracts for such projects with a contractor(s) licensed pursuant to the Contractors License Law).

Ge I am exempt under Sec. _____ B & PC for this reason: _____

Date *6-3-98* Owner Signature *[Signature]*

IN ISSUING THIS BUILDING PERMIT, the applicant represents, and the city relies on the representation of the applicant, that the applicant verified all measurements and locations shown on the application or accompanying drawings and that the improvement to be constructed does not violate any law or private agreement relating to permissible or prohibited locations for such improvements. This building permit does not authorize any illegal location of any improvement or the violation of any private agreement relating to location of improvements.

I certify that I have read this application and state that all information is correct. I agree to comply with all city and county ordinances and state laws relating to building construction and hereby authorize representative(s) of this city to enter upon the abovementioned property for inspection purposes.

Date *6-3-98* Applicant/Agent Signature *[Signature]*

WORKER'S COMPENSATION DECLARATION: I hereby affirm under penalty of perjury one of the following declarations:

I have and will maintain a certificate of consent to self-insure for workers' compensation as provided for by Section 3700 of the Labor Code, for the performance of work for which the permit is issued.

I have and will maintain workers' compensation insurance, as required by Section 3700 of the Labor Code, for the performance of the work for which this permit is issued. My workers' compensation insurance carrier and policy number are:

Carrier *Morgan* Policy Number _____

Ge (This section need not be completed if the permit is for \$100 or less) I certify that in the performance of the work for which this permit is issued, I shall not employ any person in any manner so as to become subject to the workers' compensation laws of California and agree that if I should become subject to the workers' compensation provisions of Section 3700 of the Labor Code, I shall forthwith comply with those provisions.

Date *6-3-98* Applicant Signature *[Signature]*

WARNING: FAILURE TO SECURE WORKER'S COMPENSATION COVERAGE IS UNLAWFUL AND SHALL SUBJECT AN EMPLOYER TO CRIMINAL PENALTIES AND CIVIL FINES UP TO ONE HUNDRED THOUSAND DOLLARS (\$100,000) IN ADDITION TO THE COST OF COMPENSATION, DAMAGES AS PROVIDED FOR IN SECTION 3706 OF THE LABOR CODE, INTEREST AND ATTORNEY'S FEE.

THIS PERMIT SHALL EXPIRE BY LIMITATION IF WORK IS NOT COMMENCED WITHIN 180 DAYS.

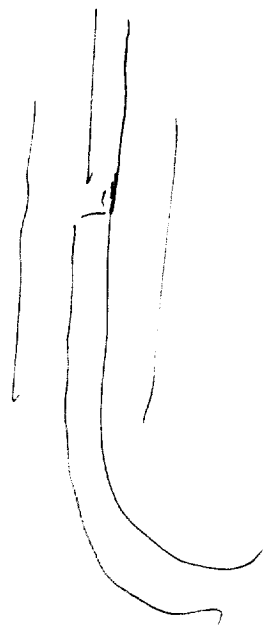
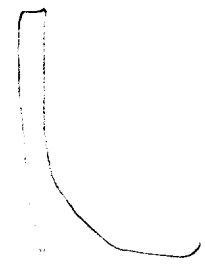
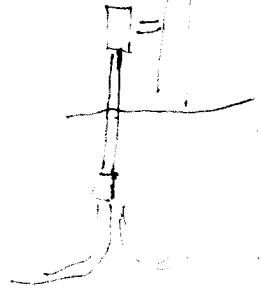

99-4767

REMOVE AND REPLACE EXISTING FIXTURES WITH PROGRESS LIGHTING FIXTURE MODEL NO P5479-60, 120VAC NPF BALLAST, PLC-28 COMPACT FLUORESCENT LAMP W/ 3" Ø POST. (TYPICAL FOR SIX (6))

L STREET

Replace existing lighting & conduit.

All work subject to field inspection.

NOTE: SAWCUT WALK AND REPAIR/REPLACE DEFECTIVE CONDUIT AS NECESSARY

TO PANEL "L" CB #9 VIA TIME SWITCH

PANEL "L"

MECH ROOM

2526 L STREET

PERIMETER LIGHTING RETROFIT

SCALE: 1/16" = 1'-0"

5/27/98

SP

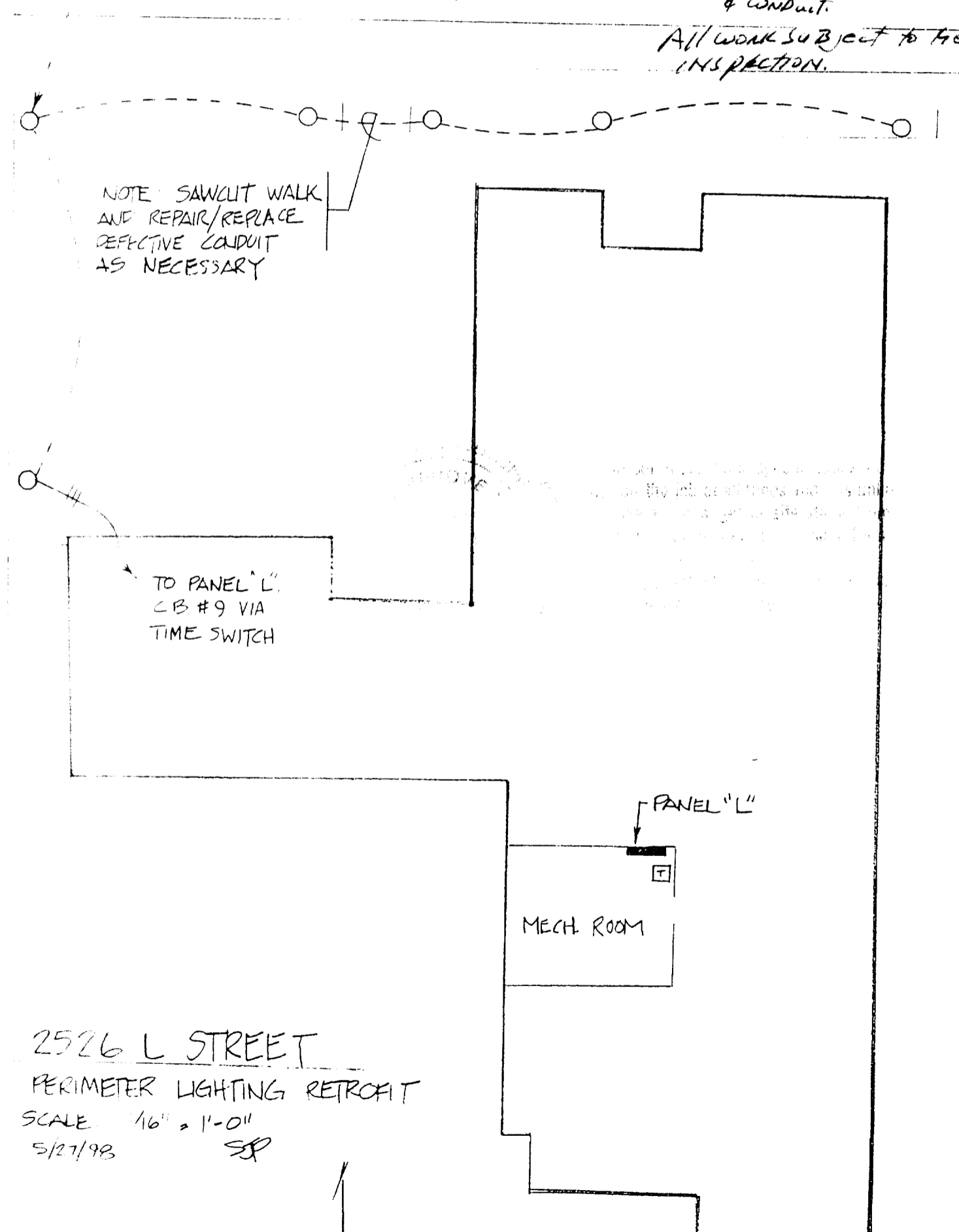

Post-Top Globes

Modular Units

For complete units, order post fitter and shatter-resistant acrylic globe. Each can be interchanged for added lighting versatility. All fitters are equipped with integral post line type ballast. (Fitters can be retrofitted into existing globes (order separately).)

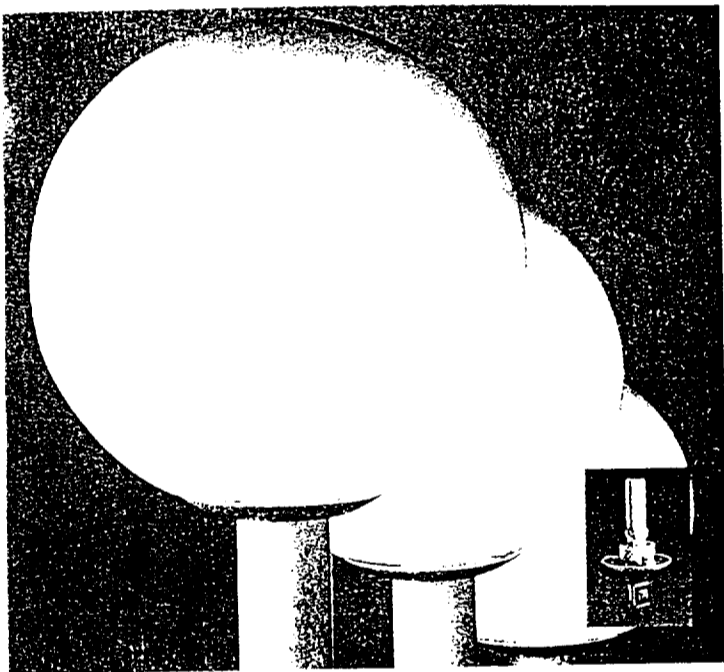

Acrylic Globes Only

Catalog No.	Diameter	Color
P5470-60	12"	White
P5471-60	14"	White
P5472-60	16"	White

Post Fitters

Must be ordered with globes (above)



Catalog No.	Standard Ballast(s)	Lamp(s)
P5467-30	120V NPF	One PLC-28
P5468-30	120V HPF	One PLC-28
P5469-30	120V HPF	Two PLC-28

Note:

Fitter NOT Compatible with Post

P5467-30	P5392-31C
P5468-30	P5392-31PC
P5469-30	P5391-30 or P5392-31PC
P5479-60	P5392-31PC

Complete Units

Globes and fitters are shipped together to make one complete fixture.

- ▶ **P5426-60** Complete post lantern. White shatter-resistant acrylic globe. White fitter. Size: 12" dia., 10" ht. Fits 3" post (order separately). Lamp: One medium base lamp, 100w max.
- ▶ **P5436-60** Same as P5426-60 except with black globe. Lamp: One medium base lamp, 100w max.
- ▶ **P5446-60** Same as P5436-60 except with white globe. Lamp: One medium base lamp, 200w max.

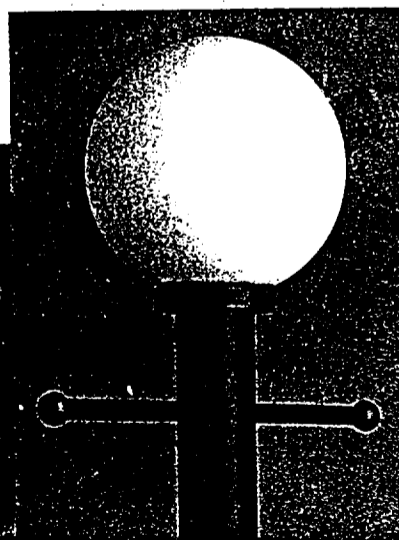
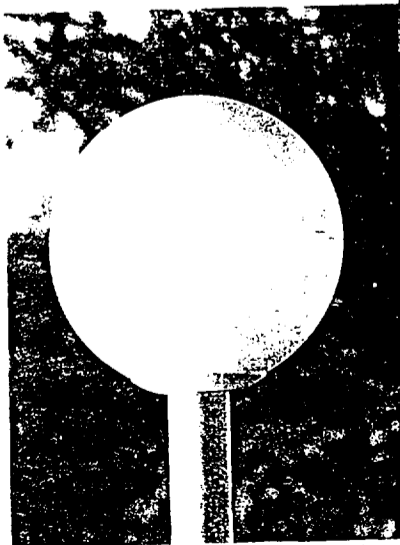

- ▶ **P5478-60** Complete post lantern. White shatter-resistant 10" acrylic twist-lock globe. Black fitter. Size: 10" dia., 10-1/4" ht. Fits 3" post (order separately). Lamp: One medium base lamp, 100w max.



◀ **P7828-01** PLC-28 Compact fluorescent lamp.



- ▶ **P5479-60** Same as P5478-60 except with standard 120V NPF ballast. Lamp: One PLC-28 Quad compact fluorescent lamp.



Medium Base Lamp



Compact Fluorescent Lamp

Posts and other mounting accessories on page 208

H/CTR = Height from center of J-box to top of fixture



Energy Efficient Fluorescent

Outdoor

Posts & Mounting Accessories

Decorative Cast Posts

Cast aluminum posts for surface mount only. 1/2" bolts and template included.

- ▶ **P5330-31** (Shown with P5403) Black. Decorative post accepts all single lanterns except P5404-31 and P5410-31 HRS post lanterns. Size: 3" dia., 40" base, 75-1/2" ht.

- ▶ **P5331-31** Black. Decorative post accepts any single lantern designed for a 3" dia. post. Size: 11-3/4" base, 84-1/2" ht.

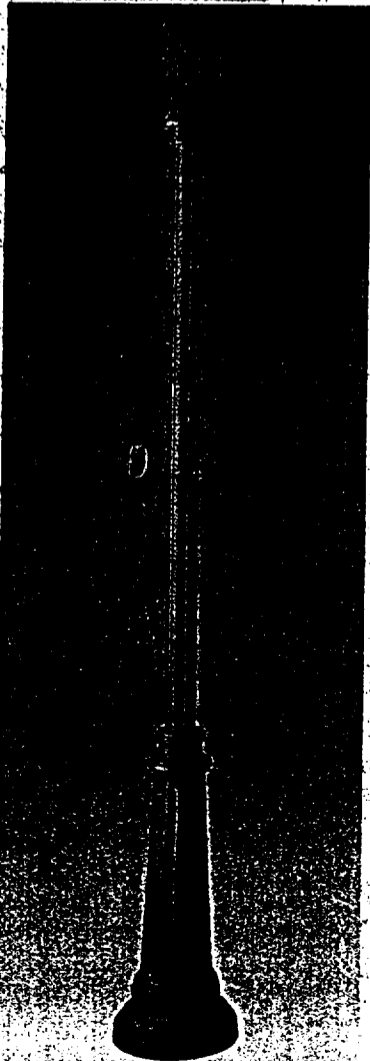

Posts

Accepts any single lantern which fits a 3" diameter post. Use full 7" ht. or cut to desired length.



P5390-31 Black aluminum post

P5393-31 Black steel post.

P5393-30 White

P5390-31PC Same as above except with photoelectric cell which automatically turns lantern on at dusk, off at dawn.

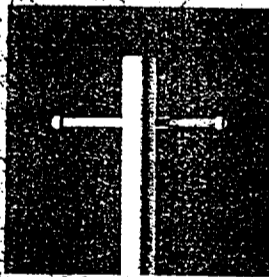

P5391-30 White

P5391-31 Black

Aluminum post with ladder rest.

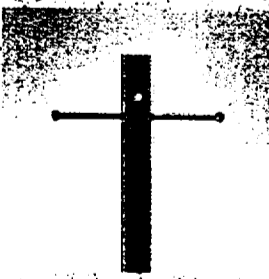

P5392-31PC

Black aluminum post with ladder rest. Has weatherproof G.C.O. and photoelectric cell which automatically turns lantern on at dusk, off at dawn.

Mounting Accessories

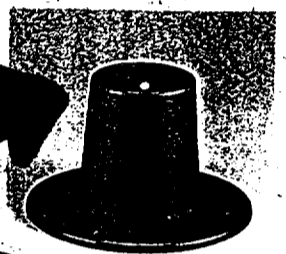

Surface Mount Post Adapter

P8748-31 Black. Flanged cast aluminum base for surface mounting round, 3" bottom O.D. posts. Anchor bolts and set screws included. Size: 8" dia., 5" ht.

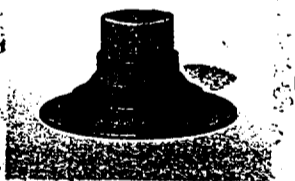

Pedestal Mount

P8726-31

Black cast aluminum

P8726-10

Polished solid brass

P8726-25

Verde cast aluminum

P8726-30

White cast aluminum

For mounting post lanterns (except

P5404-31, P5405,

P5410-31, P5467,

P5468, P5469) on

pedestals or walls.

Size: 7" dia., 3-1/4" ht.

98-4767

REMOVE AND REPLACE EXISTING FIXTURES WITH PROGRESS LIGHTING FIXTURE MODEL NO P5479-60, 20VAC NPF BALLAST, PLC-28 COMPACT FLUORESCENT LAMP W/ 3" Ø POST. (TYPICAL FOR SIX (6))

Replack
existing lighting
& conduit

L STREET

All work subject to
Field inspection



NOTE SAWCUT WALK
AND REPAIR/REPLACE
DEFECTIVE CONDUIT
AS NECESSARY

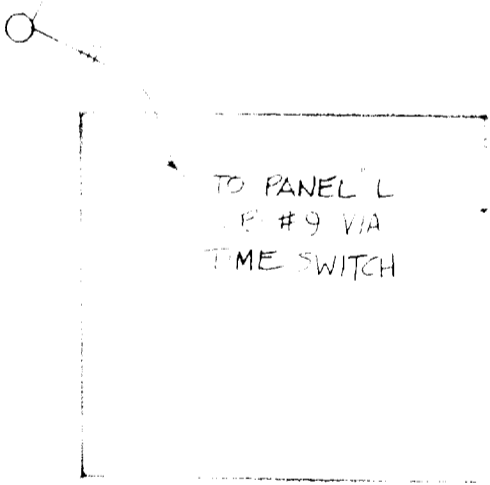

TO PANEL "L"
L#9 VIA
TIME SWITCH

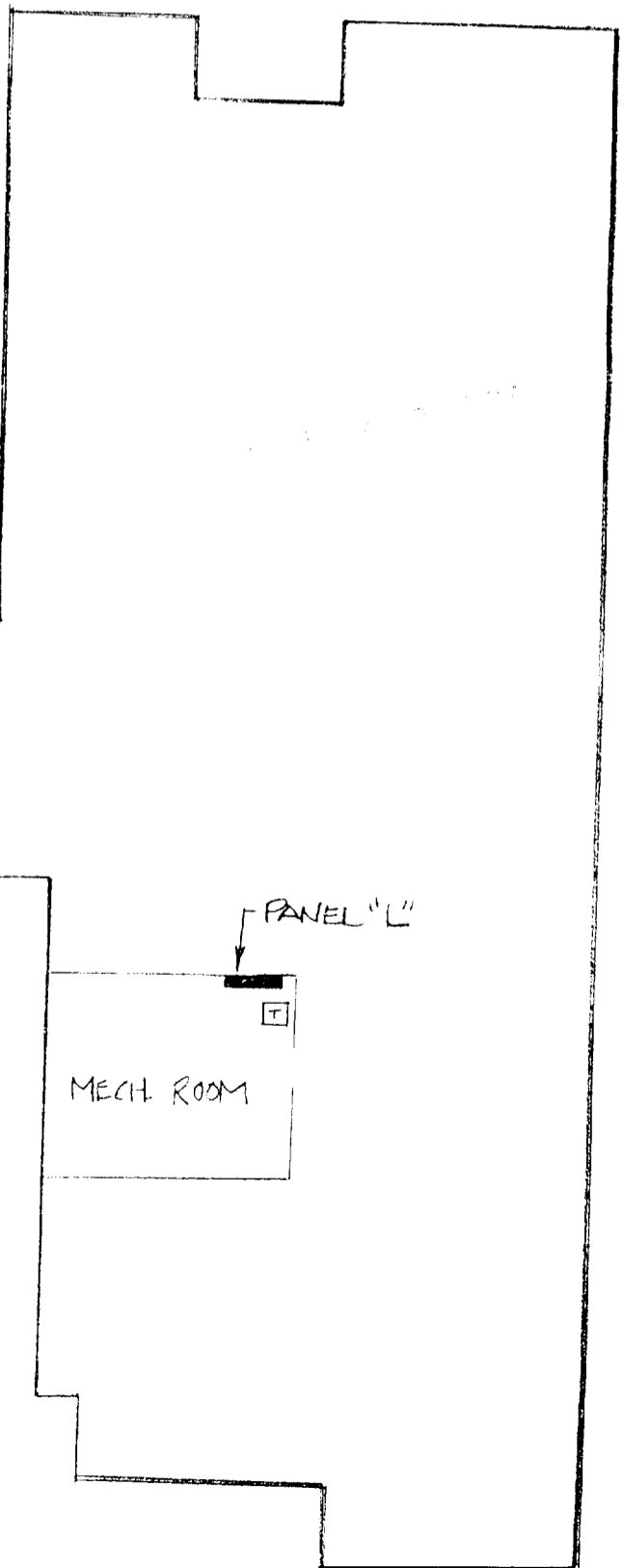

2526 L STREET

PERIMETER LIGHTING RETROFIT

SCALE 1/8" = 1'-0"

5/27/98

SP



Module Units

These units feature a shatter and shatter-resistant acrylic globe for long life and improved lighting versatility. All fitters are designed to accommodate the tube ballast fitters can be ordered separately.

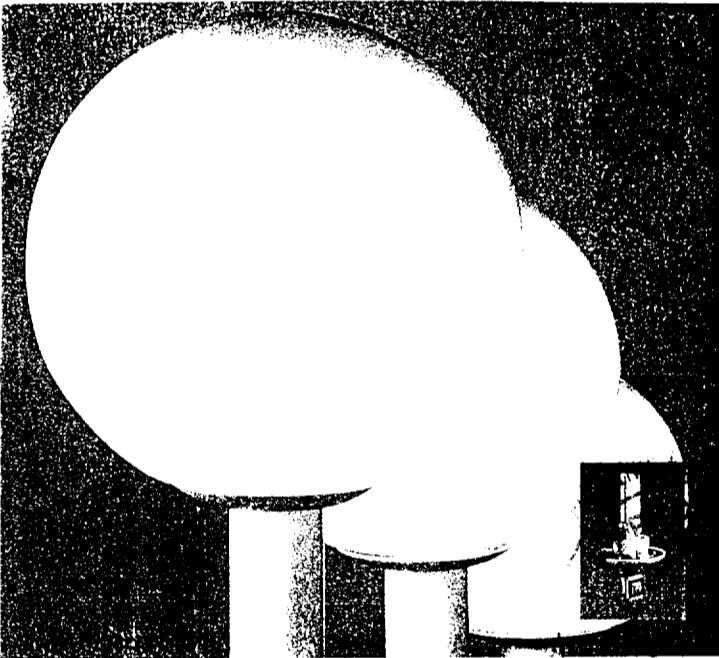

Post-Top Globes

Acrylic Globes Only

Catalog No.	Diameter	Color
P5470-60	12"	White
P5471-60	14"	White
P5472-60	16"	White

Post Fitters

Must be ordered with globes (above) 

Catalog No.	Standard Ballast(s)	Lamp(s)
P5467-30	120V NPF	One PLC-28
P5468-30	120V HPF	One PLC-28
P5469-30	120V HPF	Two PLC-28

Note:

Fitter *NOT Compatible with Post*

P5467-30	P5392-31C
P5468-30	P5392-31PC
P5469-30	P5391-30 or P5392-31PC
P5479-60	P5392-31PC

Complete Units

These units are complete with the globe and fitter.

- ▶ P5426-60 Complete post lantern. White shatter-resistant 10" acrylic twist-lock globe. Black fitter. Size: 10" dia., 10-1/4" ht. Lamp: One medium base lamp.
- ▶ P5436-60 Complete post lantern. White shatter-resistant 10" acrylic twist-lock globe. Black fitter. Size: 10" dia., 10-1/4" ht. Lamp: One medium base lamp.
- ▶ P5446-60 Complete post lantern. White shatter-resistant 10" acrylic twist-lock globe. Black fitter. Size: 10" dia., 10-1/4" ht. Lamp: One medium base lamp.

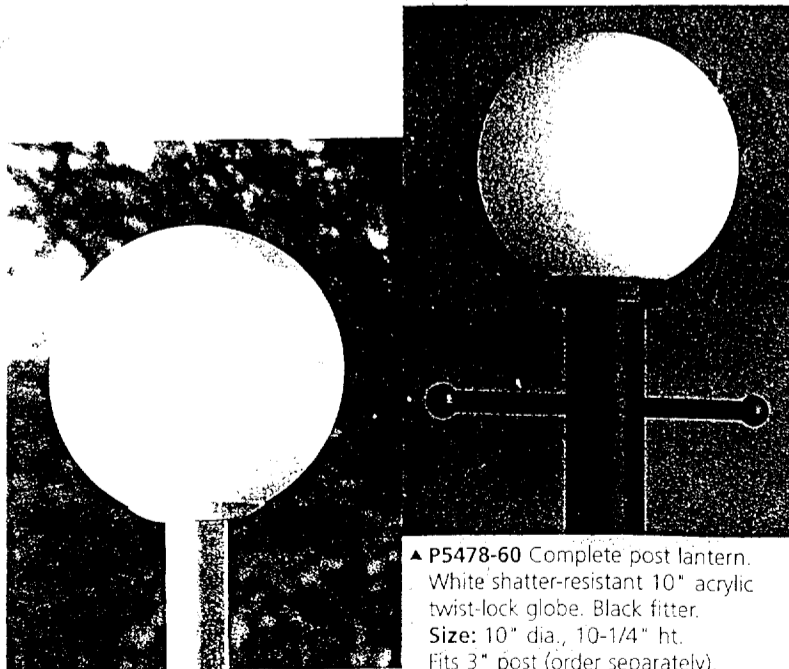

Medium Base Lamp

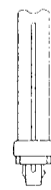

Compact Fluorescent Lamp

Posts and other mounting accessories on page 208

H/CTR = Height from center of I-box to top of fixture



Energy Efficient Fluorescent



◀ P7828-01 PLC-28 Compact fluorescent lamp.



▶ P5479-60 Same as P5478-60 except with standard 120V NPF ballast. Lamp: One PLC-28 Quad compact fluorescent lamp.

Outdoor

Posts & Mounting Accessories

Decorative Cast Posts

Cast aluminum posts for surface mount only. Post and template included.

- ▶ **P5330-31** (Shown with P5403) Black decorative post accepts all single lanterns except P5404-31 and P5410-31 HPS post lanterns.
Size: 3" dia., 40" base, 75-1/2" ht.

- ▶ **P5331-31** Black decorative post accepts any single lantern designed for a 3" dia. post.
Size: 3"-3/4" base, 84-1/2" ht.

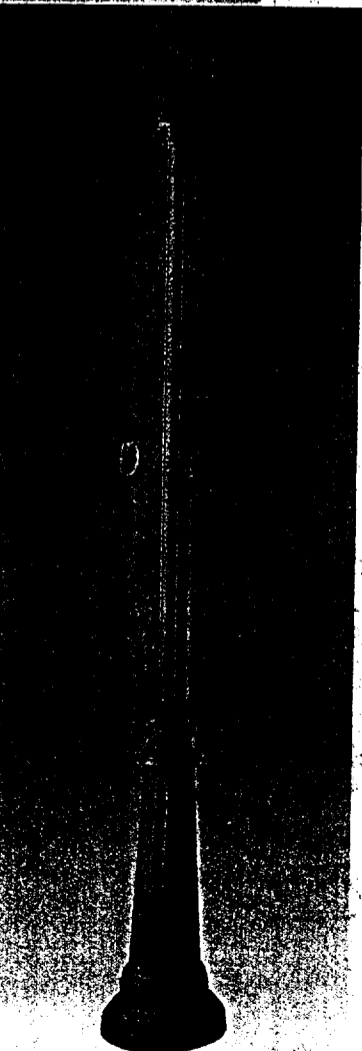

Posts

Accepts any single lantern which fits a 3" diameter post. Use full 7" ht. or cut to desired length.



P5390-31 Black aluminum post

P5393-31 Black steel post

P5393-30 White

P5390-31PC Same as above except with photoelectric cell which automatically turns lantern on at dusk, off at dawn.

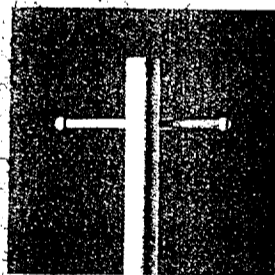

P5391-30 White

P5391-31 Black

Aluminum post with ladder rest.

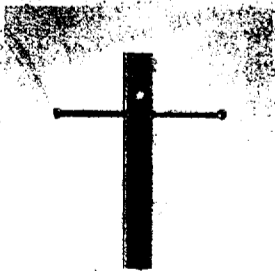

P5392-31PC

Black aluminum post with ladder rest. Has weatherproof G.C.O. and photoelectric cell which automatically turns lantern on at dusk, off at dawn.

Mounting Accessories

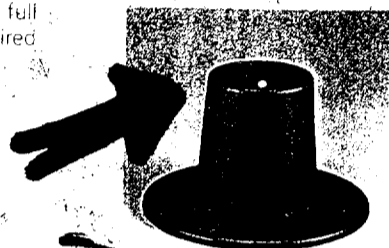

Surface Mount Post Adapter

P8748-31 Black. Flanged cast aluminum base for surface mounting round, 3" bottom O.D. posts. Anchor bolts and set screws included.
Size: 8" dia., 5" ht.



Pedestal Mount

P8726-31 Black cast aluminum
P8726-10 Polished solid brass
P8726-25 Verde cast aluminum
P8726-30 White cast aluminum for mounting post lanterns (except P5404-31, P5405, P5410-31, P5467, P5468, P5469) on pedestals or walls.
Size: 7" dia., 3-1/4" ht.