

CITY OF SACRAMENTO
1231 I Street, Sacramento, CA 95814

Permit No: 010
Insp Area: 4

Site Address: 35 SABRE CT SAC
Parcel No: 225-1470-063 NORTHPT PK 6 LOT 63

Sub-Type: .
Housing (Y/N): N

CONTRACTOR
WESTERN PACIFIC HOUSING
1210 CENTRAL BLVD
BRENTWOOD CA 94513

OWNER

ARCHITECT

Nature of Work: MP 2144/OPT 2 STORY 10 ROOM SFR

CONSTRUCTION LENDING AGENCY : I hereby affirm under penalty of perjury that there is a construction lending agency for the performance of the work for which this permit is issued (Sec. 3097, Civ. C).

Lender's Name _____ Lender's Address _____

LICENSED CONTRACTORS DECLARATION: I hereby affirm under penalty of perjury that I am licensed under provisions of Chapter 9 commencing with section 7000) of Division 3 of the Business and Professions Code and my license is in full force and effect.

License Class B License Number 675799 Date 2/2/01 Contractor Signature N. Collins

OWNER-BUILDER DECLARATION: I hereby affirm under penalty of perjury that I am exempt from the contractors License Law for the following reason (Sec. 7031.5, Business and Professions Code; any city or county which requires a permit to construct, alter, improve, demolish, or repair any structure, prior to its issuance, also requires the applicant for such permit to file a signed statement that he or she is licensed pursuant to the provisions of the Contractors License Law (Chapter 9 (commencing with Section 7000) of Division 8 of the Business and Professions Code) or that he or she is exempt therefrom and the basis for the alleged exemption. Any violation of Section 7031.5 by any applicant for a permit subjects the applicant to a civil penalty of not more than five hundred dollars (\$500.00).

____ I, as a owner of the property, or my employees with wages as their sole compensation, will do the work, and the structure is not intended or offered for sale (Sec. 7044, Business and Professional Code). The Contractors License Law does not apply to an owner of property who builds or improves thereon, and who does such work himself or herself or through his/her own employees, provided that such improvements are not intended or offered for sale. If, however, the building or improvement is sold within one year of completion, the owner-builder will have the burden of proving that he/she did not build or improve for the purpose of sale.)

____ I, as owner of the property, am exclusively contracting with licensed contractors to construct the project (Sec. 7044, Business and Professions Code). The Contractors License Law does not apply to an owner of property who builds or improves thereon, and who contracts for such projects with a contractor(s) licensed pursuant to the Contractors License Law).

I am exempt under Sec. _____ B & PC for this reason: _____

Date _____ Owner Signature _____

IN ISSUING THIS BUILDING PERMIT, the applicant represents, and the city relies on the representation of the applicant, that the applicant verified all measurements and locations shown on the application or accompanying drawings and that the improvement to be constructed does not violate any law or private agreement relating to permissible or prohibited locations for such improvements. This building permit does not authorize any illegal location of any improvement or the violation of any private agreement relating to location of improvements.

I certify that I have read this application and state that all information is correct. I agree to comply with all city and county ordinances and state laws relating to building construction and hereby authorize representative(s) of this city to enter upon the abovementioned property for inspection purposes.

Date 3/2/01 Applicant Agent Signature N. Collins

WORKER'S COMPENSATION DECLARATION: I hereby affirm under penalty of perjury one of the following declarations:

____ I have and will maintain a certificate of consent to self-insure for workers' compensation as provided for by Section 3700 of the Labor Code, for the performance of work for which the permit is issued.

I have and will maintain workers' compensation insurance as required by Section 3700 of the Labor Code, for the performance of the work for which this permit is issued. My workers' compensation insurance carrier is _____.

Carrier EAGLE INS CO Policy Number 4S-0000215 Exp Date 03/19/2001

(This section need not be completed if the permit is for \$100 or less) I certify that in the performance of the work for which this permit is issued, I shall not employ any person in any manner so as to become subject to the workers' compensation laws of California and agree that if I should become subject to the workers' compensation provisions of Section 3700 of the Labor Code, I shall forthwith comply with those provisions.

Date 3/2/01 Applicant Signature N. Collins

WARNING: FAILURE TO SECURE WORKER'S COMPENSATION COVERAGE IS UNLAWFUL AND SHALL SUBJECT AN EMPLOYER TO CRIMINAL PENALTIES AND CIVIL FINES UP TO ONE HUNDRED THOUSAND DOLLARS (\$100,000) IN ADDITION TO THE COST OF COMPENSATION, DAMAGES AS PROVIDED FOR IN SECTION 3706 OF THE LABOR CODE, INTEREST AND ATTORNEY'S FEE.

THIS PERMIT SHALL EXPIRE BY LIMITATION IF WORK IS NOT COMMENCED WITHIN 180 DAYS.

ADDITIONAL SUBDIVISION BUILDING PERMIT APPLICATION

Project Address: 35 Sabre Court
Lot Number: 63

Assessor Parcel # 225-470-063
Subdivision Northpointe Park Unit # 6

WestPA/095

OWNER INFORMATION:

Legal Property Owner: Western Pacific Housing Phone# (925) 634-6023
Owner Address: 1210 Central Boulevard, City Brentwood, State Ca. Zip 94513

CONTRACTOR INFORMATION:

Contractor: Western Pacific License# 675709/B Phone # (925) 634-6023 Fax 634-6166

PROJECT INFORMATION:

Land Use Zone RIA Occupancy Group R3 Construction Type VN Fed Code 1A
No. of Stories: 2 No. of Rooms: _____ Street Width: _____
1st Floor Area _____ 2nd Floor Area _____ Basement _____ Roof Material _____

AREA IN SQUARE FOOT OF:

Dwelling/Living 2382 + 238
Garage/Storage 427 - 238
Decks/Balconies 60
Carports _____

SCOPE OF WORK: _____

- Information Above Complete
- Violation Files Checked
- Standard Setbacks
- County Sewer
- AR Flood Waiver Required
- Flood Elevation Certificate Required
- Water Development Infill Area
- Planning Approval
- Design Review Approval
- Special Fee Districts Apply:

---THE FOLLOWING MUST BE PROVIDED IN ORDER TO SUBMIT FOR PERMIT---

- 2 COMPLETE PLOT PLANS, LEGIBLE & DRAWN TO SCALE
- 11 X 17 COPY OF FLOOR PLAN WITH FOLLOWING INFORMATION:
 - a) Assessor's Parcel Number
 - b) New Floor Area
 - c) Owners Name
 - d) Project Address

Date:

Received by: (initials)

Permit #:

CERTIFICATION OF INSULATION

WESTERN PACIFIC LOT # **63**
35 Sabre
SIENA

- P.O. BOX 851, WEST SACRAMENTO, CA 95691 LIC. #202026
- 1309 MELODY ROAD, MARYSVILLE, CA 95901 LIC. #202026
- P.O. BOX 9651, FRESNO, CA 93793-9651 LIC. #202026
- P.O. BOX 1631, RENO, NV 89505 LIC. #10675
- 3325 A PONDEROSA WAY, LAS VEGAS, NV 89118 LIC. #10675

DATE INSULATION COMPLETED
7/25/01

SQUARE FEET)		SQUARE FEET)		SQUARE FEET)	
MATERIAL FIBERGLASS		MATERIAL FIBERGLASS		MATERIAL FIBERGLASS	
FORM BATTS		FORM BATTS & BLOW		FORM BATTS	
MANUFACTURER'S PRODUCT I.D.		MANUFACTURER'S PRODUCT I.D.		MANUFACTURER'S PRODUCT I.D.	
OCF		OCF		OCF	
BAGS					
R-VALUE	APPLIED	R-VALUE	APPLIED	MIN. INSTALLED WEIGHT PER SF	
13	3 5/8"	30	9 1/2"		

MATERIAL FIBERGLASS	FORM BATTS	R-VALUE	MANUFACTURER OCF
----------------------------	-------------------	---------	-------------------------

MATERIAL FOAM	MANUFACTURER W R GRACE
----------------------	-------------------------------

SIGNATURE - INSULATION CONTRACTOR <i>Bill [Signature]</i>	TITLE MANAGER	DATE
SIGNATURE - GENERAL CONTRACTOR	TITLE	DATE

REMARKS



BASALITE®

PACIFIC STUCCO SYSTEMS

4290 Roseville Road
North Highlands, CA 95660-5710
(916) 486-4094
Fax (916) 486-4187

Installation Card
Fiber Reinforced Stucco

Job Name and Address : Western Pacific
SICARD

ICBO# 5269

7-07-01
Date of job completion
107-63

Plastering Contractor

Name: VISION PLASTERING

Address: 5 PLYMOUTH BACH

Telephone No. () 987-3324

Approved contractor as issued by Basalite/Pacific Stucco

This is to certify the exterior coating system at the above address, has been installed in accordance with the evaluation report specified above and the manufacturers instructions.

[Signature]
Signature of authorized representative of
plastering contractor

8-15-01
Date

This installation card must be presented to the building inspector after completion of work and before final inspection.

LEGEND

- SWALE
- MAILBOX
- * WOOD FENCE
- SIDEYARD GATE
- SS SEWER SERVICE
- WS WATER SERVICE
- UTILITY SERVICE
- F.F. FINISH FLOOR

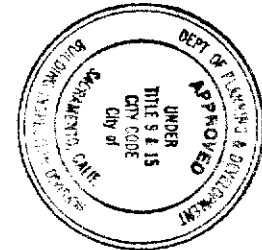
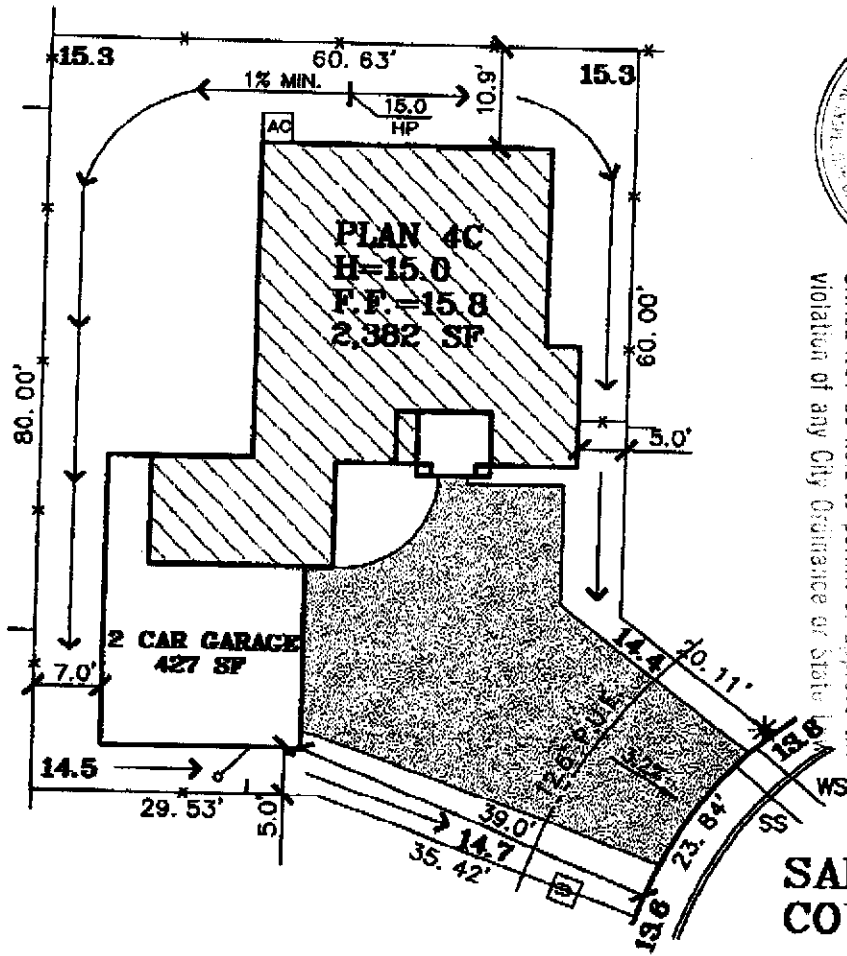

This set of plans and specifications must be kept on the job at all times and it is unlawful to make any changes or alterations from the same without written permission from the Building Inspection Division.
The approval of this plan and specification SHALL NOT be held to permit or approve the violation of any City Ordinance or State Law.

SABRE COURT

OK per Phil R
BE

LOT 63
PLAN 4C
A.P.N.:
ADDRESS: 35 SABRE COURT
LOT AREA: 5,264 SF

BECAUSE OF THE UNIQUE CONDITIONS OF THIS LOT, THE BUYER AS WALKED AND APPROVED THE SITE. FINAL GRADING CONDITIONS MAY VARY. THE INFORMATION ON THIS PLOT PLAN IS PROVIDED FOR YOUR CONVENIENCE AS A GUIDE TO THE GENERAL LOCATION OF THE SUBJECT PROPERTY. THE ACCURACY OF THIS PLOT PLAN IS NOT GUARANTEED NOR IS IT A PART OF ANY POLICY, REPORT OR GUARANTEE TO WHICH IT MAY BE ATTACHED. ACTUAL DIMENSIONS MAY VARY OR CHANGE WITHOUT PRIOR NOTICE DUE TO ACTUAL SITE CONDITIONS.

PLAN: 4
ELEVATION: C
ORIENTATION: L
COLOR: 160

SIGNED (BUYER) _____ DATE _____

The Splink Corporation
1590 VENTURE OAKS WAY
SACRAMENTO, CA 95833
t:(916)925-5550 FAX:(916)921-9374

 **Western Pacific Housing**
1210 Central Boulevard
Brentwood, CA 94513
office: (925) 634-6023
fax: (925) 634-6063

SIENA
NORTHPOINTE PARK UNIT 6
City of Sacramento, California

Scale: 1"=20' March 20, 2001