

RESOLUTION NO. 2008-161

Adopted by the Sacramento City Council

March 18, 2008

APPROVAL TO SUBMIT TRAFFIC LIGHT SYNCHRONIZATION PROGRAM (TLSP) APPLICATION

BACKGROUND

- A. Caltrans has issued a call for projects for the state TLSP. Funds are available for traffic light synchronization projects and other technology-based improvements to improve safety, operations and the effective capacity of local streets and roads. There is \$100 million available statewide for this program. Staff recommendation is to submit an application for approximately \$3 million.

BASED ON THE FACTS SET FORTH IN THE BACKGROUND, THE CITY COUNCIL RESOLVES AS FOLLOWS:

- Section 1. The Director of Transportation is authorized to submit an application for funding to the Traffic Light Synchronization Program (TLSP) for approximately \$3 million. As the project is still being scoped and estimated the exact amount of the grant request is subject to change.

Table of Contents:

- Exhibit A – Map of West El Camino Avenue
- Exhibit B – Map of Folsom Boulevard
- Exhibit C – Map of 65th Street/65th Street Expressway
- Exhibit D – Map of Fruitridge Road
- Exhibit E – Map of Power Inn Road
- Exhibit F – Map of Florin Road
- Exhibit G – Map of Pocket Road/Meadowview Road/Mack Road

Adopted by the City of Sacramento City Council on March 18, 2008 by the following vote:

Ayes: Councilmembers Cohn, Fong, Hammond, McCarty, Pannell, Sheedy, Tretheway, Waters, and Mayor Fargo.

Noes: None.

Abstain: None.

Absent: None.



Mayor Heather Fargo

Attest:



Shirley Concolino, City Clerk

LOCATION MAP FOR
WEST EL CAMINO AVENUE
ORCHARD LANE TO AMERICAN AVENUE

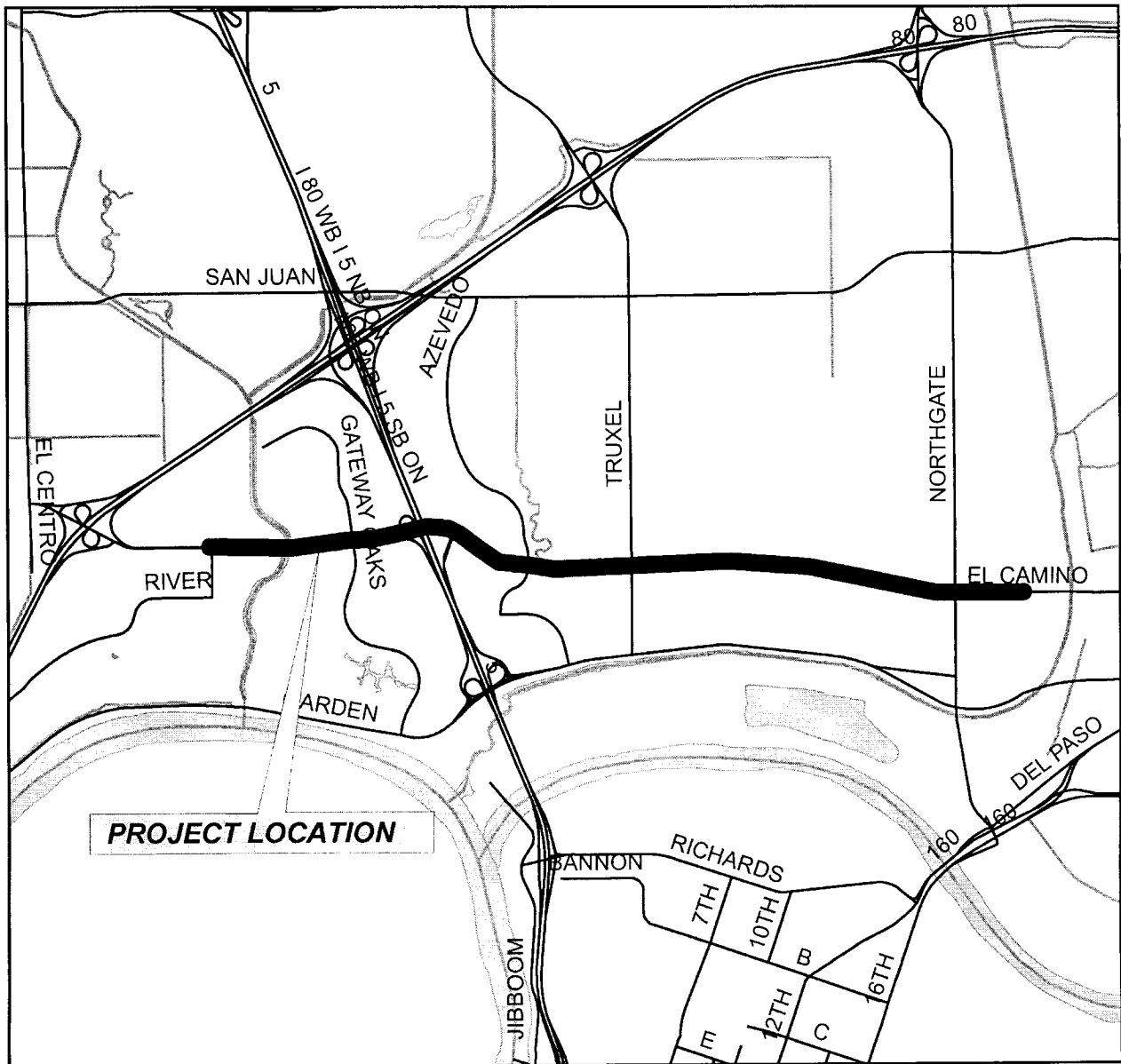

Map Contact: Hamid Khalessi
Date: February 11, 2008



LOCATION MAP FOR
FOLSOM BOULEVARD
ALHAMBRA BOULEVARD TO 65TH STREET

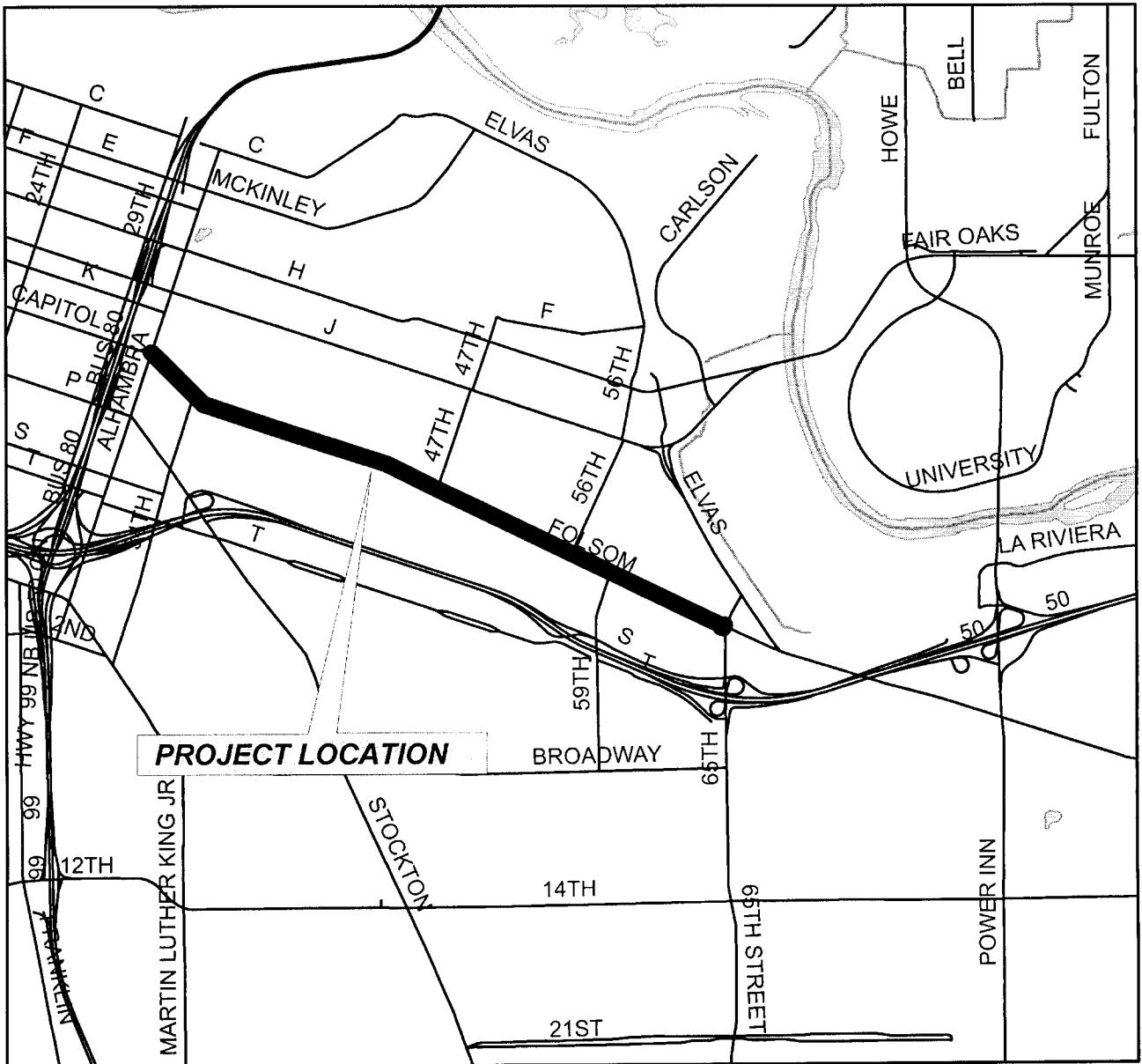

Map Contact: Hamid Khalessi
Date: February 11, 2008



LOCATION MAP FOR
65TH STREET/65TH STREET EXPRESSWAY
ELVAS AVENUE TO ELDER CREEK ROAD

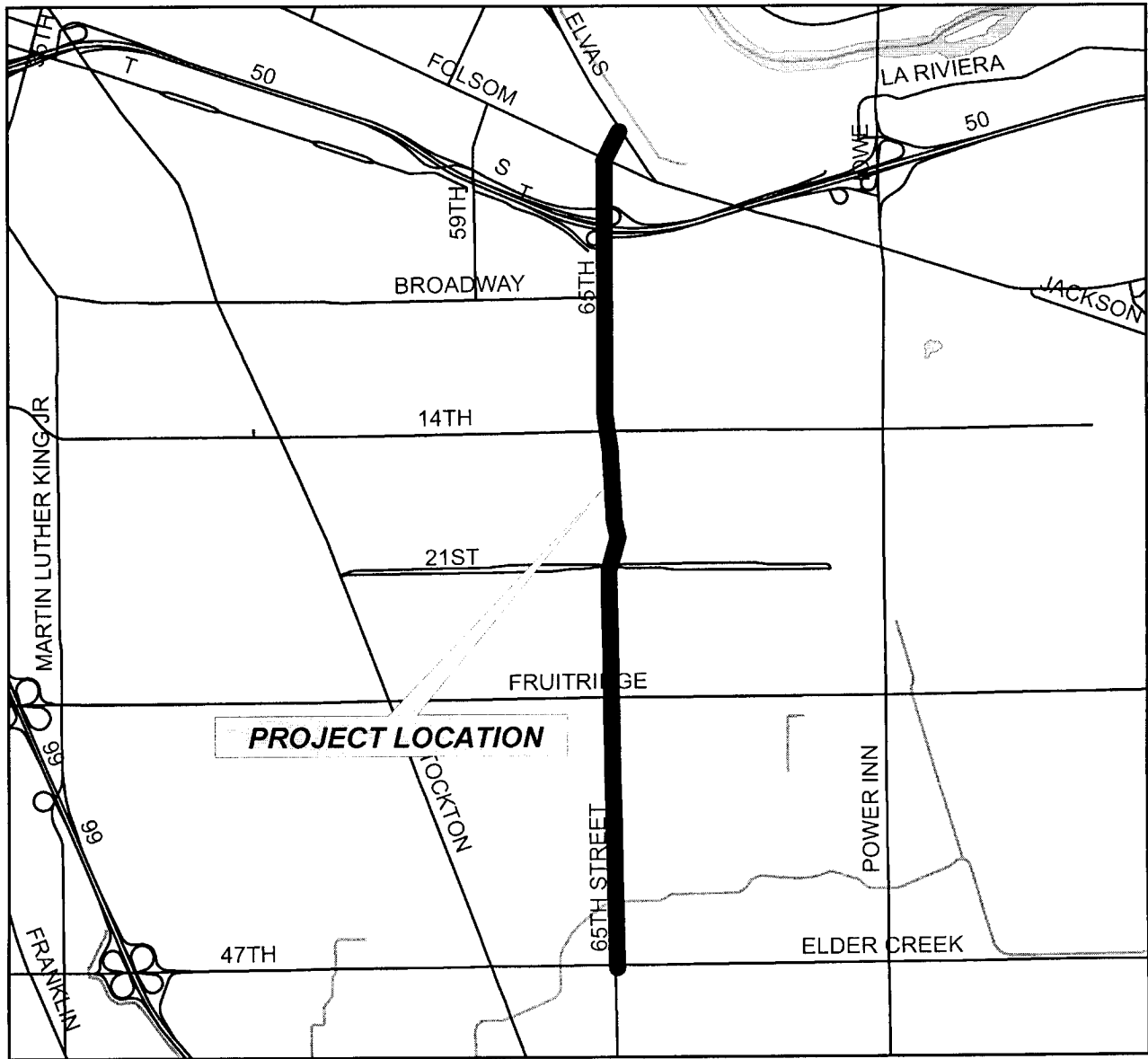

Map Contact: Hamid Khalessi
Date: February 11, 2008



LOCATION MAP FOR
FRUITRIDGE ROAD
MARTIN LUTHER KING Jr. BOULEVARD
TO FLORIN PERKINS ROAD

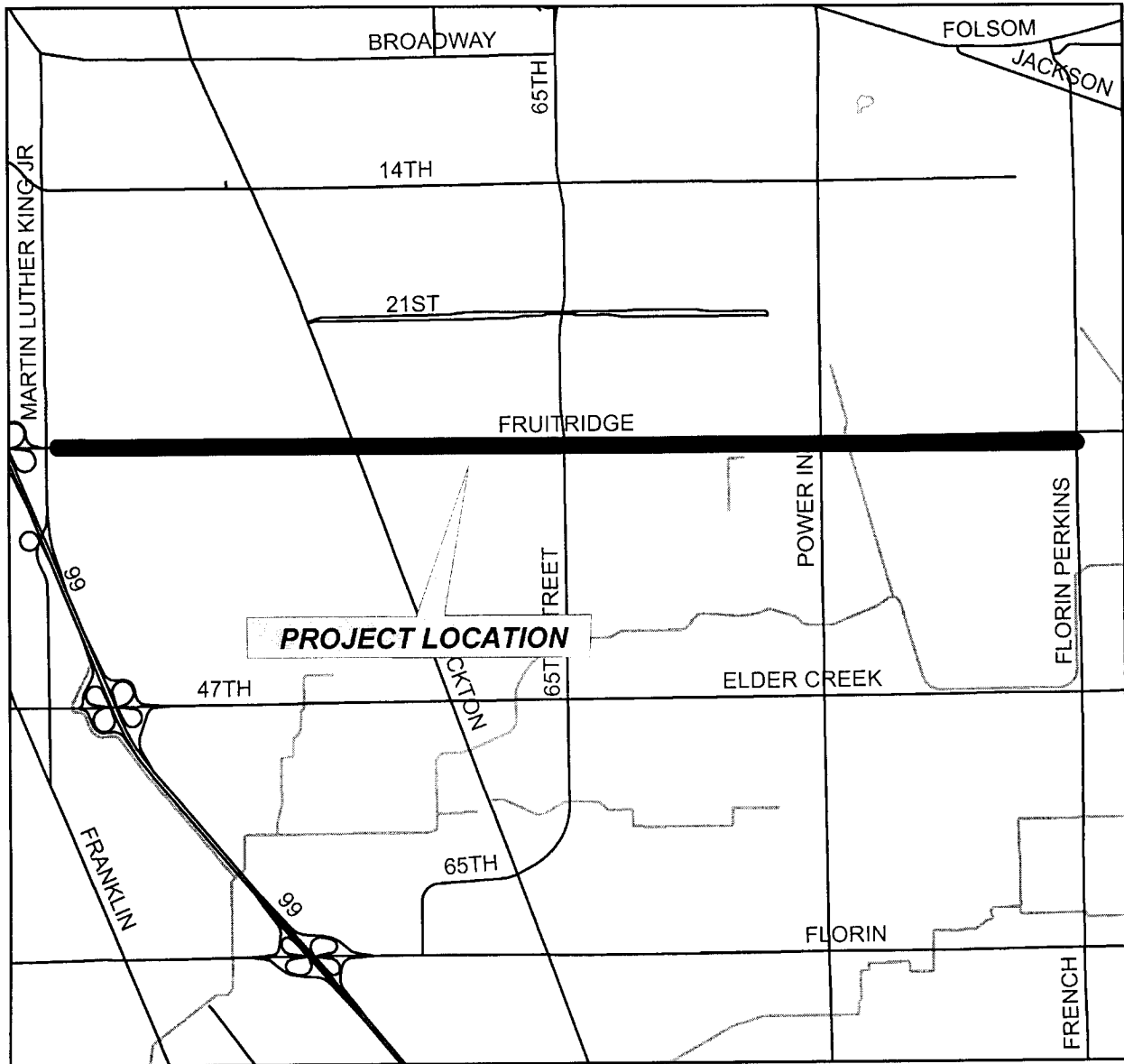

Map Contact: Hamid Khalessi
Date: February 11, 2008



LOCATION MAP FOR
POWER INN ROAD
FRUITRIDGE ROAD TO ELDER CREEK ROAD

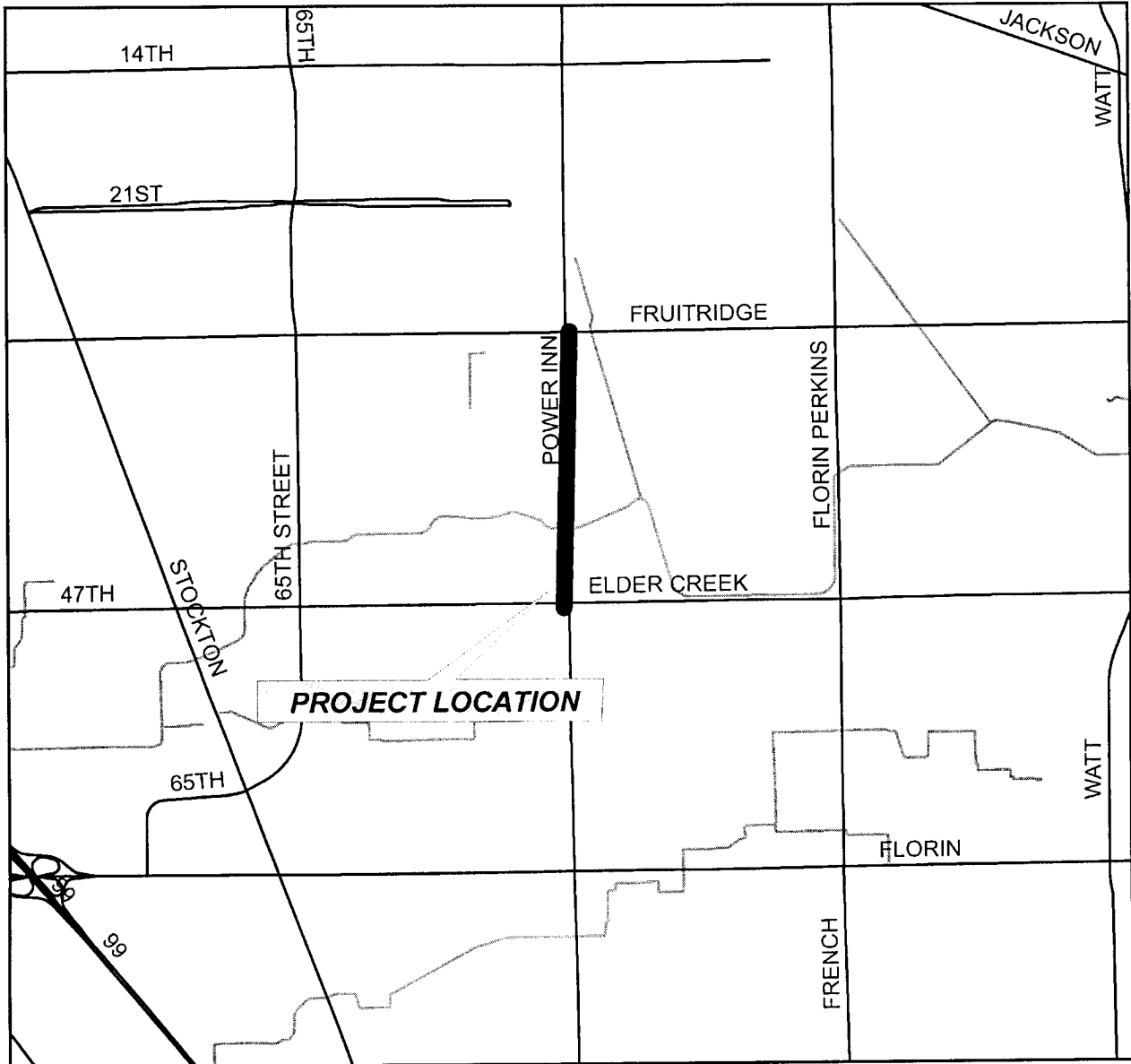

Map Contact: Hamid Khalessi
Date: February 11, 2008



LOCATION MAP FOR
FLORIN ROAD
GREENHAVEN DRIVE TO FRANKLIN BOULEVARD

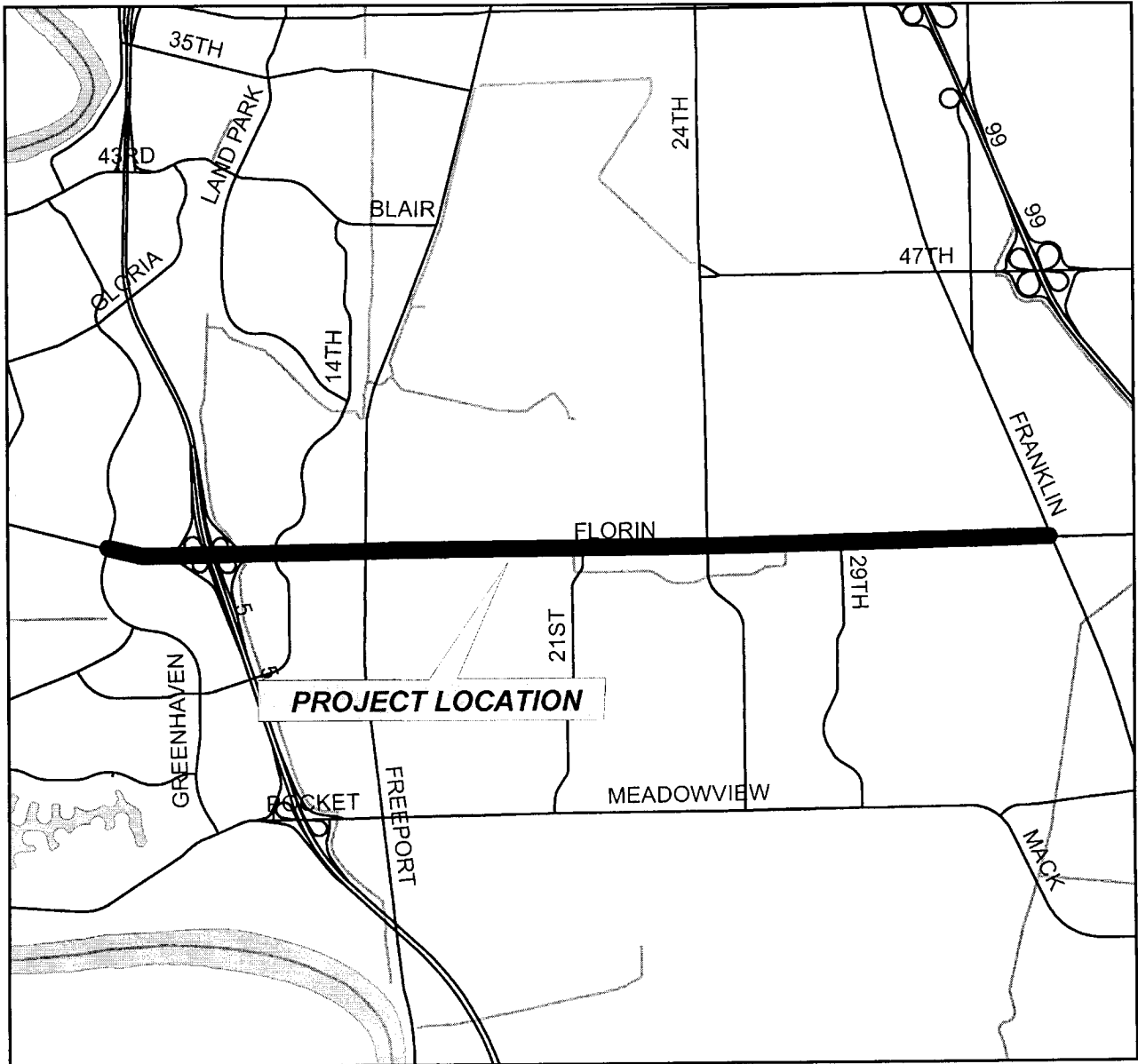

Map Contact: Hamid Khalessi
Date: February 11, 2008



LOCATION MAP FOR
POCKET ROAD/MEADOWVIEW ROAD/MACK ROAD
GREENHAVEN DRIVE TO STOCKTON BOULEVARD

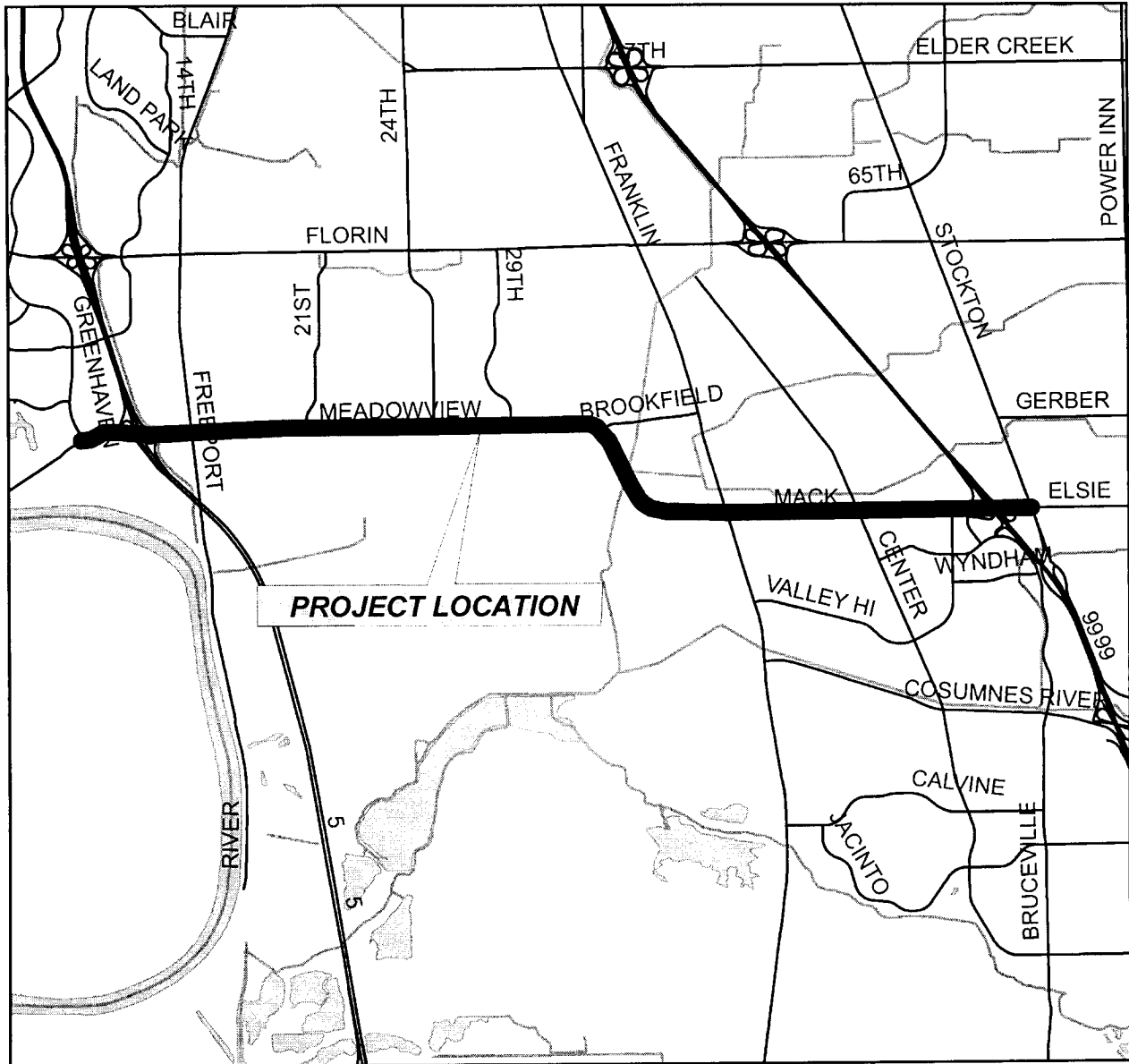

Map Contact: Hamid Khalessi
Date: February 11, 2008

