

CITY OF SACRAMENTO
1231 I Street, Sacramento, CA 95814

Permit No: 0104916
Insp Area: 4

Site Address: 4833 VERENA LN SAC
Parcel No: 225-1610-076 WESTBR 6 LOT 76

Sub-Type: NSFR
Housing (Y/N): N

CONTRACTOR
MORRISON HOMES
1130 IRON POINT RD STE 120
FOLSOM CA. 95630

OWNER
MORRISON HOMES
1130 IRON POINT RD #120
FOLSOM CA 95630

ARCHITECT

Nature of Work: NSFR MP1958 8 RMS

CONSTRUCTION LENDING AGENCY: I hereby affirm under penalty of perjury that there is a construction lending agency for the performance of the work for which this permit is issued (Sec. 3097, Civ. C.)

Lender's Name _____ Lender's Address _____

LICENSED CONTRACTORS DECLARATION: I hereby affirm under penalty of perjury that I am licensed under provisions of Chapter 9 (commencing with section 7000) of Division 3 of the Business and Professions Code and my license is in full force and effect.

License Class B License Number 519445 Date 4-25-01 Contractor Signature [Signature]

OWNER-BUILDER DECLARATION: I hereby affirm under penalty of perjury that I am exempt from the contractors License Law for the following reason (Sec. 7031.5, Business and Professions Code: any city or county which requires a permit to construct, alter, improve, demolish, or repair any structure, prior to its issuance, also requires the applicant for such permit to file a signed statement that he or she is licensed pursuant to the provisions of the Contractors License Law (Chapter 9 (commencing with Section 7000) of Division 8 of the Business and Professions Code) or that he or she is exempt therefrom and the basis for the alleged exemption. Any violation of Section 7031.5 by any applicant for a permit subjects the applicant to a civil penalty of not more than five hundred dollars (\$500.00).

____ I, as a owner of the property, or my employees with wages as their sole compensation, will do the work, and the structure is not intended or offered for sale (Sec. 7044, Business and Professional Code: The Contractors License Law does not apply to an owner of property who builds or improves thereon, and who does such work himself or herself or through his/her own employees, provided that such improvements are not intended or offered for sale. If, however, the building or improvement is sold within one year of completion, the owner-builder will have the burden of proving that he/she did not build or improve for the purpose of sale.)

____ I, as owner of the property, am exclusively contracting with licensed contractors to construct the project (Sec. 7044, Business and Professions Code: The Contractors License Law does not apply to an owner of property who builds or improves thereon, and who contracts for such projects with a contractor(s) licensed pursuant to the Contractors License Law.)

____ I am exempt under Sec. _____ B & PC for this reason: _____

Date _____ Owner Signature _____

IN ISSUING THIS BUILDING PERMIT, the applicant represents, and the city relies on the representation of the applicant, that the applicant verified all measurements and locations shown on the application or accompanying drawings and that the improvement to be constructed does not violate any law or private agreement relating to permissible or prohibited locations for such improvements. This building permit does not authorize any illegal location of any improvement or the violation of any private agreement relating to location of improvements.

I certify that I have read this application and state that all information is correct. I agree to comply with all city and county ordinances and state laws relating to building construction and hereby authorize representative(s) of this city to enter upon the above-mentioned property for inspection purposes.

Date 4-25-01 Applicant/Agent Signature [Signature]

WORKER'S COMPENSATION DECLARATION: I hereby affirm under penalty of perjury one of the following declarations:

____ I have and will maintain a certificate of consent to self-insure for workers' compensation as provided for by Section 3700 of the Labor Code, for the performance of work for which the permit is issued.

I have and will maintain workers' compensation insurance, as required by Section 3700 of the Labor Code, for the performance of the work for which this permit is issued. My workers' compensation insurance carrier and policy number are:

Carrier ZURICH-AMERICAN INS. CO Policy Number WC2090701-03 Exp Date 11/01/2001

____ (This section need not be completed if the permit is for \$100 or less) I certify that in the performance of the work for which this permit is issued, I shall not employ any person in any manner so as to become subject to the workers' compensation laws of California, and if I should become subject to the workers' compensation provisions of Section 3700 of the Labor Code, I shall forthwith comply with those provisions.

Date 4-25-01 Applicant Signature [Signature]

WARNING: FAILURE TO SECURE WORKER'S COMPENSATION COVERAGE IS UNLAWFUL AND SHALL SUBJECT AN EMPLOYER TO CRIMINAL PENALTIES AND CIVIL FINES UP TO ONE HUNDRED THOUSAND DOLLARS, PLUS THE COST OF COMPENSATION, DAMAGES AS PROVIDED FOR IN SECTION 3706 OF THE LABOR CODE AND ATTORNEY'S FEE.

THIS PERMIT SHALL EXPIRE BY LIMITATION IF WORK IS NOT COMMENCED WITHIN 180 DAYS.

PAID
CITY OF SACRAMENTO
APR 25 2001
NEIGHBORHOODS PLANNING
AND DEVELOPMENT SERVICES

01049160

RESIDENTIAL SUBDIVISION BUILDING PERMIT APPLICATION

Project Address: 4833 Verena Lane Assessor Parcel # 225-1610-076
Lot Number: 70 Subdivision Westborough Village 6

OWNER INFORMATION:

Legal Property Owner: Morrison Homes Phone# (916) 355-8900
Owner Address: 1130 Iron Point Rd #120 City Folsom State CA Zip 95630

CONTRACTOR INFORMATION:

Contractor: Morrison Homes Lic. # 519465 Phone # 355-8900 Fax 355-0100

PROJECT INFORMATION:

Land Use Zone R1A Occupancy Group R3 Construction Type VN Fed Code 1A
No. of Stories: 1 No. of Rooms: 8 Street Width: _____
1st Floor Area 1958 2nd Floor Area _____ Basement _____ Roof Material _____
AREA IN SQUARE FOOT OF:
Dwelling/Living 1958
Garage/Storage 637
Decks/Balconies 190
Carports _____
SCOPE OF WORK: New Single Family Dwelling

FOR OFFICE USE ONLY

- Information Above Complete
- Violation Files Checked
- Standard Setbacks
- County Sewer
- AR Flood Waiver Required
- Flood Elevation Certificate Required
- Water Development Infill Area
- Planning Approval
- Design Review Approval
- Special Fee Districts Apply:

- THE FOLLOWING MUST BE PROVIDED IN ORDER TO SUBMIT FOR PERMIT---
- 2 COMPLETE PLOT PLANS, LEGIBLE & DRAWN TO SCALE
 - 11 X 17 COPY OF FLOOR PLAN WITH FOLLOWING INFORMATION
 - a) Assessor's Parcel Number
 - b) New Floor Area
 - c) Owners Name
 - d) Project Address

\$134,055²¹



WesPac

insulation
a MASCO Company



809 North Market Blvd., Ste. 11 • Sacramento, CA 95834
(916) 927-7149 • Fax (916) 927-4257
Lic. #487478

Installed Insulation Certificate

We certify that the building insulation listed herein is installed in conformance
with current energy conservation regulations, California Administrative Code, Title 24, State of California

R FACTOR	AREA	TYPE	INCHES/BAGS (BLOWN)
R30	CEILING AREA	FIBERGLASS BLOW	12" / 38 BAGS
R30	CEILING AREA	FIBERGLASS BATT	10.25"
R13	EXT. WALL AREA	FIBERGLASS BATT	3.5"

4833 VERENA LN
SAC, CA 95835

Certified by

Sammy Jimenez

Title Secretary

BEL-LAGO @WESTLAKE

Address or Lot Number AGO776

Date Installed 09/07/01

Phase #

OMEGA PRODUCTS INTERNATIONAL, INC.

DIAMOND WALL INSULATING STUCCO SYSTEM

JOB ADDRESS:

LOT 76
4833 VERONA LN

ICBO Report #4004

SAC, CA. 95835

Date of Job Completion 12/10/01

PLASTERING CONTRACTOR:

Name: STUCCO (WORK) INC

Address: 5900 WAREHOUSE WAY SACRAMENTO CA

Telephone No: (916) 383 66 99

Contractor Number of Diamond Wall System 2175

This is to certify that the exterior coating system on the building exterior at the above address has been installed in accordance with the evaluation report specified above and the manufacturer's instructions.

Date

12/20/01

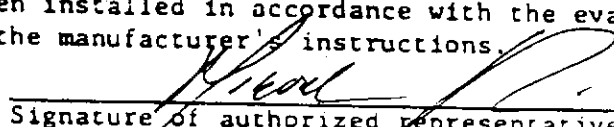
Signature of authorized representative of
Plastering Contractor

This installation card must be presented to the building inspector after completion of work and before final inspection.

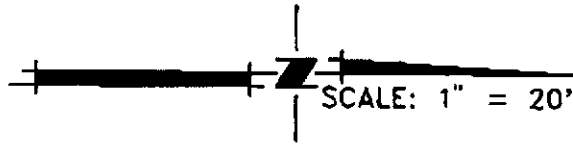

This set of plans and specifications must be kept on the job at all times and it is unlawful to make any changes or alterations from the same without written permission from the Building Inspection Division. The approval of this plan and specification SHALL NOT be held to permit or approve the violation of any City Ordinance or State Law.

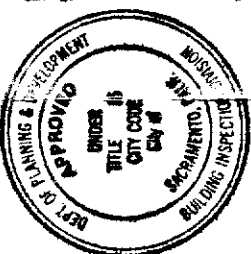

□ = STREET LIGHT
 □ = UTILITY BOX

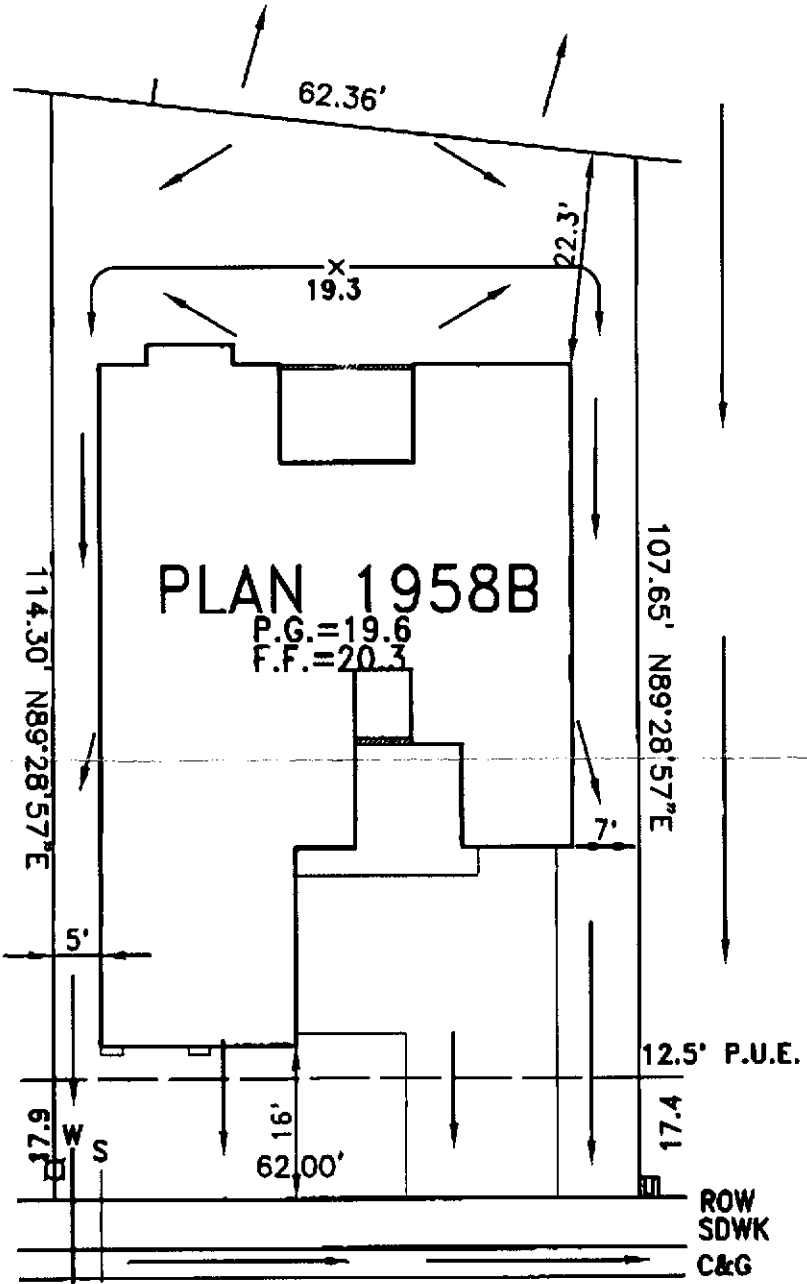

VERENA LANE

LOT COVERAGE 38.5%

UNAUTHORIZED CHANGES & USES: THE ENGINEER PREPARING THIS PLOT WILL NOT BE RESPONSIBLE FOR, OR LIABLE FOR, UNAUTHORIZED CHARGES TO OR USES OF THIS PLOT.
 ALL CHANGES TO THIS PLOT MUST BE IN WRITING AND MUST BE APPROVED BY THE ENGINEER.
 THE INFORMATION ON THIS PLOT PLAN IS PROVIDED FOR YOUR CONVENIENCE AS A GUIDE TO THE GENERAL LOCATION OF THE SUBJECT PROPERTY. THE OF THIS PLOT PLAN IS NOT GUARANTEED. NOR IS IT A PART OF ANY POLICY, REPORT, OR GUARANTEE TO WHICH IT MAY BE ATTACHED. ACTUAL DIMENSIONS MAY VARY OR CHANGE WITHOUT PRIOR NOTICE DUE TO ACTUAL SITE CONDITIONS.

CIVIL ENGINEERING SURVEYING
 MAPPING PLANNING
WOOD-RODGERS INC.
 3301 C STREET BLDG 100B SACRAMENTO, CA 95816
 TEL: 916/341-7760 FAX: 916/341-7767

WESTBOROUGH VILLAGE 6
 LOT 76
 PLAN 21838-R
 CITY OF SACRAMENTO, CALIFORNIA
 MAR. 2001 DRAWN: VM CHECKED: *R* 1122.028

J:\JOBS\WESTBOROUGH\MLL6\CIVIL\LOT PLANS\SPECIAL PERMIT EXHIBITS\LOT_76.DWG 03/15/01 18:29