

CITY OF SACRAMENTO
1231 I Street, Sacramento, CA 95814

Permit No: 0010253
Insp Area: 3

Site Address: 5601 WAREHOUSE WY SAC
Parcel No: 061-0210-019

Sub-Type: REM
Housing (Y/N): N

CONTRACTOR
GREINDAHL CONST
1721 EASTERN AV
SAC CA 95864

OWNER
ECHOSPHERE CORPORATION
90 INVERNESS CR EAST
ENGLEWOOD, CO 80112

ARCHITECT

Nature of Work: REMODEL FROM 1900 SQ FT OF OFFICE SPACE TO 9000 SQ FT OF OFFICE SPACE. AND REMODEL THE EXISTING OFFICE SPACE

CONSTRUCTION LENDING AGENCY: I hereby affirm under penalty of perjury that there is a construction lending agency for the performance of the work for which this permit is issued (Sec. 3097, Civ. C).

Lender's Name _____ Lender's Address _____

LICENSED CONTRACTORS DECLARATION: I hereby affirm under penalty of perjury that I am licensed under provisions of Chapter 9 (commencing with section 7000) of Division 3 of the Business and Professions Code and my license is in full force and effect.

License Class _____ License Number _____ Date _____ Contractor Signature _____

OWNER-BUILDER DECLARATION: I hereby affirm under penalty of perjury that I am exempt from the contractors License Law for the following reason (Sec. 7031.5, Business and Professions Code; any city or county which requires a permit to construct, alter, improve, demolish, or repair any structure, prior to its issuance, also requires the applicant for such permit to file a signed statement that he or she is licensed pursuant to the provisions of the Contractors License Law (Chapter 9 (commencing with Section 7000) of Division 8 of the Business and Professions Code) or that he or she is exempt therefrom and the basis for the alleged exemption. Any violation of Section 7031.5 by any applicant for a permit subjects the applicant to a civil penalty of not more than five hundred dollars (\$500.00).

_____, I, as a owner of the property, or my employees with wages as their sole compensation, will do the work, and the structure is not intended or offered for sale (Sec. 7044, Business and Professional Code: The Contractors License Law does not apply to an owner of property who builds or improves thereon, and who does such work himself or herself or through his/her own employees, provided that such improvements are not intended or offered for sale. If, however, the building or improvement is sold within one year of completion, the owner-builder will have the burden of proving that he/she did not build or improve for the purpose of sale.)

I, as owner of the property, am exclusively contracting with licensed contractors to construct the project (Sec. 7044, Business and Professions Code: The Contractors License Law does not apply to an owner of property who builds or improves thereon, and who contracts for such projects with a contractor(s) licensed pursuant to the Contractors License Law).

I am exempt under Sec. _____ B & PC for this reason: _____

Date 11-1-00 Owner Signature [Signature]

IN ISSUING THIS BUILDING PERMIT, the applicant represents, and the city relies on the representation of the applicant, that the applicant verified all measurements and locations shown on the application or accompanying drawings and that the improvement to be constructed does not violate any law or private agreement relating to permissible or prohibited locations for such improvements. This building permit does not authorize any illegal location of any improvement or the violation of any private agreement relating to location of improvements.

I certify that I have read this application and state that all information is correct. I agree to comply with all city and county ordinances and state laws relating to building construction and hereby authorize representative(s) of this city to enter upon the abovementioned property for inspection purposes.

Date 11-1-00 Applicant/Agent Signature [Signature]

WORKER'S COMPENSATION DECLARATION: I hereby affirm under penalty of perjury one of the following declarations:

_____, I have and will maintain a certificate of consent to self-insure for workers' compensation as provided for by Section 3700 of the Labor Code, for the performance of work for which the permit is issued.

_____, I have and will maintain workers' compensation insurance, as required by Section 3700 of the Labor Code, for the performance of the work for which this permit is issued. My workers' compensation insurance carrier and policy number are:

Carrier [Redacted] Policy Number [Redacted] Exp Date _____

(This section need not be completed if the permit is for \$100 or less) I certify that in the performance of the work for which this permit is issued, I shall not employ any person in any manner so as to become subject to the workers' compensation laws of California and agree that if I should become subject to the workers' compensation provisions of Section 3700 of the Labor Code, I shall forthwith comply with those provisions.

Date 11-1-00 Applicant Signature [Signature]

WARNING: FAILURE TO SECURE WORKER'S COMPENSATION COVERAGE IS UNLAWFUL AND SHALL SUBJECT AN EMPLOYER TO CRIMINAL PENALTIES AND CIVIL FINES UP TO ONE HUNDRED THOUSAND DOLLARS (\$100,000) IN ADDITION TO THE COST OF COMPENSATION. DAMAGES AS PROVIDED FOR IN SECTION 3706 OF THE LABOR CODE, INTEREST AND ATTORNEY'S FEE.

THIS PERMIT SHALL EXPIRE BY LIMITATION IF WORK IS NOT COMMENCED WITHIN 180 DAYS.

CITY OF SACRAMENTO

30 DAY **TEMPORARY**
Certificate of Occupancy

For Information Contact (916) 264-5716

Building Address: 5601 WAREHOUSE WY Permit No. 0010253

Building Use: OFFICE T.I. DBA: EHCOSTAR Occupancy: B,S

Building Owner: ECHOSPHERE CORP. Construction Type: _____

Owner Address: 90 INVERNESS CR EAST ENGLEWOOD Sprinkled? [] Yes [] No

Portion of Building Occupied: T.I. Area: 9000 Sq. Ft.

Specific purpose for temporary occupancy and/or conditions/limitations of temporary occupancy:

2/8/01 Willie Harris DENNIS RICHARDSON
Date By:Print Sign CITY BUILDING OFFICIAL

[TCO approvals: VF,BB,MJS,FJ]

BC 109.4 TEMPORARY CERTIFICATE

If the Chief Building Official finds that no substantial hazard will result from occupancy of any building or portion thereof before the same is completed, a temporary Certificate of Occupancy may be issued for the use of a portion or portions of a building or structure prior to the completion for the entire building or structure.

POST IN A CONSPICUOUS PLACE

January 11, 2001

Re: Echostar Communication
Phase II Tenant Improvement
5671 Warehouse Way
Sacramento, CA 95826

It is acceptable to use double 3 5/8"x20 ga. steel studs as compression strut in lieu of emt compression strut as shown on detail 5/D2. Attached are calculations indicating the maximum allowable height for double studs is 24'-0". The existing height is approximately 16'-0".

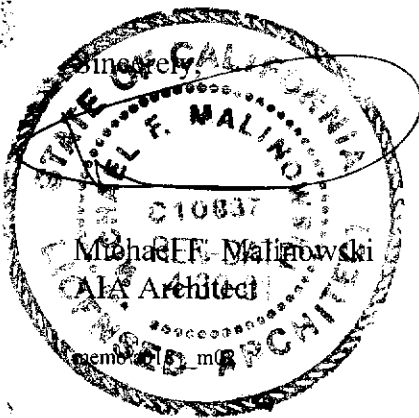

M. Malinowski AIA Architect

(916) 442-6955
fax 442-6649
architect@2xtreme.net
2420 K Street
Sacramento, CA 95816

MARR • SHAFER & ASSOCIATES
Consulting Structural Engineers

JOB _____ SHEET 1
CALCULATED BY JDA DATE 1/6

Compression Posts:

Based on Donn DX26 ceiling grid

Max F_{vert.} = F_{horiz.} = 234#

$\frac{KL}{r} \leq 200 \rightarrow L_{max.} = \frac{200r}{1.0}$

Option 1

1⁵/₈" x 20ga. SS Steel Studs A = .1535 in² r_y = .4634 in r_x = .6752 in
 L_{y max.} = 200(.4634)/1.0 = 92.6" → 7'-8"
 L_{x max.} = 200(.6752)/1.0 = 135" → 11'-3"
 f_a = 234#/.1535 in² = 1524 psi < 1.33 x 3730 = 4960 psi ✓ okay

Option 2

2¹/₂" x 20ga. SS Steel Studs A = .1837 in² r_y = .4577 in r_x = 1.0
 L_{y max.} = 91.5" → 7'-7"
 L_{x max.} = 198" → 16'-6"
 f_a = 1244 psi ✓ okay

Option 3

3¹/₂" x 20ga. SS Steel Studs A = .2182 in² r_y = .4435 in r_x = 1.3
 L_{y max.} = 88.7" → 7'-4"
 L_{x max.} = 273" → 22'-9"
 f_a = 1072 psi ✓ okay

Option 4

1⁵/₈" x 20ga. WC Steel Studs A = .1822 in² r_y = .5980 in r_x = .6
 L_{y max.} = 120" → 10'-0"
 L_{x max.} = 138" → 11'-6"
 f_a = 1284 psi ✓ okay

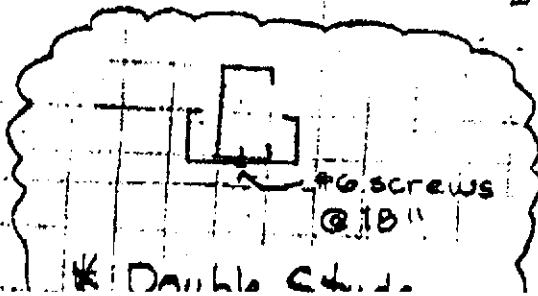

Maximum Height of Compression Post

Grabber Steel Studs	Single Stud	Double Studs
1 ⁵ / ₈ " x 20ga. SS	7'-8"	11'-3"
2 ¹ / ₂ " x 20ga. SS	7'-7"	16'-6"
3 ¹ / ₂ " x 20ga. SS	7'-4"	22'-9"
1 ⁵ / ₈ " x 20ga. WC	10'-0"	11'-6"

03/29/1994 17:19

FROM CALPELV SACRAMENTO

TO 4212253

P.02

Consulting Structural Engineers

CALCULATED BY JDA DATE 4-5-

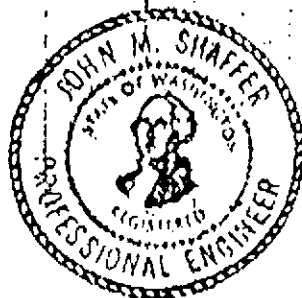

SET 17367
Exp. 2/3/50

John M. Shaffer

Ceiling Compression Posts using Steel Studs:

With $3\frac{5}{8}'' \times 20$ ga. steel studs
 $1\frac{5}{8}''$ wide with $\frac{3}{8}''$ return lips

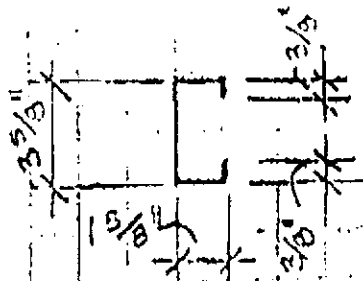

Min. $r_x = 1.45$ in.

Min. $r_y = .588$ in.

based on $\frac{KL}{r} < 200$

Single Stud \therefore use $r_y = .588$ in.

$L_{max} = \frac{200 r}{K} = \frac{200 (.588)}{1.0} = 117'' = 9'-9''$ max. h

Double Stud \therefore use $r_x = 1.45$ in.

$L_{max} = \frac{200 (1.45)}{1.0} = 290'' = 24'-2''$ max. height for Tee configuration

#6 screws @ 16"

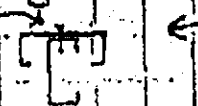

Date 2/4/01
Page 1 of 3

Project Name Grundahl Echostar

AIR MOVING EQUIPMENT TEST SHEET

SYSTEM	#1	#2
Equipment Location	Roof	ROOF
Area Served	West Front	West Rear
Equipment Manufacturer	RUUD	RUUD
Model	RKKA-A072CL13E	RKKA-A036CK08E
Serial Number	2A5304ADAAE059911694	2A5620ADAAE339815634

	Specified	Actual	Specified	Actual
Total CFM - Fan	/	/	/	/
Total CFM - Outlet				
R/A CFM				
O/A CFM				
Total Static Pressure (Total/External)				
Inlet Pressure				
Discharge Pressure				
Fan RPM				

	Specified	Actual	Specified	Actual
Motor Manufacturer	GE	GE	GE	GE
Motor HP/ BHP	1.5	1.5	1/2	1/2
Phase	3	3	1	1
Voltage	208-230	208	208-230	208
Amperage	5.8	5.3	2.7	2.5
Motor RPM	1725	1725	1075	1075
Motor Service Factor	1.15		1	
Starter Heater Elements	NA			

Motor Sheave & No. Grooves	NA	NA
Fan Sheave & No. Grooves	NA	NA
Belts	AP40	NA

Remarks _____

SECTION V—PROCEDURES

Date 2/4/01

Page 2 of 3

Project Name Grendahl Echostar

AIR MOVING EQUIPMENT TEST SHEET

SYSTEM	#3	#5
Equipment Location	Roof	Roof
Area Served	Lunch + Conf	Roof Front
Equipment Manufacturer	RUUD	RUUD
Model	RKKA-A060CK10X	RKKA-A036CK08E
Serial Number	2A5643ADAAAF310020475	2A5620ADAAAF28991974

	Specified	Actual	Specified	Actual
Total CFM - Fan	GE	GE	GE	GE
Total CFM - Outlet				
R/A CFM				
O/A CFM				
Total Static Pressure (Total/External)				
Inlet Pressure				
Discharge Pressure				
Fan RPM				

	Specified	Actual	Specified	Actual
Motor Manufacturer	GE	GE	GE	GE
Motor HP/ BHP	3/4	3/4	1/2	1/2
Phase	1	1	1	1
Voltage	208-230	208	208-230	209
Amperage	5.4	5.4	3	3
Motor RPM	1075	1075	1075	1075
Motor Service Factor	1		1	
Starter Heater Elements				

Motor Sheave & No. Grooves	NA	NA
Fan Sheave & No. Grooves	NA	NA
Belts		

Remarks _____

SECTION V—PROCEDURES

Date 2/4/01
 Page 3 of 3

Project Name Grendahl EchoStar

AIR MOVING EQUIPMENT TEST SHEET

SYSTEM	<u>4</u>	
Equipment Location	<u>Roof</u>	
Area Served	<u>East</u>	
Equipment Manufacturer	<u>RUUP</u>	
Model	<u>RKKA-036CK08E</u>	
Serial Number	<u>2A562DADAAAF219934426</u>	

	Specified	Actual	Specified	Actual
Total CFM - Fan				
Total CFM - Outlet				
R/A CFM				
O/A CFM				
Total Static Pressure (Total/External)				
Inlet Pressure				
Discharge Pressure				
Fan RPM				

	Specified	Actual	Specified	Actual
Motor Manufacturer	<u>GE</u>	<u>GE</u>		
Motor HP/ BHP	<u>1/2</u>	<u>1/2</u>		
Phase	<u>1</u>	<u>1</u>		
Voltage	<u>208-230</u>	<u>209</u>		
Amperage	<u>3</u>	<u>2.9</u>		
Motor RPM	<u>1075</u>	<u>1075</u>		
Motor Service Factor	<u>1</u>			
Starter Heater Elements				

Motor Sheave & No. Grooves	<u>N/A</u>	<u>N/A</u>
Fan Sheave & No. Grooves	<u>N/A</u>	<u>N/A</u>
Belts	<u>N/A</u>	<u>N/A</u>

Remarks _____

Date 2/4/01
 Page 1 of 5

Project Grendahl Echostar
 System #1 Floor # 1

AIR DISTRIBUTION TEST SHEET

Terminal Number	Room Number	Terminal		Factor	Design		Test—FPM or CFM			Final	
		Type	Size		FPM	CFM	Test 1	Test 2	Test 3	FPM	CFM
2			12		480	500	485				
1			10		320	330	320				
3			12		480	470	480				
4			12		480	440	475				
5			8		160	200	165				
6			8		160	170	160				
7			8		160	150	160				
8			8		160	140	155				
Return air total							Total	2400			
Out side air								2160			
								240	10%		

Remarks _____

Date 2/4/01

Page 3 of 5

Project Echostar

System #3

Floor # _____

AIR DISTRIBUTION TEST SHEET

Terminal Number	Room Number	Terminal		Factor	Design		Test—FPM or CFM			Final		
		Type	Size		FPM	CFM	Test 1	Test 2	Test 3	FPM	CFM	
11			8		160	160	160	160				
12			8		160	130	160	160				
13			10		390	400	390	390				
14			10		320	310	320	320				
15			8		225	230	225	225				
16			8		225	250	225	225				
17			8		200	200	200	200				
							Total		1680			
Return OSA			all	Runs total							1500	
											180 = 10%	

Remarks _____

MEMORANDUM

SACRAMENTO FIRE DEPARTMENT

TO: BUILDING DEPARTMENT

DATE: 2-6-01

FROM: Troy Malaspino
Fire Marshal

SUBJECT: FIRE SYSTEM INSPECTION

A final inspection of the newly installed fire system at:

5601 Warehouse Way

Has been conducted by Inspector

F. Johnson

On

2-6-01

00-10253-200
Permit Number

9,000
Square Footage

T.I + OH SPR EXT
Type of Inspection

They system is acceptable by this department.

R. Woodman
By: Ross L. Woodman,
Fire Prevention Officer II

00-403
F.D. Reference Number