

CITY OF SACRAMENTO

Permit No: 9808918

1231 I Street, Sacramento, CA 95814

Insp Area: 1

Site Address: 2215 27TH ST SAC

Sub-Type: RES

Parcel No: 0100187001

Housing (Y/N): N

CONTRACTOR

P&P BUILDING WRECKING INC
8589 FLORIN RD
SACRAMENTO CA 95828

OWNER

GOTTLIEB MILTON/PAT
2826 PROSPECT PARK #300
RANCHO CORDOVA CA 95670

ARCHITECT

Nature of Work: DEMO ENTIRE STRUCTURE(S)

CONSTRUCTION LENDING AGENCY : I hereby affirm under penalty of perjury that there is a construction lending agency for the performance of the work for which this permit is issued (Sec. 3097, Civ. C).

Lender's Name _____ Lender's Address _____

LICENSED CONTRACTORS DECLARATION: I hereby affirm under penalty of perjury that I am licensed under provisions of Chapter 9 (commencing with section 7000) of Division 3 of the Business and Professions Code and my license is in full force and effect.

License Class C-21 License Number 271587 Date 9-11-98 Contractor Signature Matthew C. P...

OWNER-BUILDER DECLARATION: I hereby affirm under penalty of perjury that I am exempt from the contractors License Law for the following reason (Sec. 7031.5, Business and Professions Code; any city or county which requires a permit to construct, alter, improve, demolish, or repair any structure, prior to its issuance, also requires the applicant for such permit to file a signed statement that he or she is licensed pursuant to the provisions of the Contractors License Law (Chapter 9 (commencing with Section 7000) of Division 8 of the Business and Professions Code) or that he or she is exempt therefrom and the basis for the alleged exemption. Any violation of Section 7031.5 by any applicant for a permit subjects the applicant to a civil penalty of not more than five hundred dollars (\$500.00);

_____, I, as a owner of the property, or my employees with wages as their sole compensation, will do the work, and the structure is not intended or offered for sale (Sec. 7044, Business and Professional Code: The Contractors License Law does not apply to an owner of property who builds or improves thereon, and who does such work himself or herself or through his/her own employees, provided that such improvements are not intended or offered for sale. If, however, the building or improvement is sold within one year of completion, the owner-builder will have the burden of proving that he/she did not build or improve for the purpose of sale.)

_____, I, as owner of the property, am exclusively contracting with licensed contractors to construct the project (Sec. 7044, Business and Professions Code: The Contractors License Law does not apply to an owner of property who builds or improves thereon, and who contracts for such projects with a contractor(s) licensed pursuant to the Contractors License Law).

_____ I am exempt under Sec. _____ B & PC for this reason: _____

Date _____ Owner Signature _____

IN ISSUING THIS BUILDING PERMIT, the applicant represents, and the city relies on the representation of the applicant, that the applicant verified all measurements and locations shown on the application or accompanying drawings and that the improvement to be constructed does not violate any law or private agreement relating to permissible or prohibited locations for such improvements. This building permit does not authorize any illegal location of any improvement or the violation of any private agreement relating to location of improvements.

I certify that I have read this application and state that all information is correct. I agree to comply with all city and county ordinances and state laws relating to building construction and hereby authorize representative(s) of this city to enter upon the abovementioned property for inspection purposes.

Date 9-11-98 Applicant/Agent Signature Matthew C. P...

WORKER'S COMPENSATION DECLARATION: I hereby affirm under penalty of perjury one of the following declarations:

_____ I have and will maintain a certificate of consent to self-insure for workers' compensation as provided for by Section 3700 of the Labor Code, for the performance of work for which the permit is issued.

I have and will maintain workers' compensation insurance, as required by Section 3700 of the Labor Code, for the performance of the work for which this permit is issued. My workers' compensation insurance carrier and policy number are:

Carrier State Fund Policy Number 1-99 229-98 U 0018244

_____, (This section need not be completed if the permit is for \$100 or less) I certify that in the performance of the work for which this permit is issued, I shall not employ any person in any manner so as to become subject to the workers' compensation laws of California and agree that if I should become subject to the workers' compensation provisions of Section 3700 of the Labor Code, I shall forthwith comply with those provisions.

Date 9-11-98 Applicant Signature Matthew C. P...

WARNING: FAILURE TO SECURE WORKER'S COMPENSATION COVERAGE IS UNLAWFUL AND SHALL SUBJECT AN EMPLOYER TO CRIMINAL PENALTIES AND CIVIL FINES UP TO ONE HUNDRED THOUSAND DOLLARS (\$100,000) IN ADDITION TO THE COST OF COMPENSATION, DAMAGES AS PROVIDED FOR IN SECTION 3706 OF THE LABOR CODE, INTEREST AND ATTORNEY'S FEE.

THIS PERMIT SHALL EXPIRE BY LIMITATION IF WORK IS NOT COMMENCED WITHIN 180 DAYS.

DEVELOPMENT SERVICES
DIVISION

APPLICATION FOR
WRECKING PERMIT

916-264-7619
FAX 916-264-7046

LOCATION

ADDRESS: 2215 27th St
LOT: 0100187001 TRACT: _____
LOT DEPTH: _____ LOT WIDTH: _____ CORNER LOT: _____ INTERIOR LOT X
OWNER: Sottlieb Milton/Pat
ADDRESS: 2826 Prospect Park Dr

BUILDING DATA

LENGTH: 30 WIDTH 50 FIRST FLOOR AREA 1500 (SQ.FT.) NO. STORIES 1
USE OF BUILDING: dwelling CONSTRUCTION TYPE _____ HEIGHT _____
OF UNITS _____ REAR YARD _____ SIDE YARD _____ SET BACK _____
CITY SEWER X WATER X SEPTIC _____ WELL _____

CONTRACTOR

NAME: P+P Building Wrecking STATE LICENSE NO. 271787
ADDRESS: 4589 Florin Rd
PHONE: 916-383-6198 FAX: 916-383-8206
LIABILITY INSURANCE P.L. _____ P.D. _____ POLICY ON FILE _____

CODE REQUIREMENTS

NOTIFICATION OF ADJACENT PROPERTY OWNERS _____ DATE: _____
COPY OF NOTIFICATION ON FILE: _____ USE OF PROPERTY REQUIRED: _____
PEDESTRIAN PROTECTION REQUIRED: no REQUIREMENTS ATTACHED _____
BASEMENTS OR OTHER EXCAVATIONS ON LOT: X TO BE FILLED X FENCED _____

PREPARE PLOT PLAN SHOWING LOCATION OF BUILDING ON LOT AND TYPE AND LOCATION OF BUILDING BARRICADE.

SPECIAL CONDITIONS:

I have read the above application and know the contents thereof; the same is true and correct. I further state that I am familiar with the laws governing the demolition of buildings within the City of Sacramento and the State of California and that the above structure will be razed in conformity therewith. I further state that I understand that this permit may be revoked for any violation of the provisions of the Code of the City of Sacramento pertaining to or affected by the demolition procedure to be used on the above building.

No. W _____
DATE: _____
FEE: _____

APPLICANT: Matthew C. Pini
TITLE: Vice President
(APPLICANT/OWNER)

PERMIT EXPIRES
_____/_____/_____
MONTH DAY YEAR

✓ THIS IS A REVOCABLE PERMIT

ADDRESS: 2215 27th St

OWNER: _____

Approval by the following City Departments must be obtained prior to the issuance of a wrecking permit by the Building Inspections Division. Design Review approval required on all wrecking permits in Central City/Alhambra Blvd. corridor prior to sewer disconnect permit being issued.

DESIGN REVIEW 1231 I Street, Room 200 264-5604	<i>Design Review approval will require "Design Review" M.M. 9-3-98</i>
PLUMBING DIVISION 1231 I Street, Room 200 264-5716 (or) Housing 264-5404	
WATER DEPARTMENT 1391 35th Avenue 264-5371	
FIRE DEPARTMENT 1231 I Street, Room 401 264-5416	<i>[Signature]</i>
TRAFFIC ENGINEER 1000 I Street 264-5307	
ARBORIST/TREE SERVICE (Downtown and Commercial Buildings) 5730 24th Street 433-6345	<i>9-10-98. Dunder Hill No Dan Skowalski per cost estimate provided</i>

JACK CRIST Director *[Signature]*

DEPARTMENT OF
PLANNING AND DEVELOPMENT

CITY OF SACRAMENTO
CALIFORNIA

1231 I STREET
ROOM 200
SACRAMENTO, CA
95814-2998

BUILDING INSPECTIONS
916-264-5716
Permit Services
916-264-7619
FAX 916-264-7046

WRECKING PERMIT # _____

DEMOLITION PERMIT NOTIFICATION

A Demolition Permit for a 1 story building at:

2215 27th
(Address)

Parcel number: 0100187001

has been issued on 9-10-98
(date)

The structure is scheduled for demolition within 30 days.

Please update your service and billing records accordingly.

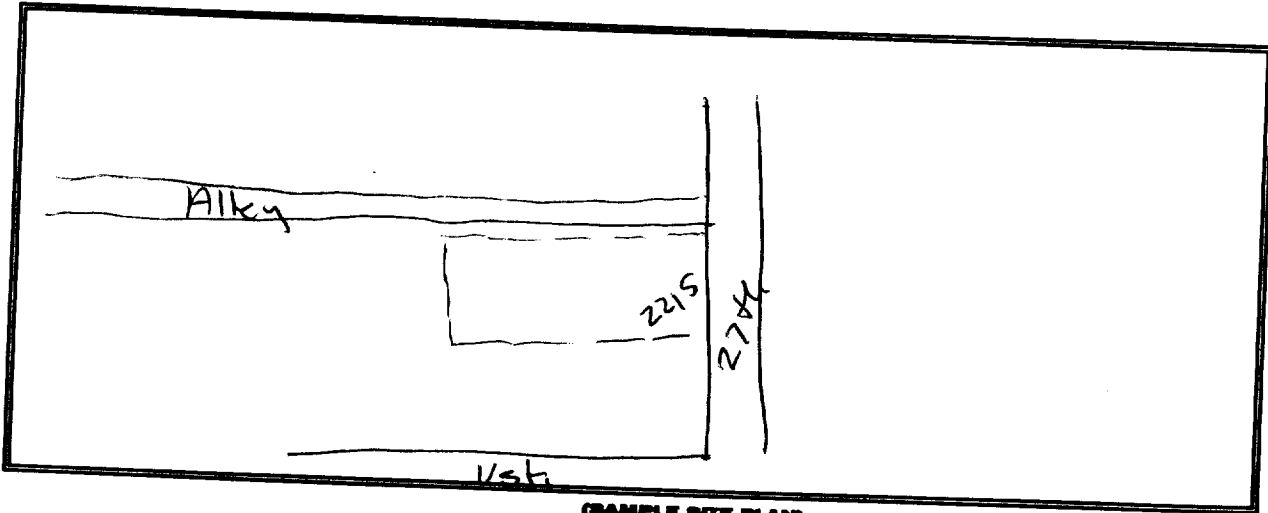

- cc: P.G. & E (Terry Clark)
- SMUD
- SOLID WASTE (3141)
- UTILITIES (3350)
- UTIL. BILLING (1125)
- FIRE DEPT. (2510)

INITIAL: _____ DATE: _____