

OFFICE COPY THIS IS A 2 PART FORM WRITE ON A FIRM SURFACE

CONSTRUCTION LENDING AGENCY

I hereby affirm under penalty of perjury that there is a construction lending agency for the performance of the work for which this permit is issued (Sec. 3097, Civ.C).

Lenders Name _____
Lenders Address _____

LICENSED CONTRACTORS DECLARATION

I hereby affirm under penalty of perjury that I am licensed under provisions of Chapter 9 (commencing with Section 7000) of Division 3 of the Business and Professions Code and my license is in full force and effect.

License Class C-10 Lic. Number 303019
Date 12/4/01 Contractor Carl Cook
(Signature)

OWNER - BUILDER DECLARATION

I hereby affirm under penalty of perjury that I am exempt from the Contractors License Law for the following reason (Sec. 7031.5, Business and Professions Code: Any city or county which requires a permit to construct, alter, improve, demolish, or repair any structure, prior to its issuance, also requires the applicant for such permit to file a signed statement that he or she is licensed pursuant to the provisions of the Contractors License Law (Chapter 9 (commencing with Section 7000) of Division 8 of the Business and Professions Code) or that he or she is exempt therefrom and the basis for the alleged exemption. Any violation of Section 7031.5 by any applicant for a permit subjects the applicant to a civil penalty of not more than five hundred dollars (\$500.00):

- I, as owner of the property, or my employees with wages as their sole compensation, will do the work, and the structure is not intended or offered for sale (Sec. 7044, Business and Professions Code: The Contractors License Law does not apply to an owner of property who builds or improves thereon, and who does such work himself or herself or through his or her own employees, provided that such improvements are not intended or offered for sale. If, however, the building or improvement is sold within one year of completion, the owner-builder will have the burden of proving that he or she did not build or improve for the purpose of sale.)
- I, as owner of the property, am exclusively contracting with licensed contractors to construct the project (Sec. 7044, Business and Professions Code: The Contractors License Law does not apply to an owner of property who builds or improves thereon, and who contracts for such projects with a contractor(s) licensed pursuant to the Contractors License Law).
- I am exempt under Sec. _____ B & P C for this reason _____

Date _____ Owner _____
(Signature)

In issuing this building permit, the applicant represents, and the City relies on the representation of the applicant, that the applicant verified all measurements and locations shown on the application or accompanying drawings and that the improvement to be constructed does not violate any law or private agreement relating to permissible or prohibited locations for such improvements. This building permit does not authorize any illegal location of any improvement or the violation of any private agreement relating to location of improvements.

I certify that I have read this application and state that all information is correct. I agree to comply with all city and county ordinances and state laws relating to building construction and hereby authorize representative of this City to enter upon the abovementioned property for inspection purposes.

Date 12/4/01 Signature of Applicant or Agent Carl Cook

USE BLACK INK BALL POINT PEN - PRESS FIRMLY SIGN PERMIT APPLICATION

SITE ADDRESS: 725 E1 Camino Ave. SUITE cc INSP. AREA 4

ASSESSOR PARCEL NO. 263-0252-017 PERMIT NO. 0201370

NAME OF APPLICANT: Pacific Neon ADDRESS: P.O. Box 15100 Sac Ca ZIP CODE: 95851 PHONE NO.: 927 0527

BUSINESS OWNER: N. Sac Funeral Home

SIGN INFORMATION

ATTACHED INTERIOR / ELECT. SINGLE FACED

ILLUMINATED NON-ILLUMINATED BILLBOARD / SUBDIVISION

INDIVIDUAL LETTERS PAINTED ON BUILDING LOGO

METAL POLE DOUBLE FACED

PLASTIC MONUMENT VINYL/AGATOR FOAM

WOODEN PROJECTING RE-FACE

SIGN COPY: North Sacramento Funeral Home

5-21978

CITY OF SACRAMENTO PERMIT SERVICES
BUILDING INSPECTION DIVISION 264-7619

WORKER'S COMPENSATION DECLARATION

I hereby affirm under penalty of perjury one of the following declarations:

- I have and will maintain a certificate of consent to self-insure for workers' compensation as provided for by Section 3700 of the Labor Code, for the performance of work for which the permit is issued.
- I have and will maintain workers' compensation insurance, as required by Section 3700 of the Labor Code, for the performance of the work for which this permit is issued. My workers' compensation insurance carrier and policy number are:
Carrier: State Fund
Policy Number: 478-02

Date: 12/4/01 Applicant: Carl Cook
(Signature)

WARNING: FAILURE TO SECURE WORKERS' COMPENSATION COVERAGE IS UNLAWFUL AND SHALL SUBJECT AN EMPLOYER TO CRIMINAL PENALTIES AND CIVIL FINES UP TO ONE HUNDRED THOUSAND DOLLARS (\$100,000), IN ADDITION TO THE COST OF COMPENSATION, DAMAGES AS PROVIDED FOR IN SECTION 3706 OF THE LABOR CODE, INTEREST AND ATTORNEY'S FEES.

SIGN INFORMATION

(A) HEIGHT: 8 (B) LENGTH: 9

(A X B) SIGN AREA: 72 32 sq

POLE SIZE: _____ FOOTING SIZE: _____

STREET FRONTAGE (FT): _____

OCCUPANCY FRONTAGE (FT): _____

OFFICE USE ONLY

ENGINEERING REQUIRED? YES NO APPROVED BY: _____

DESIGN REVIEW REQUIRED? YES NO APPROVED BY: KS

SPECIAL PERMIT REQUIRED? YES NO # _____

VARIANCE REQUIRED? YES NO # _____

LOCATED IN PUD? YES NO WHICH PUD? _____

SIGN VALUATION

A. TYPE OF SIGN: D/E Pole Sign

B. \$ _____ PER SQ. FT. X _____ SQ. FT. = \$ _____

APPROVED BY: Mante D DATE: 3-6-02

DENIED BY: _____ DATE: _____

FINANCIAL INSPECTIONS

BUILDING INSPECTOR: PAID DATE: 8-26-01

ELECTRICAL INSPECTOR: PAID DATE: 4-26-05

SIGN INSPECTOR: _____ DATE: _____

RECEIVED AMOUNT

DATE: MAR 07 2002

AMOUNT: 17500

SIGN PERMIT FEE: _____

ELECTRICAL SIGN FEE: _____

CITY BUSINESS LICENSE: _____

OTHER: _____

TOTAL \$ _____

THIS PERMIT SHALL EXPIRE BY LIMITATION IF WORK AUTHORIZED IS NOT COMMENCED WITHIN 180 DAYS.

Client
North Sacramento
Funeral Home
 725 El Camino Ave.
 Sacramento, CA
 Client Approval

Environmental Graphic Design,
 Planning and Fabrication

PacificNeonCompany

1576 Silica Avenue
 Sacramento, California 95815
 Telephone 916.927.0527
 Facsimile 916.927.2414
 E-Mail pacificneon@yahoo.com

ALL RIGHTS RESERVED. COPYRIGHT © 2001
 ILLUSTRATIONS ARE CONCEPTS ONLY. ACTUAL COLORS
 AND MATERIALS MAY VARY FROM THOSE SHOWN

Account Executive
Franz Deutsch

Project Number
01-6371

Date	Document
2 Oct 01	Preliminary
13 Nov 01	Revision
2 Dec 01	Revision
25 Jan 02	Revision
6 Feb 02	Revision

Production Approval

FILE COPY

Drawing

2

WD

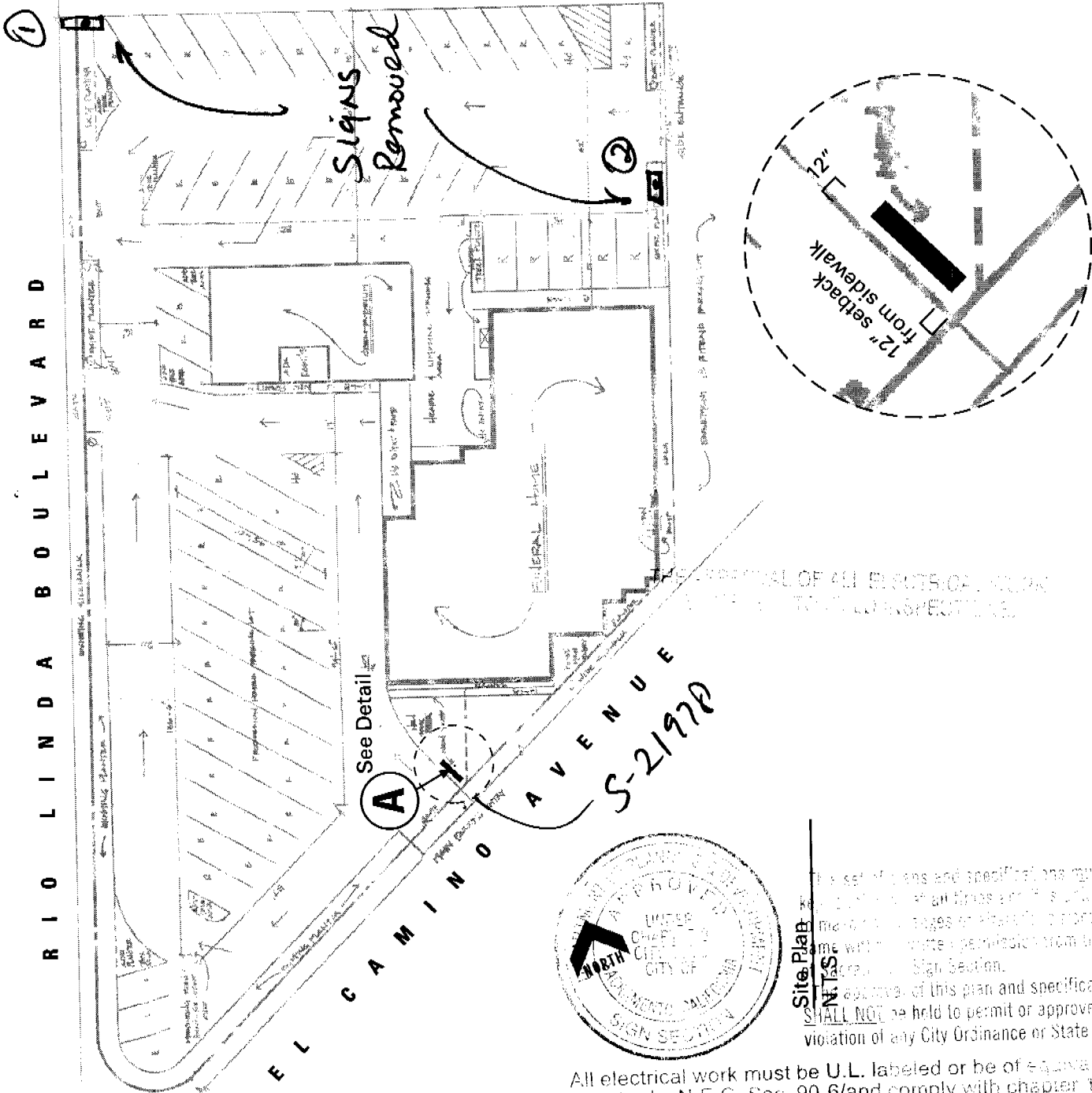

FOOTING INSPECTION REQUIRED

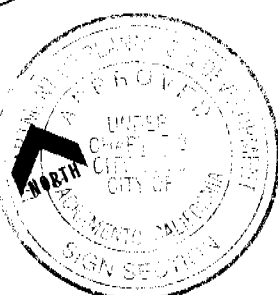

Site Plan
 This set of plans and specifications must be approved by the City of Sacramento, California. The City Engineer or his/her designee shall not be held responsible for the design or construction of the sign. The City Engineer or his/her designee shall not be held responsible for the design or construction of the sign. The City Engineer or his/her designee shall not be held responsible for the design or construction of the sign.

All electrical work must be U.L. labeled or be of equivalent standards, N.E.C. Sec. 90-6/and comply with chapter 14, Div. 2 of Sacramento City Code.

EQUIPMENT MUST BE USED AS DESIGN INTENDED
ALL SIGN INSTALLATIONS ARE SUBJECT TO FIELD INSPECTIONS

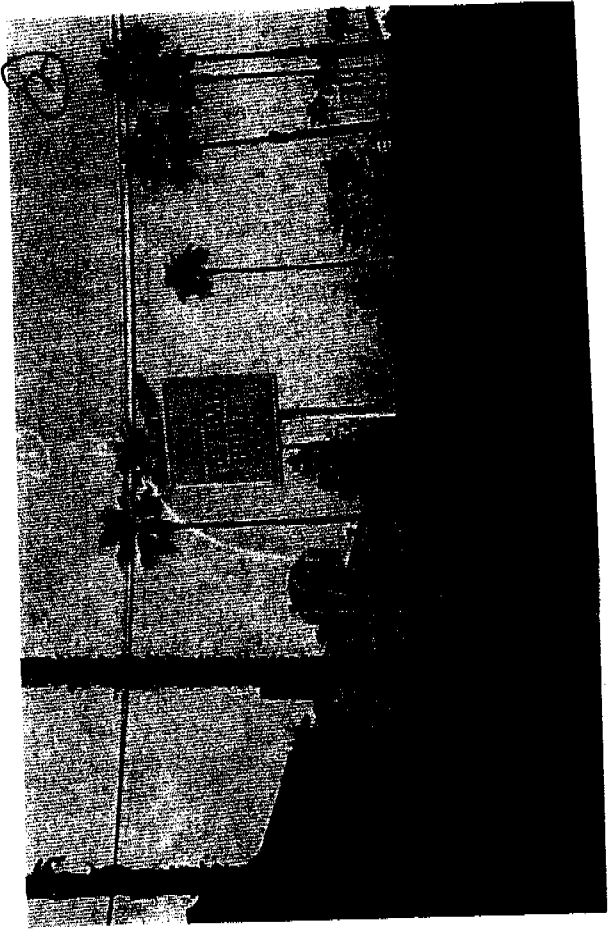
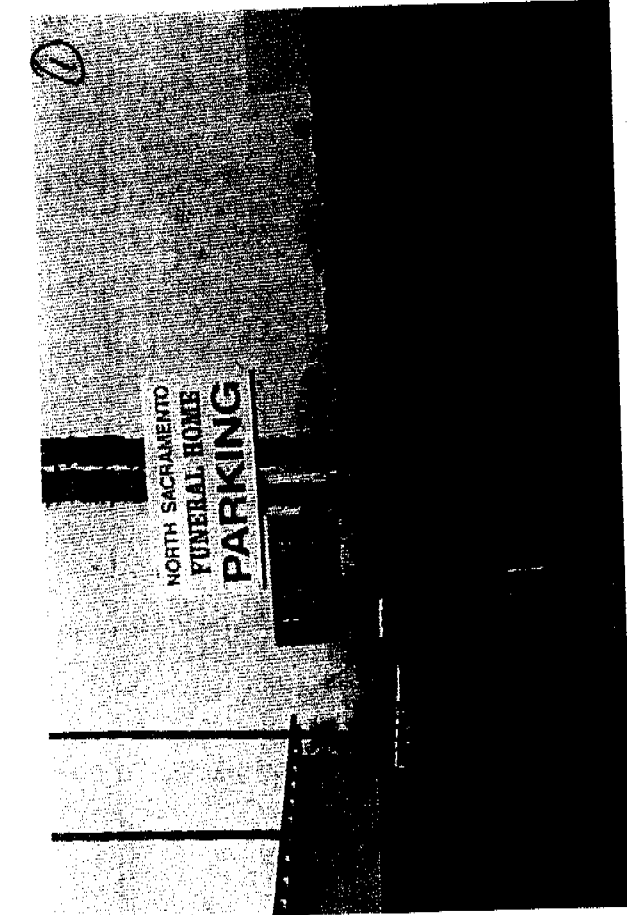

Bldg Inspected : DO NOT FINAL Pylon Sign until these signs
 have been removed. Pole condition satisfactory
 By Luis Sanchez of Design Review.
 : Cabinet & Pole must be removed - Mark A.L.
 3.6.02

Client

North Sacramento
Funeral Home
725 El Camino Ave.
Sacramento, CA

Client Approval

Environmental Graphic Design,
Planning and Fabrication

PacificNeonCompany

1576 Silica Avenue
Sacramento, California 95815
Telephone 916.927.0527
Facsimile 916.927.2414
E-Mail pacificneon@yahoo.com

ALL RIGHTS RESERVED. COPYRIGHT © 2001
ILLUSTRATIONS: DESICP CONCEPTS ONLY. ACTUAL COLORS
AND MATERIALS MAY VARY FROM THOSE SHOWN

Account Executive

Franz Deutsch

Project Number

01-6371

Date Document

2 Oct 01 Preliminary

13 Nov 01 Revision

25 Jan 02 Revision

30 Jan 02 Revision

Production Approval

Drawing

1

WD

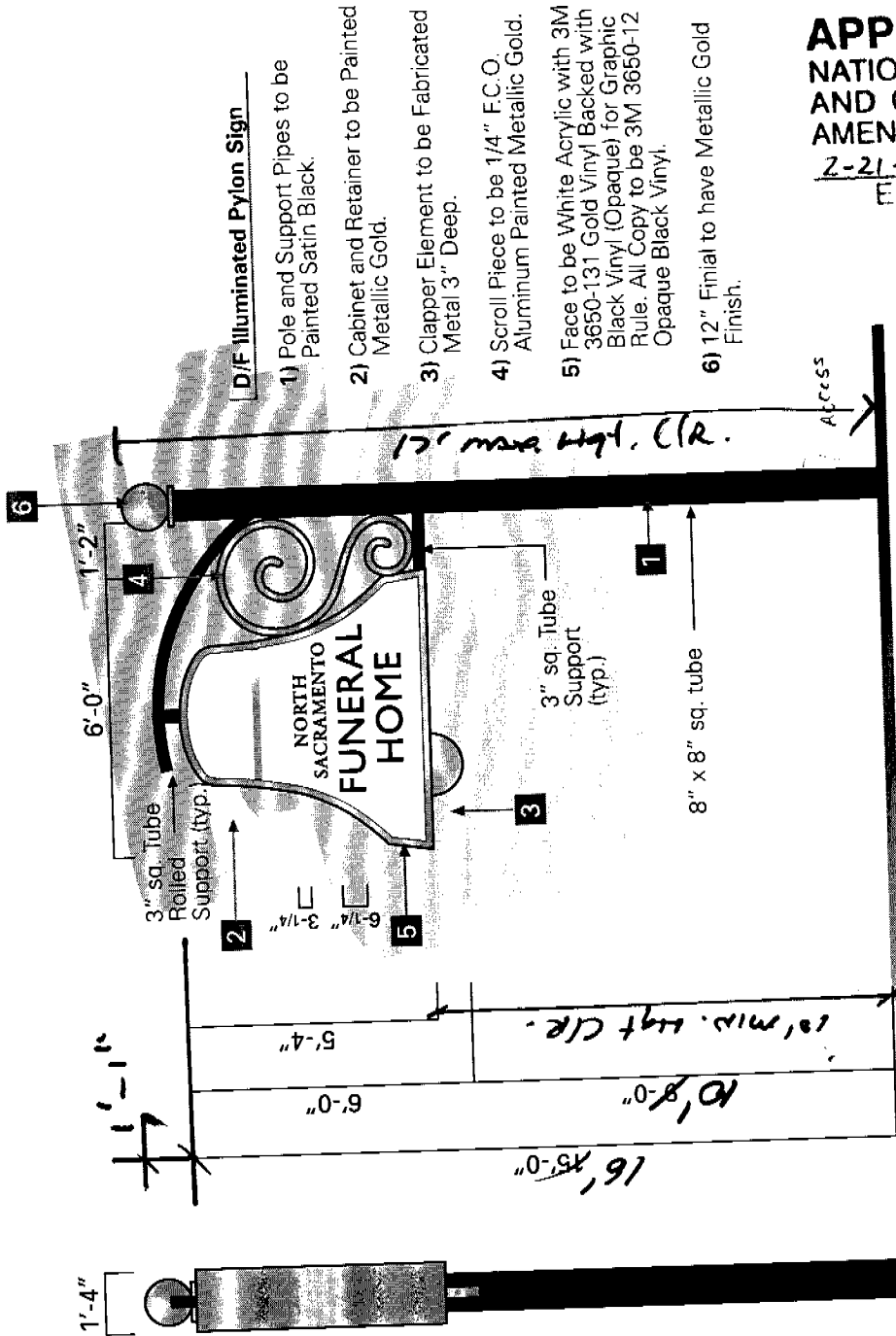

APPROVED PER 1996
NATIONAL ELECTRICAL CODE
AND CITY OF SACRAMENTO
AMENDMENTS
2-21-02 X/LH
ELECTRICAL DIVISION

A D/F Illuminated Blade Mounted Pylon Sign

Scale 1/4" = 1' - 0"

A

End View

Scale 1/4" = 1' - 0"

A

FOOTING INSPECTION REQUIRED

THE APPROVAL OF ALL ELECTRICAL WORK
IS SUBJECT TO FIELD INSPECTIONS.

N. SACRAMENTO FUNERAL HOME

BY R.W.M. DATE 3/02
 CHKD. BY DATE

SUBJECT POLE SIGN
 725 EL CAMINO AVE
 SACRAMENTO, CALIF.

SHEET NO. 1 OF 2
 JOB NO. 02-119
 PACIFIC NEON
 P.O. 8-9115

DESIGN CRITERIA

- CODE - 98 C.B.C. & SAC. CITY
- WIND - 75 M.P.H., EXP. 'B' (20 P.S.F. MIN.)
- SEISMIC - ZONE 3

WIND GOVERNS DESIGN

$P = C_e C_g q_s I = (.62)(1.4)(14.4) = 12.5 \text{ P.S.F.}$

USE 20 P.S.F. MIN.

(A) $(7.0 \times 5.0) 20 = 700 \times 13.16 = 9212 \text{ \#}$
 (B) $(\frac{8}{12} \times 17) 20 = \frac{227}{927} \times 8.5 = \frac{1930}{11,142} \text{ \#}$

$W \approx 200 \text{ \#}$

$M_{DL} \approx (200 \text{ \#}) 3.5' = 700 \text{ \#ft}$

$M_{TOR} \approx (700) 3.5' = 2450 \text{ \#ft}$

$M_c = \sqrt{M_w^2 + M_{DL}^2} = \text{COMBINED MOMENT}$
 $= \sqrt{(11142^2 + 2450^2)}^{1/2} = 11,408 \text{ \#ft}$

$M_E = \frac{M_c + \sqrt{M_c^2 + M_T^2}}{2} = \text{EQUIV BENDING MOM.}$
 $= \frac{11408 + \sqrt{(11408^2 + 2450^2)}}{2} = 11,538 \text{ \#ft}$

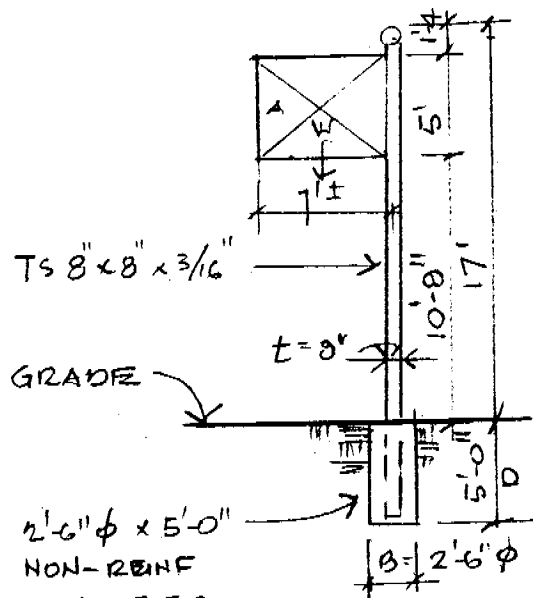

TS 8" x 8" x 3/16"
 GRADE
 t = 3/16"
 2'-6" φ x 5'-0" NON-REINF CONC. PIER OR * ALTERNATE

FOOTING EMBEDDMENT NON-CONSTRAINED

H.P. CALCULATOR PROGRAM 036360 & ENERCALC

$H \approx \frac{11538}{927} = 12.45' \quad P = 927 \text{ \#}$

$W_f = 150 (2)(1.33) = 400 \text{ P.S.F. / FT.}$
FOOTNOTE 3, TABLE 18-1-A
 SEC. 1809.2

TRY 2'-6" φ CONC. PIER = B

$D = 4.91'$

USE 2'-6" φ x 5'-0" CONC. PIER
 NO REINF. REQ'D. $f'_c = 2000 \text{ PSI}$

* ALTERNATE: 2'-6" x 2'-6" x 4'-4" } 2,500 PSI

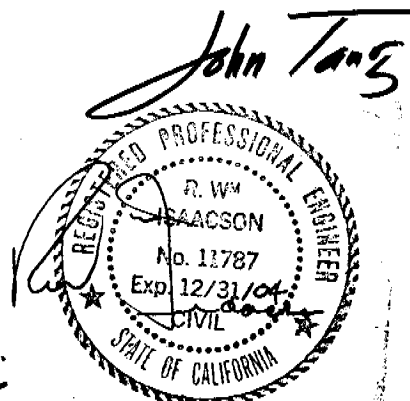

3/4/02

FOOTING INSPECTION REQUIRED

(CONT'D)

BY RWHM DATE 3/02

SUBJECT POLE SIGN

SHEET NO. 2 OF 2

CHKD. BY DATE

JOB NO. 02-119

BASE WIND COLUMN

$$\text{MAX STRESS IN COL.} = \frac{P(H + 0.34D)}{\text{SECT. MOD.}}$$

$$C = .34 D \approx 1.7'$$

$$M_c = 927 (12.45 + 1.7) = 13117 \text{ ft}^4$$

TRY TS 8x8

$$f_b = \frac{13117 \times 12}{14.6 \text{ in}^3} = 10,781 \text{ psi}$$

FOOTING INSPECTION REQUIRED

$$F_b = (.6) 46000 = 27600 \text{ psi O.K.}$$

USE TS 8" x 8" x 3/16" A500 Gr B
t = .188" WT = 19.63 #/l