

CITY OF SACRAMENTO

Permit No: 9805996

1231 I Street, Sacramento, CA 95814

Insp Area: 1

Site Address: 5092 FOLSOM BL SAC

Sub-Type: COM

Parcel No: 0080431042

Housing (Y/N): N

CONTRACTOR

SENTINEL FIRE EQUIP  
5702 BROADWAY  
SACRAMENTO CA

OWNER

QUALITY SUPERMARKET  
1550 51ST ST  
SACRAMENTO CA

ARCHITECT

95820 95819

Nature of Work: 2 ANSUL SYST. FOR HOODS

CONSTRUCTION LENDING AGENCY : I hereby affirm under penalty of perjury that there is a construction lending agency for the performance of the work for which this permit is issued (Sec. 3097, Civ. C).

Lender's Name \_\_\_\_\_ Lender's Address \_\_\_\_\_

LICENSED CONTRACTORS DECLARATION: I hereby affirm under penalty of perjury that I am licensed under provisions of Chapter 9 (commencing with section 7000) of Division 3 of the Business and Professions Code and my license is in full force and effect.

License Class C16 License Number 369137 Date 6-30-98 Contractor Signature SENTINEL FIRE

OWNER-BUILDER DECLARATION: I hereby affirm under penalty of perjury that I am exempt from the contractors License Law for the following reason (Sec. 7031.5, Business and Professions Code; any city or county which requires a permit to construct, alter, improve, demolish, or repair any structure, prior to its issuance, also requires the applicant for such permit to file a signed statement that he or she is licensed pursuant to the provisions of the Contractors License Law (Chapter 9 (commencing with Section 7000) of Division 8 of the Business and Professions Code) or that he or she is exempt therefrom and the basis for the alleged exemption. Any violation of Section 7031.5 by any applicant for a permit subjects the applicant to a civil penalty of not more than five hundred dollars (\$500.00);

I, as a owner of the property, or my employees with wages as their sole compensation, will do the work, and the structure is not intended or offered for sale (Sec. 7044, Business and Professional Code: The Contractors License Law does not apply to an owner of property who builds or improves thereon, and who does such work himself or herself or through his/her own employees, provided that such improvements are not intended or offered for sale. If, however, the building or improvement is sold within one year of completion, the owner-builder will have the burden of proving that he/she did not build or improve for the purpose of sale.)

I, as owner of the property, am exclusively contracting with licensed contractors to construct the project (Sec. 7044, Business and Professions Code: The Contractors License Law does not apply to an owner of property who builds or improves thereon, and who contracts for such projects with a contractor(s) licensed pursuant to the Contractors License Law).

I am exempt under Sec. \_\_\_\_\_ B & PC for this reason: \_\_\_\_\_

Date \_\_\_\_\_ Owner Signature \_\_\_\_\_

IN ISSUING THIS BUILDING PERMIT, the applicant represents, and the city relies on the representation of the applicant, that the applicant verified all measurements and locations shown on the application or accompanying drawings and that the improvement to be constructed does not violate any law or private agreement relating to permissible or prohibited locations for such improvements. This building permit does not authorize any illegal location of any improvement or the violation of any private agreement relating to location of improvements.

I certify that I have read this application and state that all information is correct. I agree to comply with all city and county ordinances and state laws relating to building construction and hereby authorize representative(s) of this city to enter upon the abovementioned property for inspection purposes.

Date 6-30-98 Applicant/Agent Signature Wayne Yarrington

WORKER'S COMPENSATION DECLARATION: I hereby affirm under penalty of perjury one of the following declarations:

I have and will maintain a certificate of consent to self-insure for workers' compensation as provided for by Section 3700 of the Labor Code, for the performance of work for which the permit is issued.

I have and will maintain workers' compensation insurance, as required by Section 3700 of the Labor Code, for the performance of the work for which this permit is issued. My workers' compensation insurance carrier and policy number are:

Carrier GOLDEN EAGLE Policy Number NWC 41939810  
EXP. 11-30-98

(This section need not be completed if the permit is for \$100 or less) I certify that in the performance of the work for which this permit is issued, I shall not employ any person in any manner so as to become subject to the workers' compensation laws of California and agree that if I should become subject to the workers' compensation provisions of Section 3700 of the Labor Code, I shall forthwith comply with those provisions.

Date 6-30-98 Applicant Signature Wayne Yarrington

WARNING: FAILURE TO SECURE WORKER'S COMPENSATION COVERAGE IS UNLAWFUL AND SHALL SUBJECT AN EMPLOYER TO CRIMINAL PENALTIES AND CIVIL FINES UP TO ONE HUNDRED THOUSAND DOLLARS (\$100,000) IN ADDITION TO THE COST OF COMPENSATION, DAMAGES AS PROVIDED FOR IN SECTION 3706 OF THE LABOR CODE, INTEREST AND ATTORNEY'S FEE.

THIS PERMIT SHALL EXPIRE BY LIMITATION IF WORK IS NOT COMMENCED WITHIN 180 DAYS.

11/30/98  
B2

# MEMORANDUM

Sacramento Fire Department

To: BUILDING DEPARTMENT

Date: 7-16-98

From: Gordon Duncan,  
Fire Marshal

Subject: **FIRE SYSTEM INSPECTION**

A final inspection of the newly installed fire system at:

5090 Folsom Blvd

has been conducted by Inspector F. Johnson

on 7-9-98.

Permit Number 98-05996-C

The system is acceptable by this Department.

Kit Hood  
Type Inspection

R. Woodman  
By: Ross L. Woodman,  
Fire Prevention Officer II

98-119  
F. D. Reference Number

1 1/2" NOSH. 3

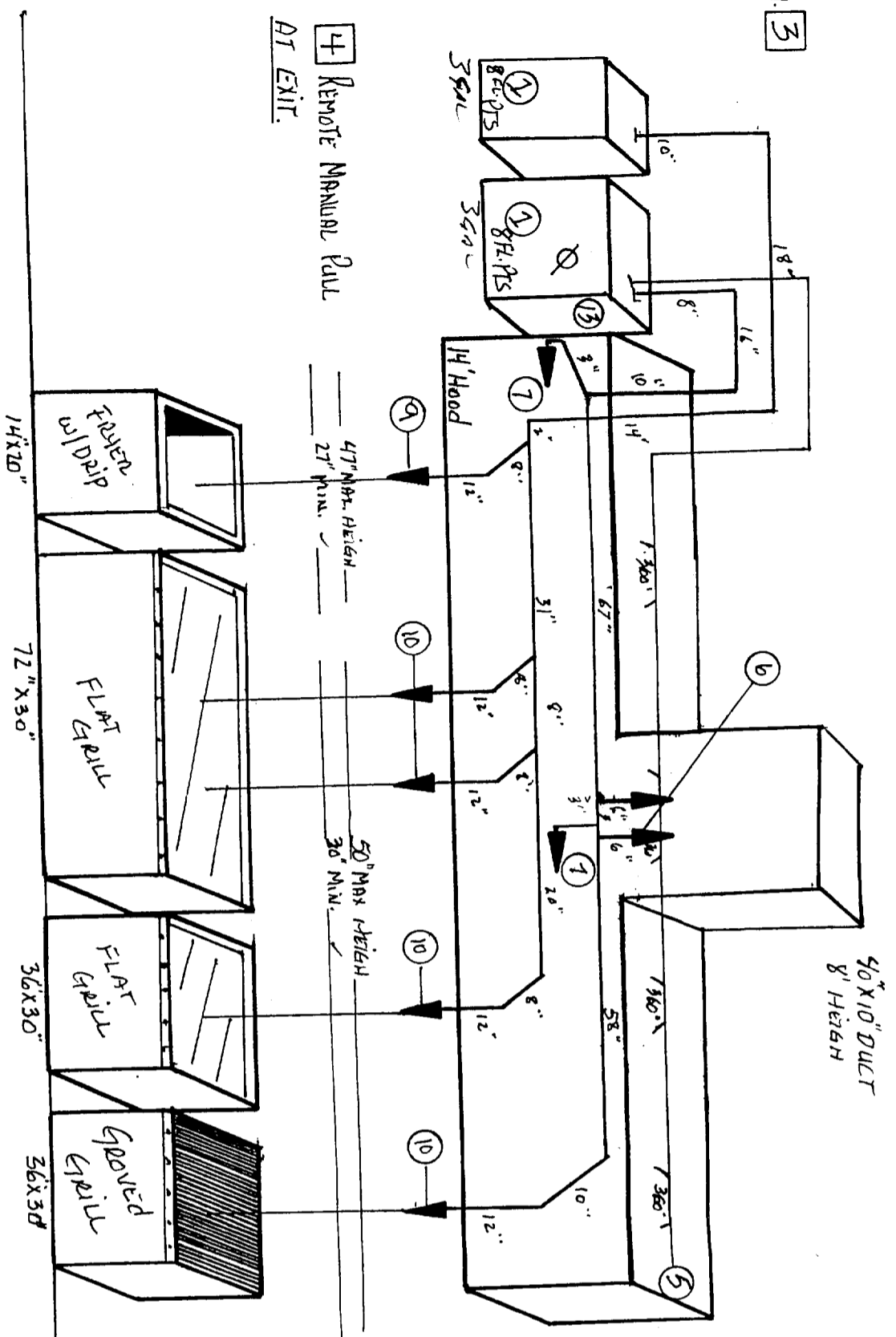

4 Remote Manual Pull  
AT EXIT.

**APPROVED**

*Feb 4/30/98*  
SACRAMENTO  
FIRE DEPARTMENT

Established 1929		SALES AND SERVICE		
<b>SENTINEL FIRE</b>		ANSUL AUTHORIZED DISTRIBUTOR		
EQUIPMENT COMPANY		RESTAURANT HOOD SYSTEMS		
C-16 LICENSE NO. 369137		VEHICLE FIRE PROTECTION		
5702 BROADWAY, SACRAMENTO, CA 95820		(916) 455-5630		
NO.	DESCRIPTION	PART NO	NO.	DESCRIPTION
1	ANSUL (R102) SYSTEM	79290	6	DUCT NOZZLE
2	OTHER		7	PLENUM NOZZLE-8"
3	GAS VALVE 1 1/2" MESH	55607	8	PLENUM NOZZLE-4"
4	REMOTE PULL BOX	4835	9	FRYER NOZZLE
5	DETECTOR BRACKET 360°	56837	10	/GRILL NOZZLE 2 1/4"

\* ALL PIPING IS 3/8" BLK.-SCHD. 40  
 \* AS BUILT PIPING DIMENSIONS TO BE FURNISHED AT FINAL TEST  
 \* TO BE INSTALLED AS-PER ANSUL MANUAL, NFPA 77A, AND LOCAL FIRE AUTH.  
 \* MAX. FLOW POINTS IS (22), BEING USED IS (16) FLOW POINTS  
 SINGLE FILTER BANK

BRAND	ANSUL	JOB NAME	Cassidy's	DRAWN BY:		
MODEL	R102 711300	ADDRESS	50955- Tolson Blvd.			
DATE	6-30-98	CITY	SACRAMENTO, CA.			
NO.	DESCRIPTION	PART NO	NO.	DESCRIPTION	PART NO	SCALE
11	RADIANT BROILER	419337				
12	SALAMANDER NOZZLE	419335				
13	Misc Switch for Alarm Interference				32222	
14		230				
15		260				

**ISSUED**

JUN 30 1998

CITY OF SACRAMENTO  
DEVELOPMENT SERVICES DIV

*Ken Plan*  
INSPECTOR

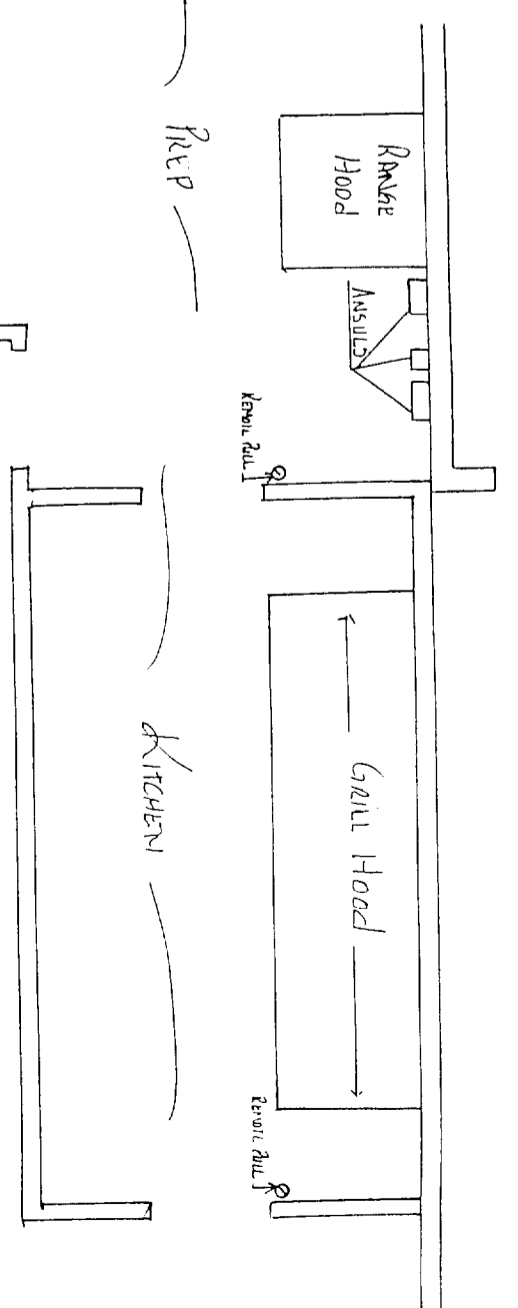

4085  
FINE ART

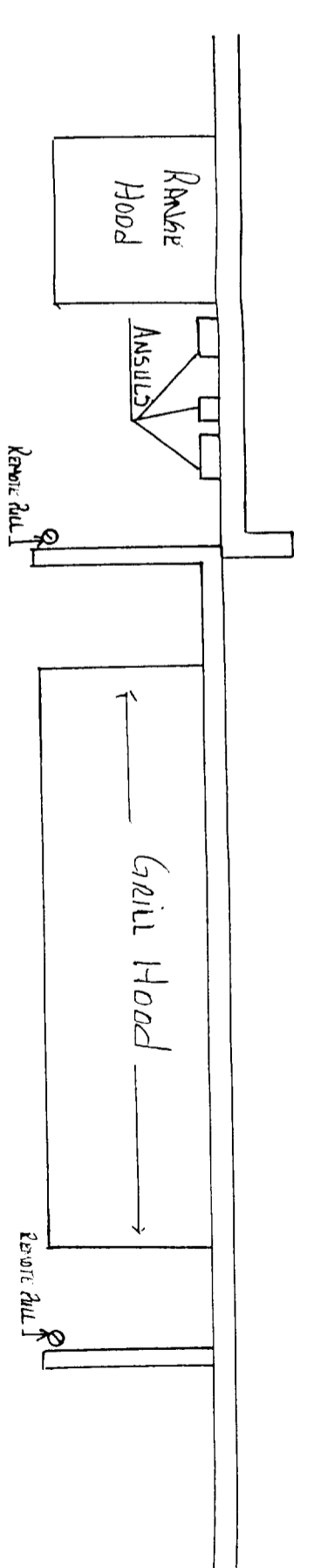
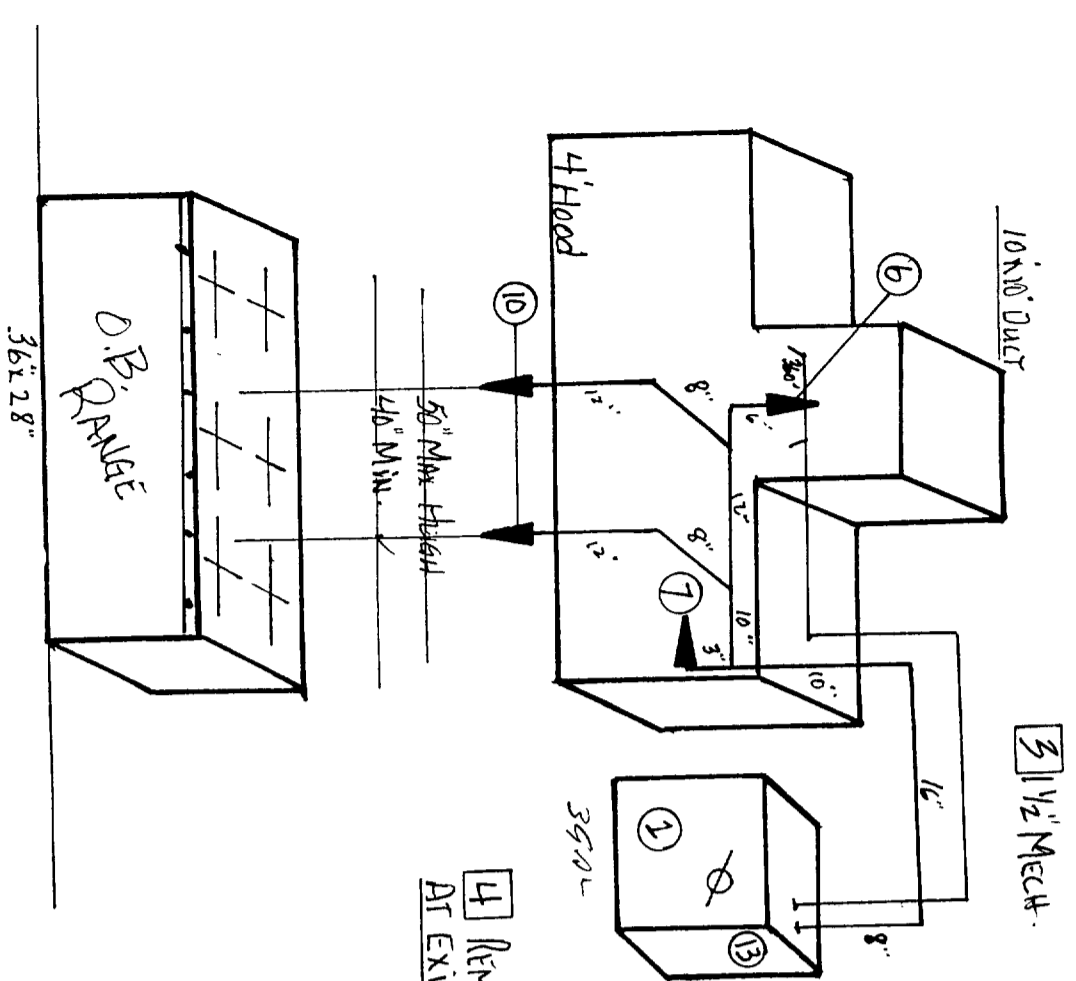

**APPROVED**  
*6/30/98*  
 SACRAMENTO  
 FIRE DEPARTMENT

**ISSUED**  
 JUN 30 1998  
 CITY OF SACRAMENTO  
 DEVELOPMENT SERVICES DIV.

\*ALL PIPING IS 3/8" BLK.-SCHD. 40  
 \*AS BUILT PIPING DIMENSIONS TO BE FURNISHED AT FINAL TEST  
 \*TO BE INSTALLED AS-PER ANSUL MANUAL, NFPA 17A, AND LOCAL FIRE AUTH.  
 \*MAX. FLOW POINTS IS (11), BEING USED IS (7) FLOW POINTS  
 SINGLE FILTER BANK.

Established 1929 <b>SENTINEL FIRE</b> EQUIPMENT COMPANY C-16 LICENSE NO. 369137 5702 BROADWAY, SACRAMENTO, CA 95820 (916) 455-5630		SALES AND SERVICE ANSUL AUTHORIZED DISTRIBUTOR • RESTAURANT HOOD SYSTEMS • VEHICLE FIRE PROTECTION		BRAND ANSUL	JOB NAME Cassidy's	DRAWN BY: <i>WV</i>
MODEL R102 711300 3GAZ.		ADDRESS 5055 Folsom Blvd.		DATE 6-30-98	CITY Sacramento, CA	SCALE
NO.	DESCRIPTION	PART NO	NO.	DESCRIPTION	PART NO	SCALE
1	ANSUL (R102) SYSTEM	79290	6	DUCT NOZZLE	419337	
2	OTHER		7	PLENUM NOZZLE-8'	419339	
3	GAS VALVE 1/2" NEUL.	55607	8	PLENUM NOZZLE-4'		
4	REMOTE PULL BOX	4835	9	FRYER NOZZLE		
5	DETECTOR BRACKET	260	10	RANGE/ NOZZLE 2 1/2"	245	
			11	RADIANT BROILER		
			12	SALAMANDER NOZZLE		
			13	Microwave Interlock	32222	Parcel #
			14			
			15			