

CITY OF SACRAMENTO

Permit No: 9811978

1231 I Street, Sacramento, CA 95814

Insp Area: 4

Site Address: 3316 MARINA GLEN WY SAC

Sub-Type: NSFR

Parcel No: 2740480053

LOT 47/RIVERSGATE

Housing (Y/N): N

CONTRACTOR

WARMINGTON HOMES
8265 SIERRA COLLEGE BL #312
ROSEVILLE CA 95661

OWNER

WARMINGTON HOMES

ARCHITECT

HEZMALHLACH WILLIAM ARCH INC
17875 VON KARMAN AV #404
IRVINE CA 92614

Nature of Work: NEW HOME, MP2059, 8 ROOMS

CONSTRUCTION LENDING AGENCY : I hereby affirm under penalty of perjury that there is a construction lending agency for the performance of the work for which this permit is issued (Sec. 3097, Civ. C).

Lender's Name

Lender's Address

LICENSED CONTRACTORS DECLARATION: I hereby affirm under penalty of perjury that I am licensed under provisions of Chapter 9 (commencing with section 7000) of Division 3 of the Business and Professions Code and my license is in full force and effect.

License Class B License Number 746231 Date 12-17-98 Contractor Signature [Signature]

OWNER-BUILDER DECLARATION: I hereby affirm under penalty of perjury that I am exempt from the contractors License Law for the following reason (Sec. 7031.5, Business and Professions Code: any city or county which requires a permit to construct, alter, improve, demolish, or repair any structure, prior to its issuance, also requires the applicant for such permit to file a signed statement that he or she is licensed pursuant to the provisions of the Contractors License Law (Chapter 9 (commencing with Section 7000) of Division 8 of the Business and Professions Code) or that he or she is exempt therefrom and the basis for the alleged exemption. Any violation of Section 7031.5 by any applicant for a permit subjects the applicant to a civil penalty of not more than five hundred dollars (\$500.00);

I, as a owner of the property, or my employees with wages as their sole compensation, will do the work, and the structure is not intended or offered for sale (Sec. 7044, Business and Professions Code: The Contractors License Law does not apply to an owner of property who builds or improves thereon, and who does such work himself or herself or through his/her own employees, provided that such improvements are not intended or offered for sale. If, however, the building or improvement is sold within one year of completion, the owner-builder will have the burden of proving that he/she did not build or improve for the purpose of sale.)

I, as owner of the property, am exclusively contracting with licensed contractors to construct the project (Sec. 7044, Business and Professions Code: The Contractors License Law does not apply to an owner of property who builds or improves thereon, and who contracts for such projects with a contractor(s) licensed pursuant to the Contractors License Law).

I am exempt under Sec. B & PC for this reason:

Date Owner Signature

IN ISSUING THIS BUILDING PERMIT, the applicant represents, and the city relies on the representation of the applicant, that the applicant verified all measurements and locations shown on the application or accompanying drawings and that the improvement to be constructed does not violate any law or private agreement relating to permissible or prohibited locations for such improvements. This building permit does not authorize any illegal location of any improvement or the violation of any private agreement relating to location of improvements.

I certify that I have read this application and state that all information is correct. I agree to comply with all city and county ordinances and state laws relating to building construction and hereby authorize representative(s) of this city to enter upon the abovementioned property for inspection purposes.

Date 12-17-98 Applicant/Agent Signature [Signature]

WORKER'S COMPENSATION DECLARATION: I hereby affirm under penalty of perjury one of the following declarations:

I have and will maintain a certificate of consent to self-insure for workers' compensation as provided for by Section 3700 of the Labor Code, for the performance of work for which the permit is issued.

I have and will maintain workers' compensation insurance, as required by Section 3700 of the Labor Code, for the performance of the work for which this permit is issued. My workers' compensation insurance carrier and policy number are:

Carrier REPUBLIC INDEM CO OF AMERICA Policy Number 00779320 Exp Date 07/01/1999

(This section need not be completed if the permit is for \$100 or less) I certify that in the performance of the work for which this permit is issued, I shall not employ any person in any manner so as to become subject to the workers' compensation laws of California and agree that if I should become subject to the workers' compensation provisions of Section 3700 of the Labor Code, I shall forthwith comply with those provisions.

Date 12-17-98 Applicant Signature [Signature]

WARNING: FAILURE TO SECURE WORKER'S COMPENSATION COVERAGE IS UNLAWFUL AND SHALL SUBJECT AN EMPLOYER TO CRIMINAL PENALTIES AND CIVIL FINES UP TO ONE HUNDRED THOUSAND DOLLARS (\$100,000) IN ADDITION TO THE COST OF COMPENSATION, DAMAGES AS PROVIDED FOR IN SECTION 3706 OF THE LABOR CODE, INTEREST AND ATTORNEY'S FEE.

THIS PERMIT SHALL EXPIRE BY LIMITATION IF WORK IS NOT COMMENCED WITHIN 180 DAYS.



№ 10097

INSTALLATION CARD

Job Address:

*473316 Marina del Rey*  
*473316 Marina del Rey*

Stucco System Trade Name: KWIK KOTE  
Name Stucco Manufacturer: KWIK KOTE CORP.

Report No. 3607  
Date of Job Completion

Stucco Contractor: Kenyon Construction

Name: John W. Kenyon, III

Address: P.O. Box 2077

North Highlands, CA 95660

Telephone Number: (916) 349-8191

Approved Contractor Number as issued by the Stucco Manufacturer: 1

This is to certify that the stucco system on the building exterior at the above address had been installed in accordance with the evaluation report specified above and the manufacturer's instructions.

Signature of authorized representative of stucco contractor

Date

# CERTIFICATION OF INSULATION

PART I GENERAL  
PART II AREAS INSULATED

WARMINGTON     RIVERBEND	LOT # 47	<input checked="" type="checkbox"/> P.O. BOX 854, WEST SACRAMENTO, CA 95691 LIC. #202026 <input type="checkbox"/> 1453 GARDEN HWY., YUBA CITY, CA 95991 LIC. #202026 <input type="checkbox"/> P.O. BOX 9651, FRESNO, CA 93793-9651 LIC. #202026 <input type="checkbox"/> P.O. BOX 1631, RENO, NV 89505 LIC. #10675 <input type="checkbox"/> 3326 A PONDEROSA WAY, LAS VEGAS, NV 89118 LIC. #10675
DATE INSULATION COMPLETED		

WALLS	CEILING	FLOORS
( SQUARE FEET)	( SQUARE FEET)	( SQUARE FEET)
TYPE OF INSULATION		TYPE OF INSULATION
MATERIAL <b>FIBERGLASS</b>	MATERIAL <b>FIBERGLASS</b>	MATERIAL <b>FIBERGLASS</b>
FORM <b>BATTS</b>	FORM <b>BATTS &amp; BLOW</b>	FORM <b>BATTS</b>
MANUFACTURER'S PRODUCT I.D.		MANUFACTURER'S PRODUCT I.D.
MANUFACTURER		MANUFACTURER
<b>OCF</b>		<b>OCF</b>
BAGS		
R-VALUE INSTALLED	APPLIED THICKNESS	R-VALUE INSTALLED
<b>13</b>	<b>3 5/8</b>	
	<b>30 BATT</b>	
	<b>30 BLOW</b>	
	<b>9</b>	
	<b>12</b>	

**KNEE WALLS IF R-VALUE IS OTHER THAN WALLS ABOVE**

MATERIAL <b>FIBERGLASS</b>	FORM <b>BATTS</b>	R VALUE	MANUFACTURER <b>OCF</b>
-------------------------------	----------------------	---------	----------------------------

**AIR INFILTRATION SEALANT**

MATERIAL <b>FOAM</b>	MANUFACTURER <b>W R GRACE</b>
-------------------------	----------------------------------

**THIS IS TO CERTIFY THAT INSULATION AND/OR SEALANT HAS BEEN INSTALLED IN CONFORMANCE WITH APPLICABLE CODES AND REGULATIONS.**

SIGNATURE—INSULATION CONTRACTOR <i>Mark Smith</i>	TITLE MANAGER	DATE 5-4-99
SIGNATURE—GENERAL CONTRACTOR	TITLE	DATE

REMARKS

# NATOMAS UNIFIED SCHOOL DISTRICT

1515 Sports Drive, #1 • Sacramento, CA 95834  
Phone 916/641-3300 • Fax 916/928-1629

## CERTIFICATION OF COMPLIANCE

### SCHOOL DISTRICT DEVELOPMENT FEES

<b>PART I: TO BE COMPLETED BY APPLICANT</b>			
PROPERTY OWNER'S NAME	WARMINGTON HOMES		
OWNER'S ADDRESS	5500 DOUGLAS BLVD.		
PROJECT ADDRESS	3316 MARINA BLVD		
PARCEL NUMBER	274 0480-053		
SUBDIVISION NAME	RIVERBEND		
NUMBER OF UNITS			
PRINT APPLICANT'S NAME	MARK WHITEHEAD	APPLICANT'S SIGNATURE:	<i>Mark Whitehead</i>
TITLE OF APPLICANT	SUPERINTENDENT		
DATE	12-16-98	TELEPHONE NUMBER	791-5200
<b>PART II: TO BE COMPLETED BY BUILDING DEPARTMENT</b>			
PLAN IDENTIFICATION NUMBER	9811978		
BUILDING TYPE (CHECK ONE)	<input checked="" type="checkbox"/> RESIDENTIAL <input type="checkbox"/> APARTMENT/CONDOMINIUM <input type="checkbox"/> COMMERCIAL/INDUSTRIAL		
SQUARE FEET OF CHARGEABLE BUILDING AREA	2059		
SIGNATURE	<i>Margaret McAllen</i>		
TITLE	<i>Body Seal</i>	DATE	12-12-98
<b>PART III: TO BE COMPLETED BY NATOMAS UNIFIED SCHOOL DISTRICT</b>			
DISTRICT CERTIFICATION NUMBER	99-71		
FEES COLLECTED			
RESIDENTIAL	2059 Sq. Ft. X \$ 1.93	= \$	3973.87
APARTMENT/CONDOMINIUM	Sq. Ft. X \$	= \$	
COMMERCIAL/INDUSTRIAL	Sq. Ft. X \$	= \$	

This certification covers only the amount of square footage indicated above. Any additions or corrections to the square footage for this project will require an amendment to the Certificate of Compliance.

As the authorized school district official, I hereby certify that the requirements of Government Code Section 65995 have been complied with by the above signed applicant.

**AUTHORIZED SCHOOL DISTRICT OFFICIAL:**

SIGNATURE: *Frank R. Smith*  
 TITLE: *Fac. Plan Sec*      DATE: 12/17/98

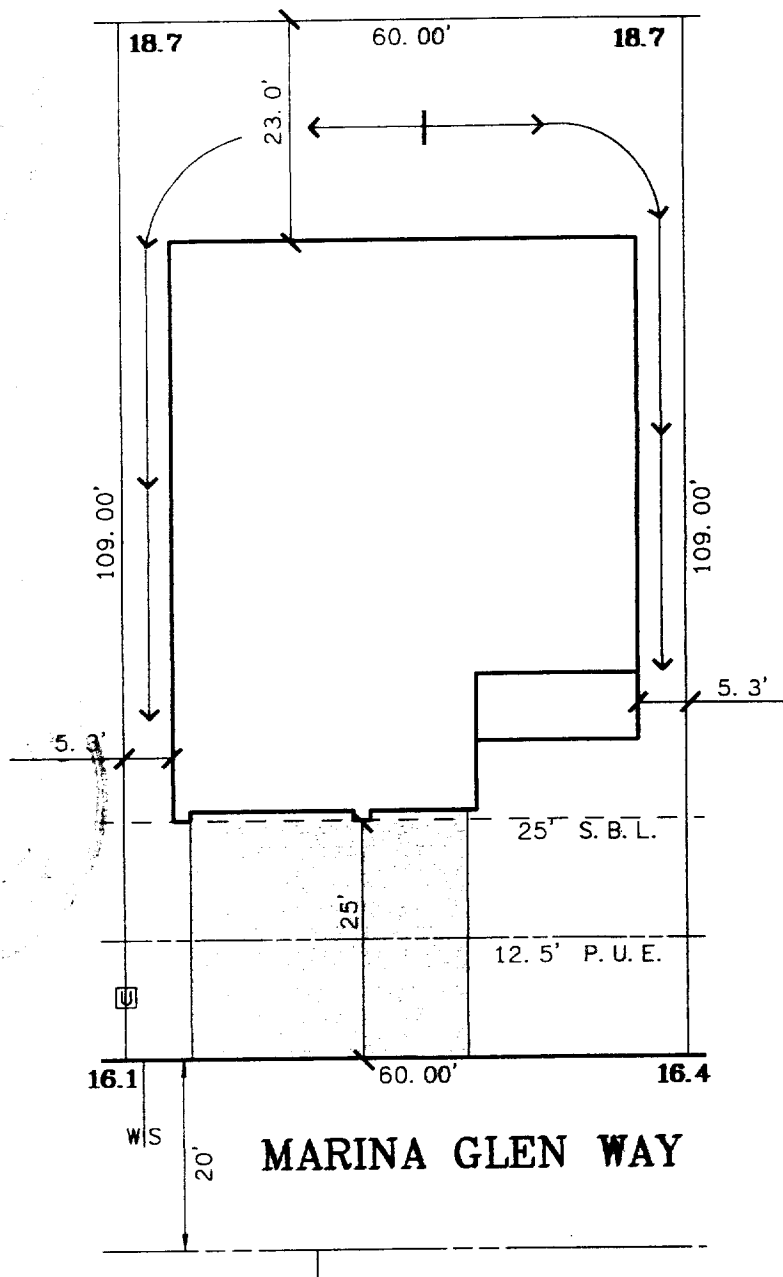

SCALE: 1" = 20' 

A. P. N. :  
 ADDRESS : 3316 MARINA GLEN WAY

**The Spink Corporation**  
 2590 VENTURE OAKS WAY  
 SACRAMENTO, CA. 95833  
 PH:(916)925-5550 FAX:(916)921-9274

**RIVERGATE**  
 LOT 47  
 PLAN 2

**RIVERBEND CLASSICS**  
 CITY OF SACRAMENTO, CA.  
 CLIENT: WARMINGTON HOMES  
 JOB NO.: 9342-001