

CITY OF SACRAMENTO
1231 I Street, Sacramento, CA 95814

Permit No: 0402282
Insp Area: 4
Thos Bros: 257A4

Site Address: 2708 MACON DR SAC
Parcel No: 201-0620-019
N

NORTHBOROUGH II VIL. 8-4 LOT 19

Sub-Type: NSFR
Housing (Y/N):

CONTRACTOR
US HOME
2366 GOLD MEADOW DR STE 100
GOLD RIVER, CA 95670 77041

OWNER

ARCHITECT

Nature of Work: MP3377 2 STORY 12 ROOM SFR

CONSTRUCTION LENDING AGENCY : I hereby affirm under penalty of perjury that there is a construction lending agency for the performance of the work for which this permit is issued (Sec. 3097, Civ. C).

Lender's Name _____ Lender's Address _____

LICENSED CONTRACTORS DECLARATION: I hereby affirm under penalty of perjury that I am licensed under provisions of Chapter 9 (commencing with section 7000) of Division 3 of the Business and Professions Code and my license is in full force and effect.

License Class B License Number 451839 Date 3/9/4 Contractor Signature Don McCloskey

OWNER-BUILDER DECLARATION: I hereby affirm under penalty of perjury that I am exempt from the contractors License Law for the following reason (Sec. 7031.5, Business and Professions Code; any city or county which requires a permit to construct, alter, improve, demolish, or repair any structure, prior to its issuance, also requires the applicant for such permit to file a signed statement that he or she is licensed pursuant to the provisions of the Contractors License Law (Chapter 9 (commencing with Section 7000) of Division 8 of the Business and Professions Code) or that he or she is exempt therefrom and the basis for the alleged exemption. Any violation of Section 7031.5 by any applicant for a permit subjects the applicant to a civil penalty of not more than five hundred dollars (\$500.00);

____ I, as a owner of the property, or my employees with wages as their sole compensation, will do the work, and the structure is not intended or offered for sale (Sec. 7044, Business and Professional Code: The Contractors License Law does not apply to an owner of property who builds or improves thereon, and who does such work himself or herself or through his/her own employees, provided that such improvements are not intended or offered for sale. If, however, the building or improvement is sold within one year of completion, the owner-builder will have the burden of proving that he/she did not build or improve for the purpose of sale.)

____ I, as owner of the property, am exclusively contracting with licensed contractors to construct the project (Sec. 7044, Business and Professions Code: The Contractors License Law does not apply to an owner of property who builds or improves thereon, and who contracts for such projects with a contractor(s) licensed pursuant to the Contractors License Law).

____ I am exempt under Sec. _____ B & PC for this reason: _____

Date _____ Owner Signature _____

IN ISSUING THIS BUILDING PERMIT, the applicant represents, and the city relies on the representation of the applicant, that the applicant verified all measurements and locations shown on the application or accompanying drawings and that the improvement to be constructed does not violate any law or private agreement relating to permissible or prohibited locations for such improvements. This building permit does not authorize any illegal location of any improvement or the violation of any private agreement relating to location of improvements.

I certify that I have read this application and state that all information is correct. I agree to comply with all city and county ordinances and state laws relating to building construction and hereby authorize representative(s) of this city to enter upon the abovementioned property for inspection purposes

Date 3/9/4 Applicant/Agent Signature Don McCloskey

WORKER'S COMPENSATION DECLARATION: I hereby affirm under penalty of perjury one of the following declarations:
____ I have and will maintain a certificate of consent to self-insure for workers' compensation as provided for by Section 3700 of the Labor Code, for the performance of work for which the permit is issued.

I have and will maintain workers' compensation insurance, as required by Section 3700 of the Labor Code, for the performance of the work for which this permit is issued. My workers' compensation insurance carrier and policy number are:

Carrier OLD REPUBLIC INS. CO. Policy Number MWC10815000 Exp Date 11/01/2004

____ (This section need not be completed if the permit is for \$100 or less) I certify that in the performance of the work for which this permit is issued, I shall not employ any person in any manner so as to become subject to the workers' compensation laws of California and agree that if I should become subject to the workers' compensation provisions of Section 3700 of the Labor Code, I shall forthwith comply with those provisions.

Date 3/9/4 Applicant Signature Don McCloskey

WARNING: FAILURE TO SECURE WORKER'S COMPENSATION COVERAGE IS UNLAWFUL AND SHALL SUBJECT AN EMPLOYER TO CRIMINAL PENALTIES AND CIVIL FINES UP TO ONE HUNDRED THOUSAND DOLLARS (\$100,000) IN ADDITION TO THE COST OF COMPENSATION, DAMAGES AS PROVIDED FOR IN SECTION 3706 OF THE LABOR CODE, INTEREST AND ATTORNEY'S FEE.

THIS PERMIT SHALL EXPIRE BY LIMITATION IF WORK IS NOT COMMENCED WITHIN 180 DAYS.

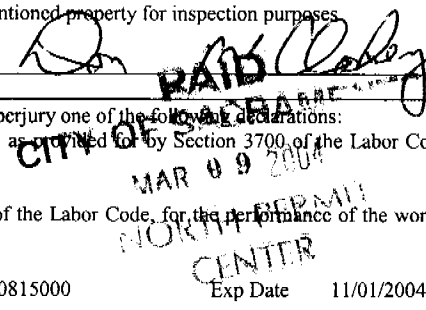

THIS PLAN IS PREPARED TO SHOW THE DIMENSIONAL RELATIONSHIP FROM BUILDING FOUNDATION TO PROPERTY LINES, DRAINAGE CONTROL ELEVATIONS AND DIRECTION OF DRAINAGE FLOW. THIS IS DONE TO CONFORM TO LOCAL ORDINANCES FOR THE PURPOSE OF BUILDING PERMIT ISSUANCE. INFORMATION SHOWN ON THIS PLAN IS APPROXIMATE EXCEPT FOR MINIMUM SETBACKS WHICH ARE REQUIRED BY LOCAL ORDINANCE. THIS PLAN DOES NOT REFLECT AS BUILT CONDITIONS WHICH WILL LIKELY VARY FROM THIS PLAN.

MP 3377

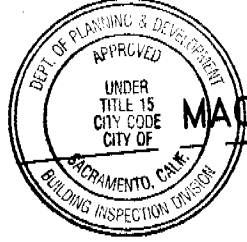
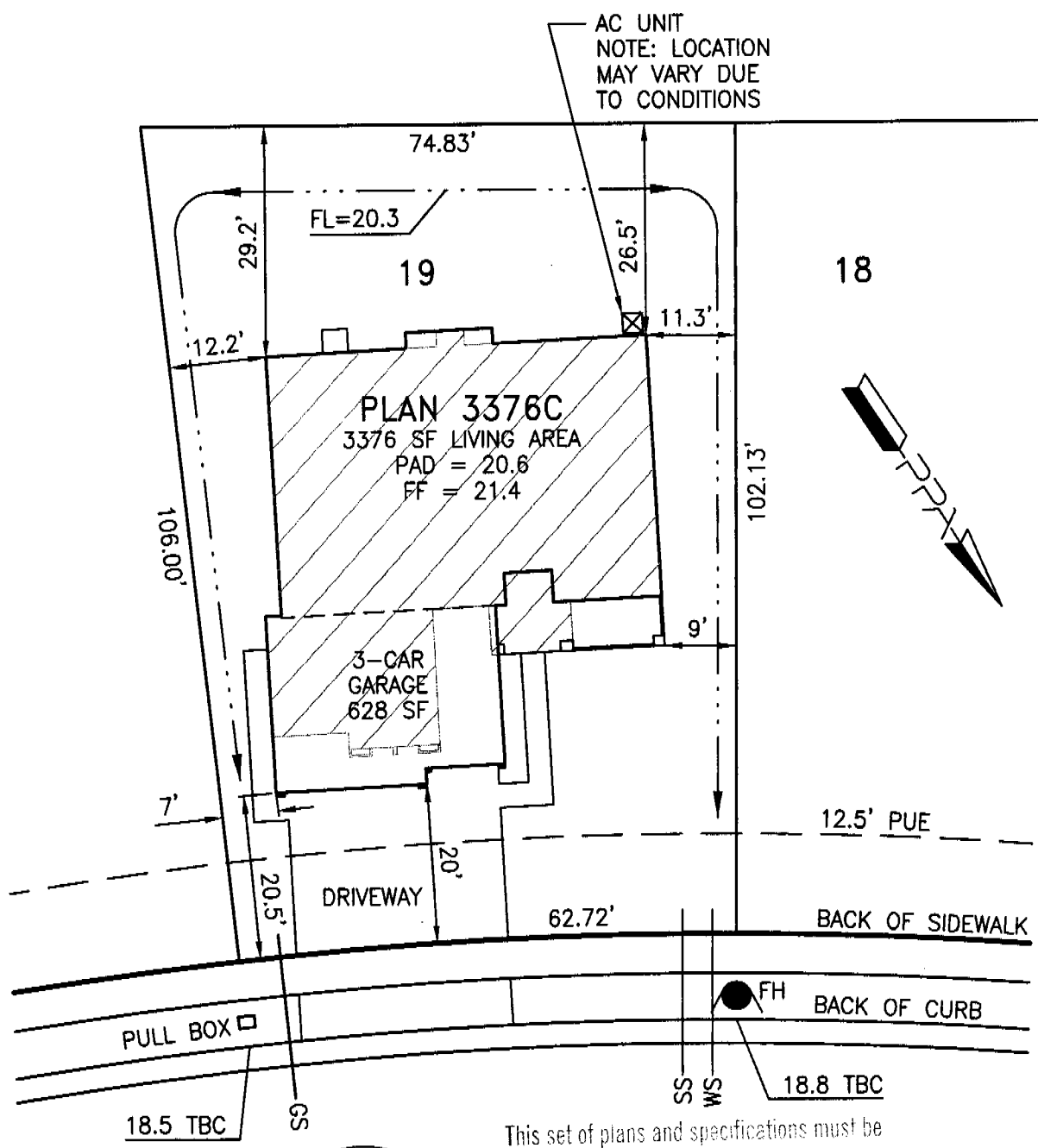

This set of plans and specifications must be kept on the job at all times and it is unlawful to make any changes or alterations from the plans without written permission from the Building Inspection Division.

The approval of this plan and specification SHALL NOT be held to permit or approve the violation of any City Ordinance or State Law.

Approved By:	US Home Corp. Rep.	Date
Revision	Approved By	Date
▲		
▲		

LOT AREA: 7100 SF
 ALLOWED LOT COVERAGE: 2840 SF = 40.0%
 ACTUAL LOT COVERAGE: 2202 SF = 31.0%
 REAR YARD AREA: 2014 SF
 NUMBER OF BEDROOMS:

It is understood that the drainage areas, slopes and grades shall not be altered, changed, blocked, modified or in any way be reconstructed by Owner contrary to what is depicted on this Plot Plan. THESE CONDITIONS RUN WITH THE LAND AND ARE BINDING ON ALL SUBSEQUENT OWNERS. All setback dimensions and elevations as shown may be adjusted to fit field conditions.

Plot Plan for Heritage at Natomas Park Village 8-4 PPA Job #005007
Natomas Laureate Lot 19
 2708 Macon Drive, Sacramento, CA 95835 APN 201-0620-019

US Home Corporation - Sacramento Division
 2366 Gold Meadow Way, Suite 200, Gold River, CA 95670 Phone (916) 858-3900 Fax (916) 858-3925

Plot Plan Associates www.plotplans.org Date Drawn: 02/09/04 Scale: 1"=20'
 PO Box 435 Citrus Heights CA 95611-0435 (916) 769-9063 Date Revised: Drawn By: MRM

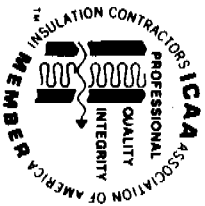

**INSULATION CONTRACTORS
ASSOCIATION
OF AMERICA**

INSULATION
CERTIFICATE
476996

1321 DUKE STREET, SUITE 303 • ALEXANDRIA, VA 22314 • (703) 739-0356

THIS IS TO CERTIFY THAT INSULATION HAS BEEN INSTALLED IN CONFORMANCE WITH CURRENT ENERGY REGULATIONS, CALIFORNIA ADMINISTRATIVE CODE TITLE 24, STATE OF CALIFORNIA, IN THE BUILDING LOCATED AT

LOT # _____ TRACT # 476996

STREET 2708 Maan Dr CITY _____

EXTERIOR WALLS:

MANUFACTURER _____ THICKNESS/TYPE _____ R-13
VALUE _____

CEILING:

BATTS: _____ THICKNESS/TYPE _____ R-38
VALUE _____

MANUFACTURER _____ THICKNESS/TYPE _____ R-38
BLOWN IN: _____ MINIMUM _____
VALUE _____

MANUFACTURER _____ THICKNESS _____ R-38
VALUE _____

SQUARE FOOTAGE COVERED _____ NUMBER OF BAGS USED _____
FLOORS: _____

MANUFACTURER _____ THICKNESS/TYPE _____ R-38
VALUE _____

SLAB ON GRADE: _____ THICKNESS/TYPE _____ R-38
VALUE _____

MANUFACTURER _____ THICKNESS/TYPE _____ R-38
VALUE _____

WIDTH OF INSULATION _____ INCHES
FOUNDATION WALLS: _____

MANUFACTURER _____ THICKNESS/TYPE _____ R-38
VALUE _____

GENERAL CONTRACTOR _____ DATE _____
CALIFORNIA CONTRACTORS LICENSE # _____

SIGNATURE _____ TITLE _____
INSULATION CONTRACTOR **ARCADE INSULATION**

CALIFORNIA CONTRACTORS LICENSE #815286
NEVADA CONTRACTORS LICENSE #55201
DATE 10/12/09

SIGNATURE _____ TITLE _____

INSTALLATION CERTIFICATE

CF-6R

US HOME - NATOMAS 8-4

Site Address

Permit Number

An installation certificate is required to be posted at the building site or made available for all appropriate inspections. (The information provided on this form is required; however, use of this form to provide the information is optional.) After completion of final inspection a copy must be provided to the building department (upon request) and the building owner at occupancy, per Section 10-103(b).

HVAC SYSTEMS:

Heating Equipment

Table with 10 columns: Equip. Type (pkg. Heat pump), CEC Certified Mfr name and Model #, # of Identical Systems, (1) Efficiency (AFUE, etc.) > CF-IR value, Duct Location (attic, etc.), Duct or Piping R-value, Heating Load (Btu/hr), Heating Capacity (Btu/hr), PLAN. Rows include FURNACE YORK#P4HUB16L064, FURNACE YORK#P4HUC20L080, etc.

Cooling Equipment

Table with 10 columns: Equip. Type (pkg. Heat pump), CEC Certified Compressor Unit Mfr Name and Model #, # of Identical Systems, (1) Efficiency (SEER, etc.) > CF-IR value, Duct Location (attic, etc.), Duct R-value, Cooling Load (Btu/hr), Cooling Capacity (Btu/hr), PLAN. Rows include A/C YORK #H*RC042, A/C YORK #H*RA048, etc.

* = TXV with coil

(1) > reads greater than or equal to.

I, the undersigned, verify that equipment listed above is: 1) is the actual equipment installed, 2) equivalent to or more efficient than that specified in the certificate of compliance (Form CH-IR) submitted for compliance with the Energy Efficiency Standards for residential buildings, and 3) equipment that meets or exceeds the appropriate requirements for mandatory services from the Energy Efficiency Regulations or Part 6, where applicable.

Signature, Date

BEUTLER CORPORATION

Installing Subcontractor (Co. Name)

OR General Contractor (Co. Name) OR Owner

WATER HEATING SYSTEMS:

Table with 10 columns: Heater Type, CEC Certified Mfr Name & Model #, Distribution Type (Std. point of use), If Recirculation Control Type, # of Identical Systems, (2) Rated Input (kW or Btu/hr), Tank Volume (gallons), (2) Efficiency (EF, RE), (3) Standby Loss (%), External Insulation R-value.

(2) For small gas storage (rated input of less than or equal to 75,000 Btu/hr), electric resistance and heat pump water heaters, list Energy Factor. For large gas storage water heaters (rated input of greater than 75,000 Btu/hr), list Recovery Efficiency, Standby Loss and Rated Input. For instantaneous gas water heaters, list Recovery efficiency and Rated Input.

(3) R-12 external insulation is mandatory for storage water heaters with an energy factor of less than 0.58.

Facets & Shower Heads: