

THIS IS A 2 PART FORM WRITE ON A FIRM SURFACE

USE BLACK INK BALL POINT PEN — PRESS FIRMLY SIGN PERMIT APPLICATION

CONSTRUCTION LENDING AGENCY

I hereby affirm under penalty of perjury that there is a construction lending agency for the performance of the work for which this permit is issued (Sec. 3097, Civ.C).

Lenders Name _____
Lenders Address _____

LICENSED CONTRACTORS DECLARATION

I hereby affirm under penalty of perjury that I am licensed under provisions of Chapter 9 (commencing with Section 7000) of Division 3 of the Business and Professions Code and my license is in full force and effect.

License Class _____ Lic. Number _____
Date _____ Contractor _____
(Signature)

OWNER - BUILDER DECLARATION

I hereby affirm under penalty of perjury that I am exempt from the Contractors License Law for the following reason (Sec. 7031.5, Business and Professions Code: Any city or county which requires a permit to construct, alter, improve, demolish, or repair any structure, prior to its issuance, also requires the applicant for such permit to file a signed statement that he or she is licensed pursuant to the provisions of the Contractors License Law (Chapter 9 (commencing with Section 7000) of Division 3 of the Business and Professions Code) or that he or she is exempt therefrom and the basis for the alleged exemption. Any violation of Section 7031.5 by any applicant for a permit subjects the applicant to a civil penalty of not more than five hundred dollars (\$500.00):

I, as owner of the property, or my employees with wages as their sole compensation, will do the work, and the structure is not intended or offered for sale (Sec. 7044, Business and Professions Code: The Contractors License Law does not apply to an owner of property who builds or improves thereon, and who does such work himself or herself or through his or her own employees, provided that such improvements are not intended or offered for sale. If, however, the building or improvement is sold within one year of completion, the owner-builder will have the burden of proving that he or she did not build or improve for the purpose of sale.)

I as owner of the property, am exclusively contracting with licensed contractors to construct the project (Sec. 7044, Business and Professions Code: The Contractors License Law does not apply to an owner of property who builds or improves thereon, and who contracts for such projects with a contractor(s) licensed pursuant to the Contractors License Law).

I am exempt under Sec. _____ B & P for this reason
Date 5/21/03 Parkview Property Services
Owner Parkview Property Services
(Signature) by Tessa Ferris

In issuing this building permit, the applicant represents, and the City relies on the representation of the applicant, that the applicant verified all measurements and locations shown on the application or accompanying drawings and that the improvement to be constructed does not violate any law or private agreement relating to permissible or prohibited locations for such improvements. This building permit does not authorize any illegal location of any improvement or the violation of any private agreement relating to location of improvements.

I certify that I have read this application and state that all information is correct. I agree to comply with all city and county ordinances and state laws relating to building construction and hereby authorize representative of this city to enter upon the abovementioned property for inspection purposes.

Date 5/1/03 Tessa Ferris
Signature of Applicant or Agent

SITE ADDRESS 727 T STREET SUITE _____ INSP. AREA 1

ASSESSOR PARCEL NO. 009064-010003 ADDRESS 727 T ST. SAC TO PERMIT NO. 0309210 PHONE NO. _____

LICENSED CONTRACTOR _____ NAME OF APPLICANT _____ BUSINESS OWNER Parkview Property Services ZIP CODE _____

BUSINESS OWNER Parkview Property Services ADDRESS 727 T ST. SAC TO PERMIT NO. 0309210 PHONE NO. (916) 443-4464

SIGN INFORMATION

- ATTACHED
- ILLUMINATED
- INDIVIDUAL LETTERS
- METAL
- PLASTIC
- WOODEN
- INTERIOR / ELECT.
- NON-ILLUMINATED
- PAINTED ON BUILDING
- POLE
- MOUNTMENT
- PROJECTING
- SINGLE FACED
- BILLBOARD / SUBDIVISION
- LOGO
- DOUBLE FACED
- VINYL/GATOR FOAM
- RE-FACE

SIGN COPY Parkview Property Services

Parkview Property Services
subject
CITY OF SACRAMENTO PERMIT SERVICES
BUILDING INSPECTION DIVISION 264-7619

WORKER'S COMPENSATION DECLARATION

I hereby affirm under penalty of perjury one of the following declarations:

I have and will maintain a certificate of consent to self-insure for workers' compensation as provided for by Section 3700 of the Labor Code, for the performance of work for which the permit is issued.

I have and will maintain workers' compensation insurance, as required by Section 3700 of the Labor Code, for the performance of the work for which this permit is issued. My workers' compensation insurance carrier and policy number are:

Carrier PAID
Policy Number CITY OF SACRAMENTO

(This section shall be completed if the permit is for one hundred dollars (\$100) or less) I certify that in the performance of the work for which this permit is issued I shall not employ any person in any manner so as to become subject to the workers' compensation laws of California and agree that if I should become subject to the workers' compensation provisions of Section 3700 of the Labor Code, I shall forthwith comply with those provisions.

Date: _____ Applicant: _____ (Signature)

WARNING: FAILURE TO SECURE WORKERS' COMPENSATION COVERAGE IS UNLAWFUL AND SHALL SUBJECT AN EMPLOYER TO CRIMINAL PENALTIES AND CIVIL FINES UP TO ONE HUNDRED THOUSAND DOLLARS (\$100,000) IN ADDITION TO THE COST OF COMPENSATION, DAMAGES AS PROVIDED FOR IN SECTION 3706 OF THE LABOR CODE, INTEREST AND ATTORNEY'S FEES.

THIS PERMIT SHALL EXPIRE BY LIMITATION IF WORK AUTHORIZED IS NOT COMMENCED WITHIN 180 DAYS.

(A) HEIGHT 6'4" (B) LENGTH 2'6" X 4'6"
(A X B) SIGN AREA 6'4" X 25' FOOTING SIZE REFR TO P4
POLE SIZE _____
STREET FRONTAGE (FT) 25' OCCUPANCY FRONTAGE (FT) 20'

OFFICE USE ONLY

ENGINEERING REQUIRED? YES NO APPROVED BY _____
DESIGN REVIEW REQUIRED? YES NO APPROVED BY _____
SPECIAL PERMIT REQUIRED? YES NO PER _____
VARIANCE REQUIRED? YES NO PER _____
LOCATED IN PUD? YES NO WHICH PUD? _____

SIGN VALUATION

A. TYPE OF SIGN Sign Structures SQ. FT. = \$ _____
B. \$ _____ PER SQ. FT. X _____ SQ. FT. = \$ _____
APPROVED BY my DATE 7/2/03
DENIED BY _____ DATE _____

FINAL INSPECTIONS

BUILDING INSPECTOR DSP DATE 9.9.03
ELECTRICAL INSPECTOR _____ DATE _____
SIGN INSPECTOR _____ DATE _____

FEES: RECEIVED DATE AMOUNT

SIGN APPLICATION FEE	
SIGN PERMIT FEE	
ELECTRICAL SIGN FEE	
CITY BUSINESS LICENSE	
OTHER	
TOTAL FEES	\$

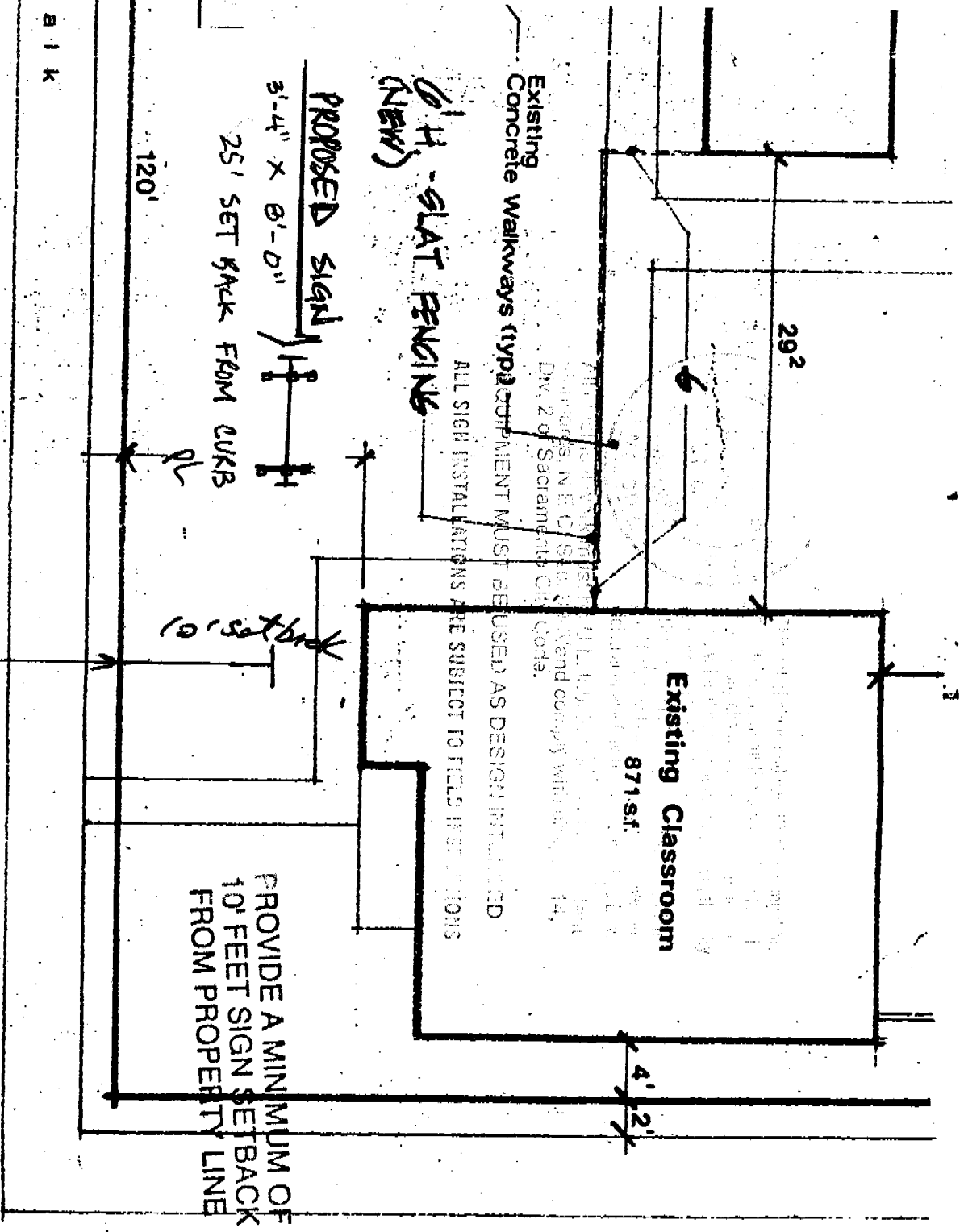

alk

SCALE: 1" = 10'

Northwest corner of 8th Street and T Street Sacramento

PARKVIEW PRESBYTERIAN CHURCH

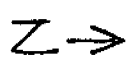

SITE PLAN

CITY COPY

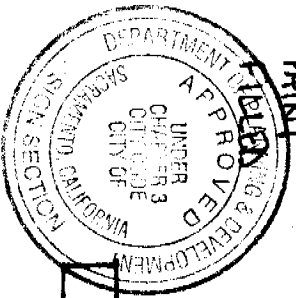

LETTERS
CARVED
INTO 3/4"
2x12

PAINT

RWD
NOTICE
BOARD
1'-6" x
2'-6"

This set of plans and specifications must be kept on file for the duration of the project. Any changes or alterations to the plans must be made in writing and approved by the City Engineer. The approval of this plan and specification is given on the condition that the contractor shall be held responsible for the proper installation of the sign.

PARKVIEW
PRESBYTERIAN
CHURCH



NON-ILLUMINATED

ALL REDWOOD MATERIALS

Scale 1" = 1'-0"

1095

20" 3/4

8'-0"

2x4

1x8

4x4

2x2

2x4

28" 48"

6'-0"

RWD
2"x12"

6'-4"
6'-4"
20"

All electrical work must be done in accordance with the City of Sacramento Electrical Code, Chapter 2 of Sacramento Code. Equipment must be listed and labeled at the time of installation. ALL SIGN INSTALLATIONS SHALL BE IN ACCORDANCE WITH THE CITY OF SACRAMENTO SIGN REGULATIONS.

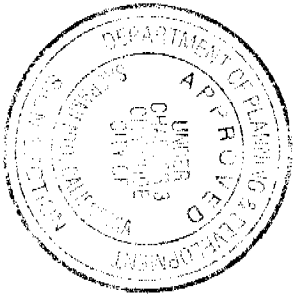

All electrical work must be U.L. listed and conform to the code of the City of New York, N.E.C. Sec. 90.6 and all other applicable codes, Div. 2 of Department City Code.

EQUIPMENT MUST BE USED AS LISTED
ALL SIGN HEIGHTS SHOWN ARE SEVERAL

This set of plans and specifications must be kept on file for all electrical work to be done to make any changes or alterations to the same without written permission from the City of New York, Department of Planning and Development.

The approval of this plan and specification shall not be held responsible for any violation of the City Code.

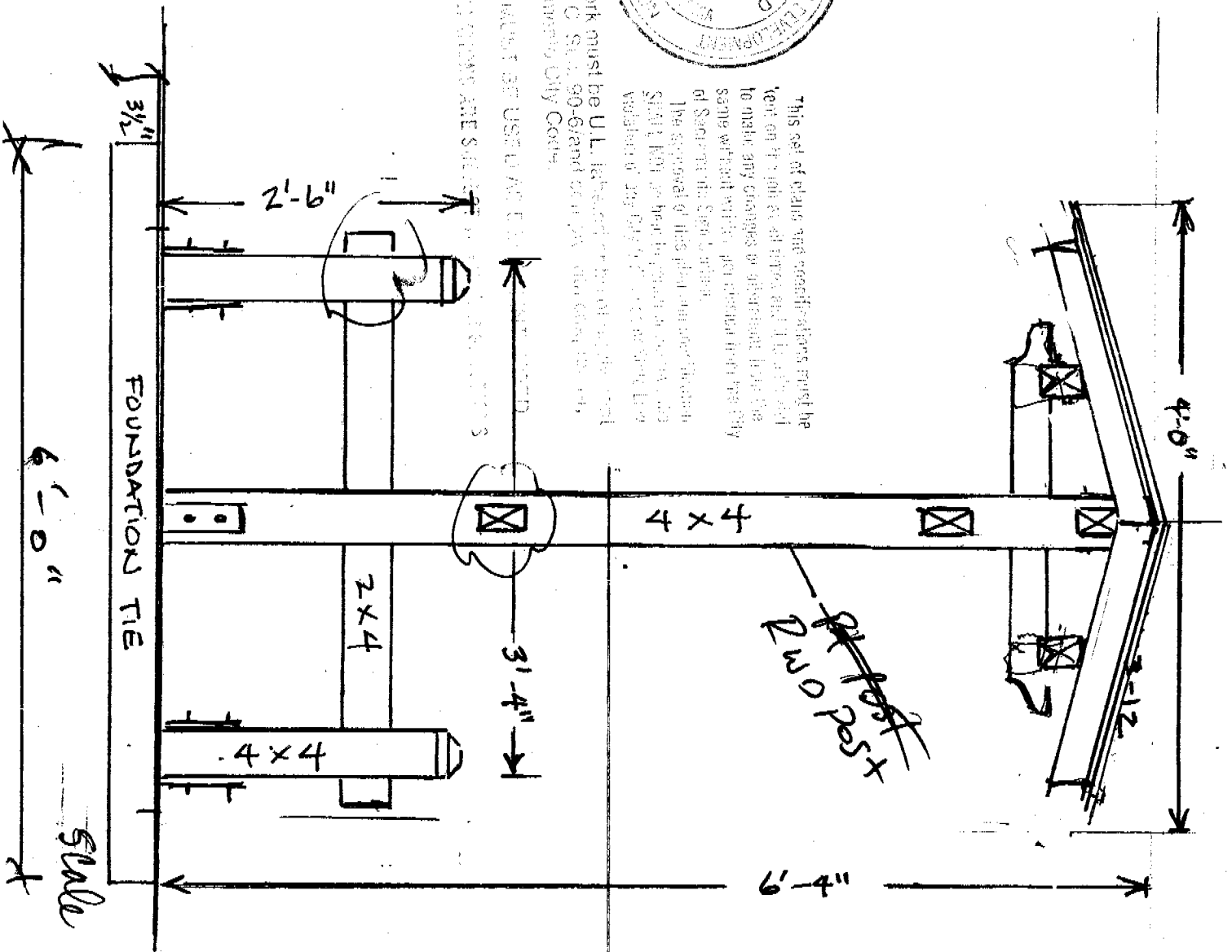

SCALE 1" = 1'-0" 2 of 5

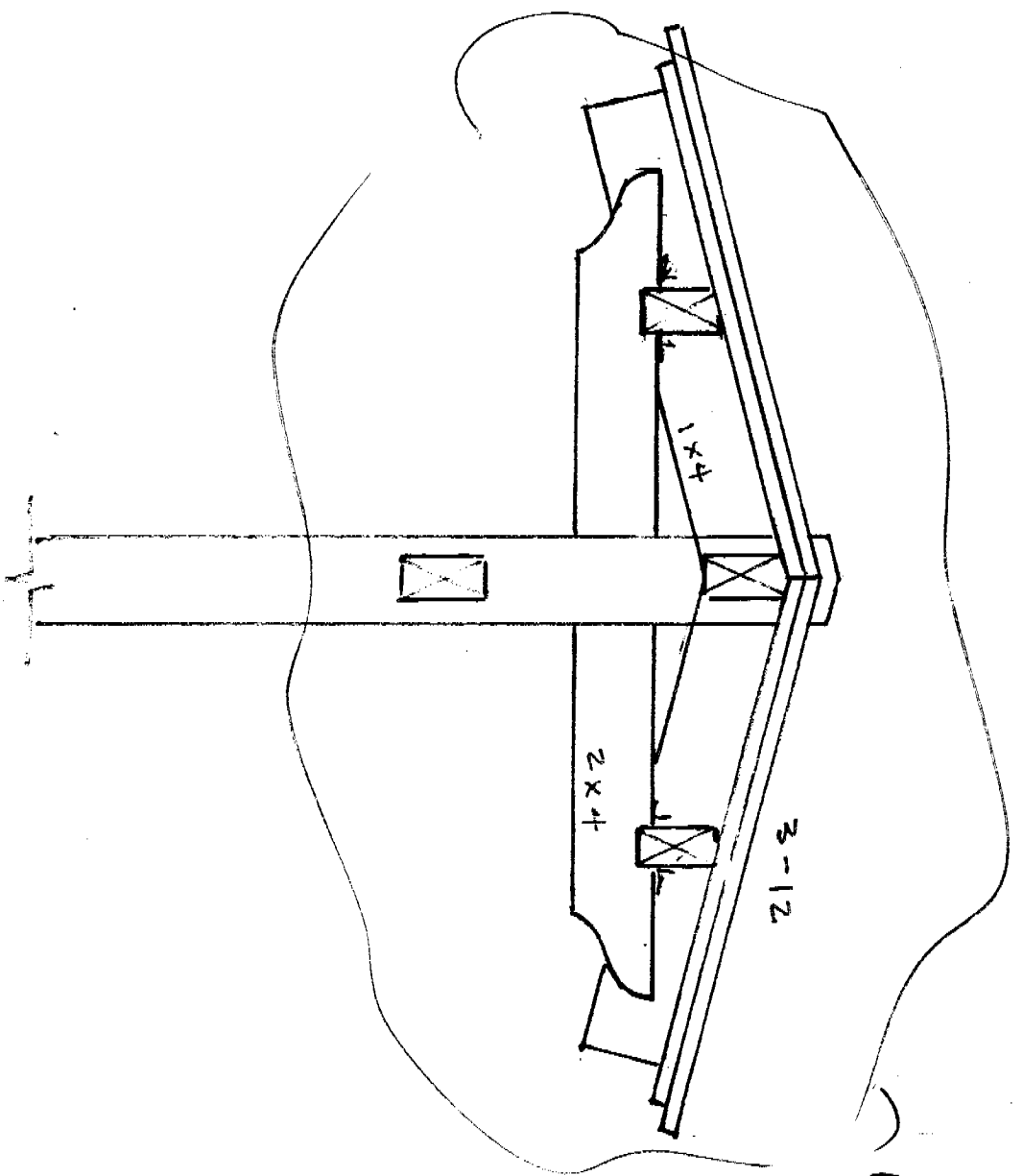

Revised

ROOF FRAME DETAIL.

SCALE 1/2" = 1'-0"

3 of 5

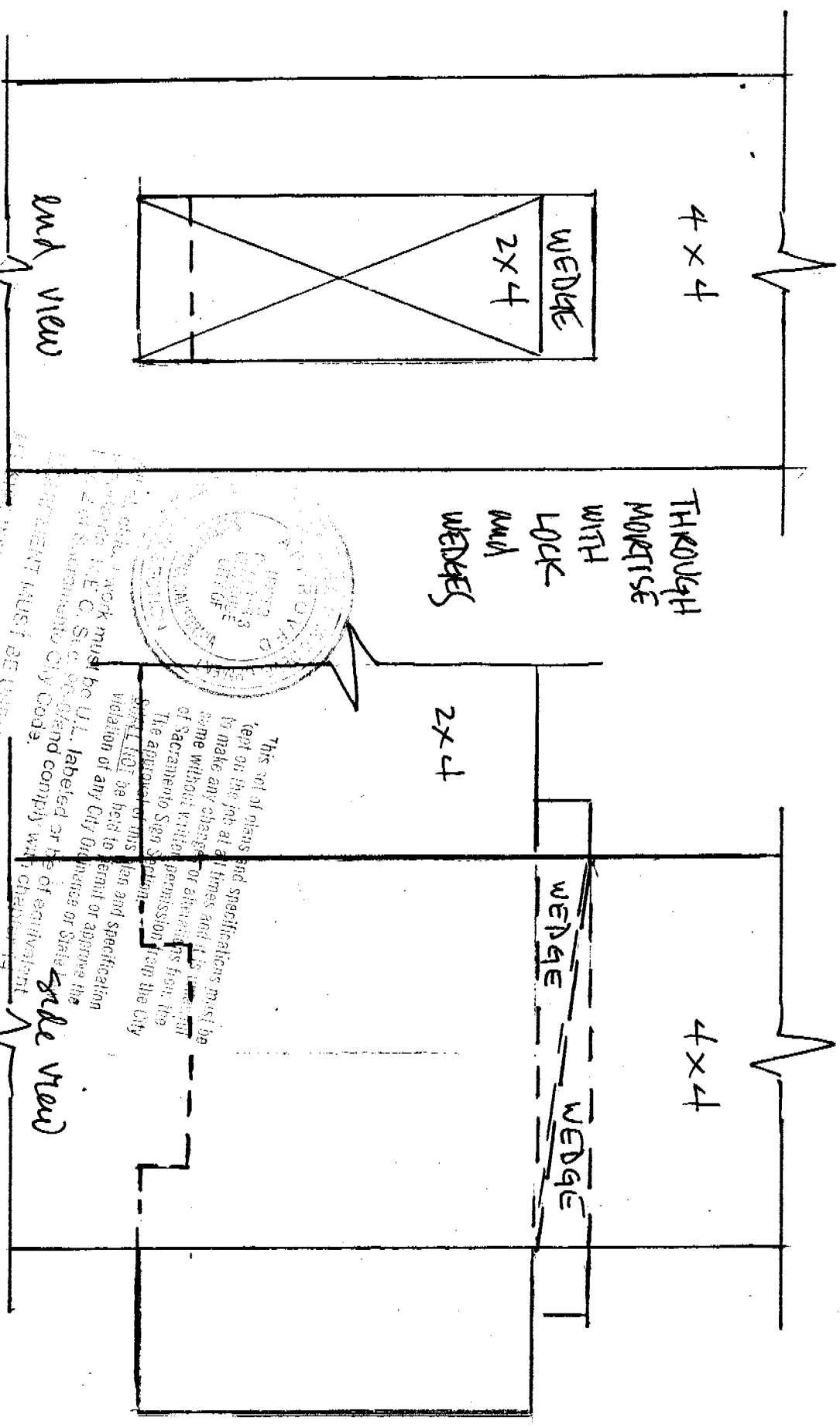

4x4
 WEDGE
 2x4

END VIEW

THROUGH MORTISE WITH LOCK WEDGES

2x4

WEDGE WEDGE

4x4

side view

JOINT DETAIL (top)

2x4

scale 3/4" = 1"

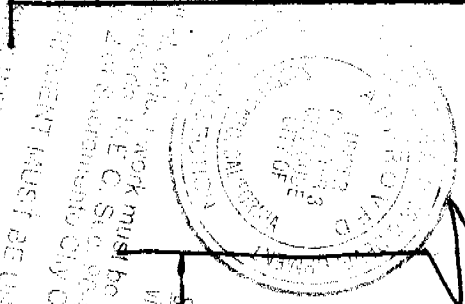

THIS SET OF PLANS AND SPECIFICATIONS MUST BE KEPT ON THE JOB AT ALL TIMES AND IT IS TO REMAIN THE SAME WITHOUT CHANGE OR ADDITION WITHOUT THE WRITTEN PERMISSION FROM THE ARCHITECT OR HIS REPRESENTATIVE. THE APPROVAL OF THIS PLAN AND SPECIFICATION VIOLATION OF ANY CITY ORDINANCE OR STATE LAW SHALL BE HELD TO BE A VIOLATION OF ANY CITY ORDINANCE OR STATE LAW. CONTRACTORS MUST BE U.L. LABELED OR BE OF EQUIVALENT QUALITY AND COMPLY WITH CHAPTER 19, DIVISION 5, SECTION 05100. CONTRACTORS ARE RESPONSIBLE FOR OBTAINING ALL NECESSARY PERMITS AND INSPECTIONS.