

CITY OF SACRAMENTO
1231 I Street, Sacramento, CA 95814

Permit No: 0405077
Insp Area: 4
Thos Bros: 257-C5

Site Address: 1457 DREAMY WY SAC
Parcel No: 201-0800-083
N

NORTHPOINTE PARK VIL. 22 LOT 42

Sub-Type: NSFR
Housing (Y/N):

CONTRACTOR
LENNAR RENAISSANCE INC
2240 DOUGLAS BL
ROSEVILLE, CA 95661

OWNER

ARCHITECT

Nature of Work: MP 324 X 2 STORY 10 ROOM SFR

CONSTRUCTION LENDING AGENCY : I hereby affirm under penalty of perjury that there is a construction lending agency for the performance of the work for which this permit is issued (Sec. 3097, Civ. C).

Lender's Name _____ Lender's Address _____

LICENSED CONTRACTORS DECLARATION: I hereby affirm under penalty of perjury that I am licensed under provisions of Chapter 9 (commencing with section 7000) of Division 3 of the Business and Professions Code and my license is in full force and effect.

License Class B License Number 732348 Date _____ Contractor Signature [Signature]

OWNER-BUILDER DECLARATION: I hereby affirm under penalty of perjury that I am exempt from the contractors License Law for the following reason (Sec. 7031.5, Business and Professions Code; any city or county which requires a permit to construct, alter, improve, demolish, or repair any structure, prior to its issuance, also requires the applicant for such permit to file a signed statement that he or she is licensed pursuant to the provisions of the Contractors License Law (Chapter 9 (commencing with Section 7000) of Division 8 of the Business and Professions Code) or that he or she is exempt therefrom and the basis for the alleged exemption. Any violation of Section 7031.5 by any applicant for a permit subjects the applicant to a civil penalty of not more than five hundred dollars (\$500.00);

I, as a owner of the property, or my employees with wages as their sole compensation, will do the work, and the structure is not intended or offered for sale (Sec. 7044, Business and Professional Code: The Contractors License Law does not apply to an owner of property who builds or improves thereon, and who does such work himself or herself or through his/her own employees, provided that such improvements are not intended or offered for sale. If, however, the building or improvement is sold within one year of completion, the owner-builder will have the burden of proving that he/she did not build or improve for the purpose of sale.)

I, as owner of the property, am exclusively contracting with licensed contractors to construct the project (Sec. 7044, Business and Professions Code: The Contractors License Law does not apply to an owner of property who builds or improves thereon, and who contracts for such projects with a contractor(s) licensed pursuant to the Contractors License Law).

I am exempt under Sec. _____ B & PC for this reason: _____

Date _____ Owner Signature _____

PAID
CITY OF SACRAMENTO
APR 16 2004
BUILDING PERMIT

IN ISSUING THIS BUILDING PERMIT, the applicant represents, and the city relies on the representation of the applicant, that the applicant verified all measurements and locations shown on the application or accompanying drawings and that the improvement to be constructed does not violate any law or private agreement relating to permissible or prohibited locations for such improvements. This building permit does not authorize any illegal location of any improvement or the violation of any private agreement relating to location of improvements.

I certify that I have read this application and state that all information is correct. I agree to comply with all city and county ordinances and state laws relating to building construction and hereby authorize representative(s) of this city to enter upon the abovementioned property for inspection purposes.

Date 4-16-04 Applicant/Agent Signature [Signature]

WORKER'S COMPENSATION DECLARATION: I hereby affirm under penalty of perjury one of the following declarations:

I have and will maintain a certificate of consent to self-insure for workers' compensation as provided for by Section 3700 of the Labor Code, for the performance of work for which the permit is issued.

I have and will maintain workers' compensation insurance, as required by Section 3700 of the Labor Code, for the performance of the work for which this permit is issued. My workers' compensation insurance carrier and policy number are:

Carrier OLD REPUBLIC INS. CO. Policy Number MWC10845400 Exp Date 11/01/2004

(This section need not be completed if the permit is for \$100 or less) I certify that in the performance of the work for which this permit is issued, I shall not employ any person in any manner so as to become subject to the workers' compensation laws of California and agree that if I should become subject to the workers' compensation provisions of Section 3700 of the Labor Code, I shall forthwith comply with those provisions.

Date 4-16-04 Applicant Signature [Signature]

WARNING: FAILURE TO SECURE WORKER'S COMPENSATION COVERAGE IS UNLAWFUL AND SHALL SUBJECT AN EMPLOYER TO CRIMINAL PENALTIES AND CIVIL FINES UP TO ONE HUNDRED THOUSAND DOLLARS (\$100,000) IN ADDITION TO THE COST OF COMPENSATION, DAMAGES AS PROVIDED FOR IN SECTION 3706 OF THE LABOR CODE, INTEREST AND ATTORNEY'S FEE.

THIS PERMIT SHALL EXPIRE BY LIMITATION IF WORK IS NOT COMMENCED WITHIN 180 DAYS.

plot plan

THIS PLOT PLAN IS FOR THE PURPOSE OF SHOWING THE HOUSE TO BE CONSTRUCTED ON THE LOT AND MAY NOT REPRESENT THE FINAL AS-BUILT CONFIGURATION OF THE PROPERTY OR IMPROVEMENTS THEREON. THE ACCURACY OF THIS PLOT PLAN IS NOT GUARANTEED, NOR IS IT A PART OF ANY POLICY, REPORT OR GUARANTEE TO WHICH IT MAY BE ATTACHED. ACTUAL DIMENSIONS, OTHER THAN MINIMUM ORDINANCE, MAY VARY OR CHANGE WITHOUT PRIOR NOTICE, DUE TO ACTUAL SITE CONDITIONS.

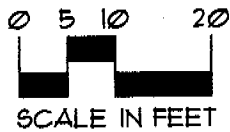

HOMESITE
43
PAD=15.8

HOMESITE
42
4725± SQ. FT.

HOMESITE
41
PAD=15.4

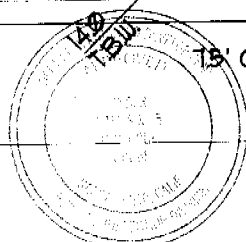
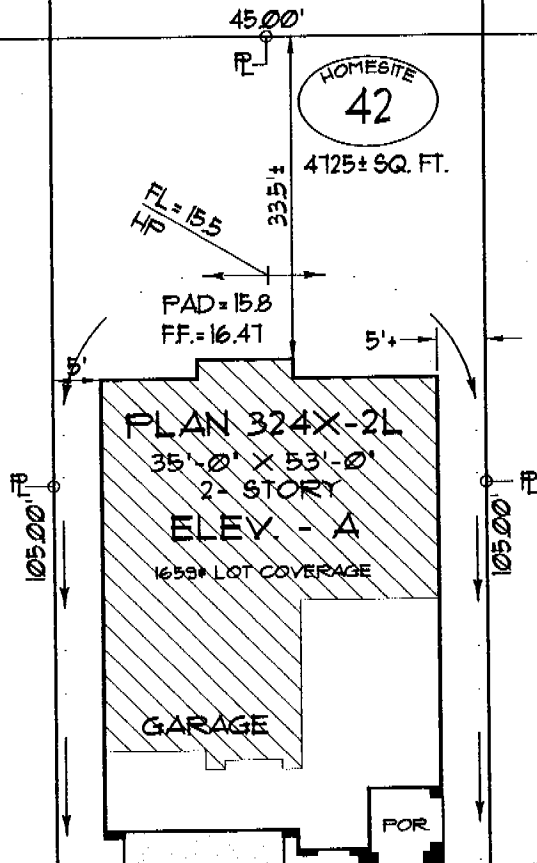

This set of plans and specifications must be kept on the job at all times and it is unlawful to make any changes or alterations from the same without written permission from the Building Inspection Division.

DREAMY WAY
SHALL NOT be held to permit or approve the violation of any City Ordinance or State Law.

lot coverage LOT AREA: 4725± # BUILDING: 1659 # BLDG./ LOT AREA: 35 %		retaining wall HEIGHT: _____ LENGTH: _____ DISTANCE FROM P.L.: _____		symbols legend DROP INLET: ELECTRIC SERVICE BOX: FIRE HYDRANT: FLOW LINE HIGH POINT: FL #23.4 GAS SERVICE: PAD-MOUNT TRANSFORMER: SEWER SVC.: STREET LIGHT: TOP-BACK OF SIDEWALK ELEV.: 123.4 TBW SWALE (FLOW DIRECTION): WATER SVC.: EXTENTS OF 2ND STORY LEVEL:		<p>Winncrest Homes</p> <p>AMBER LANE A REGENCY PARK COMMUNITY</p>	
general notes 1) DIMENSIONS ALONG CURVED LINES ARE CHORD LENGTHS, U.O.N. 2) SETBACK DIMENSIONS ARE ROUNDED DOWN TO NEAREST HALF UNIT, U.O.N. 3) FOOTPRINT AREA CALCULATIONS (#) ARE BASED ON PLAN DIMENSIONS ONLY AND DO NOT INCLUDE COVERED ENTRIES, PORCHES OR ARCHITECTURAL PROJECTIONS.							
5.2	BCB	3/1/04	20:1				
phase	drawn by	issue	scale				
<p>home site #42 1457 Dreamy Way NORTHPOINTE PARK VILLAGE 22 CITY OF SACRAMENTO, CALIFORNIA a.p.n.: 201-05800-083</p>							



INSULATION CONTRACTORS ASSOCIATION OF AMERICA

INSULATION CERTIFICATE
44634

1321 DUKE STREET, SUITE 303 • ALEXANDRIA, VA 22314 • (703) 739-0356

THIS IS TO CERTIFY THAT INSULATION HAS BEEN INSTALLED IN CONFORMANCE WITH CURRENT ENERGY REGULATIONS, CALIFORNIA ADMINISTRATIVE CODE, TITLE 24, STATE OF CALIFORNIA, IN THE BUILDING LOCATED AT:

1457 Economy Wy LOT # 14 TRACT # 44634

STREET 1457 Economy Wy CITY VA

EXTERIOR WALLS:

MANUFACTURER F THICKNESS/TYPE 2 R-VALUE 5

CEILINGS:

BATTS: MANUFACTURER 1 THICKNESS/TYPE 1 R-VALUE 3.5

BLOWN IN: MANUFACTURER CT THICKNESS 14 3/4 R-VALUE 3.5

SQUARE FOOTAGE COVERED 1157 NUMBER OF BAGS USED 39

FLOORS: MANUFACTURER _____ THICKNESS/TYPE _____ R-VALUE _____

SLAB ON GRADE: MANUFACTURER _____ THICKNESS/TYPE _____ R-VALUE _____

WIDTH OF INSULATION _____ INCHES

FOUNDATION WALLS: MANUFACTURER _____ THICKNESS/TYPE _____ R-VALUE _____

GENERAL CONTRACTOR _____ CALIFORNIA CONTRACTORS LICENSE # _____ DATE _____

SIGNATURE _____ TITLE _____

INSULATION CONTRACTOR **ARCADE INSULATION** CALIFORNIA CONTRACTORS LICENSE #815286 NEVADA CONTRACTORS LICENSE #55201 DATE 3-11-08

SIGNATURE [Signature] TITLE _____

Project Address: 1457 DREAMY WAY
Lot Number: 42

Assessor Parcel # 201-0800-083
Subdivision NORTHPOINTE PARK VILLAGE 22

OWNER INFORMATION:

Legal Property Owner: WINNCREST HOMES Phone# 773-7471
Owner Address: 1075 CREEKSIDE RIDGE DR City ROSEVILLE State CA Zip 95678

CONTRACTOR INFORMATION:

Contractor: WINNCREST Lic. # 732348 Phone # 773-7471 Fax _____

PROJECT INFORMATION:

Land Use Zone R1A Occupancy Group R3 Construction Type VN Fed Code 1A
No. of Stories: TWO No. of Rooms: _____ Street Width: 40'
1st Floor Area 1262 2nd Floor Area 1095 Basement N/A Roof Material TILE
AREA IN SQUARE FOOT OF:
Dwelling/Living 2357
Garage/Storage 420
Decks/Balconies _____
Carports _____

SCOPE OF WORK: NEW S.F. 0
M.P. # 3247

- Information Above Complete
 - Violation Files Checked
 - Standard Setbacks
 - County Sewer
 - AR Flood Waiver Required
 - Flood Elevation Certificate Required
 - Water Development Infill Area
 - Planning Approval
 - Design Review Approval
 - Special Fee Districts Apply:
- ~THE FOLLOWING MUST BE PROVIDED IN ORDER TO SUBMIT FOR PERMIT~
- 2 COMPLETE PLOT PLANS, LEGIBLE & DRAWN TO SCALE
 - 11 X 17 COPY OF FLOOR PLAN WITH FOLLOWING INFORMATION
 - a) Assessor's Parcel Number
 - b) New Floor Area
 - c) Owners Name
 - d) Project Address

Date: _____ Received by: _____



DEPARTMENT OF
UTILITIES

FIELD SERVICES
DIVISION
Water Distribution- Meter Shop

CITY OF SACRAMENTO
CALIFORNIA

5730 24th St. Bldg. 8
SACRAMENTO, CA
95822-3699

PH 916-433-6229
FAX 916-433-4036

To our customer:

Due to a supply problem, we will be using this document to substitute for an actual meter. This document may be shown to your inspector as proof that the City Of Sacramento is aware that you have purchased a meter and it will be installed as soon as possible.

Meter Address: 1457 Deamy Wy #42

Utilities Leadworker: Chuck Barsuglia

Cell Phone: 798 4737

Date: 9-20-04

KwikKote

No. 200-920988

Stucco System Installation Card

Job Name: AMBER LANE @ REGENCY PARK
Address: 1457 DREAMY WAY
SACRAMENTO,
Lot #: 0042-22

Stucco System Trade Name: KWIK KOTE
Stucco System Manufacturer: KWIK KOTE CORP.

ICBO Evaluation Service, Inc.
Report No. 3607
Date of Job Completion:

Home Builder: LENNAR RENAISSANCE/WINNCREST

Address: 1075 Creekside Ridge Dr. #100
ROSEVILLE, CA

Stucco Contractor: KENYON PLASTERING, INC.
Address: PO BOX 2077
North Highlands, CA

Telephone Number: 916/349-8191

Approved Contractor Number as
issued by the Stucco Manufacturer: 1001

Card Print Date: 09/30/2004

This is to certify that the stucco system on the building exterior at the above address had been installed in accordance with the evaluation report specified above and the manufacturer's instructions.

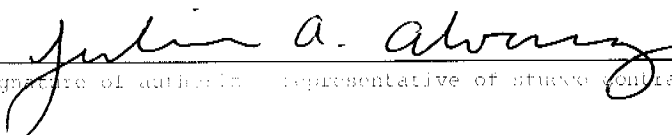

Signature of authorized representative of stucco contractor

9-30-04

Date