

CITY OF SACRAMENTO
1231 I Street, Sacramento, CA 95814

Permit No: 0013282

Insp Area: 1

Site Address: 1308 P ST SAC

Sub-Type: NSFR

Parcel No: 006-0284-032

CAPITOL PARK HOMES LOT 22 Housing (Y/N): N

CONTRACTOR

CAPITOL PARK HOMES
818 19TH ST STE 200
SACRAMENTO CA 95814

OWNER

STATE OF CALIFORNIA
800 Q ST
SACRAMENTO CA 95814

ARCHITECT

Nature of Work: MP 1757 3 STORY 7 ROOM SFR

CONSTRUCTION LENDING AGENCY: I hereby affirm under penalty of perjury that there is a construction lending agency for the performance of the work for which this permit is issued (Sec. 3097, Civ. Cl.)

Lender's Name _____ Lender's Address _____

LICENSED CONTRACTORS DECLARATION: I hereby affirm under penalty of perjury that I am licensed under provisions of Chapter 9 commencing with section 7000 of Division 3 of the Business and Professions Code and my license is in full force and effect.

License Class B License Number 267067 Date 4-19-01 Contractor Signature [Signature]

OWNER-BUILDER DECLARATION: I hereby affirm under penalty of perjury that I am exempt from the contractors License Law for the following reason (Sec. 7031.5, Business and Professions Code): any city or county which requires a permit to construct, alter, improve, demolish, or repair any structure, prior to its issuance, also requires the applicant for such permit to file a signed statement that he or she is licensed pursuant to the provisions of the Contractors License Law (Chapter 9 commencing with Section 7000) of Division 8 of the Business and Professions Code) or that he or she is exempt therefrom and the basis for the alleged exemption. Any violation of Section 7031.5 by any applicant for a permit subjects the applicant to a civil penalty of not more than five hundred dollars (\$500.00).

I, as a owner of the property, or my employees with wages as their sole compensation, will do the work, and the structure is not intended or offered for sale (Sec. 7044, Business and Professions Code). The Contractors License Law does not apply to an owner of property who builds or improves thereon, and who does such work himself or herself or through his/her own employees, provided that such improvements are not intended or offered for sale. If, however, the building or improvement is sold within one year of completion, the owner-builder will have the burden of proving that he/she did not build or improve for the purpose of sale.

I, as owner of the property, am exclusively contracting with licensed contractors to construct the project (Sec. 7044, Business and Professions Code). The Contractors License Law does not apply to an owner of property who builds or improves thereon, and who contracts for such projects with a contractor(s) licensed pursuant to the Contractors License Law.

I am exempt under Sec. _____ B & Pt. for this reason: _____

Date _____ Owner Signature _____

IN ISSUING THIS BUILDING PERMIT, the applicant represents, and the city relies on the representation of the applicant, that the applicant verified all measurements and locations shown on the application or accompanying drawings and that the improvement to be constructed does not violate any law or private agreement relating to permissible or prohibited locations for such improvements. This building permit does not authorize any illegal location of any improvement or the violation of any private agreement relating to location of improvements.

I certify that I have read this application and state that all information is correct. I agree to comply with all city and county ordinances and state laws relating to building construction and hereby authorize representative(s) of this city to enter upon the abovementioned property for inspection purposes.

Date 4-19-01 Applicant Agent Signature [Signature]

WORKER'S COMPENSATION DECLARATION: I hereby affirm under penalty of perjury one of the following declarations:

I have and will maintain a certificate of consent to self-insure for workers' compensation as provided for by Section 3700 of the Labor Code, for the performance of work for which the permit is issued.

I have and will maintain workers' compensation insurance, as required by Section 3700 of the Labor Code, for the performance of the work for which this permit is issued. My workers' compensation insurance carrier and policy number are:

Carrier Binder Policy Number _____ Exp Date _____

(This section need not be completed if the permit is for \$100 or less.) I certify that in the performance of the work for which this permit is issued, I shall not employ any person in any manner so as to become subject to the workers' compensation laws of California and agree that if I should become subject to the workers' compensation provisions of Section 3700 of the Labor Code, I will forthwith comply with those provisions.

Date 4-19-01 Applicant Signature [Signature]

WARNING: FAILURE TO SECURE WORKER'S COMPENSATION COVERAGE IS UNLAWFUL AND SHALL SUBJECT AN EMPLOYER TO CRIMINAL PENALTIES AND CIVIL FINES UP TO ONE HUNDRED THOUSAND DOLLARS (\$100,000) IN ADDITION TO THE COST OF COMPENSATION, DAMAGES AS PROVIDED FOR IN SECTION 3706 OF THE LABOR CODE, INTEREST AND ATTORNEY'S FEE.

THIS PERMIT SHALL EXPIRE BY LIMITATION IF WORK IS NOT COMMENCED WITHIN 180 DAYS.

RESIDENTIAL SUBDIVISION BUILDING PERMIT APPLICATION 0013282 Plan 4

Project Address: 1308 P Street
Lot Number: 22

Assessor Parcel # 006-0284-032
Subdivision CAPITOL PARK HOMES

OWNER INFORMATION:

Legal Property Owner: SHASTA/DOWNTOWN SINGLE FAM Phone# 449-8989
Owner Address: 818 19th ST City SACRAMENTO State CA Zip 95814

CONTRACTOR INFORMATION:

Contractor: CNM CONST. Lic. # 767087 Phone # 449-8989 Fax 449-8865

PROJECT INFORMATION:

Land Use Zone RIA Occupancy Group R3 Construction Type VN Fed Code 1A
No. of Stories: 3 No. of Rooms: 11 Street Width: 20
1st Floor Area 1259 2nd Floor Area 488 Basement - Roof Material COMP

AREA IN SQUARE FOOT OF:

Dwelling/Living 1747
Garage/Storage 496/684
Decks/Balconies 84
Carports -

SCOPE OF WORK: NEW SINGLE FAMILY RESIDENCE

- Information Above Complete
- Violation Files Checked
- Standard Setbacks
- County Sewer
- AR Flood Waiver Required
- Flood Elevation Certificate Required
- Water Development Infill Area
- Planning Approval
- Design Review Approval
- Special Fee Districts Apply:

THE FOLLOWING MUST BE PROVIDED IN ORDER TO SUBMIT FOR PERMIT

- 2 COMPLETE PLOT PLANS, LEGIBLE & DRAWN TO SCALE
- 11 X 17 COPY OF FLOOR PLAN WITH FOLLOWING INFORMATION
 - a) Assessor's Parcel Number
 - b) New Floor Area
 - c) Owners Name
 - d) Project Address

Date: _____ Received by: (staff) _____ Permit # _____

FOR OFFICE USE ONLY

Certification of Compliance
School District Development

Part I—To be completed by the APPLICANT

Owner's Name/Address CHASTA MOUNTAIN SINGLE FAMILY DEV LLC
Project Address 1308 P ST
Parcel Number 006-0224-032 Lot No. 22
Subdivision Name CAPITAL PARK HOMES No. of Units _____
Applicant's Signature [Signature] Title PWI
Phone No. 762-4801 Date 4-5-01

Notice to Applicant: Pursuant to Government Code Section 66020(d), this will serve to notify you that the 90-day approval period in which you may protest the fees or other payment identified above will begin to run on the date in which the building or installation permit for this project is issued or on which they are paid to the district(s) or to another public entity authorized to collect them on behalf of the district(s), whichever is earlier.

Part II—To be completed by the BUILDING DEPARTMENT

Plan Identification Number 1747
Building Type (check one) Residential Apartment/Condominium Commercial/Industrial
Square Feet of Chargeable Building Area 1747
Signature/Title [Signature] Date 4-5-01

Part III—To be completed by the SCHOOL DISTRICT

School District 22222 Certificate No. 7035
 Exempt Comments \$432.22 per unit for development A
Residential/Apartment/etc. _____ Square ft. x \$ 172 = \$ 432.22
Commercial/Industrial _____ Square ft. x \$ _____ = \$ _____
Total fees collected 445324 = \$ 432.22

This certification covers only the amount of square footage indicated above. Any additions or corrections to the square footage for this project will require an amendment to the Certificate of Compliance.

As the authorized school official, I hereby certify that the requirements of Government Code Section 65995 and any other authorized requirements have been complied with by the above signed applicant.

Signature [Signature] Date 4/18/01

CERTIFICATION OF INSULATION

PART I GENERAL
PART II AREAS INSULATED
PART III CERTIFICATION

ADDRESS OR TRACT <div style="font-size: 2em; font-weight: bold; margin-left: 20px;">CNM</div> <div style="margin-left: 150px;">LOT # 22</div>	SACRAMENTO INSULATION CONTRACTORS <input checked="" type="checkbox"/> P.O. BOX 854, WEST SACRAMENTO, CA 95691 LIC. #202026 <input type="checkbox"/> 1309 MELODY ROAD, MARYSVILLE, CA 95901 LIC. #202026 <input type="checkbox"/> P.O. BOX 9651, FRESNO, CA 93793-9651 LIC. #202026 <input type="checkbox"/> P.O. BOX 1631, RENO, NV 89505 LIC. #10675 <input type="checkbox"/> 3326 A PONDEROSA WAY, LAS VEGAS, NV 89118 LIC. #10675
CAPITOL PARK HOMES DATE INSULATION COMPLETED 10-23-01	

WALLS		CEILINGS			FLOORS	
(SQUARE FEET)		(SQUARE FEET)			(SQUARE FEET)	
TYPE OF INSULATION		TYPE OF INSULATION			TYPE OF INSULATION	
MATERIAL FIBERGLASS		MATERIAL FIBERGLASS			MATERIAL FIBERGLASS	
FORM BATTS		FORM BATTS & BLOW			FORM BATTS	
MANUFACTURER'S PRODUCT I.D.		MANUFACTURER'S PRODUCT I.D.			MANUFACTURER'S PRODUCT I.D.	
MANUFACTURER		MANUFACTURER			MANUFACTURER	
OCF		OCF			OCF	
BAGS						
R-VALUE INSTALLED	APPLIED THICKNESS	R-VALUE INSTALLED	APPLIED THICKNESS	MIN. INSTALLED WEIGHT PER SQUARE FOOT	R-VALUE INSTALLED	APPLIED THICKNESS
13	3 5/8"	30	9"			

KNEE WALLS IF R-VALUE IS OTHER THAN WALLS ABOVE

MATERIAL FIBERGLASS	FORM BATTS	R VALUE	MANUFACTURER OCF
----------------------------	-------------------	---------	-------------------------

AIR INFILTRATION SEALANT

MATERIAL FOAM	MANUFACTURER W R GRACE
----------------------	-------------------------------

THIS IS TO CERTIFY THAT INSULATION AND/OR SEALANT HAS BEEN INSTALLED IN CONFORMANCE WITH APPLICABLE CODES, MATERIAL STANDARDS AND REGULATIONS.

SIGNATURE - INSULATION CONTRACTOR <i>Jeff Cable</i>	TITLE MANAGER	DATE 10-24-01
SIGNATURE - GENERAL CONTRACTOR	TITLE	DATE

REMARKS:

22

P STREET

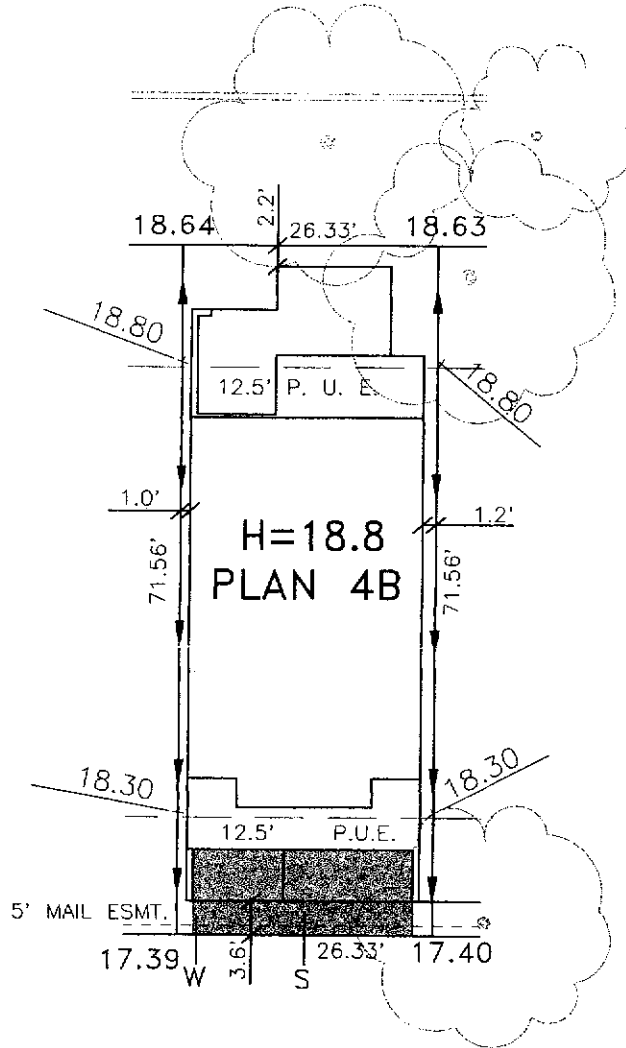

MOTOR COURT B

NOTE:

This plan is only intended to reference the building plan designated for this lot. All setbacks other than minimum code requirements are approximate. The "as-built" field condition may vary from this plan.

DATE: 10-06-00
 A.P.N.: 006-2840-032
 ADDRESS: 1308 P STREET

LOT AREA: 1,884 SF
 LOT COVERAGE: 68%

The Spink Corporation

2590 VENTURE OAKS WAY
 SACRAMENTO, CA. 95833

PH (916)925-5550 FAX (916)921-9274

CAPITOL PARK

LOT 22
 PLAN 4B

CAPITOL PARK

CITY OF SACRAMENTO, CA
 CLIENT: CNM CONSTRUCTION
 JOB NO.: 1222-002