

CITY OF SACRAMENTO
1231 I Street, Sacramento, CA 95814

Permit No: **0505858**
Insp Area: **2**
Thos Bros:
Sub-Type: NSFR
Housing (Y/N): N

Site Address: **310 STONE VALLEY CR SAC**
Parcel No: **BROOKFIELD MEADOWS UNIT # 2 LOT # 15**

CONTRACTOR
TIM LEWIS COMMUNITIES
5750 SUNRISE BLVD
CITRUS HEIGHTS 95610

OWNER

ARCHITECT

Nature of Work: **MP1518 1 STORY 6 RM SFR**

CONSTRUCTION LENDING AGENCY : I hereby affirm under penalty of perjury that there is a construction lending agency for the performance of the work for which this permit is issued (Sec. 3097, Civ. C).

Lender's Name _____ Lender's Address _____

LICENSED CONTRACTORS DECLARATION: I hereby affirm under penalty of perjury that I am licensed under provisions of Chapter 9 (commencing with section 7000) of Division 3 of the Business and Professions Code and my license is in full force and effect.

License Class B License Number 492827 Date 5.4.05 Contractor Signature [Signature]

OWNER-BUILDER DECLARATION: I hereby affirm under penalty of perjury that I am exempt from the contractors License Law for the following reason (Sec. 7031.5, Business and Professions Code; any city or county which requires a permit to construct, alter, improve, demolish, or repair any structure, prior to its issuance, also requires the applicant for such permit to file a signed statement that he or she is licensed pursuant to the provisions of the Contractors License Law (Chapter 9 (commencing with Section 7000) of Division 8 of the Business and Professions Code) or that he or she is exempt therefrom and the basis for the alleged exemption. Any violation of Section 7031.5 by any applicant for a permit subjects the applicant to a civil penalty of not more than five hundred dollars (\$500.00);

I, as a owner of the property, or my employees with wages as their sole compensation, will do the work, and the structure is not intended or offered for sale (Sec. 7044, Business and Professional Code: The Contractors License Law does not apply to an owner of property who builds or improves thereon, and who does such work himself or herself or through his/her own employees, provided that such improvements are not intended or offered for sale. If, however, the building or improvement is sold within one year of completion, the owner-builder will have the burden of proving that he/she did not build or improve for the purpose of sale.)

I, as owner of the property, am exclusively contracting with licensed contractors to construct the project (Sec. 7044, Business and Professions Code: The Contractors License Law does not apply to an owner of property who builds or improves thereon, and who contracts for such projects with a contractor(s) licensed pursuant to the Contractors License Law).

I am exempt under Sec. _____ B & PC for this reason: _____
Date _____ Owner Signature _____

PAID
CITY OF SACRAMENTO
MAY 04 2005

IN ISSUING THIS BUILDING PERMIT, the applicant represents, and the city relies on the representation of the applicant, that the applicant verified all measurements and locations shown on the application or accompanying drawings and that the improvement to be constructed does not violate any law or private agreement relating to permissible or prohibited locations for such improvements. This building permit does not authorize any illegal location of any improvement or the violation of any private agreement relating to location of improvements.

I certify that I have read this application and state that all information is correct. I agree to comply with all city and county ordinances and state laws relating to building construction and hereby authorize representative(s) of this city to enter upon the abovementioned property for inspection purposes.

Date 5.4.05 Applicant/Agent Signature [Signature]

WORKER'S COMPENSATION DECLARATION: I hereby affirm under penalty of perjury one of the following declarations:
I have and will maintain a certificate of consent to self-insure for workers' compensation as provided for by Section 3700 of the Labor Code, for the performance of work for which the permit is issued.

I have and will maintain workers' compensation insurance, as required by Section 3700 of the Labor Code, for the performance of the work for which this permit is issued. My workers' compensation insurance carrier and policy number are:

Carrier STATE FUND Policy Number 040-118-2004 Exp Date _____

(This section need not be completed if the permit is for \$100 or less) I certify that in the performance of the work for which this permit is issued, I shall not employ any person in any manner so as to become subject to the workers' compensation laws of California and agree that if I should become subject to the workers' compensation provisions of Section 3700 of the Labor Code, I shall forthwith comply with those provisions.

Date 5.4.05 Applicant Signature [Signature]

WARNING: FAILURE TO SECURE WORKER'S COMPENSATION COVERAGE IS UNLAWFUL AND SHALL SUBJECT AN EMPLOYER TO CRIMINAL PENALTIES AND CIVIL FINES UP TO ONE HUNDRED THOUSAND DOLLARS (\$100,000) IN ADDITION TO THE COST OF COMPENSATION, DAMAGES AS PROVIDED FOR IN SECTION 3706 OF THE LABOR CODE, INTEREST AND ATTORNEY'S FEE.

THIS PERMIT SHALL EXPIRE BY LIMITATION IF WORK IS NOT COMMENCED WITHIN 180 DAYS.

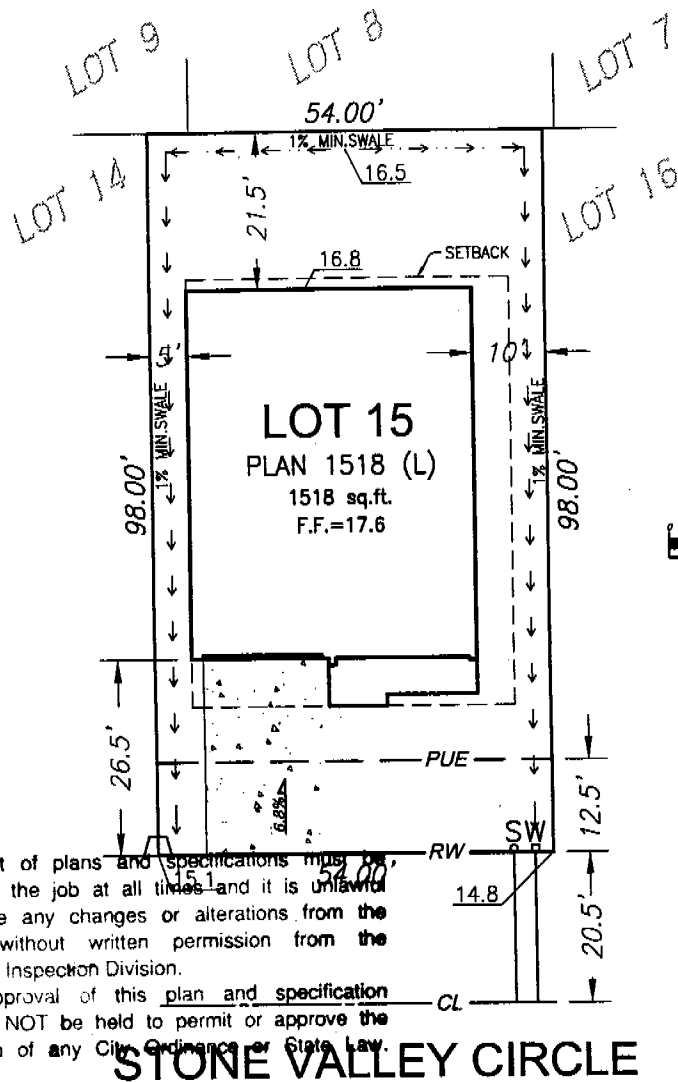

This set of plans and specifications must be kept on the job at all times and it is unlawful to make any changes or alterations from the same without written permission from the Building Inspection Division. The approval of this plan and specification SHALL NOT be held to permit or approve the violation of any City Ordinance or State Law.

STONE VALLEY CIRCLE

PLOT PLAN

BROOKFIELD MEADOWS UNIT NO.2

APN: _____ ADDRESS: **310 STONE VALLEY CIRCLE**
 HOME SITE #: **15** RESIDENCE: **1518** ELEV.: **A**
 ORIENTATION: **L** COLOR: **2** STYLE: **SP**
 HOME SITE: **5292 S.F. (.12ac.)** COVERAGE: **40.3%**

MINIMUM SETBACKS:

- FRONT - 20'
- SIDE - 5'
- REAR - 20'

LEGEND

- PROPERTY LINE
- PUE PUBLIC UTILITY EASEMENT
- RW RIGHT OF WAY
- YY SLOPE LINES
- SETBACK
- LP LOT PAD
- FF FINISHED FLOOR
- W WATER SERVICE
- S SEWER SERVICE
- SWALE (1% MIN.)
- ☒ STREET LIGHT
- ⦿ FIRE HYDRANT
- ⊠ TRANSFORMER
- ▢ DRY UTIL. SERV. NOTCH
- DRY UTIL. PULLBOX

NOTE: THIS PLOT IS PREPARED TO SHOW THE DIMENSIONAL RELATIONSHIP FROM BUILDING FOUNDATIONS TO PROPERTY LINE, DESIGN OF DRAINAGE CONTROL ELEVATIONS AND DIRECTION OF DRAINAGE FLOW TO CONFORM WITH LOCAL ORDINANCES FOR THE PURPOSE OF BUILDING PERMIT ISSUANCE ONLY. ANY DEVIATIONS FROM SLOPES SHOWN, GRADING ON LOT, AND SETBACK DIMENSIONS MADE BY THE PROPERTY OWNER MUST BE APPROVED BY THE CITY OF SACRAMENTO. THIS INFORMATION SHOWN IS APPROXIMATE, EXCEPT FOR SETBACKS, WHICH ARE MINIMUMS REQUIRED BY ORDINANCE. THIS PLOT PLAN DOES NOT REFLECT AS-BUILT CONDITIONS WHICH MAY VARY FROM THIS PLAN.

TIM LEWIS COMMUNITIES
 5750 SUNRISE BLVD., STE. 130
 CITRUS HEIGHTS, CALIFORNIA 95610
 (916) 966-8047
 LAST EDITED: 3/28/05

REV.1 _____
 REV.2 _____
 REV.3 _____
 APPROVED: _____

SIGNED (BUYER) _____ DATE: _____
 SIGNED (BUYER) _____ DATE: _____