

CITY OF SACRAMENTO
1231 I Street, Sacramento, CA 95814

Permit No: 0013712

Insp Area: 4

Site Address: 2785 CHATEAU MONTELENA WY SAC

Parcel No: 225-1160-097

Sub-Type: RES

Housing (Y/N):

CONTRACTOR

PREMIER POOLS AND SPAS
11250 PYRITES WY
RANCHO CORDOVA CA 95670

OWNER

MONSERRAT, JULIE
2785 CHATEAU MONTELENA WY
SAC, CA. 95834

ARCHITECT

Nature of Work: NEW POOL - NO HEATER

CONSTRUCTION LENDING AGENCY: I hereby affirm under penalty of perjury that there is a construction lending agency for the performance of the work for which this permit is issued (Sec. 3097, Civ. C).

Lender's Name _____ Lender's Address _____

LICENSED CONTRACTORS DECLARATION: I hereby affirm under penalty of perjury that I am licensed under provisions of Chapter 9 (commencing with section 7000) of Division 3 of the Business and Professions Code and my license is in full force and effect.

License Class _____ License Number 50770 Date 1/10/01 Contractor Signature [Signature]

OWNER-BUILDER DECLARATION: I hereby affirm under penalty of perjury that I am exempt from the contractors License Law for the following reason (Sec. 7031.5, Business and Professions Code: any city or county which requires a permit to construct, alter, improve, demolish, or repair any structure, prior to its issuance, also requires the applicant for such permit to file a signed statement that he or she is licensed pursuant to the provisions of the Contractors License Law (Chapter 9 (commencing with Section 7000) of Division 8 of the Business and Professions Code) or that he or she is exempt therefrom and the basis for the alleged exemption. Any violation of Section 7031.5 by any applicant for a permit subjects the applicant to a civil penalty of not more than five hundred dollars (\$500.00):

____ I, as a owner of the property, or my employees with wages as their sole compensation, will do the work, and the structure is not intended or offered for sale (Sec. 7044, Business and Professional Code: The Contractors License Law does not apply to an owner of property who builds or improves thereon, and who does such work himself or herself or through his/her own employees, provided that such improvements are not intended or offered for sale. If, however, the building or improvement is sold within one year of completion, the owner-builder will have the burden of proving that he/she did not build or improve for the purpose of sale.)

____ I, as owner of the property, am exclusively contracting with licensed contractors to construct the project (Sec. 7044, Business and Professions Code: The Contractors License Law does not apply to an owner of property who builds or improves thereon, and who contracts for such projects with a contractor(s) licensed pursuant to the Contractors License Law).

____ I am exempt under Sec. _____ B & PC for this reason: _____

Date _____ Owner Signature _____

IN ISSUING THIS BUILDING PERMIT, the applicant represents, and the city relies on the representation of the applicant, that the applicant verified all measurements and locations shown on the application or accompanying drawings and that the improvement to be constructed does not violate any law or private agreement relating to permissible or prohibited locations for such improvements. This building permit does not authorize any illegal location of any improvement or the violation of any private agreement relating to location of improvements.

I certify that I have read this application and state that all information is correct. I agree to comply with all city and county ordinances and state laws relating to building construction and hereby authorize representative(s) of this city to enter upon the abovementioned property for inspection purposes.

Date _____ Applicant/Agent Signature [Signature]

WORKER'S COMPENSATION DECLARATION: I hereby affirm under penalty of perjury one of the following declarations:

____ I have and will maintain a certificate of consent to self-insure for workers' compensation as provided for by Section 3700 of the Labor Code, for the performance of work for which the permit is issued.

I have and will maintain workers' compensation insurance, as required by Section 3700 of the Labor Code, for the performance of the work for which this permit is issued. My workers' compensation insurance carrier and policy number are:

Carrier STATE FUND Policy Number 046 00000 8820 Exp Date 01/01/2001

____ (This section need not be completed if the permit is for \$100 or less) I certify that in the performance of the work for which this permit is issued, I shall not employ any person in any manner so as to become subject to the workers' compensation laws of California and agree that if I should become subject to the workers' compensation provisions of Section 3700 of the Labor Code, I shall forthwith comply with those provisions.

Date _____ Applicant Signature [Signature]

WARNING: FAILURE TO SECURE WORKER'S COMPENSATION COVERAGE IS UNLAWFUL AND SHALL SUBJECT AN EMPLOYER TO CRIMINAL PENALTIES AND CIVIL FINES UP TO ONE HUNDRED THOUSAND DOLLARS (\$100,000) IN ADDITION TO THE COST OF COMPENSATION, DAMAGES AS PROVIDED FOR IN SECTION 3706 OF THE LABOR CODE, INTEREST AND ATTORNEY'S FEE.

THIS PERMIT SHALL EXPIRE BY LIMITATION IF WORK IS NOT COMMENCED WITHIN 180 DAYS.

CITY OF SACRAMENTO

SUBMIT TWO COPIES

THIS COPY SHALL BE ON JOB SITE AT ALL TIMES

CONTRACTOR/OWNER

JOB ADDRESS:

LOAD CALCULATION - N.E.C. 220.30

TOTAL SQ. FT. 1500

NUMBER	ITEM	WATTS	LOAD CALCULATION
1500	Sq. ft @ 3 watts per sq. ft.	4500	Compressor 20 amps Fan 5 amps
4	20 Amp. Appliance circuits @ 1,500 watts each	6000	Unit Total Load - 25 amps x 240V
1	Range (Nameplate Rating = N.P.R.) GAS	GAS	Electric Furnace @ N.P.R. - 6,000 watts X 65% = 3900 Watts
1	Oven (N.P.R.) GAS	GAS	Use 6000W., since it is larger.
1	Cooking Units (N.P.R.) MICRO WAVE	900	Heat Pump Note: Be careful when doing load calculations where heat pumps are installed. The load for most heat pumps that are equipped with auxiliary heat strips will be larger under the demand for heat. For the purposes of load calculations only, on heat pumps, use 100% of the heat pump compressor and fans and 65% of auxiliary heat load to show total heat pump load.
1	Water Heater (N.P.R.) GAS	GAS	Heat Pump Example Compressor 20 Amps Fans 5 amps
1	Dishwasher (N.P.R.)	1500	Heat Pump Load = 25A X 240V = 6,000 Aux. Heat Strip = 6,000W X 65% = 3,900W Total Heat Pump Load = 9,900W
1	Disposal (N.P.R.)	750	
1	Washer [1500 watts min. - N.E.C. 220-16(b)]	1500	
1	Dryer [5000 watts min. or N.P.R. if larger] N.E.C. 220-18] GAS	GAS	
1	Meters (N.P.R.)	-	
1	Other (N.P.R.)	500	
1	Other (N.P.R.)	1500	
Air Conditioning Equipment			
Air Conditioning [cooling @ (N.P.R. X 100%)] = 7,000			Sub-Total = 17450 (Less 1st 10KW) 10,000 @100% = 10,000 Watts
Electrical Heating @ (N.P.R.) X 65% = 2750			Remainder @ 40% 7450@40% = 2950 Watts
NOTE USE THE LARGEST LOAD HEAT OR COOL =			Total Air Cond and/or heat pump load = 7380 Watts
Heat pump (compressor & fans) X 100% =			Total Service Load = 2150 Watts
Aux. heat strips (or elect. furnace) X 65% =			Total Service Load = 2150 watts + 240V = 84 Amps
Total Heat Pump Load =			Service Size <u>200AMP</u>
NOTE = AMPS X CIRCUIT VOLTAGE = WATTS			

Plans on microfilm

(City of Sac)

APN 225-1160-097
(MONSERAT)

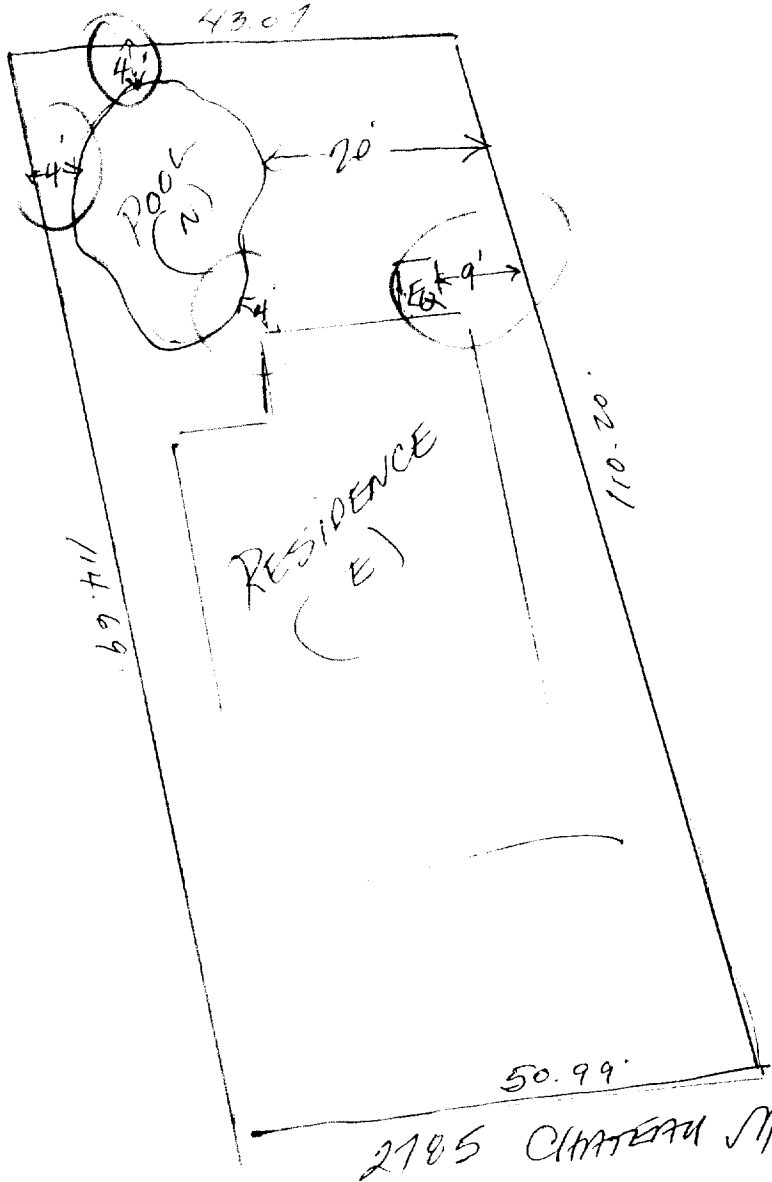

ISSUED

NOV 29 2000

Sacramento Building Division

CITY OF SACRAMENTO
PERMIT ASSISTANCE

NOV 14 2000

RECEIVED