

CITY OF SACRAMENTO
1231 I Street, Sacramento, CA 95814

Permit No: 0103326
Insp Area: 4

Site Address: 3433 DELPHINIUM WY SAC
Parcel No: 274-0500-024 NATOMAS WEST 1 LOT 92

Sub-Type: NSFR
Housing (Y/N): N

CONTRACTOR
KAUFMAN AND BROAD
611 ORANGE DR
VACAVILLE CA. 95687

OWNER

ARCHITECT

Nature of Work: NSFR MP2318 2 STORY 10 RMS

CONSTRUCTION LENDING AGENCY: I hereby affirm under penalty of perjury that there is a construction lending agency for the performance of the work for which this permit is issued (Sec. 3097, Civ. C)

Lender's Name _____ Lender's Address _____

LICENSED CONTRACTORS DECLARATION: I hereby affirm under penalty of perjury that I am licensed under provisions of Chapter 9 (commencing with section 7000) of Division 3 of the Business and Professions Code and my license is in full force and effect.

License Class C License Number 12345 Date 2-27-06 Contractor Signature [Signature]

OWNER-BUILDER DECLARATION: I hereby affirm under penalty of perjury that I am exempt from the contractors License Law for the following reason (Sec. 7031.5, Business and Professions Code; any city or county which requires a permit to construct, alter, improve, demolish, or repair any structure, prior to its issuance, also requires the applicant for such permit to file a signed statement that he or she is licensed pursuant to the provisions of the Contractors License Law (Chapter 9 (commencing with Section 7000) of Division 8 of the Business and Professions Code) or that he or she is exempt therefrom and the basis for the alleged exemption. Any violation of Section 7031.5 by any applicant for a permit subjects the applicant to a civil penalty of not more than five hundred dollars (\$500.00).

I, as a owner of the property, or my employees with wages as their sole compensation, will do the work, and the structure is not intended or offered for sale (Sec. 7044, Business and Professional Code. The Contractors License Law does not apply to an owner of property who builds or improves thereon, and who does such work himself or herself or through his/her own employees, provided that such improvements are not intended or offered for sale. If, however, the building or improvement is sold within one year of completion, the owner-builder will have the burden of proving that he/she did not build or improve for the purpose of sale.)

I, as owner of the property, am exclusively contracting with licensed contractors to construct the project (Sec. 7044, Business and Professions Code. The Contractors License Law does not apply to an owner of property who builds or improves thereon, and who contracts for such projects with a contractor(s) licensed pursuant to the Contractors License Law.)

I am exempt under Sec. _____ B & PC for this reason: _____

Date _____ Owner Signature _____

IN ISSUING THIS BUILDING PERMIT, the applicant represents, and the city relies on the representation of the applicant, that the applicant verified all measurements and locations shown on the application or accompanying drawings and that the improvement to be constructed does not violate any law or private agreement relating to permissible or prohibited locations for such improvements. This building permit does not authorize any illegal location of any improvement or the violation of any private agreement relating to location of improvements.

I certify that I have read this application and state that all information is correct. I agree to comply with all city and county ordinances and state laws relating to building construction and hereby authorize representative(s) of this city to enter upon the abovementioned property for inspection purposes.

Date 3-27-06 Applicant/Agent Signature [Signature]

WORKER'S COMPENSATION DECLARATION: I hereby affirm under penalty of perjury one of the following declarations:

I have and will maintain a certificate of consent to self-insure for workers' compensation as provided for by Section 3700 of the Labor Code, for the performance of work for which the permit is issued.

I have and will maintain workers' compensation insurance, as required by Section 3700 of the Labor Code, for the performance of the work for which this permit is issued. My workers' compensation insurance carrier and policy number are:

Carrier CONTINENTAL CAS. CO Policy Number WC188899094 Exp Date 05/01/2000

(This section need not be completed if the permit is for \$100 or less). I certify that in the performance of the work for which this permit is issued, I shall not employ any person in any manner so as to become subject to the workers' compensation laws of California, and agree that if I should become subject to the workers' compensation provisions of Section 3700 of the Labor Code, I shall forthwith comply with those provisions.

Date 3-27-06 Applicant Signature [Signature]

WARNING: FAILURE TO SECURE WORKER'S COMPENSATION COVERAGE IS UNLAWFUL AND SHALL SUBJECT AN EMPLOYER TO CRIMINAL PENALTIES AND CIVIL FINES UP TO ONE HUNDRED THOUSAND DOLLARS (\$100,000) IN ADDITION TO THE COST OF COMPENSATION, DAMAGES AS PROVIDED FOR IN SECTION 3706 OF THE LABOR CODE, INTEREST AND ATTORNEY'S FEE.

THIS PERMIT SHALL EXPIRE BY LIMITATION IF WORK IS NOT COMMENCED WITHIN 180 DAYS.

CERTIFICATION OF INSULATION

ADDRESS OR TRACT				SACRAMENTO INSULATION CONTRACTORS			
KB HOMES LOT # 92 3433 DELPHINIUM WAY CALIFORNIA GARDENS				<input checked="" type="checkbox"/> P.O. BOX 864, WEST SACRAMENTO, CA 95691 LIC. #202026 <input type="checkbox"/> 1308 MELODY ROAD, MARYSVILLE, CA 95901 LIC. #202023 <input type="checkbox"/> P.O. BOX 0651, FRESNO, CA 93793-0651 LIC. #202026 <input type="checkbox"/> P.O. BOX 1831, RENO, NV 89506 LIC. #10675 <input type="checkbox"/> 3326 A PONDEROSA WAY, LAS VEGAS, NV 89118 LIC. #10675			
DATE INSULATION COMPLETED							
WALLS		CEILING		FLOORS			
(SQUARE FEET)		(SQUARE FEET)		(SQUARE FEET)			
TYPE OF INSULATION		TYPE OF INSULATION		TYPE OF INSULATION			
MATERIAL FIBERGLASS		MATERIAL FIBERGLASS		MATERIAL FIBERGLASS			
FORM BATTS		FORM BATTS & BLOW		FORM BATTS			
MANUFACTURER'S PRODUCT I.D.		MANUFACTURER'S PRODUCT I.C.		MANUFACTURER'S PRODUCT I.D.			
MANUFACTURER		MANUFACTURER		MANUFACTURER			
OCF		OCF		OCF			
R-VALUE INSTALLED		APPLIED THICKNESS		R-VALUE INSTALLED		APPLIED THICKNESS	
13		3 5/8"		38 38		12 3/4" 14 3/4"	
KNEE WALLS IF R-VALUE IS OTHER THAN WALLS ABOVE							
MATERIAL FIBERGLASS		FORM BATTS		R-VALUE		MANUFACTURER OCF	
AIR INFILTRATION SEALANT							
MATERIAL FOAM				MANUFACTURER W R GRACE			
THIS IS TO CERTIFY THAT INSULATION AND/OR SEALANT HAS BEEN INSTALLED IN CONFORMANCE WITH APPLICABLE CODES, MATERIAL STANDARDS AND REGULATIONS:							
SIGNATURE - INSULATION CONTRACTOR				TITLE		DATE	
<i>[Signature]</i>				MANAGER		1-8-02	
SIGNATURE - GENERAL CONTRACTOR				TITLE		DATE	
REMARKS							

RESIDENTIAL SUBDIVISION BUILDING PERMIT APPLICATION

Project Address: 3433 Delphinium Way Assessor Parcel # 274-0500-024
Lot Number: 92 Subdivision Natomas West Village 1

OWNER INFORMATION:

0103326

Legal Property Owner: KB Home Phone# 707-469-2464
Owner Address: 611 Orange dr City Vacaville State CA Zip 95687

CONTRACTOR INFORMATION:

Contractor: KB Home Lic. # 761970 Phone # 707-469-2464 Fax 469-2405

PROJECT INFORMATION:

Land Use Zone RIA Occupancy Group R3 Construction Type VN Fed Code 1A
No. of Stories: 2 No. of Rooms: _____ Street Width: _____
1st Floor Area 1054 2nd Floor Area 1264 Basement _____ Roof Material _____
AREA IN SQUARE FOOT OF:
Dwelling/Living 2318
Garage/Storage 380
Decks/Balconies 19
Carports 19
SCOPE OF WORK: New Single Family Dwelling

FOR OFFICE USE ONLY

- Information Above Complete
- Violation Files Checked
- Standard Setbacks
- County Sewer
- AR Flood Waiver Required
- Flood Elevation Certificate Required
- Water Development Infill Area
- Planning Approval
- Design Review Approval
- Special Fee Districts Apply:

- THE FOLLOWING MUST BE PROVIDED IN ORDER TO SUBMIT FOR PERMIT
- 2 COMPLETE PLOT PLANS, LEGIBLE & DRAWN TO SCALE
 - 11 X 17 COPY OF FLOOR PLAN WITH FOLLOWING INFORMATION
 - a) Assessor's Parcel Number
 - b) New Floor Area
 - c) Owners Name
 - d) Project Address

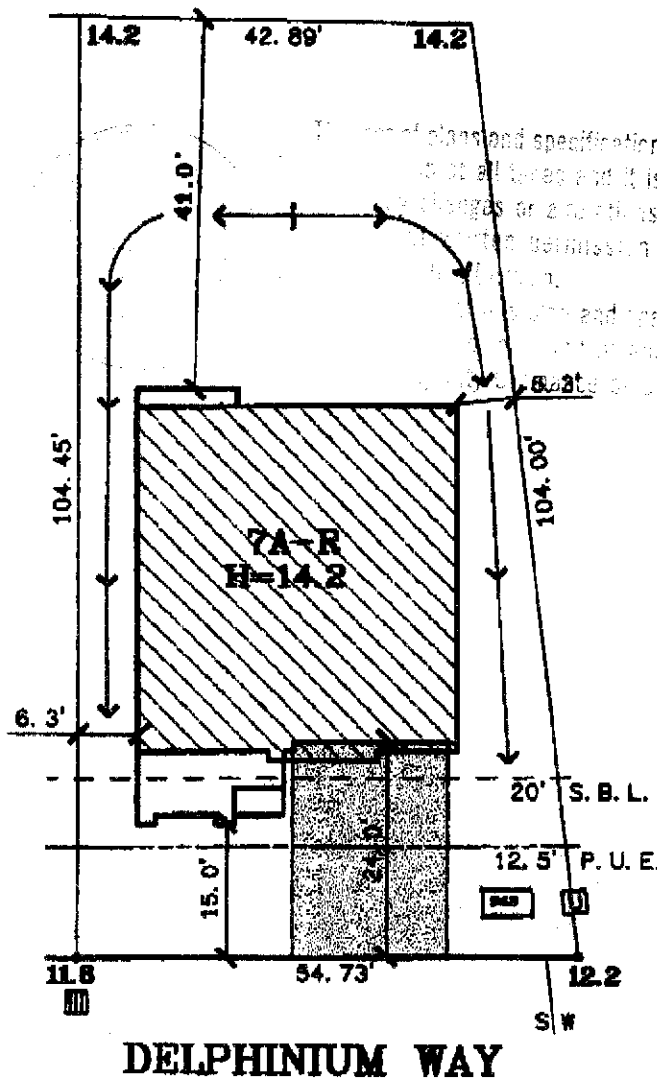

The use of plans and specifications must be as set forth and it is unlawful to make any changes or additions from the original plans and specifications without the written permission from the City of Sacramento.

The use of plans and specifications must be as set forth and it is unlawful to make any changes or additions from the original plans and specifications without the written permission from the City of Sacramento.



DATE: 2-20-01
 A.P.N.: 274-0500-024
 ADDRESS: 3433 DELPHINIUM WAY

LOT AREA: 5,067 SF
 LOT COVERAGE: 29%

The Splink Corporation
 2590 VENTURE OAKS WAY
 SACRAMENTO, CA 95833
 PH (916)925-5550 FAX (916)921-9274

NATOMAS WEST VILLAGE 1
 LOT 92
 PLAN 7A

CALIFORNIA GARDENS
 CITY OF SACRAMENTO, CA
 CLIENT: KAUFMAN & BROAD