

**CITY OF SACRAMENTO**  
1231 I Street, Sacramento, CA 95814

**Permit No: 0104918**  
**Insp Area: 4**

**Site Address: 4832 VERENA LN SAC**  
Parcel No: 225-1610-064 WESTBR 6 LOT 34

Sub-Type: NSFR  
Housing (Y/N): N

**CONTRACTOR**  
MORRISON HOMES  
1130 IRON POINT RD STE 120  
FOLSOM CA. 95630

**OWNER**  
MORRISON HOMES  
1130 IRON POINT RD #120  
FOLSOM CA 95630

**ARCHITECT**

**Nature of Work: NSFR MP2819 10 RMS 2 STORY**

**CONSTRUCTION LENDING AGENCY:** I hereby affirm under penalty of perjury that there is a construction lending agency for the performance of the work for which this permit is issued (Sec. 3097, C.V.C.)

Lender's Name \_\_\_\_\_ Lender's Address \_\_\_\_\_

**LICENSED CONTRACTORS DECLARATION:** I hereby affirm under penalty of perjury that I am licensed under provisions of Chapter 9 (commencing with section 7000) of Division 3 of the Business and Professions Code and my license is in full force and effect.

License Class B License Number 519967 Date 4-25-01 Contractor Signature [Signature]

**OWNER-BUILDER DECLARATION:** I hereby affirm under penalty of perjury that I am exempt from the contractors License Law for the following reason (Sec. 7031.5, Business and Professions Code: any city or county which requires a permit to construct, alter, improve, demolish, or repair any structure, prior to its issuance, also requires the applicant for such permit to file a signed statement that he or she is licensed pursuant to the provisions of the Contractors License Law (Chapter 9 (commencing with Section 7000) of Division 8 of the Business and Professions Code) or that he or she is exempt therefrom and the basis for the alleged exemption. Any violation of Section 7031.5 by any applicant for a permit subjects the applicant to a civil penalty of not more than five hundred dollars (\$500.00).

\_\_\_\_\_, I, as a owner of the property, or my employees with wages as their sole compensation, will do the work, and the structure is not intended or offered for sale (Sec. 7044, Business and Professions Code). The Contractors License Law does not apply to an owner of property who builds or improves thereon, and who does such work himself or herself or through his/her own employees, provided that such improvements are not intended or offered for sale. If, however, the building or improvement is sold within one year of completion, the owner-builder will have the burden of proving that he/she did not build or improve for the purpose of sale.)

\_\_\_\_\_, I, as owner of the property, am exclusively contracting with licensed contractors to construct the project (Sec. 7044, Business and Professions Code). The Contractors License Law does not apply to an owner of property who builds or improves thereon, and who contracts for such projects with a contractor(s) licensed pursuant to the Contractors License Law.)

\_\_\_\_\_, I am exempt under Sec. \_\_\_\_\_ B & PC for this reason: \_\_\_\_\_

Date \_\_\_\_\_ Owner Signature \_\_\_\_\_

**IN ISSUING THIS BUILDING PERMIT,** the applicant represents, and the city relies on the representation of the applicant, that the applicant verified all measurements and locations shown on the application or accompanying drawings and that the improvement to be constructed does not violate any law or private agreement relating to permissible or prohibited locations for such improvements. This building permit does not authorize any illegal location of any improvement or the violation of any private agreement relating to location of improvements.

I certify that I have read this application and state that all information is correct. I agree to comply with all city and county ordinances and state laws relating to building construction and hereby authorize representative(s) of this city to enter upon the abovementioned property for inspection purposes.

Date 4-25-01 Applicant/Agent Signature [Signature]

**WORKER'S COMPENSATION DECLARATION:** I hereby affirm under penalty of perjury one of the following declarations:

\_\_\_\_\_, I have and will maintain a certificate of consent to self-insure for workers' compensation as provided for by Section 3700 of the Labor Code, for the performance of work for which the permit is issued.

I have and will maintain workers' compensation insurance, as required by Section 3700 of the Labor Code, for the performance of the work for which this permit is issued. My workers' compensation insurance carrier and policy number are:

Carrier ZURICH-AMERICAN INS. CO Policy Number WC2090701-03 Exp Date 11/01/2001

\_\_\_\_\_, (This section need not be completed if the permit is for \$100 or less) I certify that in the performance of the work for which this permit is issued, I shall not employ any person in any manner so as to become subject to the workers' compensation laws of California and I shall not become subject to the workers' compensation provisions of Section 3700 of the Labor Code. I shall forthwith comply with those provisions.

Date 4-25-01 Applicant Signature [Signature]

WARNING: FAILURE TO SECURE WORKER'S COMPENSATION COVERAGE IS UNLAWFUL. NEIGHBORHOOD PLANNING AND DEVELOPMENT SERVICES SHALL SUBJECT AN EMPLOYER TO CRIMINAL PENALTIES AND CIVIL FINES UP TO ONE HUNDRED THOUSAND DOLLARS (\$100,000) IN ADDITION TO THE COST OF COMPENSATION, DAMAGES AS PROVIDED FOR IN SECTION 3706 OF THE LABOR CODE, INTEREST AND COURT COSTS.

**THIS PERMIT SHALL EXPIRE BY LIMITATION IF WORK IS NOT COMMENCED WITHIN 180 DAYS.**

RESIDENTIAL SUBDIVISION BUILDING PERMIT APPLICATION

Project Address: 4832 Verena Lane Assessor Parcel # 225-1610-064  
Lot Number: 64 Subdivision Westborough Village 6

OWNER INFORMATION:

Legal Property Owner: Morrison Homes Phone# (916) 355-8900  
Owner Address: 1130 Iron Point Rd #120 City Folsom State CA Zip 95630

CONTRACTOR INFORMATION:

Contractor: Morrison Homes Lic. # 519465 Phone # 355-8900 Fax 355-0100

PROJECT INFORMATION:

Land Use Zone RIA Occupancy Group R3 Construction Type VN Fed Code 1A  
No. of Stories: 2 No. of Rooms: 10 Street Width: \_\_\_\_\_  
1<sup>st</sup> Floor Area 1546 2<sup>nd</sup> Floor Area 1273 Basement \_\_\_\_\_ Roof Material \_\_\_\_\_  
AREA IN SQUARE FOOT OF:  
Dwelling/Living 2819  
Garage/Storage 655  
Decks/Balconies 131  
Carports \_\_\_\_\_  
SCOPE OF WORK: New Single Family Dwelling

FOR OFFICE USE ONLY

- Information Above Complete
- Violation Files Checked
- Standard Setbacks
- County Sewer
- AR Flood Waiver Required
- Flood Elevation Certificate Required
- Water Development Infill Area
- Planning Approval
- Design Review Approval
- Special Fee Districts Apply:

THE FOLLOWING MUST BE PROVIDED IN ORDER TO SUBMIT FOR PERMIT

- 2 COMPLETE PLOT PLANS, LEGIBLE & DRAWN TO SCALE
- 11 X 17 COPY OF FLOOR PLAN WITH FOLLOWING INFORMATION
  - a) Assessor's Parcel Number
  - b) New Floor Area
  - c) Owners Name
  - d) Project Address

\$185,549 <sup>21</sup>

# CERTIFICATION OF INSULATION

ADDRESS OR TRACT <p style="font-size: 2em; font-family: cursive;">MORRISON</p> <p style="font-size: 1.5em; font-family: cursive;">LOT # 64</p> <p style="font-size: 2em; font-family: cursive;">BEL LAGO</p>	SACRAMENTO INSULATION CONTRACTORS <input checked="" type="checkbox"/> P.O. BOX 854, WEST SACRAMENTO, CA 95691 LIC. #202026 <input type="checkbox"/> 1309 MELODY ROAD, MARYSVILLE, CA 95901 LIC. #202026 <input type="checkbox"/> P.O. BOX 8851, FRESNO, CA 93793-8851 LIC. #202026 <input type="checkbox"/> P.O. BOX 1831, RENO, NV 89506 LIC. #10675 <input type="checkbox"/> 3326 A PONDEROSA WAY, LAS VEGAS, NV 89118 LIC. #10675 DATE INSULATION COMPLETED
---	--

WALLS		CEILINGS			FLOORS				
SQUARE FEET)		SQUARE FEET)			SQUARE FEET)				
TYPE OF INSULATION		TYPE OF INSULATION			TYPE OF INSULATION				
MATERIAL <b>FIBERGLASS</b>		MATERIAL <b>FIBERGLASS</b>			MATERIAL <b>FIBERGLASS</b>				
FORM <b>BATTS</b>		FORM <b>BATTS &amp; BLOW</b>			FORM <b>BATTS</b>				
MANUFACTURER'S PRODUCT I.D.		MANUFACTURER'S PRODUCT I.D.			MANUFACTURER'S PRODUCT I.D.				
MANUFACTURER		MANUFACTURER			MANUFACTURER				
<b>OCF</b>		<b>OCF</b>			<b>OCF</b>				
R-VALUE INSTALLED		APPLIED THICKNESS		MIN. INSTALLED WEIGHT PER SQUARE FOOT		R-VALUE INSTALLED		APPLIED THICKNESS	
13 19		3 3/4" 5 1/2"							
30		30							
9"		12"							

KNEE WALLS IF R-VALUE IS OTHER THAN WALLS ABOVE

MATERIAL <b>FIBERGLASS</b>	FORM <b>BATTS</b>	R-VALUE	MANUFACTURER <b>OCF</b>
-------------------------------	----------------------	---------	----------------------------

AIR INFILTRATION SEALANT

MATERIAL <b>FOAM</b>	MANUFACTURER <b>W R GRACE</b>
-------------------------	----------------------------------

THIS IS TO CERTIFY THAT INSULATION AND/OR SEALANT HAS BEEN INSTALLED IN CONFORMANCE WITH APPLICABLE CODES, MATERIAL STANDARDS AND REGULATIONS.

SIGNATURE—INSULATION CONTRACTOR <i>[Signature]</i>	TITLE <b>MANAGER</b>	DATE <b>3-18-02</b>
SIGNATURE—GENERAL CONTRACTOR	TITLE	DATE

REMARKS:

# OMEGA PRODUCTS INTERNATIONAL, INC.

DIAMOND WALL INSULATING STUCCO SYSTEM

JOB ADDRESS:

4832 VERENA LN LOT 64  
SAC, CA 95835

ICBO Report #4004

Date of Job Completion 12-10-01

PLASTERING CONTRACTOR:

Name: Stucco Works Inc  
Address: 5900 WAREHOUSE WAY SACRAMENTO CA  
Telephone No: (916) 383 66 99  
Contractor Number of Diamond Wall System 2175

This is to certify that the exterior coating system on the building exterior at the above address has been installed in accordance with the evaluation report specified above and the manufacturer's instructions.

12-20-01  
Date

[Signature]  
Signature of authorized representative of  
Plastering Contractor

This installation card must be presented to the building inspector after completion of work and before final inspection.

UNAUTHORIZED CHANGES & USES: THE ENGINEER PREPARING THIS PLAN WILL NOT BE RESPONSIBLE FOR, OR LIABLE FOR, UNAUTHORIZED CHARGES TO OR USES OF THIS PLAN. ALL CHANGES TO THIS PLAN MUST BE IN WRITING AND MUST BE APPROVED BY THE ENGINEER. THE INFORMATION ON THIS PLAN IS PROVIDED FOR YOUR CONVENIENCE AS A GUIDE TO THE GENERAL LOCATION OF THE SUBJECT PROPERTY. THE DIMENSIONS MAY VARY OR CHANGE WITHOUT PRIOR NOTICE DUE TO ACTUAL SITE CONDITIONS.

LOT COVERAGE 32.2%

**VERENA LANE**

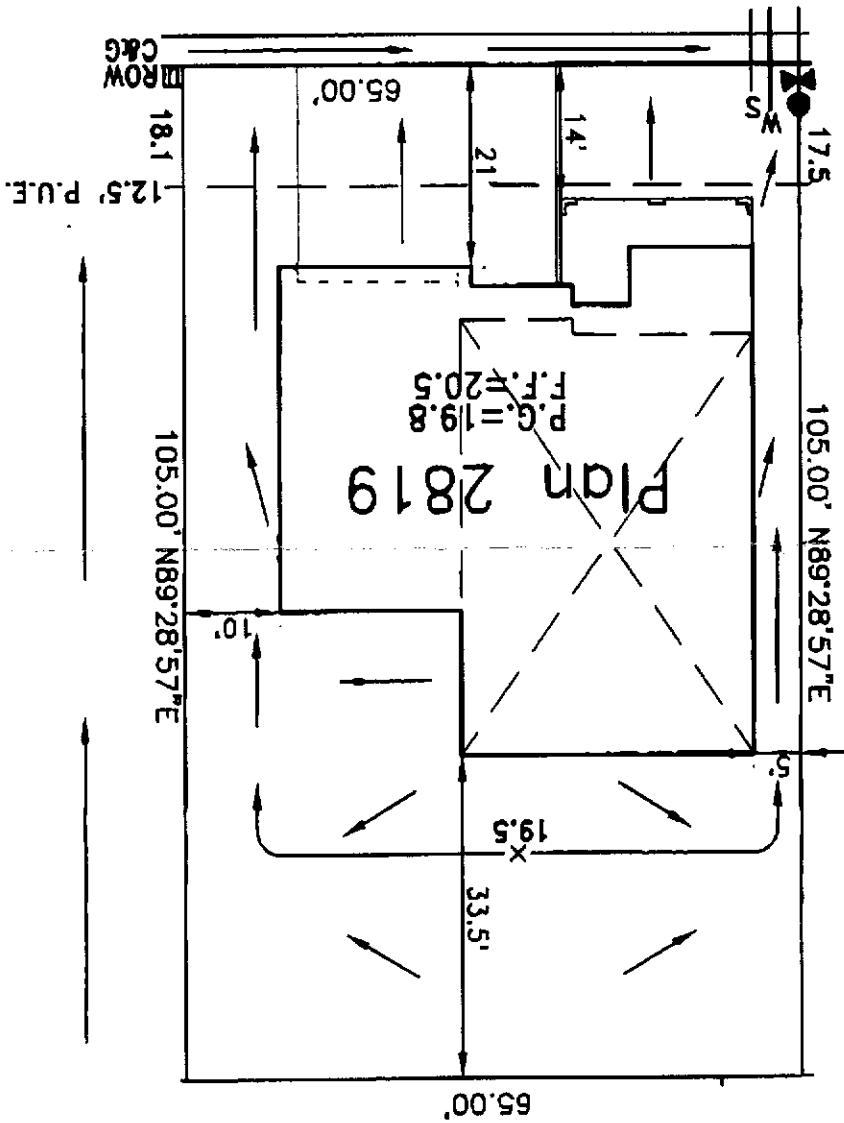

☐ = UTILITY BOX  
 ⦿ = FIRE HYDRANT

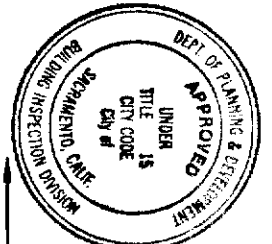

This set of plans and specifications must be kept on the job at all times and it is unlawful to make any changes or alterations from the same without written permission from the Building Inspection Division.  
 The approval of this plan and specification SHALL NOT be held to permit or approve the violation of any City Ordinance or State Law.

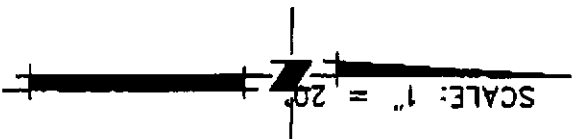

J:\JOBS\WESTBOROUGH VILLAGE CIVIL PLOT PLANS\SPECIAL PERMIT EXHIBITS\LOT\_64.DWG 03/15/01 18:27