

CITY OF SACRAMENTO
1231 I Street, Sacramento, CA 95814

Permit No: 9910878
Insp Area: 4

Site Address: 59 JARVIS CR SAC

Parcel No: 225-1230-038

GATEWAY WEST LOT #38

Sub-Type: NSFR

Housing (Y/N): N

CONTRACTOR
BEAZER HOMES
3009 DOUGLAS BL #150
ROSEVILLE CA 95661

OWNER

ARCHITECT

Nature of Work: MP 1872 1 STORY 7 ROOM SFR

CONSTRUCTION LENDING AGENCY : I hereby affirm under penalty of perjury that there is a construction lending agency for the performance of the work for which this permit is issued (Sec. 3097, Civ. C)

Lender's Name _____ Lender's Address _____

LICENSED CONTRACTORS DECLARATION: I hereby affirm under penalty of perjury that I am licensed under provisions of Chapter 9 commencing with section 7000) of Division 3 of the Business and Professions Code and my license is in full force and effect.

License Class B License Number 724191 Date 10/6/99 Contractor Signature Sheryl Van Maran

OWNER-BUILDER DECLARATION: I hereby affirm under penalty of perjury that I am exempt from the contractors License Law for the following reason (Sec. 7031.5, Business and Professions Code: any city or county which requires a permit to construct, alter, improve, demolish, or repair any structure, prior to its issuance, also requires the applicant for such permit to file a signed statement that he or she is licensed pursuant to the provisions of the Contractors License Law (Chapter 9 (commencing with Section 7000) of Division 8 of the Business and Professions Code) or that he or she is exempt therefrom and the basis for the alleged exemption. Any violation of Section 7031.5 by any applicant for a permit subjects the applicant to a civil penalty of not more than five hundred dollars (\$500.00).

____ I, as a owner of the property, or my employees with wages as their sole compensation, will do the work, and the structure is not intended or offered for sale (Sec. 7044, Business and Professional Code: The Contractors License Law does not apply to an owner of property who builds or improves thereon, and who does such work himself or herself or through his/her own employees, provided that such improvements are not intended or offered for sale. If, however, the building or improvement is sold within one year of completion, the owner-builder will have the burden of proving that he/she did not build or improve for the purpose of sale.)

____ I, as owner of the property, am exclusively contracting with licensed contractors to construct the project (Sec. 7044, Business and Professions Code). The Contractors License Law does not apply to an owner of property who builds or improves thereon, and who contracts for such projects with a contractor(s) licensed pursuant to the Contractors License Law.)

____ I am exempt under Sec. _____ B & PC for this reason: _____

Date _____ Owner Signature _____

IN ISSUING THIS BUILDING PERMIT, the applicant represents, and the city relies on the representation of the applicant, that the applicant verified all measurements and locations shown on the application or accompanying drawings and that the improvement to be constructed does not violate any law or private agreement relating to permissible or prohibited locations for such improvements. This building permit does not authorize any illegal location of any improvement or the violation of any private agreement relating to location of improvements.

I certify that I have read this application and state that all information is correct. I agree to comply with all city and county ordinances and state laws relating to building construction and hereby authorize representative(s) of this city to enter upon the abovementioned property for inspection purposes.

Date 10/6/99 Applicant/Agent Signature Sheryl Van Maran

WORKER'S COMPENSATION DECLARATION: I hereby affirm under penalty of perjury one of the following declarations:

____ I have and will maintain a certificate of consent to self-insure for workers' compensation as provided for by Section 3700 of the Labor Code, for the performance of work for which the permit is issued.

____ I have and will maintain workers' compensation insurance, as required by Section 3700 of the Labor Code, for the performance of the work for which this permit is issued. My workers' compensation insurance carrier and policy number are:

Carrier LIBERTY MUTUAL INS CO. Policy Number WA2-65D-004147-059 Exp Date 04/01/2000

____ (This section need not be completed if the permit is for \$100 or less) I certify that in the performance of the work for which this permit is issued, I shall not employ any person in any manner so as to become subject to the workers' compensation laws of California and agree that if I should become subject to the workers' compensation provisions of Section 3700 of the Labor Code, I shall forthwith comply with those provisions.

Date 10/6/99 Applicant Signature Sheryl Van Maran

WARNING: FAILURE TO SECURE WORKER'S COMPENSATION COVERAGE IS UNLAWFUL AND SHALL SUBJECT AN EMPLOYER TO CRIMINAL PENALTIES AND CIVIL FINES UP TO ONE HUNDRED THOUSAND DOLLARS (\$100,000) IN ADDITION TO THE COST OF COMPENSATION, DAMAGES AS PROVIDED FOR IN SECTION 3706 OF THE LABOR CODE, INTEREST AND ATTORNEY'S FEE.

THIS PERMIT SHALL EXPIRE BY LIMITATION IF WORK IS NOT COMMENCED WITHIN 180 DAYS.

Natomas Unified School District
 1515 Sports Drive, #1 • Sacramento, CA 95834-1905
 Phone 916/641-3300 • Fax 916/928-1629

SCHOOL DISTRICT DEVELOPMENT FEES

Property Owner's Name <u>Beazer Homes</u>	
Owner's Address <u>3009 Douglas Blvd #150 Roseville CA 95601</u>	
Project Address <u>59 Jarvis Circle Lot 38</u>	
Parcel Number <u>225-123-038</u>	
Subdivision Name <u>Gateway West</u>	
Number of Units <u>1</u>	
Print Applicant's Name <u>Sheryl Van Maren</u>	Applicant's Signature <u>Sheryl Van Maren</u>
Title of Applicant <u>Starts Coordinator</u>	
Date <u>9/20/99</u>	Telephone Number <u>773-3888</u>
Plan Identification Number <u>9910878R</u>	
Building Type (Check One)	
<input checked="" type="checkbox"/> Residential	<input type="checkbox"/> Apartment/Condominium
	<input type="checkbox"/> Commercial/Industrial
Square Feet of Chargeable Building Area <u>1872</u>	
Signature <u>[Signature]</u>	Date <u>9/21/99</u>
Title <u>Bldg Insp</u>	
District Certification Number <u>00-358</u>	
Fees Collected:	
Residential: <u>1872</u> Sq. Ft. X \$ <u>3.08</u>	= \$ <u>5765.76</u>
Apartment/Condominium:	Sq. Ft. X \$ = \$
Commercial/Industrial:	Sq. Ft. X \$ = \$
NOTICE TO APPLICANT: Pursuant to government code section 66020 (d), this will serve to notify you that the 90-day approval period in which you may protest the fees, or other payment identified above, will begin to run on the date in which the building or installation permit for this project is issued, or on which they are paid to the District, or to another public entity authorized to collect them on behalf of the District, whichever is earlier.	
Applicant Signature: <u>Sheryl Van Maren</u>	Date: <u>9/22/99</u>

This certification covers only the amount of square footage indicated above. Any additions or corrections to the square footage for this project will require an amendment to the Certificate of Compliance.

As the authorize Natomas Unified School District official, I hereby certify that the requirements of Government Code Section 95000 have been complied with by the above signed applicant.

SIGNATURE: [Signature] DATE: 10/1/99
 TITLE: Facilities Planning

CERTIFICATION OF INSULATION

ADDRESS OR TRACT

SACRAMENTO INSULATION CONTRACTORS

BEAZER

LOT # 38

- P.O. BOX 854, WEST SACRAMENTO, CA 95691 LIC. #202026
- 1309 MELODY ROAD, MARYSVILLE, CA 95901 LIC. #202026
- P.O. BOX 9651, FRESNO, CA 93793-9651 LIC. #202026
- P.O. BOX 1631, RENO, NV 89505 LIC. #10675
- 3326 A PONDEROSA WAY, LAS VEGAS, NV 89118 LIC. #10675

MEMORIES

DATE INSULATION COMPLETED

PART GENERAL

PART AREAS INSULATED

WALLS

CEILING

FLOORS

(SQUARE FEET)

(SQUARE FEET)

(SQUARE FEET)

TYPE OF INSULATION

TYPE OF INSULATION

TYPE OF INSULATION

MATERIAL

FIBERGLASS

MATERIAL

FIBERGLASS

MATERIAL

FIBERGLASS

FORM

BATTS

FORM

BATTS & BLOW

FORM

BATTS

MANUFACTURER'S PRODUCT I D

MANUFACTURER'S PRODUCT I D

MANUFACTURER'S PRODUCT I D

MANUFACTURER

MANUFACTURER

MANUFACTURER

OCF

OCF

OCF

BAGS

R - VALUE
INSTALLED

APPLIED
THICKNESS

R - VALUE
INSTALLED

APPLIED
THICKNESS

MIN. INSTALLED
WEIGHT PER
SQUARE FOOT

R - VALUE
INSTALLED

APPLIED
THICKNESS

13

3 5/8"

30
30

9"
12"

KNEE WALLS IF R-VALUE IS OTHER THAN WALLS ABOVE

MATERIAL

FIBERGLASS

FORM

BATTS

R VALUE

MANUFACTURER

OCF

AIR INFILTRATION SEALANT

MATERIAL

FOAM

MANUFACTURER

W R GRACE

THIS IS TO CERTIFY THAT INSULATION AND/OR SEALANT HAS BEEN INSTALLED IN CONFORMANCE WITH APPLICABLE CODES, MATERIAL STANDARDS AND REGULATIONS.

SIGNATURE - INSULATION CONTRACTOR

Bell Hernandez

TITLE

MANAGER

DATE

07-00

SIGNATURE - GENERAL CONTRACTOR

TITLE

DATE

REMARKS

RESIDENTIAL BUILDING PERMIT APPLICATION

New Construction Addition Remodels Other

Project Address: 59 Janis Circle

Assessor Parcel # 225-123-038

OWNER INFORMATION:

Legal Property Owner: Beazer Homes Phone # 773-3888
Owner Address: 3009 Douglas Blvd #150 City Roseville State CA Zip 95661

CONTRACTOR INFORMATION:

Contractor: Beazer Homes Llc. # 724191 Phone # 773-3888 Fax# 773-0425

PROJECT INFORMATION:

Land Use Zone _____ Occupancy Group R-5 Construction Type 5 Fed Code _____
No. of stories: 1 No. of rooms: 7 Street width: _____
1st Floor Area 1872 2nd Floor Area _____ Basement _____ Roof Material _____

38

AREA IN SQUARE FOOT OF:	EXISTING	NEW
Dwelling/Living	_____	<u>1872</u>
Garage/Storage	_____	<u>618</u>
Decks/Balconies	_____	_____
Carports	_____	_____

SCOPE OF WORK: SFD

FOR OFFICE USE ONLY

- Information above complete
- AR Flood Waiver required
- Planning Approval
- Violation files checked
- Flood Elevation Certificate Required
- Design Review Approval
- Standard setbacks
- Water Development Infill Area
- Special Fee Districts Apply : _____
- County Sewer

NEW STRUCTURES & ADDITIONS

❖ THE FOLLOWING MUST BE PROVIDED IN ORDER TO SUBMIT FOR PLAN REVIEW

- 2 COMPLETE PLANS, LEGIBLE & DRAWN TO SCALE
 - 3 SETS IF PROJECT IS IN A DESIGN REVIEW AREA
 - Title 24 Energy Compliance documentation
 - Grading and Erosion Control Questionnaire
 - 11" x 17" copy of floor plan for County Assessor
 - Plan Review Fees
- ❖ Plans to include: site plan, floor plan, elevations, roof/ceiling plan, foundation and structural framing details, and structural calculations for non-conforming structures.

Date: _____

Received by: (staff) _____

ACTIVITY/PERMIT # _____

THIS PLAN IS PREPARED TO SHOW THE DIMENSIONAL RELATIONSHIP FROM BUILDING FOUNDATION TO PROPERTY LINE, DESIGN DRAINAGE CONTROL ELEVATIONS, AND DIRECTION OF DRAINAGE FLOW TO CONFORM WITH LOCAL ORDINANCES FOR THE PURPOSE OF BUILDING PERMIT ISSUANCE. INFORMATION SHOWN IS APPROXIMATE EXCEPT FOR THOSE SETBACKS WHICH ARE MINIMUMS REQUIRED BY ORDINANCE. THIS PLOT DOES NOT REFLECT AS BUILT CONDITIONS WHICH WILL LIKELY VARY FROM THIS PLAN.

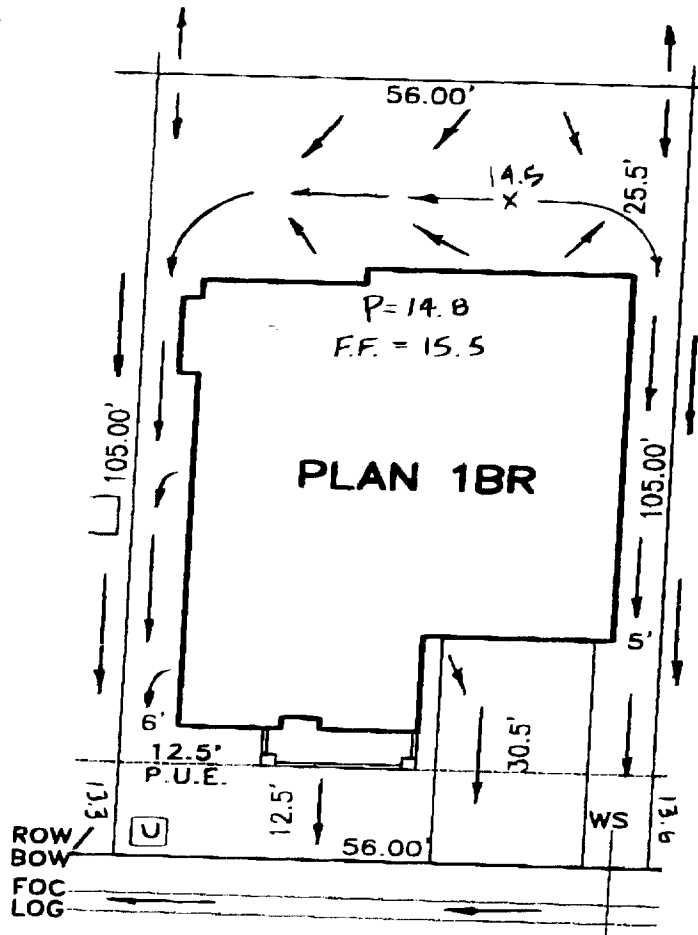
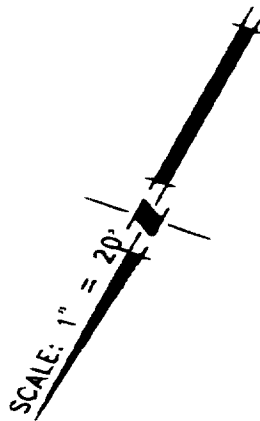

JARVIS CIRCLE

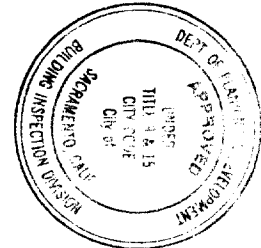

The owner of plans and specifications must be kept on the job at all times and it is unlawful to make any changes or alterations from the same without written permission from the Building Inspection Division.

The approval of this plan and specification SHALL NOT be held to permit or approve the violation of any City Ordinance or State Law.

ROUTING/APPROVAL		
	✓	INITIALS
President		
Project Development		
Construction	✓	<i>WR</i>
Marketing	✓	<i>AR</i>
in.		

U = UTILITY SERVICE BOX

LOT COVERAGE = 37.1%

PLOT PLAN
LOT 38
GATEWAY VILLAGE 2
 FOR
BEAZER HOMES
 SACRAMENTO CALIFORNIA

WOOD-RODGER INC.

DATE: SEPT. 1999	DRAWN: D.P.B.	PROJECT NO: 99BEZ-022
---------------------	------------------	--------------------------

JWH 9-6-99