

CITY OF SACRAMENTO
1231 I Street, Sacramento, CA 95814

Permit No: 0115973
Insp Area: 4
Thos Bros:
Sub-Type: NSFR
Housing (Y/N):

Site Address: 3759 GRESHAM LN SAC
Parcel No: 225-0160-010
N

WESTBOROUGH VILLAGE 4 LOT 10

CONTRACTOR
CHRISTOPHERSON HOMES INC.
1315 AIRPORT BLVD.
SANTA ROSA CA. 95403

OWNER

ARCHITECT

Nature of Work: MP 3170 2 STORY 10 ROOM NSFR

CONSTRUCTION LENDING AGENCY: I hereby affirm under penalty of perjury that there is a construction lending agency for the performance of the work for which this permit is issued (Sec. 3097, Civ. C).

Lender's Name _____ Lender's Address _____

LICENSED CONTRACTORS DECLARATION: I hereby affirm under penalty of perjury that I am licensed under provisions of Chapter 9 (commencing with section 7000) of Division 3 of the Business and Professions Code and my license is in full force and effect.

License Class B License Number 592027 Date 12.20.01 Contractor Signature A Run

OWNER-BUILDER DECLARATION: I hereby affirm under penalty of perjury that I am exempt from the contractors License Law for the following reason (Sec. 7031.5, Business and Professions Code; any city or county which requires a permit to construct, alter, improve, demolish, or repair any structure, prior to its issuance, also requires the applicant for such permit to file a signed statement that he or she is licensed pursuant to the provisions of the Contractors License Law (Chapter 9 (commencing with Section 7000) of Division 8 of the Business and Professions Code) or that he or she is exempt therefrom and the basis for the alleged exemption. Any violation of Section 7031.5 by any applicant for a permit subjects the applicant to a civil penalty of not more than five hundred dollars (\$500.00);

I, as a owner of the property, or my employees with wages as their sole compensation, will do the work, and the structure is not intended or offered for sale (Sec. 7044, Business and Professional Code: The Contractors License Law does not apply to an owner of property who builds or improves thereon, and who does such work himself or herself or through his/her own employees, provided that such improvements are not intended or offered for sale. If, however, the building or improvement is sold within one year of completion, the owner-builder will have the burden of proving that he/she did not build or improve for the purpose of sale.)

I, as owner of the property, am exclusively contracting with licensed contractors to construct the project (Sec. 7044, Business and Professions Code: The Contractors License Law does not apply to an owner of property who builds or improves thereon, and who contracts for such projects with a contractor(s) licensed pursuant to the Contractors License Law).

I am exempt under Sec. _____ B & PC for this reason: _____

Date _____ Owner Signature _____

IN ISSUING THIS BUILDING PERMIT, the applicant represents, and the city relies on the representation of the applicant, that the applicant verified all measurements and locations shown on the application or accompanying drawings and that the improvement to be constructed does not violate any law or private agreement relating to permissible or prohibited locations for such improvements. This building permit does not authorize any illegal location of any improvement or the violation of any private agreement relating to location of improvements.

I certify that I have read this application and state that all information is correct. I agree to comply with all city and county ordinances and state laws relating to building construction and hereby authorize representative(s) of this city to enter upon the above mentioned property for inspection purposes.

Date 12.20.01 Applicant/Agent Signature A Run

WORKER'S COMPENSATION DECLARATION: I hereby affirm under penalty of perjury one of the following declarations:
I have and will maintain a certificate of consent to self-insure for workers' compensation as provided for by Section 3700 of the Labor Code, for the performance of work for which the permit is issued.

I have and will maintain workers' compensation insurance, as required by Section 3700 of the Labor Code, for the performance of the work for which this permit is issued. My workers' compensation insurance carrier and policy number are:

Carrier State Fund Policy Number 2607505 Exp Date 12.02

(This section need not be completed if the permit is for \$100 or less) I certify that in the performance of the work for which this permit is issued, I shall not employ any person in any manner so as to become subject to the workers' compensation laws of California and agree that if I should become subject to the workers' compensation provisions of Section 3700 of the Labor Code, I shall forthwith comply with those provisions.

Date 12.20.01 Applicant Signature A Run

WARNING: FAILURE TO SECURE WORKER'S COMPENSATION COVERAGE IS UNLAWFUL AND SHALL SUBJECT AN EMPLOYER TO CRIMINAL PENALTIES AND CIVIL FINES UP TO ONE HUNDRED THOUSAND DOLLARS (\$100,000) IN ADDITION TO THE COST OF COMPENSATION, DAMAGES AS PROVIDED FOR IN SECTION 3706 OF THE LABOR CODE, INTEREST AND ATTORNEY'S FEE.

THIS PERMIT SHALL EXPIRE BY LIMITATION IF WORK IS NOT COMMENCED WITHIN 180 DAYS.

CERTIFICATION OF INSULATION

PART I GENERAL

ADDRESS OF TRACT CHRISTOPHERSON LOT # 110 The Avenues	SACRAMENTO BUILDING PRODUCTS <input checked="" type="checkbox"/> P.O. BOX 854, WEST SACRAMENTO, CA 95691 LIC. #202026 <input type="checkbox"/> 1309 MELODY ROAD, MARYSVILLE, CA 95901 LIC. #202026 <input type="checkbox"/> P.O. BOX 9651, FRESNO, CA 93793-9651 LIC. #202026 <input type="checkbox"/> P.O. BOX 1631, RENO, NV 89505 LIC. #10675 <input type="checkbox"/> 3326 A PONDEROSA WAY, LAS VEGAS, NV 89118 LIC. #10675 DATE INSULATION COMPLETED 5-9-02
---	--

WALLS		CEILING			FLOORS	
(SQUARE FEET)		(SQUARE FEET)			(SQUARE FEET)	
TYPE OF INSULATION		TYPE OF INSULATION			TYPE OF INSULATION	
FIBERGLASS		FIBERGLASS			FIBERGLASS	
BATTS		BATTS & BLOW			BATTS	
MANUFACTURER'S PRODUCT I.D.		MANUFACTURER'S PRODUCT I.D.			MANUFACTURER'S PRODUCT I.D.	
OCF		OCF			OCF	
BAGS						
R-VALUE INSTALLED	APPLIED THICKNESS	R-VALUE INSTALLED	APPLIED THICKNESS	MIN. INSTALLED WEIGHT PER	R-VALUE INSTALLED	APPLIED THICKNESS
13	3 5/8	38 38	12 14 1/4			

ROOF WALLS R-VALUE IS OTHER THAN WALLS

MATERIAL FIBERGLASS	FORM BATTS	R VALUE	MANUFACTURER OCF
-------------------------------	----------------------	---------	----------------------------

AIR INFILTRATION SEALANT

MATERIAL FOAM	MANUFACTURER W R GRACE
-------------------------	----------------------------------

THIS IS TO CERTIFY THAT AN AIR INFILTRATION SEALANT HAS BEEN INSTALLED IN ACCORDANCE WITH APPLICABLE CODES.

SIGNATURE—INSULATION CONTRACTOR <i>Jeff Cable</i>	TITLE MANAGER	DATE 5-13-02
SIGNATURE—GENERAL CONTRACTOR	TITLE	DATE

REMARKS:

RESIDENTIAL SUBDIVISION BUILDING PERMIT APPLICATION

Project Address: 375A Gresham Assessor Parcel # 225-160-010
Lot Number: 10 Ln. Subdivision Westborough Village 4
Phase 1

OWNER INFORMATION:

Legal Property Owner: Westlake Village Unit 4 Investors, A.C.L.P. Phone# 707.524.8222
Owner Address: 1315 Airport Blvd. City Santa Rosa State CA Zip 95403

CONTRACTOR INFORMATION:

Area Code (707)

Contractor: Christopherson Homes, Inc. Lic. # 592027 Phone # 524.8222 Fax 524.8234

PROJECT INFORMATION:

Land Use Zone R1A Occupancy Group R3 Construction Type VN Fed Code 1A
No. of Stories: 2 No. of Rooms: 14 Street Width: _____
1st Floor Area 1663 2nd Floor Area 1444 Basement na Roof Material tile
AREA IN SQUARE FOOT OF:
Dwelling/Living 3107
Garage/Storage 764
Decks/Balconies na
Carports na
SCOPE OF WORK: New S.F.D. w/Attached Garage
Plan 4A-3L

FOR OFFICE USE ONLY

- Information Above Complete
- Violation Files Checked
- Standard Setbacks
- County Sewer
- AR Flood Waiver Required
- Flood Elevation Certificate Required
- Water Development Infill Area
- Planning Approval
- Design Review Approval
- Special Fee Districts Apply:

THE FOLLOWING MUST BE PROVIDED IN ORDER TO SUBMIT FOR PERMIT

- 2 COMPLETE PLOT PLANS, LEGIBLE & DRAWN TO SCALE
- 11 X 17 COPY OF FLOOR PLAN WITH FOLLOWING INFORMATION
 - a) Assessor's Parcel Number
 - b) New Floor Area
 - c) Owners Name
 - d) Project Address

209329¹³
0115973

This set of plans and specifications must be kept on the job at all times and it is unlawful to make any changes or alterations from the same without written permission from the Building Inspection Division.

The approval of this plan and specification SHALL NOT be held to permit or approve the violation of any City Ordinance or State Law.

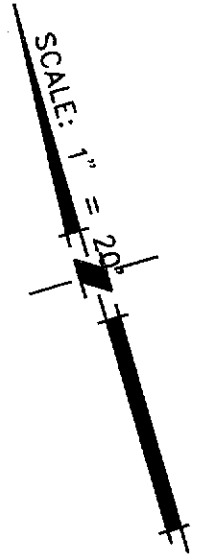
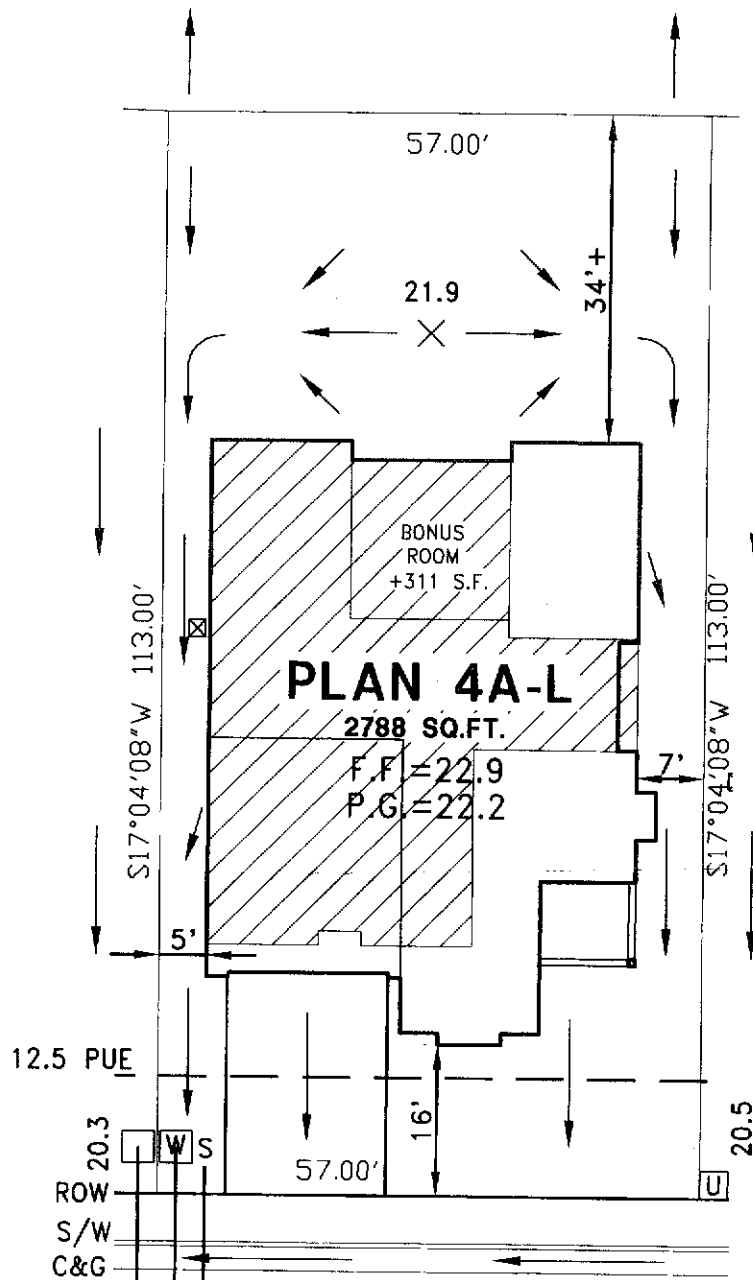
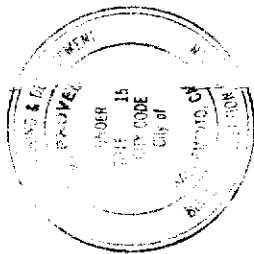

GRESHAM LANE

U = UTILITY SERVICE BOX

3759 GRESHAM LANE
 A.P.N. : 225-1600-061
 LOT COVERAGE: 48.1%
 LOT SQUARE FOOTAGE: 6441
 STREET WIDTH: 31'

UNAUTHORIZED CHANGES & USES: THE ENGINEER PREPARING THIS PLOT WILL NOT BE RESPONSIBLE FOR, OR LIABLE FOR, UNAUTHORIZED CHARGES TO OR USES OF THIS PLOT. ALL CHANGES TO THIS PLOT MUST BE IN WRITING AND MUST BE APPROVED BY THE ENGINEER. THE INFORMATION ON THIS PLOT PLAN IS PROVIDED FOR YOUR CONVENIENCE AS A GUIDE TO THE GENERAL LOCATION OF THE SUBJECT PROPERTY. THE OF THIS PLOT PLAN IS NOT GUARANTEED. NOR IS IT A PART OF ANY POLICY, REPORT, OR GUARANTEE TO WHICH IT MAY BE ATTACHED. ACTUAL DIMENSIONS MAY VARY OR CHANGE WITHOUT PRIOR NOTICE DUE TO ACTUAL SITE CONDITIONS.

SIGNED(BUYER) _____ DATE: _____
 SIGNED(BUYER) _____ DATE: _____

WOOD RODGERS INC.

ENGINEERING PLANNING MAPPING SURVEYING
 3301 C STREET, BLDG. 100-B, SACRAMENTO, CA 95816
 PHONE: (916) 341-7760 FAX: (916) 341-7767

WESTBOROUGH VILLAGE 4 PHASE 1

LOT 10
 PLAN 4A-L

CITY OF SACRAMENTO,

CALIFORNIA

OCT 2001

DRAWN:HMB

CHECKED: *[Signature]*

1122.043