

CITY OF SACRAMENTO
1231 I Street, Sacramento, CA 95814

Permit No: 0108356
Insp Area: 4

Site Address: 3126 SPINNING ROD WY SAC
Parcel No: 274-0600-020 LOT20 RIVERWALK

Sub-Type: NSFR
Housing (Y/N): N

CONTRACTOR
MYERS HOMES INC.
3300 FITZGERALD RD.
RANCHO CORDOVA CA 95742

OWNER

ARCHITECT

Nature of Work: NSFR MP2421 8 RMS 1 STORY

CONSTRUCTION LENDING AGENCY: I hereby affirm under penalty of perjury that there is a construction lending agency for the performance of the work for which this permit is issued (Sec. 3097, Civ. C.)

Lender's Name _____ Lender's Address _____

LICENSED CONTRACTORS DECLARATION: I hereby affirm under penalty of perjury that I am licensed under provisions of Chapter 9 (commencing with section 7000) of Division 3 of the Business and Professions Code and my license is in full force and effect.

License Class B License Number 744473 Date 7-24-01 Contractor Signature R. Rose

OWNER-BUILDER DECLARATION: I hereby affirm under penalty of perjury that I am exempt from the contractors License Law for the following reason (Sec. 7031.5, Business and Professions Code, any city or county which requires a permit to construct, alter, improve, demolish, or repair any structure, prior to its issuance, also requires the applicant for such permit to file a signed statement that he or she is licensed pursuant to the provisions of the Contractors License Law (Chapter 9 (commencing with Section 7000) of Division 8 of the Business and Professions Code) or that he or she is exempt therefrom and the basis for the alleged exemption: Any violation of Section 7031.5 by any applicant for a permit subjects the applicant to a civil penalty of not more than five hundred dollars (\$500.00).

I, as a owner of the property, or my employees with wages as their sole compensation, will do the work, and the structure is not intended or offered for sale (Sec. 7044, Business and Professional Code). The Contractors License Law does not apply to an owner of property who builds or improves thereon, and who does such work himself or herself or through his/her own employees, provided that such improvements are not intended or offered for sale. If, however, the building or improvement is sold within one year of completion, the owner-builder will have the burden of proving that he/she did not build or improve for the purpose of sale.

I, as owner of the property, am exclusively contracting with licensed contractors to construct the project (Sec. 7044, Business and Professions Code). The Contractors License Law does not apply to an owner of property who builds or improves thereon, and who contracts for such projects with a contractor(s) licensed pursuant to the Contractors License Law.

I am exempt under Sec. _____ B & PC for this reason _____

Date _____ Owner Signature _____

IN ISSUING THIS BUILDING PERMIT, the applicant represents, and the city relies on the representation of the applicant, that the applicant verified all measurements and locations shown on the application or accompanying drawings and that the improvement to be constructed does not violate any law or private agreement relating to permissible or prohibited locations for such improvements. This building permit does not authorize any illegal location of any improvement or the violation of any private agreement relating to location of improvements.

I certify that I have read this application and state that all information is correct. I agree to comply with all city and county ordinances and state laws relating to building construction and hereby authorize representative(s) of this city to enter upon the abovementioned property for inspection purposes.

Date 7-24-01 Applicant Agent Signature R. Rose

WORKER'S COMPENSATION DECLARATION: I hereby affirm under penalty of perjury one of the following declarations:

I have and will maintain a certificate of consent to self-insure for workers' compensation as provided for by Section 3700 of the Labor Code, for the performance of work for which the permit is issued.

RR I have and will maintain workers' compensation insurance, as required by Section 3700 of the Labor Code, for the performance of the work for which this permit is issued. My workers' compensation insurance carrier and policy number are:

Carrier RELIANCE NATIONAL INS CO Policy Number NWAO154613-01 **CITY OF SACRAMENTO** PAID Exp Date 04/01/2001

(This section need not be completed if the permit is for \$100 or less) I certify that in the performance of the work for which this permit is issued, I shall not employ any person in any manner so as to become subject to the workers' compensation laws of California and agree that if I should become subject to the workers' compensation provisions of Section 3700 of the Labor Code, I shall forthwith comply with those provisions.

Date 7-24-01 Applicant Signature R. Rose

CITY OF SACRAMENTO
NEIGHBORHOODS, PLANNING AND DEVELOPMENT SERVICES

WARNING: FAILURE TO SECURE WORKER'S COMPENSATION COVERAGE IS UNLAWFUL AND SHALL SUBJECT AN EMPLOYER TO CRIMINAL PENALTIES AND CIVIL FINES UP TO ONE HUNDRED THOUSAND DOLLARS (\$100,000) IN ADDITION TO THE COST OF COMPENSATION DAMAGES AS PROVIDED FOR IN SECTION 3706 OF THE LABOR CODE, INTEREST AND ATTORNEY'S FEE.

THIS PERMIT SHALL EXPIRE BY LIMITATION IF WORK IS NOT COMMENCED WITHIN 180 DAYS.

LOT 20

OMEGA PRODUCTS CORP.

DIAMOND WALL INSULATING STUCCO SYSTEM

JOB ADDRESS:

3126 Spinning Rod Way

ICBO Report 84004

Date of Job Completion 11/10/01

PLASTERING CONTRACTOR:

Name: Norcal Plastering

Address: Box 355 Lincoln Ca 95648

Telephone No: (916) 645-7337

Contractor Number of Diamond Wall System 2130

This is to certify that the exterior coating system on the building exterior at the above address has been installed in accordance with the evaluation report specified above and the manufacturer's instructions.

Date _____

Jim Hueston
Signature of authorized representative of
Plastering Contractor

This installation card must be presented to the building inspector after completion of work and before final inspection.

CERTIFICATION OF INSULATION

MEYERS

LOT # **20**

- P.O. BOX 864, WEST SACRAMENTO, CA 95901 LIC. #202026
- 1309 MELODY ROAD, MARYSVILLE, CA 95901 LIC. #202026
- P.O. BOX 9651, FRESNO, CA 93793-9651 LIC. #202026
- P.O. BOX 1831, RENO, NV 89505 LIC. #10675
- 3326 A PONDEROSA WAY, LAS VEGAS, NV 89118 LIC. #10675

RIVERWALK

DATE INSULATION COMPLETED

WALLS (SQUARE FEET)	ROOFS (SQUARE FEET)	FLOORS (SQUARE FEET)
MATERIAL FIBERGLASS	MATERIAL FIBERGLASS	MATERIAL FIBERGLASS
FORM BATTS	FORM BATTS & BLOW	FORM BATTS
MANUFACTURER'S PRODUCT I.D.	MANUFACTURER'S PRODUCT I.D.	MANUFACTURER'S PRODUCT I.D.

WALLS		ROOFS		FLOORS	
THICKNESS	INCHES	THICKNESS	INCHES	THICKNESS	INCHES
13	5 1/2	30	12		

MATERIAL	FORM	THICKNESS	INCHES	SQUARE FOOT	MANUFACTURER
FIBERGLASS	BATTS			19	OCF
FOAM					W R GRACE

INSULATION CERTIFIED TO MEET INSULATION MATERIAL STANDARDS AND REGULATIONS

SIGNATURE - INSULATION CONTRACTOR: *Jeff Cable* TITLE: **MANAGER** DATE: **10/30/07**

SIGNATURE - GENERAL CONTRACTOR: _____ TITLE: _____ DATE: _____

REMARKS

5

Lot 20

RESIDENTIAL BUILDING PERMIT APPLICATION

- New Construction
- Addition
- Remodels
- Other

Project Address: 3126 Spinning Rod Way Assessor Parcel # 274-060-020
SACRAMENTO, CA 95833

OWNER INFORMATION:

Legal Property Owner: MYERS HOMES OF CALIFORNIA, LLC Phone # 916-851-0530
 Owner Address: 3300 FITZGERALD RD City RANCHO GORDONIA State CA Zip 95742

CONTRACTOR INFORMATION:

Contractor: MYERS HOMES, INC. Lic. # 744473 Phone # 916-851-0530 Fax # 916-851-0535

PROJECT INFORMATION:

Land Use Zone R-1A RD Occupancy Group R-3 Construction Type VN Fed Code 1A
 No. of stories: 1 No. of rooms: 13 Street width: 50 FT
 1st Floor Area 2421 2nd Floor Area N/A Basement N/A Roof Material TILE

AREA IN SQUARE FOOT OF:	EXISTING	NEW
Dwelling/Living	_____	<u>2421</u>
Garage/Storage	_____	<u>609</u>
Decks/Balconies	_____	<u>192 COVERED FRONT PORCH</u>
Carports	_____	_____

SCOPE OF WORK: NEW CONSTRUCTION OF SINGLE FAMILY RESIDENCE ; RIVERWALK SERIES II, PLAN S / 2421 IN MASTER PLAN COMMUNITY P99-075

P99-005 AMENDED

FOR OFFICE USE ONLY:

- Information above complete
- AR Flood Waiver required
- Planning Approval
- Violation files checked
- Flood Elevation Certificate Required
- Design Review Approval
- Standard setbacks
- Water Development Infill Area
- Special Fee Districts Apply : _____
- County Sewer

NEW STRUCTURES & ADDITIONS

THE FOLLOWING MUST BE PROVIDED IN ORDER TO SUBMIT FOR PLAN REVIEW

- 2 COMPLETE PLANS, LEGIBLE & DRAWN TO SCALE *Plans to include: site plan, floor plan, elevations, roof/ceiling plan, foundation and structural framing details, and structural calculations for non-conforming structures.*
- 3 SETS IF PROJECT IS IN A DESIGN REVIEW AREA
- Title 24 Energy Compliance documentation
- 11' x 17" copy of floor plan for County Assessor
- Grading and Erosion Control Questionnaire
- Plan Review Fees

Date: _____

Received by: (staff) _____

ACTIVITY/PERMIT # _____

Handwritten signature/initials



WALLACE • KUHL & ASSOCIATES INC.
 GEOTECHNICAL ENGINEERING • CONSTRUCTION TESTING

3050 Industrial Blvd.
 PO Box 1137
 West Sacramento
 California 95691
 916-372-1434

DATE	10/1/01		JOB NO.	3720.02		WEATHER			TEMP.	" at	AM
PROJECT	Riverwalk / Myers Homes					Technician I	<input type="checkbox"/>	Staff E/G	<input type="checkbox"/>		
LOCATION	W. Elcamino					Technician II	<input type="checkbox"/>	Project E/G	<input type="checkbox"/>		
TYPE OF WORK	Pull Test.					Technician III	<input type="checkbox"/>	Senior E/G	<input type="checkbox"/>		
Inside 50 mi. radius	<input type="checkbox"/>	Outside 50 mi. radius	<input type="checkbox"/>			Nuclear Densities	<input type="checkbox"/>	Principal E/G	<input type="checkbox"/>		
PERSONNEL	REG. HRS	OT HRS	TOTAL HRS	TRAVEL	ON JOB	VEHICLE		MILES			
<i>SB</i>						#18					

OBSERVATIONS: On site 8:20 AM. to perform pull test on 5/8" anchor bolts in the following lot #s 18-1 each. 19-2 each. 20-~~1~~ 1 each. 21-1 each. All passed with 5,800 LBS of pressure per Simpson Adhesive load tables.

FIELD REPORT

Signed *Daren Redden*

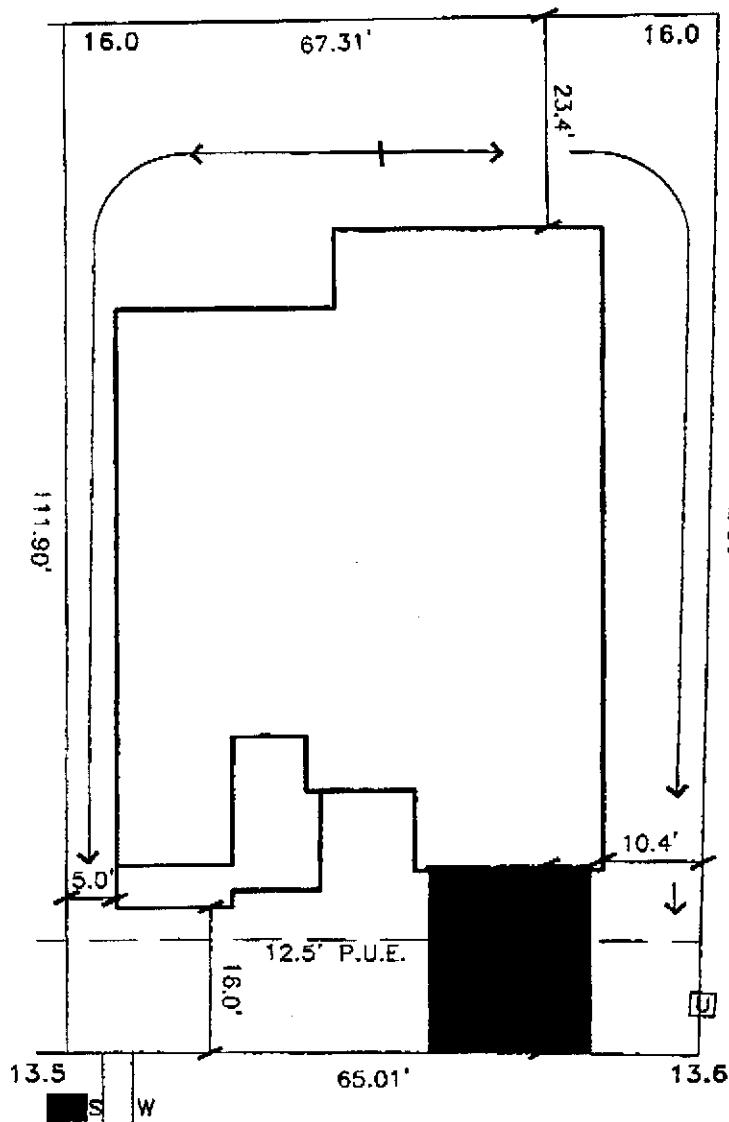

THIS PLAN IS THE PROPERTY OF STANTEC CONSULTING INC. AND IS NOT TO BE REPRODUCED OR TRANSMITTED IN ANY FORM OR BY ANY MEANS, ELECTRONIC OR MECHANICAL, INCLUDING PHOTOCOPYING, RECORDING, OR BY ANY INFORMATION STORAGE AND RETRIEVAL SYSTEM, WITHOUT THE WRITTEN PERMISSION OF STANTEC CONSULTING INC.

SPINNING ROD WAY



DATE: 05-17-01

A.P.N.:

ADDRESS:

SPINNING ROD WAY

LOT AREA: 7,427 SF

LOT COVERAGE: 44%



Stantec

Stantec Consulting Inc.
 2090 Techni-Polis Way
 Sacramento, CA 95833-1258
 Tel: 916.921.5000
 Fax: 916.921.5074
 www.stantec.com

**RIVERWALK
 UNIT NO. 2**

**LOT 20
 PLAN 2421B**

RIVERWALK

CITY OF SACRAMENTO, CA.

CLIENT: MYERS HOMES

JOB NO.: 84300072