

CITY OF SACRAMENTO

Permit No: 9812222

1231 I Street, Sacramento, CA 95814

Insp Area: 2

Site Address: 4368 BATT DR SAC

Sub-Type: N1/2PLEX

Parcel No: 2370580034

LOT 20B/SHERMAN OAKS

Housing (Y/N): N

CONTRACTOR

3B PROPERTIES
P O BOX 609
RIO LINDA CA 95673

OWNER

CALIFORNIA SECURITY BANK
1694 TULLY RD
SAN JOSE CA 95122

ARCHITECT

Nature of Work: NEW HALF-PLEX (SIDE B), MP1248, 5 ROOMS

CONSTRUCTION LENDING AGENCY: I hereby affirm under penalty of perjury that there is a construction lending agency for the performance of the work for which this permit is issued (Sec. 3097, Civ. C).

Lender's Name Lender's Address

LICENSED CONTRACTORS DECLARATION: I hereby affirm under penalty of perjury that I am licensed under provisions of Chapter 9 (commencing with section 7000) of Division 3 of the Business and Professions Code and my license is in full force and effect.

License Class B License Number 404134 Date 12-14-98 Contractor Signature [Signature]

OWNER-BUILDER DECLARATION: I hereby affirm under penalty of perjury that I am exempt from the contractors License Law for the following reason (Sec. 7031.5, Business and Professions Code; any city or county which requires a permit to construct, alter, improve, demolish, or repair any structure, prior to its issuance, also requires the applicant for such permit to file a signed statement that he or she is licensed pursuant to the provisions of the Contractors License Law (Chapter 9 (commencing with Section 7000) of Division 8 of the Business and Professions Code) or that he or she is exempt therefrom and the basis for the alleged exemption. Any violation of Section 7031.5 by any applicant for a permit subjects the applicant to a civil penalty of not more than five hundred dollars (\$500.00);

I, as a owner of the property, or my employees with wages as their sole compensation, will do the work, and the structure is not intended or offered for sale (Sec. 7044, Business and Professional Code: The Contractors License Law does not apply to an owner of property who builds or improves thereon, and who does such work himself or herself or through his/her own employees, provided that such improvements are not intended or offered for sale. If, however, the building or improvement is sold within one year of completion, the owner-builder will have the burden of proving that he/she did not build or improve for the purpose of sale.)

I, as owner of the property, am exclusively contracting with licensed contractors to construct the project (Sec. 7044, Business and Professions Code: The Contractors License Law does not apply to an owner of property who builds or improves thereon, and who contracts for such projects with a contractor(s) licensed pursuant to the Contractors License Law).

I am exempt under Sec. B & PC for this reason: DEL 14 1998

Date 12-14-98 Owner Signature [Signature]

IN ISSUING THIS BUILDING PERMIT, the applicant represents, and the city relies on the representation of the applicant, that the applicant verified all measurements and locations shown on the application or accompanying drawings and that the improvement to be constructed does not violate any law or private agreement relating to permissible or prohibited locations for such improvements. This building permit does not authorize any illegal location of any improvement or the violation of any private agreement relating to location of improvements.

I certify that I have read this application and state that all information is correct. I agree to comply with all city and county ordinances and state laws relating to building construction and hereby authorize representative(s) of this city to enter upon the abovementioned property for inspection purposes.

Date 12-14-98 Applicant/Agent Signature [Signature]

WORKER'S COMPENSATION DECLARATION: I hereby affirm under penalty of perjury one of the following declarations:

I have and will maintain a certificate of consent to self-insure for workers' compensation as provided for by Section 3700 of the Labor Code, for the performance of work for which the permit is issued.

I have and will maintain workers' compensation insurance, as required by Section 3700 of the Labor Code, for the performance of the work for which this permit is issued. My workers' compensation insurance carrier and policy number are:

Carrier Policy Number Exp Date

(This section need not be completed if the permit is for \$100 or less) I certify that in the performance of the work for which this permit is issued, I shall not employ any person in any manner so as to become subject to the workers' compensation laws of California and agree that if I should become subject to the workers' compensation provisions of Section 3700 of the Labor Code, I shall forthwith comply with those provisions.

Date 12-14-98 Applicant Signature [Signature]

WARNING: FAILURE TO SECURE WORKER'S COMPENSATION COVERAGE IS UNLAWFUL AND SHALL SUBJECT AN EMPLOYER TO CRIMINAL PENALTIES AND CIVIL FINES UP TO ONE HUNDRED THOUSAND DOLLARS (\$100,000) IN ADDITION TO THE COST OF COMPENSATION, DAMAGES AS PROVIDED FOR IN SECTION 3706 OF THE LABOR CODE, INTEREST AND ATTORNEY'S FEE.

THIS PERMIT SHALL EXPIRE BY LIMITATION IF WORK IS NOT COMMENCED WITHIN 180 DAYS.

Certificate of Compliance

Submission of Development Fees

PART I To be completed by APPLICANT

Owner's Name & Address 3B Properties
 Project Address 1131 Martinson Dr. & 4368-BAH Drive
 Parcel Number _____ Lot No. 20A - 20B
 Subdivision Name Sherman Oaks Number of Units 2
 Applicant's Signature & Title Ray N. _____
 Date 12-12-98 Phone No. _____

NOTICE TO APPLICANT: Pursuant to Government Code Section 66020(d), this will serve to notify you that the 90-day approval period in which you may protest the fees or other payment identified above will begin to run on the date in which the building or installation permit for this project is issued or on which they are paid to the district(s) or to another public entity authorized to collect them on behalf of the district(s), whichever is earlier.

PART II To be completed by BUILDING DEPARTMENT

Plan Identification Number _____ Building Type (CHECK ONE)
 Square Feet of Chargeable Building Area 1189 Residential
 Signature _____ Apartment / Condominium
 Title _____ Commercial / Industrial
 Date _____

PART III To be completed by SCHOOL DISTRICTS

Grant Joint Union High School District	
District Certification No.	<u>075-99</u>
EXEMPT	
Comments	_____
RESIDENTIAL / APARTMENT / CONDOMINIUM	
<u>1189</u> Sq. Ft. X \$ <u>.91</u> = \$ _____	
COMMERCIAL / INDUSTRIAL	
_____ Sq. Ft. X \$ _____ = \$ _____	
OTHER FEE: TYPE	
_____ Sq. Ft. X \$ _____ = \$ _____	
TOTAL FEES COLLECTED = \$ _____	

Robla Elementary School District	
District Certification No.	<u>99-011</u>
EXEMPT	
Comments	<u>1189 sq ft per unit</u>
RESIDENTIAL / APARTMENT / CONDOMINIUM	
<u>2378</u> Sq. Ft. X \$ <u>.7699</u> = \$ <u>1,830.82</u>	
COMMERCIAL / INDUSTRIAL	
_____ Sq. Ft. X \$ _____ = \$ _____	
OTHER FEE: TYPE	
_____ Sq. Ft. X \$ _____ = \$ _____	
TOTAL FEES COLLECTED = \$ <u>1,830.82</u>	

This certification covers only the amount of square footage indicated above. Any additions or corrections to the square footage for this project will require an amendment to the Certificate of Compliance.

As the authorized school district official, I hereby certify that the requirements of Government Code Section 65995 and any other authorized requirements have been complied with by the above signed applicant.

GRANT	ROBLA
Authorized School District Official	
Signature <u>[Signature]</u>	Signature <u>[Signature]</u>
Title <u>Secretary</u>	Title <u>Acct. Technician</u>
Date <u>12-14-98</u>	Date <u>12-14-98</u>

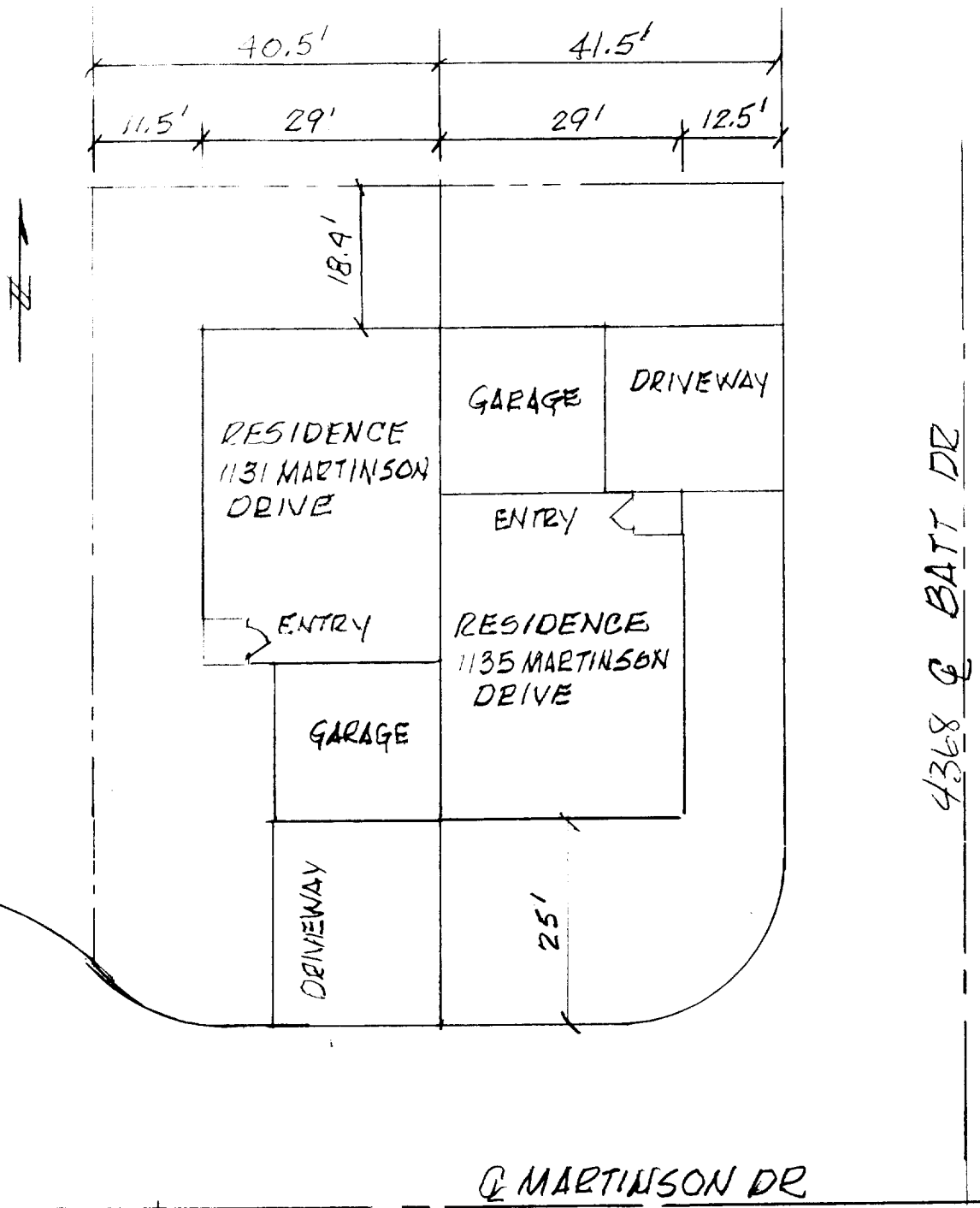

PLOT PLAN
 SCALE: 1" = 20'