



# REPORT TO COUNCIL

## City of Sacramento

10

915 I Street, Sacramento, CA 95814-2671  
www.CityofSacramento.org

Consent  
**June 13, 2006**

Honorable Mayor and  
Members of the City Council

**Subject:** Contract: Charlie Jensen Park, CIP LW76

**Location/Council District:** 6432 Park Village Street, Council District 4

**Recommendation:** Adopt a Resolution: 1) Accepting Parker Landscape Development as the responsible, low bidder with the base bid and additive alternate of \$183,182.46 and 2) Awarding the construction contract to Parker Landscape Development in the amount of \$183,182.46 for Charlie Jensen Park, CIP LW76.

**Contact:** Janet Baker, Park Development Manager, 808-8234

**Presenters:** Not applicable

**Department:** Parks & Recreation

**Division:** Park Planning, Design & Development

**Organization No:** 4727

### **Summary:**

Charlie Jensen Park (located in the East Land Park Village development) is a 2-acre park located at 6432 Park Village Street. On November 29, 2005, the City Council approved the name and the master plan for Charlie Jensen Park. There are adequate funds available for construction. Staff recommends accepting Parker Landscape Development as the responsible, low bidder with the base bid and additive alternate of \$183,182.46 and awarding the construction contract to Parker Landscape Development in the amount of \$183,182.46 for Charlie Jensen Park, CIP LW76.

### **Committee/Commission Action:**

The Charlie Jensen Park name and master plan were reviewed and approved by the Parks and Recreation Commission on October 13, 2005. Members requested that more trees be added and a narrow strip of turf be removed replacing it with native plants on the south end of the park site. The department has added these changes to the construction document plans.

**Background Information:**

Charlie Jensen Park is located in the East Land Park Village development (Attachment 1, page 5). The master plan (Attachment 2, page 6) for the 2-acre park was created through the public participation process. The Charlie Jensen Park Master Plan includes the following: basic landscaping, a bike trail, open turf, an adventure play area, a picnic shelter with picnic tables, trash receptacles, and a natural area.

On November 29, 2005, the City Council approved the name and the master plan for Charlie Jensen Park.

The project was posted and the bids were opened on May 3, 2006. Staff received nine bids and the results are listed below.

<u>CONTRACTOR</u>	<u>Base Bid</u>	<u>Additive Alternate</u>	<u>Total Bid</u>	<u>ESBE %</u>
Parker Landscape Development	\$175,259.46	\$7,923.00	\$183,182.46	84.2
Valley Crest Landscape	\$184,928.20	\$9,266.00	\$194,194.20	22.9
Olympic Land Construction	\$198,229.15	\$4,620.00	\$202,849.15	95.1
Hemington Landscape Services	\$201,738.00	\$9,500.00	\$211,238.00	23.2
Biundo Landscape Construction	\$208,132.75	\$12,000.00	\$220,132.75	81.0
JM Slover, Inc.	\$218,394.37	\$9,609.00	\$228,003.37	92.5
Planned Environments	\$223,047.66	\$10,469.37	\$233,517.03	95.5
Ad Land Venture	\$256,922.81	\$8,745.00	\$265,667.81	28.4
Gold Valley Construction	\$289,192.30	\$8,200.00	\$297,392.30	60.5

Parker Landscape Development was the responsible, low bidder with the base bid and additive alternate (drinking fountain and associated items) of \$183,182.46.

**Financial Considerations:**

Funding of \$290,000 was approved by the City Council during the 2003 Capital Improvement Program (CIP) report (CIP LW76) for the master planning and development of the park. The park funds were generated from Park Impact Fees collected in the new neighborhood surrounding the park (Planning Area 3).

There will be approximately \$16,400 per year in ongoing operational and maintenance costs for Charlie Jensen Park: \$12,000 in park maintenance and \$4,400 in water and utility costs.

The Neighborhood Park Maintenance Community Facilities District (CFD) was established to reduce reliance on the general fund for neighborhood park maintenance and to preserve the level of maintenance in the parks system. It was projected that revenues from the CFD would provide approximately 60% of the cost associated with maintaining new neighborhood parks for those areas that annex to the District.

Since some areas have not annexed to the District, the percentage of costs covered will fall below the 60% level. The balance of costs must be borne by the Citywide Landscape and Lighting District and other city funds. Existing parks and all community parks, regional parks, open space, trails and buffer areas are not covered by the CFD.

**Environmental Considerations:**

The Development Services Department, Environmental Planning Services Division has reviewed this project and determined that the project is exempt from the provisions of the California Environmental Quality Act (CEQA) under Class 1, Section 15301(a), Class 3 and Class 4, Section numbers 15304(b) and 15304(f) of the CEQA Guidelines. Projects exempt under Class 1, Section number 15301(c) consists of minor alteration to existing highways and streets including bicycle and pedestrian trails. Projects exempt under Class 3 consist of new construction of small structures or facilities. Projects exempt under Class 4, Section number 15304(b) consists of new gardening or landscaping and projects exempt under Class 4, Section number 15304(f) consists of minor trenching and backfilling where the surface is restored.

**Policy Considerations:**

Providing Parks and Recreation facilities is consistent with the City's strategic plan to enhance liveability in Sacramento's neighborhoods by expanding park and recreation facilities throughout the City.

**Emerging Small Business Development (ESBD):**

The selection of consultants and contractors for this project followed City established guidelines for inclusion of ESBD firms. At an SBE/EBE percentage total of 84.2%, Parker Landscape Development and their subcontractors are well above the meeting the City's required 20% ESBD rate.

Respectfully Submitted by:



**ROBERT G. OVERSTREET II**  
Director of Parks and Recreation

Recommendation Approved:

  
for **RAY KERRIDGE**  
City Manager

**Table of Contents:**

Pg	1-4	Report
Pg	5	Attachment 1 –Area Map
Pg	6	Attachment 2 – Charlie Jensen Park Master Plan
Pg	7	Resolution

Attachment 1 – Area Map

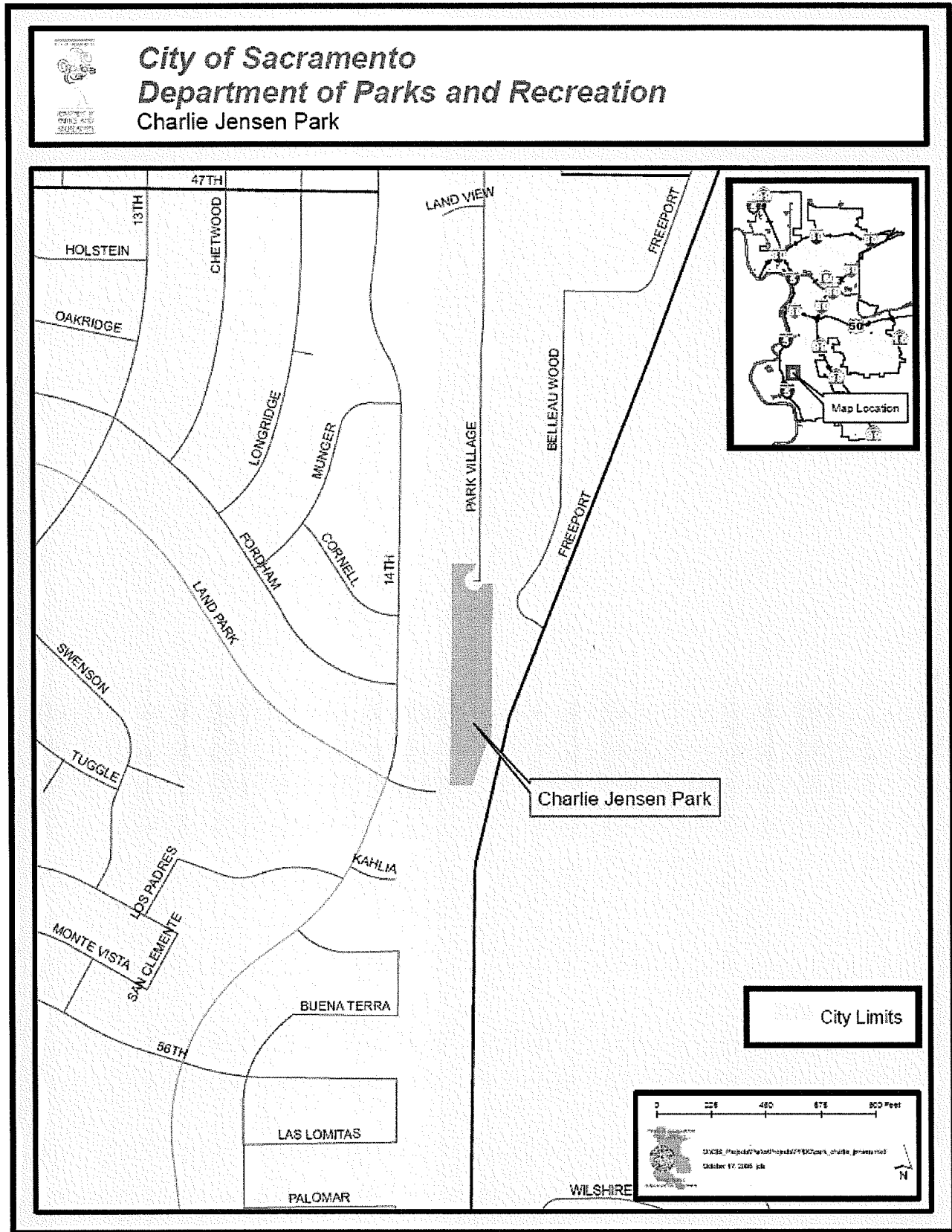

Attachment 2 – Charlie Jensen Park Master Plan

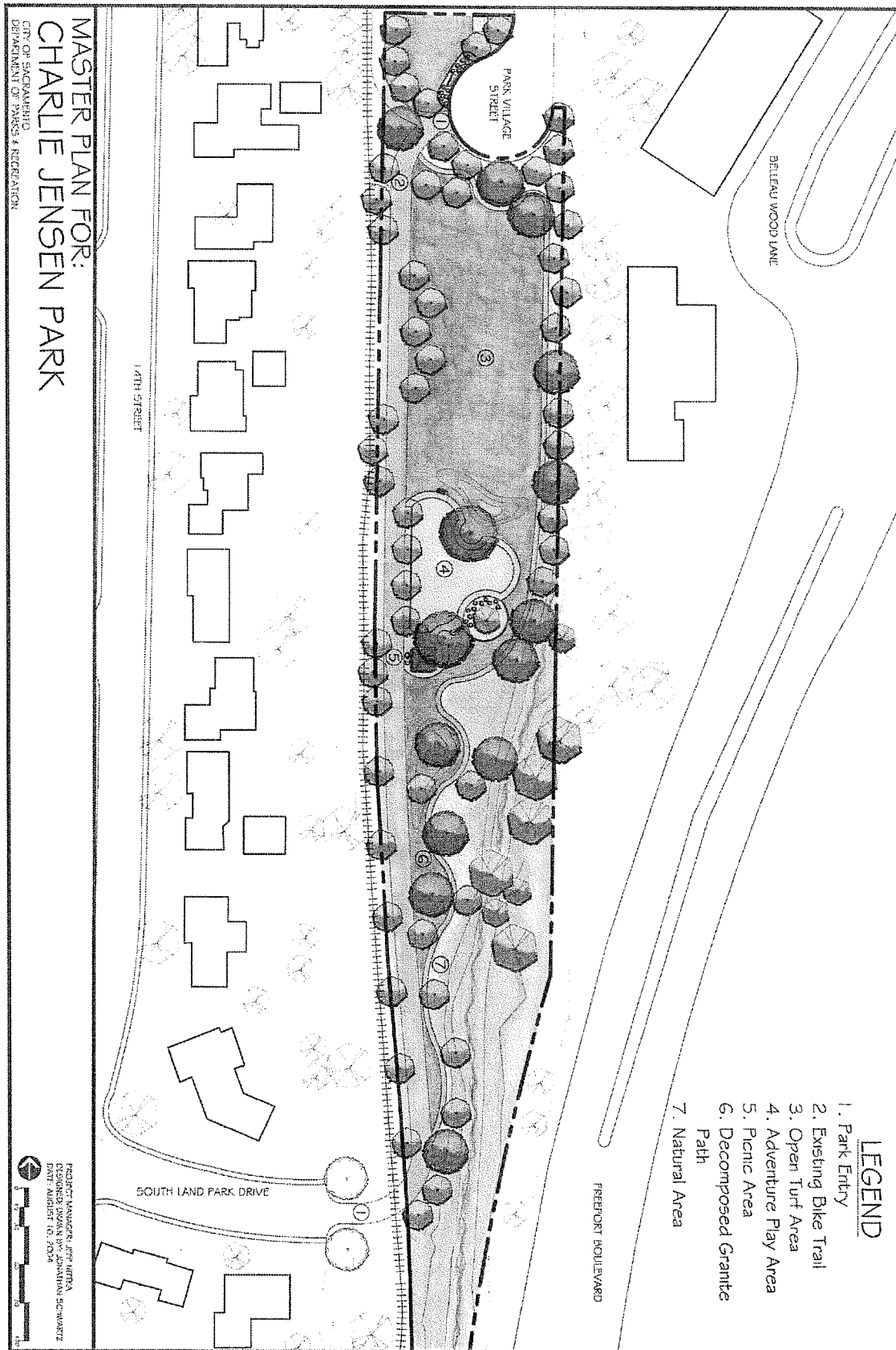

**RESOLUTION NO. 2006-XXXX**  
**Adopted by the Sacramento City Council**  
**June 13, 2006**

**ACCEPTING PARKER LANDSCAPE DEVELOPMENT AS THE RESPONSIBLE,  
LOW BIDDER WITH THE BASE BID AND ADDITIVE ALTERNATE OF \$183,182.46  
AND AWARDING THE CONSTRUCTION CONTRACT TO PARKER LANDSCAPE  
DEVELOPMENT IN THE AMOUNT OF \$183,182.46  
FOR CHARLIE JENSEN PARK, CIP LW76**

**BACKGROUND:**

- A. The City Council approved funding for development and construction of this project in the 2003 annual CIP report.
- B. On November 29, 2005, the City Council approved the name and the master plan for Charlie Jensen Park.

**BASED ON THE FACTS SET FORTH IN THE BACKGROUND, THE CITY COUNCIL  
RESOLVES AS FOLLOWS:**

- Section 1. Accepts Parker Landscape Development as the responsible, low bidder with the base bid and additive alternate of \$183,182.46.
- Section 2. Awards the construction contract to Parker Landscape Development in the amount of \$183,182.46 for Charlie Jensen Park, CIP LW76.