

CITY OF SACRAMENTO
1231 I Street, Sacramento, CA 95814

Permit No: 0417320

Insp Area: 2

Thos Bros:

Sub-Type: NSFR

N

Site Address: 55 SUN REIGN PL SAC

Parcel No: SUN MEADOWS LOT #73 Housing (Y/N):

CONTRACTOR

NEW FAZE DEVELOPMENT
3187 DEL PASO BLVD.
SACRAMENTO CA. 95815

OWNER

ARCHITECT

Nature of Work: MP 1132 1 STORY 6 ROOM SFD

CONSTRUCTION LENDING AGENCY: I hereby affirm under penalty of perjury that there is a construction lending agency for the performance of the work for which this permit is issued (Sec. 3097, Civ. C).

Lender's Name _____ Lender's Address _____

LICENSED CONTRACTORS DECLARATION: I hereby affirm under penalty of perjury that I am licensed under provisions of Chapter 9 (commencing with section 7000) of Division 3 of the Business and Professions Code and my license is in full force and effect.

License Class B License Number 714601 Date 7/26/05 Contractor Signature [Signature]

OWNER-BUILDER DECLARATION: I hereby affirm under penalty of perjury that I am exempt from the contractors License Law for the following reason (Sec. 7031.5, Business and Professions Code; any city or county which requires a permit to construct, alter, improve, demolish, or repair any structure, prior to its issuance, also requires the applicant for such permit to file a signed statement that he or she is licensed pursuant to the provisions of the Contractors License Law (Chapter 9 (commencing with Section 7000) of Division 8 of the Business and Professions Code) or that he or she is exempt therefrom and the basis for the alleged exemption. Any violation of Section 7031.5 by any applicant for a permit subjects the applicant to a civil penalty of not more than five hundred dollars (\$500.00);

I, as a owner of the property, or my employees with wages as their sole compensation, will do the work, and the structure is not intended or offered for sale (Sec. 7044, Business and Professional Code: The Contractors License Law does not apply to an owner of property who builds or improves thereon, and who does such work himself or herself or through his/her own employees, provided that such improvements are not intended or offered for sale. If, however, the building or improvement is sold within one year of completion, the owner-builder will have the burden of proving that he/she did not build or improve for the purpose of sale.)

I, as owner of the property, am exclusively contracting with licensed contractors to construct the project. The Contractors License Law does not apply to an owner of property who builds or improves thereon, and who contracts for such projects with a contractor(s) licensed pursuant to the Contractors License Law).

I am exempt under Sec. _____ B & PC for this reason: _____

Date _____ Owner Signature _____

PAID
CITY OF SACRAMENTO
JUL 26 2005
NORTH PERMIT CENTER

IN ISSUING THIS BUILDING PERMIT, the applicant represents, and the city relies on the representation of the applicant, that the applicant verified all measurements and locations shown on the application or accompanying drawings and that the improvement to be constructed does not violate any law or private agreement relating to permissible or prohibited locations for such improvements. This building permit does not authorize any illegal location of any improvement or the violation of any private agreement relating to location of improvements.

I certify that I have read this application and state that all information is correct. I agree to comply with all city and county ordinances and state laws relating to building construction and hereby authorize representative(s) of this city to enter upon the above mentioned property for inspection purposes.

Date 7/25/05 Applicant/Agent Signature [Signature]

WORKER'S COMPENSATION DECLARATION: I hereby affirm under penalty of perjury one of the following declarations:

I have and will maintain a certificate of consent to self-insure for workers' compensation as provided for by Section 3700 of the Labor Code, for the performance of work for which the permit is issued.

[Signature] I have and will maintain workers' compensation insurance, as required by Section 3700 of the Labor Code, for the performance of the work for which this permit is issued. My workers' compensation insurance carrier and policy number are:

Carrier STATE FUND Policy Number 1536963-03 Exp Date 11/01/2004

(This section need not be completed if the permit is for \$100 or less) I certify that in the performance of the work for which this permit is issued, I shall not employ any person in any manner so as to become subject to the workers' compensation laws of California and agree that if I should become subject to the workers' compensation provisions of Section 3700 of the Labor Code, I shall forthwith comply with those provisions.

Date 7-28-05 Applicant Signature [Signature]

WARNING: FAILURE TO SECURE WORKER'S COMPENSATION COVERAGE IS UNLAWFUL AND SHALL SUBJECT AN EMPLOYER TO CRIMINAL PENALTIES AND CIVIL FINES UP TO ONE HUNDRED THOUSAND DOLLARS (\$100,000) IN ADDITION TO THE COST OF COMPENSATION, DAMAGES AS PROVIDED FOR IN SECTION 3706 OF THE LABOR CODE, INTEREST AND ATTORNEY'S FEE.

THIS PERMIT SHALL EXPIRE BY LIMITATION IF WORK IS NOT COMMENCED WITHIN 180 DAYS.

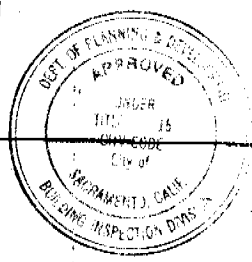
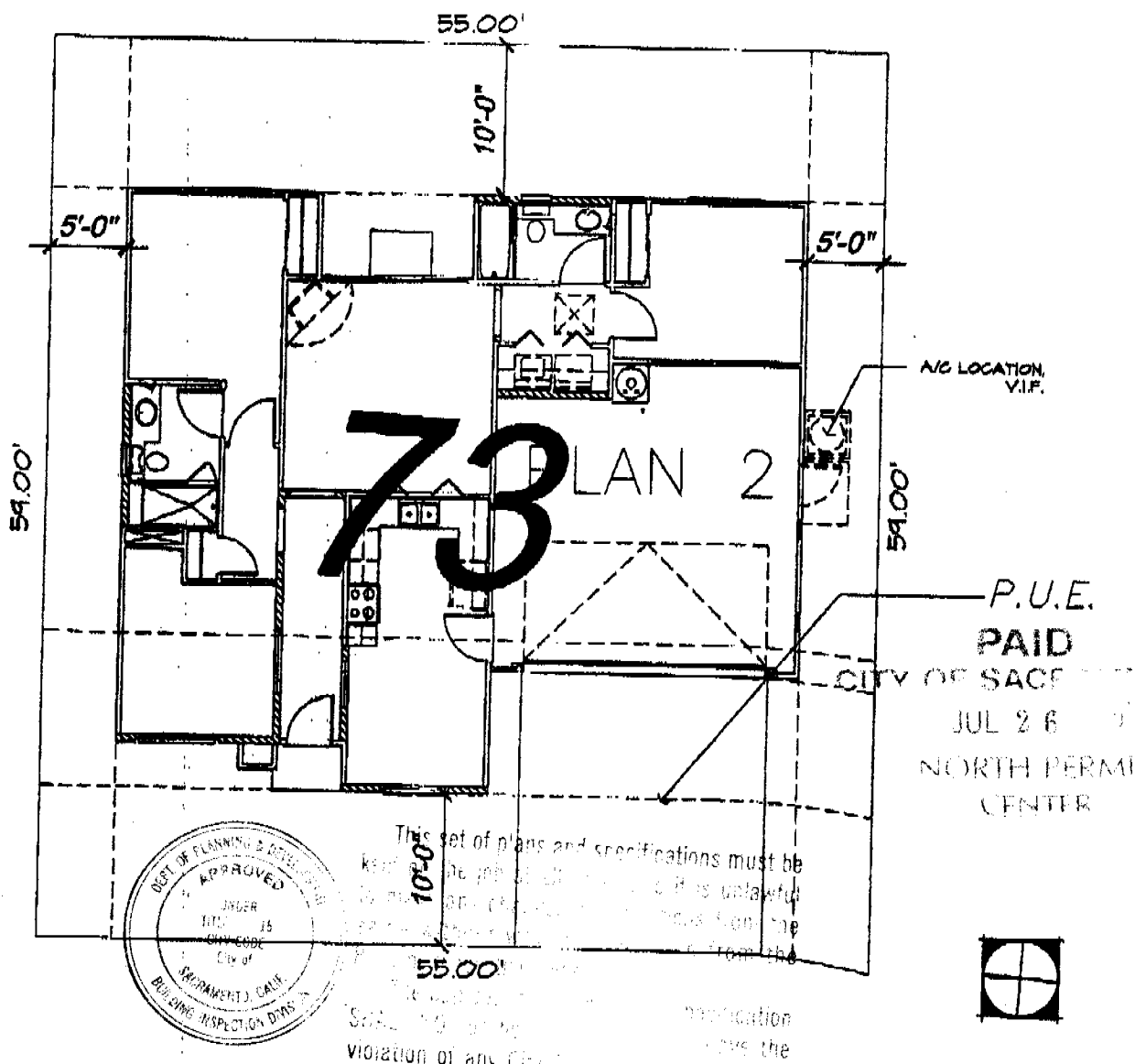

This set of plans and specifications must be kept on the job site and it is unlawful to remove them from the site without the approval of the City of Sacramento. Any violation of any City Ordinance or State Law.

*NOTE: THIS DRAWING IS INTENDED TO PROVIDE BUILDING LOCATION ONLY. ALL PROPERTY LINE MEETS AND BOUNDS ARE AS PROVIDED BY NOLTE BEYOND, ENGINEERING

HUNT HALE JONES ARCHITECTS 636 FOURTH STREET SAN FRANCISCO, CA 94107 PHONE: 415-398-1200 FAX: 415-398-0700 WWW.HUNTHALEJONES.COM	DRAWING DESCRIPTION:				PROJECT DESCRIPTION:	
	LOT 7B- PLAN 2(R)				NEW FAZE DEVELOPMENT SUN MEADOWS RETIREMENT COM. SACRAMENTO, CA	
SCALE: N.T.S.	DATE: 10-6-04	SHEET 5	OF 21	JOB NO.: 407006		

INSTALLATION CARD

WESTERN I-KOTE
Sacramento Stucco Company, Inc.

0417320

Job Address

55 Sun. Reign pl

ICBO Evaluation Service, Inc.
Evaluation Report ER-3899

Date of Job Completion 10/20/05

Plastering Contractor

Name: Rick H. Hitch Plastering, Inc.

Address: PO Box 1391, North Highlands, CA 95660

Telephone Number: (916) 334-3591

Approved contractor number as issued by coating manufacturer: 243

This is to certify that the exterior coating system on the building exterior at the above address has been installed in accordance with the evaluation report specified above and the manufacturer's instructions.

Signature of authorized representative or plastering contractor

10/20/05
Date

This installation card must be presented to the building inspector after completion of work and before final inspection.

0417320

INSULATION CONTRACTORS ASSOCIATION OF AMERICA

45690

1321 DUKE STREET, SUITE 303 • ALEXANDRIA, VA 22314 • (703) 738-0358

THIS INSULATION HAS BEEN INSTALLED IN CONFORMANCE WITH THE CALIFORNIA ENERGY EFFICIENCY CODE (CEC) AND THE NEVADA ENERGY EFFICIENCY CODE (NEEC) WHICH ARE BASED ON THE 1990 ASHRAE 90.1 ENERGY EFFICIENCY CODE.

New Faze LOT # 73 TRACT # Sun Meadows
STREET 5650 Reagan Pl CITY Sac

EXTERIOR WALLS:
MANUFACTURER FGI THICKNESS/TYPE 3 5/8 R-VALUE 13

CEILINGS:
BATT:
MANUFACTURER FGI THICKNESS/TYPE R-VALUE 38

BLOWN IN:
MANUFACTURER CT MINIMUM THICKNESS 14 3/4 R-VALUE 38

SQUARE FOOTAGE COVERED 1402 NUMBER OF BAGS USED 32

FLOORS:
MANUFACTURER THICKNESS/TYPE R-VALUE

SLAB ON GRADE:
MANUFACTURER THICKNESS/TYPE R-VALUE

WIDTH OF INSULATION INCHES

FOUNDATION WALLS:
MANUFACTURER THICKNESS/TYPE R-VALUE

GENERAL CONTRACTOR
CALIFORNIA CONTRACTORS LICENSE # DATE

SIGNATURE TITLE

INSULATION CONTRACTOR ARCADE INSULATION
CALIFORNIA CONTRACTORS LICENSE #012206
NEVADA CONTRACTORS LICENSE #65901

DATE 7-12-05
SIGNATURE Installer TITLE

INSTALLATION CERTIFICATE

CF-6R

New Faze Development: Sun Meadows

Site Address 55-Sun Meadows

Permit Number 0417320

An installation certificate is required to be posted at the building site or made available for all appropriate inspections. (The information provided on this form is required, however, use of this form to provide the information is optional.) After completion of final inspection a copy must be provided to the building department (upon request) and the building owner at occupancy, per Section 10-103(b).

HVAC SYSTEMS:

Heating Equipment

Equip. Type (pkg. Heat pump)	CEC Certified Mfr Name and Model #	# of Identical Systems	(1) Efficiency (AFUE, etc.) > CF-1R value	Duct Location (attic, etc.)	Duct or Piping R-value	Heating Load (Btu/hr)	Heating Capacity (Btu/hr)	
Furnace	YORK #P4HUA12L03201	1	0.80	Attic	R-4.2	22,357	40,000	Plan 1
Furnace	YORK #P4HUA12L03201	1	0.80	Attic	R-4.2	25,101	40,000	Plan 2
Furnace	YORK #P4HUA12L03201	1	0.80	Attic	R-4.2	26,742	40,000	Plan 3
Furnace	YORK #P4HUA12L03201	1	0.80	Attic	R-4.2	28,719	40,000	Plan 4
Furnace	YORK #P4HUA12L03201	1	0.80	Attic	R-4.2	27,445	40,000	Plan 5

Cooling Equipment

Equip. Type (pkg. Heat pump)	CEC Certified Compressor Unit Mfr Name and Model #	# of Identical Systems	(1) Efficiency (SEER, etc.) > CF-1R value	Duct Location (attic, etc.)	Duct R-value	Cooling Load (Btu/hr)	Cooling Capacity (Btu/hr)	
Condenser	YORK #H*RC024	1	12.0	Attic	R-4.2	16,285	21,100	Plan 1
Condenser	YORK #H*RC024	1	12.0	Attic	R-4.2	18,184	21,100	Plan 2
Condenser	YORK #H*RC024	1	12.0	Attic	R-4.2	18,676	21,100	Plan 3
Condenser	YORK #H*RC024	1	12.0	Attic	R-4.2	19,195	21,100	Plan 4
Condenser	YORK #H*RC024	1	12.0	Attic	R-4.2	20,158	21,100	Plan 5

(1) > reads greater than or equal to

* = Thermal Expansion Valve

I, the undersigned, verify that equipment listed above is: 1) the actual equipment installed; 2) equivalent to or more efficient than that specified in the certificate of compliance (Form CF-1R) submitted for compliance with the Energy Efficiency Standards for residential buildings; and 3) equipment that meets or exceeds the appropriate requirements for manufactured devices (from the Appliance Efficiency Regulations or Part 6), where applicable.

Mark Radloff 1-13-04
Signature, Date

Beutler Corporation
Installing Subcontractor (Co. Name)
OR General Contractor (Co. Name) OR Owner

WATER HEATING SYSTEMS:

Heater Type	CEC Certified Mfr Name & Model #	Distribution Type (Set point of use)	If Recirculation Control Type	# of Identical Systems	(2) Rated Input (kW or Btu/hr)	Tank Volume (gallons)	(2) Efficiency (EF, RE)	(3) Standby Loss (%)	External Insulation R-value

- (2) For small gas storage (rated input of less than or equal to 75,000 Btu/hr), electric resistance and heat pump water heaters, list Energy Factor. For large gas storage water heaters (rated input of greater than 75,000 Btu/hr), list Recovery Efficiency, Standby Loss and Rated Input. For instantaneous gas water heaters, list Recovery efficiency and Rated Input.
- (3) R-12 external insulation is mandatory for storage water heaters with an energy factor of less than 0.58.

Facets & Shower Heads:

All facets and showerheads installed are certified to the Commission, pursuant to Title 24, Part 6, Section 111.

I, the undersigned, verify that equipment listed above my signature is: 1) the actual equipment installed; 2) equivalent to or more efficient than that specified in the certificate of compliance (Form CF-1R) submitted for compliance with the Energy Efficiency Standards for residential buildings; and 3) equipment that meets or exceeds the appropriate requirements for manufactured devices (from the Appliance Efficiency Regulations or Part 6), where applicable.

Signature, Date

Installing Subcontractor (Co. Name)
OR General Contractor (Co. Name) OR Owner

COPY TO: Building Department
HERS Provider (if applicable)

INSTALLATION CERTIFICATE

(page 1 of 4)

CF-OR

New Faze Sun Meadows
 Site Address 55-sun-ridge pl.

All Plans
 Permit Number 0417320

An installation certificate is required to be posted at the building site or made available for all appropriate inspections. (The information provided on this form is required; however, use of this form to provide the information is optional.) After completion of final inspection, a copy must be provided to the building department (upon request) and the building owner at occupancy, per Section 10-103(b).

HYAC SYSTEMS:

ATTN: Christian

Heating Equipment

Equip. Type (pkg. heat pump)	CEC Certified Mfr Name and Model Number	# of Identical Systems	Efficiency (AFUE, etc.) ¹ (≥CF-IR value)	Duct Location (attic, etc.)	Duct or Piping R-value	Heating Load (Btu/hr)	Heating Capacity (Btu/hr)

Cooling Equipment

Equip. Type (pkg. heat pump)	CEC Certified Compressor Unit Mfr Name and Model Number	# of Identical Systems	Efficiency (SEER, etc.) ¹ (≥CF-IR value)	Duct Location (attic, etc.)	Duct R-value	Cooling Load (Btu/hr)	Cooling Capacity (Btu/hr)

1. ≥ reads greater than or equal to.

I, the undersigned, verify that equipment listed above is: 1) is the actual equipment installed, 2) equivalent to or more efficient than that specified in the certificate of compliance (Form CF-IR) submitted for compliance with the Energy Efficiency Standards for residential buildings, and 3) equipment that meets or exceeds the appropriate requirements for manufactured devices (from the Appliance Efficiency Regulations or Part 6), where applicable.

Signature, Date _____

Installing Subcontractor (Co. Name) _____
 OR General Contractor (Co. Name) OR Owner _____

WATER HEATING SYSTEMS:

Water Heater Type	CEC Certified Mfr Name & Model Number	Distribution Type (Std. Point-of-Use)	If Recirculation, Control Type	# of Identical Systems	Rated ¹ Input (kW or Btu/hr)	Tank Volume (gallons)	Efficiency ¹ (SE, KE)	Standby ¹ Loss (%)	External Insulation R-value
Gas	Rheem 42VR40-40F STD	N/A	N/A	1	40,000	40	.62		R-20

1. For small gas storage (rated input of less than or equal to 75,000 Btu/hr), electric resistance and heat pump water heaters, list Energy Factor. For large gas storage water heaters (rated input of greater than 75,000 Btu/hr), list Recovery Efficiency, Standby Loss and Rated Input. For instantaneous gas water heaters, list Recovery Efficiency and Rated Input.

Faucets & Shower Heads:

All faucets and showerheads installed are certified to the Commission, pursuant to Title 24, Part 6, Subchapter 2, Section 111.

I, the undersigned, verify that equipment listed above my signature: 1) is the actual equipment installed, 2) is equivalent to or more efficient than that specified in the certificate of compliance (Form CF-IR) submitted for compliance with the Energy Efficiency Standards for residential buildings; and 3) the equipment meets or exceeds the appropriate requirements for manufactured devices (from the Appliance Efficiency Regulations or Part 6), where applicable.

Signature, Date _____

J.R. Pierce Plumbing Co.
 Installing Subcontractor (Co. Name) OR
 General Contractor (Co. Name) OR Owner _____

COPY TO: Building Department
 Building Owner at Occupancy

INSTALLATION CERTIFICATE

(Page 2 of 13)

CF-6R

Site Address: **NEW FAZE DEVELOPMENT INC.** Permit Number: **017320**
55-Sunkeyel - SUN MEADOWS RETIREMENT PLAN 2 F
FENESTRATION/GLAZING: SACRAMENTO, CA
ALSIDE-ALPINE
7000 SERIES WINDOWS

Manufacturer/Brand Name (GROUP LIKE PRODUCTS)	Product U-Factor ¹ (≤ CF-1R value) ²	Product SHGC ¹ (≤ CF-1R value) ²	# of Panes	Total Quantity of Like Product (Optional)	Square Feet	Exterior Shading Device or Overhang	Comments/Location/Special Features
1.							
2. SLIDERS	.35	.72	2		105		LOW-E GLASS
3.							
4. SINGLE HUNG	.35	.32	2		12		
5.							
6. PICTURE WINDOWS	.34	.35	2		0		
7.							
8. PATIO DOORS	.35	.34	2		48		
9.							
10.							
11.							
12.							
13.							
14.							
15.							

¹ Manufactured fenestration products use the values from the product label. Field fabricated fenestration products use the default values from Section 116 of the Energy Efficiency Standards.

² Installed U-Factor must be less than or equal to values from CF-1R. Installed SHGC must be less than or equal to values from CF-1R, or a shading device (exterior or overhang) is installed as specified on the CF-1R. Alternatively, installed weighted average U-Factors for the total fenestration area are less than or equal to values from CF-1R.

I, the undersigned, verify that the fenestration/glazing listed above my signature: 1) is the actual fenestration product installed; 2) is equivalent to or has a lower U-Factor and lower SHGC than that specified in the certificate of compliance (Form CF-1R) submitted for compliance with the Energy Efficiency Standards for residential buildings; and 3) the product meets or exceeds the appropriate requirements for manufactured devices (from Part 6), where applicable.

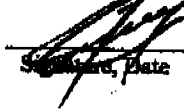
Item #s: **2, 4, 6, 8** (if applicable)
 Signature:  Date: **10-20-05**
 Y.T. GLASS & WINDOWS INC.
 Installing Subcontractor (Co. Name) OR
 General Contractor (Co. Name) OR Owner
 OR Window Distributor
 3200 DWIGHT WAY STE 400
 ELK GROVE, CA 95758-6461

Item #s (if applicable) _____ Signature, Date _____
 Installing Subcontractor (Co. Name) OR
 General Contractor (Co. Name) OR Owner
 OR Window Distributor

Item #s (if applicable) _____ Signature, Date _____
 Installing Subcontractor (Co. Name) OR
 General Contractor (Co. Name) OR Owner
 OR Window Distributor

COPY TO: Building Department
 HERS Provider (if applicable)
 Building Owner at Occupancy