

**CITY OF SACRAMENTO**  
1231 I Street, Sacramento, CA 95814

**Permit No: 0100586**  
**Insp Area: 2**

**Site Address: 7729 LARAMORE WY SAC**  
Parcel No: 053-0160-017

Sub-Type: NSFR  
Housing (Y/N): N  
LOT 17 MEADOWVIEW VILL 7

**CONTRACTOR**  
NEW FAZE DEVELOPMENT  
2377 GOLD MEADOW WY STE 270  
GOLD RIVER CA 95670

**OWNER**

**ARCHITECT**

**Nature of Work: NSFR MP1900 8 RMS 2 STORY**

**CONSTRUCTION LENDING AGENCY:** I hereby affirm under penalty of perjury that there is a construction lending agency for the performance of the work for which this permit is issued (Sec. 3097, Civ. C).

Lender's Name \_\_\_\_\_ Lender's Address \_\_\_\_\_

**LICENSED CONTRACTORS DECLARATION:** I hereby affirm under penalty of perjury that I am licensed under provisions of Chapter 9 (commencing with section 7000) of Division 3 of the Business and Professions Code and my license is in full force and effect.

License Class B License Number 714601 Date 4/9/01 Contractor Signature [Signature]

**OWNER-BUILDER DECLARATION:** I hereby affirm under penalty of perjury that I am exempt from the contractors License Law for the following reason (Sec. 7031.5, Business and Professions Code, any city or county which requires a permit to construct, alter, improve, demolish, or repair any structure, prior to its issuance, also requires the applicant for such permit to file a signed statement that he or she is licensed pursuant to the provisions of the Contractors License Law (Chapter 9 (commencing with Section 7000) of Division 8 of the Business and Professions Code) or that he or she is exempt therefrom and the basis for the alleged exemption: Any violation of Section 7031.5 by any applicant for a permit subjects the applicant to a civil penalty of not more than five hundred dollars (\$500.00):

I, as a owner of the property, or my employees with wages as their sole compensation, will do the work, and the structure is not intended or offered for sale (Sec. 7044, Business and Professional Code: The Contractors License Law does not apply to an owner of property who builds or improves thereon, and who does such work himself or herself or through his/her own employees, provided that such improvements are not intended or offered for sale. If, however, the building or improvement is sold within one year of completion, the owner-builder will have the burden of proving that he/she did not build or improve for the purpose of sale.)

I, as owner of the property, am exclusively contracting with licensed contractors to construct the project (Sec. 7044, Business and Professions Code: The Contractors License Law does not apply to an owner of property who builds or improves thereon, and who contracts for such projects with a contractor(s) licensed pursuant to the Contractors License Law).

I am exempt under Sec. \_\_\_\_\_ B & PC for this reason: \_\_\_\_\_

Date \_\_\_\_\_ Owner Signature [Signature]

**IN ISSUING THIS BUILDING PERMIT,** the applicant represents, and the city relies on the representation of the applicant, that the applicant verified all measurements and locations shown on the application or accompanying drawings and that the improvements to be constructed do not violate any law or private agreement relating to permissible or prohibited locations for such improvements. This building permit does not authorize any illegal location of any improvement or the violation of any private agreement relating to location of improvements.

I certify that I have read this application and state that all information is correct. I agree to comply with all city and county ordinances and state laws relating to building construction and hereby authorize representative(s) of this city to enter upon the abovementioned property for inspection purposes.

Date April 9, 2001 Applicant-Agent Signature [Signature]

**WORKER'S COMPENSATION DECLARATION:** I hereby affirm under penalty of perjury one of the following declarations:

I have and will maintain a certificate of consent to self-insure for workers' compensation as provided for by Section 3700 of the Labor Code, for the performance of work for which the permit is issued

I have and will maintain workers' compensation insurance, as required by Section 3700 of the Labor Code, for the performance of the work for which this permit is issued. My workers' compensation insurance carrier and policy number are:

Carrier STATE FUND Policy Number 1536963-98 Exp Date Nov. 1, 2001

(This section need not be completed if the permit is for \$100 or less) I certify that in the performance of the work for which this permit is issued, I shall not employ any person in any manner so as to become subject to the workers' compensation laws of California and agree that if I should become subject to the workers' compensation provisions of Section 3700 of the Labor Code, I shall forthwith comply with those provisions.

Date April 9, 2001 Applicant Signature [Signature]

**WARNING:** FAILURE TO SECURE WORKER'S COMPENSATION COVERAGE IS UNLAWFUL AND SHALL SUBJECT AN EMPLOYER TO CRIMINAL PENALTIES AND CIVIL FINES UP TO ONE HUNDRED THOUSAND DOLLARS (\$100,000) IN ADDITION TO THE COST OF COMPENSATION, DAMAGES AS PROVIDED FOR IN SECTION 3706 OF THE LABOR CODE, INTEREST AND ATTORNEY'S FEE.

**THIS PERMIT SHALL EXPIRE BY LIMITATION IF WORK IS NOT COMMENCED WITHIN 180 DAYS.**



INSTALLATION CARD  
WESTERN ONE KOTE STUCCO SYSTEM  
WESTERN STUCCO PRODUCTS CO. INC.



Job Address:

New Edge - Rainbow Springs  
Lot - 17  
Sacramento, CA 95815

ICBO Evaluation Service, Inc.  
Report No. 3899

Date of Job Completion \_\_\_\_\_

Plastering Contractor

Name: G. Glenn Plastering  
Address: 6330 Main Ave., Suite 4, Orangevale, CA 95662  
Telephone Number (916) 519-8755

This is to certify that the plastering system on the building exterior at the above address has been installed in accordance with the evaluation report specified above and the manufacturer's instructions.

Delores Glenn

Signature of authorized representative of plastering contractor

\_\_\_\_\_  
Date

Installation card must be presented to the building inspector after completion of work and before final inspection.

NO \_\_\_\_\_

# WES PAC INSULATION

INSULATION  
CERTIFICATE

THIS IS TO CERTIFY THAT INSULATION HAS BEEN INSTALLED IN CONFORMANCE WITH  
CURRENT ENERGY REGULATIONS, CALIFORNIA ADMINISTRATIVE CODE, TITLE 24, STATE OF  
CALIFORNIA, IN THE BUILDING LOCATED AT:

New Faze Develop LOT # 17 PLAN # 1859  
STREET Rainbow Springs CITY Sacto

**EXTERIOR WALLS:**

MANUFACTURER JM THICKNESS/TYPE 3.5" R-VALUE 13  
CELLULOSE

BATS:  
MANUFACTURER JM THICKNESS/TYPE 13" R-VALUE 38

GLASSLIN:  
MANUFACTURER CT THICKNESS/TYPE 14.75 R-VALUE 38

SQUARE FOOTAGE COVERED 604 NUMBER OF BATS USED 14

FLOOR:  
MANUFACTURER \_\_\_\_\_ THICKNESS/TYPE \_\_\_\_\_ R-VALUE \_\_\_\_\_

SEAL ON GRADE:  
MANUFACTURER \_\_\_\_\_ THICKNESS/TYPE \_\_\_\_\_ R-VALUE \_\_\_\_\_

WIDTH OF INSULATION \_\_\_\_\_ INCHES

EXTERIOR WALLS:  
MANUFACTURER \_\_\_\_\_ THICKNESS/TYPE \_\_\_\_\_ R-VALUE \_\_\_\_\_

GENERAL CONTRACTOR \_\_\_\_\_  
CALIFORNIA CONTRACTORS LICENSE # \_\_\_\_\_

DATE \_\_\_\_\_

SIGNATURE \_\_\_\_\_ TITLE \_\_\_\_\_

INSULATION CONTRACTOR WES PAC INSULATION, INC.  
CALIFORNIA CONTRACTORS LICENSE # \_\_\_\_\_

Terrill Stiles #487478 DATE \_\_\_\_\_  
SIGNATURE OFFICE MGR. TITLE

RAINBOW SPRINGS  
 LOT #17 PLAN #1859  
 7729 LARAMORE WAY, SMD  
 APN: 053-0016-017  
 SCALE: 1" = 20'

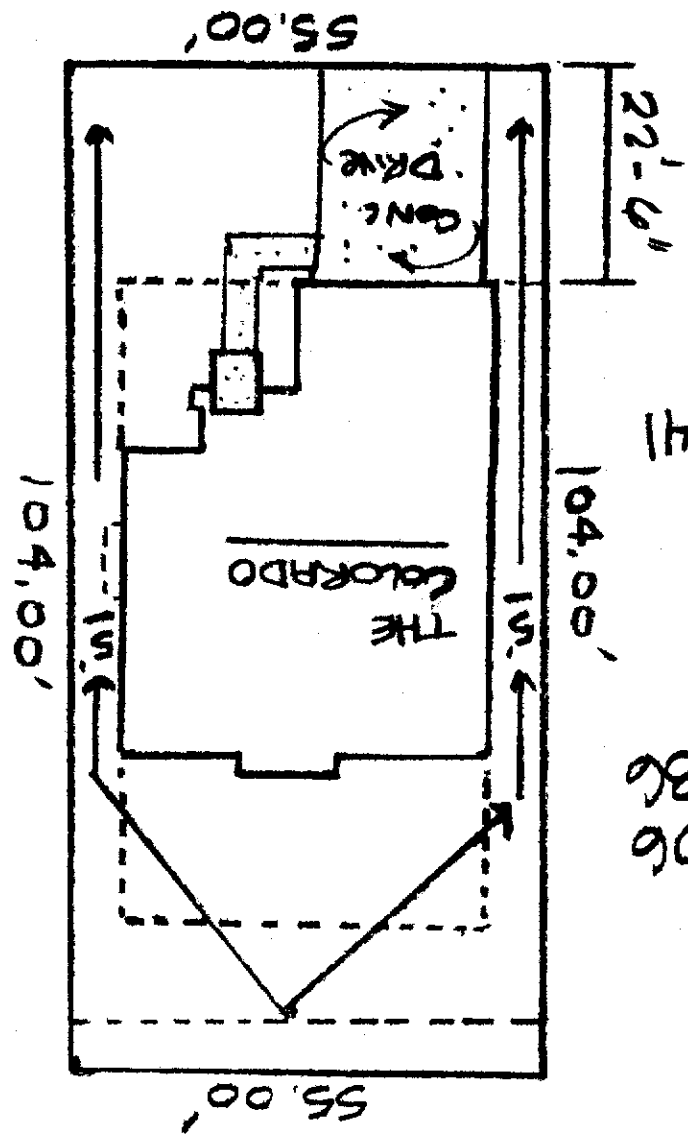

OFFICE:  
 (916) 924-9906  
 FAX (916) 924-9936  
 SITE  
 (916) 421-2749  
 FAX (916) 421-2741

NEW FAZE DEVELOPMENT  
 3187 DEL PASO BLVD.  
 SACRAMENTO, CA 95815

Vertical text on the left side of the page, likely a title block or project information, including the name 'NEW FAZE DEVELOPMENT' and other project details.

