

CITY OF SACRAMENTO  
1231 I Street, Sacramento, CA 95814

Permit No: 0404260  
Insp Area: 2  
Thos Bros: 337D4

Site Address: 211 HIGHFIELD CR SAC  
Parcel No: MEADOWVIEW ESTATES LOT 196

Sub-Type: NSFR  
Housing (Y/N): N

CONTRACTOR  
JTS COMMUNITIES  
401 WATT AV.  
SACRAMENTO CA. 95864

OWNER

ARCHITECT

Nature of Work: JTS MP104 1 STORY 9 ROOM SFR

**CONSTRUCTION LENDING AGENCY :** I hereby affirm under penalty of perjury that there is a construction lending agency for the performance of the work for which this permit is issued (Sec. 3097, Civ. C).

Lender's Name \_\_\_\_\_ Lender's Address \_\_\_\_\_

**LICENSED CONTRACTORS DECLARATION:** I hereby affirm under penalty of perjury that I am licensed under provisions of Chapter 9 (commencing with section 7000) of Division 3 of the Business and Professions Code and my license is in full force and effect.

License Class B License Number 767107 Date 4/02/04 Contractor Signature [Signature]

**OWNER-BUILDER DECLARATION:** I hereby affirm under penalty of perjury that I am exempt from the contractors License Law for the following reason (Sec. 7031.5, Business and Professions Code; any city or county which requires a permit to construct, alter, improve, demolish, or repair any structure, prior to its issuance, also requires the applicant for such permit to file a signed statement that he or she is licensed pursuant to the provisions of the Contractors License Law (Chapter 9 (commencing with Section 7000) of Division 8 of the Business and Professions Code) or that he or she is exempt therefrom and the basis for the alleged exemption. Any violation of Section 7031.5 by any applicant for a permit subjects the applicant to a civil penalty of not more than five hundred dollars (\$500.00);

\_\_\_\_\_, I, as a owner of the property, or my employees with wages as their sole compensation, will do the work, and the structure is not intended or offered for sale (Sec. 7044, Business and Professional Code: The Contractors License Law does not apply to an owner of property who builds or improves thereon, and who does such work himself or herself or through his/her own employees, provided that such improvements are not intended or offered for sale. If, however, the building or improvement is sold within one year of completion, the owner-builder will have the burden of proving that he/she did not build or improve for the purpose of sale.)

\_\_\_\_\_, I, as owner of the property, am exclusively contracting with licensed contractors to construct the project (Sec. 7044, Business and Professions Code: The Contractors License Law does not apply to an owner of property who builds or improves thereon, and who contracts for such projects with a contractor(s) licensed pursuant to the Contractors License Law).

\_\_\_\_\_, I am exempt under Sec. \_\_\_\_\_ B & PC for this reason: \_\_\_\_\_

Date \_\_\_\_\_ Owner Signature \_\_\_\_\_

**IN ISSUING THIS BUILDING PERMIT,** the applicant represents, and the city relies on the representation of the applicant, that the applicant verified all measurements and locations shown on the application or accompanying drawings and that the improvement to be constructed does not violate any law or private agreement relating to permissible or prohibited locations for such improvements. This building permit does not authorize any illegal location of any improvement or the violation of any private agreement relating to location of improvements.

I certify that I have read this application and state that all information is correct. I agree to comply with all city and county ordinances and state laws relating to building construction and hereby authorize representative(s) of this city to enter upon the abovementioned property for inspection purposes.

Date 4/02/04 Applicant/Agent Signature [Signature]

**WORKER'S COMPENSATION DECLARATION:** I hereby affirm under penalty of perjury one of the following declarations:

\_\_\_\_\_, I have and will maintain a certificate of consent to self-insure for workers' compensation as provided for by Section 3700 of the Labor Code, for the performance of work for which the permit is issued.

\_\_\_\_\_, I have and will maintain workers' compensation insurance, as required by Section 3700 of the Labor Code, for the performance of the work for which this permit is issued. My workers' compensation insurance carrier and policy number are:

Carrier ZURICH INSURANCE CO Policy Number WC367556101 Exp Date 03/01/2004

\_\_\_\_\_, (This section need not be completed if the permit is for \$100 or less) I certify that in the performance of the work for which this permit is issued, I shall not employ any person in any manner so as to become subject to the workers' compensation laws of California and agree that if I should become subject to the workers' compensation provisions of Section 3700 of the Labor Code, I shall forthwith comply with those provisions.

Date 4/02/04 Applicant Signature [Signature]

**WARNING: FAILURE TO SECURE WORKER'S COMPENSATION COVERAGE IS UNLAWFUL AND SHALL SUBJECT AN EMPLOYER TO CRIMINAL PENALTIES AND CIVIL FINES UP TO ONE HUNDRED THOUSAND DOLLARS (\$100,000) IN ADDITION TO THE COST OF COMPENSATION, DAMAGES AS PROVIDED FOR IN SECTION 3706 OF THE LABOR CODE, INTEREST AND ATTORNEY'S FEE.**

**THIS PERMIT SHALL EXPIRE BY LIMITATION IF WORK IS NOT COMMENCED WITHIN 180 DAYS.**

ORIGINAL

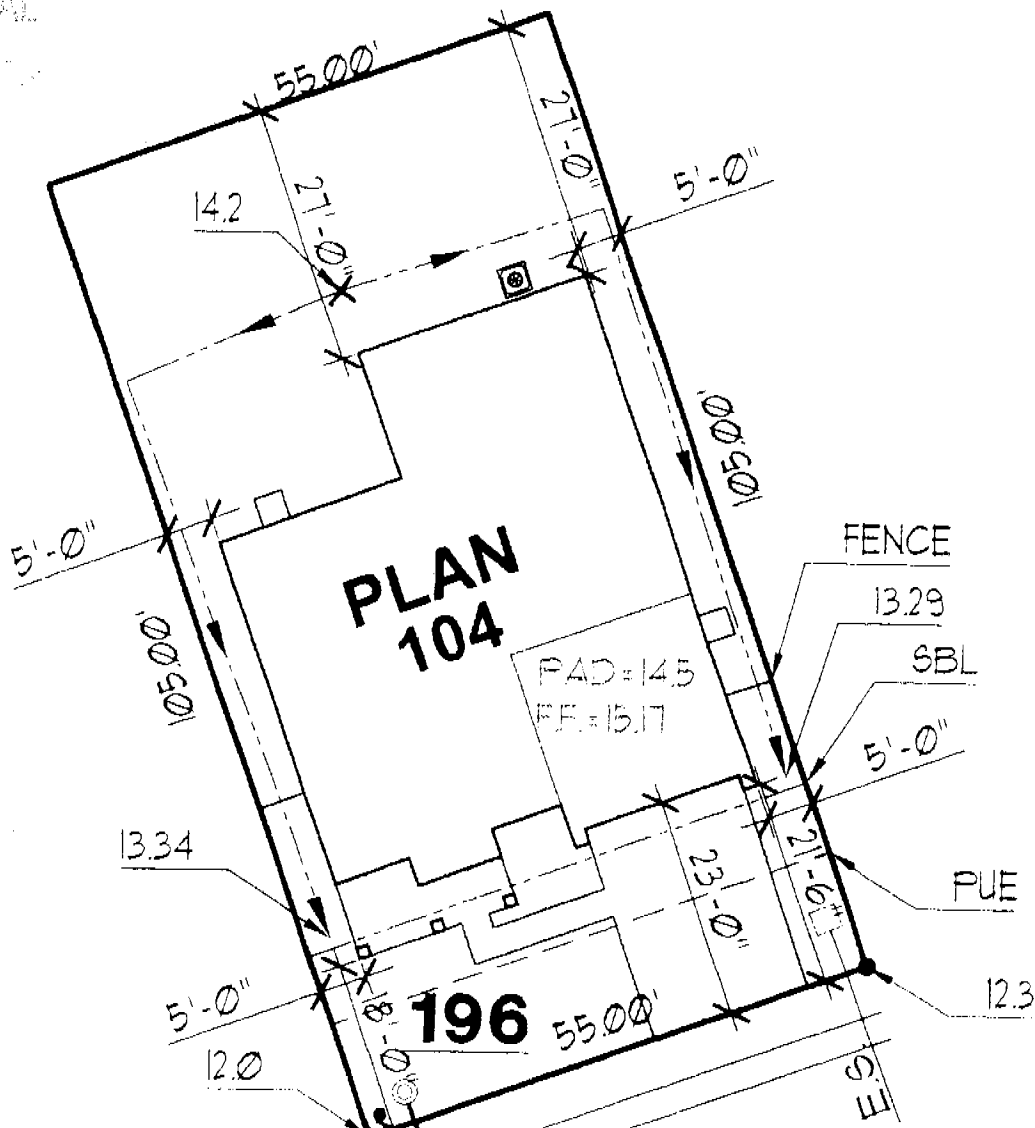

**HIGHFIELD CIRCLE**

This set of plans and specifications shall be kept on the job at all times and shall be used to make all changes or alterations thereto without written permission from the Building Inspection Division.

The approval of this plan and specification SHALL NOT be held to approve or acquiesce to the violation of any City Ordinances or Code Law.

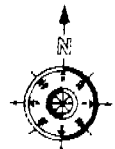

DIMENSIONS SHOWN ARE APPROXIMATE AND ARE FOR THE SOLE PURPOSE OF COUNTY/CITY APPROVAL. ADDITIONAL INFORMATION REFLECTED ON THIS DOCUMENT SUCH AS FENCE, WALL, UTILITY, AND MAILBOX. LOCATIONS ARE SUBJECT TO CHANGE WITHOUT NOTIFICATION TO BUYER. THIS PLOT PLAN MAY NOT REFLECT ALL "AS BUILT" CONDITIONS WHICH MIGHT VARY FROM THIS PROPOSED PLOT PLAN.

<ul style="list-style-type: none"> <li>1 STORY HOUSE</li> <li>2 CAR GARAGE</li> </ul>	<p><b>PROPOSED SITE PLAN</b></p>	<p><b>JTS</b> CONSULTANTS, INC. Working Together to Achieve Excellence 401 Watt Avenue Sacramento, CA 95821 (916) 487-3434</p>	<p><b>MEADOWVIEW ESTATES</b></p>
<p>APN #</p> <p>APPROVED FOR RELEASE</p>	<p>DATE</p>	<p>APPROVED FOR RELEASE</p>	<p>SCALE = 1" = 20'</p> <p>DATE: MARCH 10, 2004</p> <p>DATE</p>

INSTALLATION CARD  
Diamond Wall One Coat System  
Omega Products International, Inc.

Project Address

211 Highfield cr  
Meadow view Estates  
UNIT 1 Lot 196

ICBO Evaluation Service, Inc.  
Report ER-4004

Date Completed 7-30-04

Plastering Contractor

Name: J.T.S. Stucco Div.  
Address: 11285 White Rock Road  
Telephone No. (916) 635-2800

Approved contractor number as issued by Omega Products Int'l, Inc. P.N. # 2227

This is to certify that the exterior coating system on the building exterior at the above address has been installed in accordance with the evaluation report and the manufacturer's instructions.

Don Richels  
Signature of authorized representative of  
plastering contractor

Date

This installation card must be presented to the building inspector after completion of work and before final inspection.

# CERTIFICATION OF INSULATION

<p style="text-align: center;"><b>ADDRESS OR TRACT</b></p> <p style="font-size: 1.5em; font-family: cursive;">JTS Communities LOT # 196</p> <p style="font-size: 1.5em; font-family: cursive;">Masters @ meadowview</p>	<p style="text-align: center;"><b>SACRAMENTO BUILDING PRODUCTS</b></p> <p><input checked="" type="checkbox"/> R.O. BOX 854, WEST SACRAMENTO, CA 95691 LIC. #202026</p> <p><input type="checkbox"/> 1309 MELODY ROAD, MARYSVILLE, CA 95901 LIC. #202026</p> <p><input type="checkbox"/> R.O. BOX 9661, FRESNO, CA 93793-9661 LIC. #202026</p> <p><input type="checkbox"/> P.O. BOX 1631, RENO, NV 89505 LIC. #10675</p> <p><input type="checkbox"/> 3326 A PONDEROSA WAY, LAS VEGAS, NV 89118 LIC. #10675</p> <p style="text-align: center; font-size: 1.2em; font-family: cursive;">7/24/04</p> <p><b>DATE INSULATION COMPLETED</b></p>
---	---

WALLS			CEILINGS			FLOORS					
(                      SQUARE FEET)			(                      SQUARE FEET)			(                      SQUARE FEET)					
TYPE OF INSULATION			TYPE OF INSULATION			TYPE OF INSULATION					
MATERIAL <b>FIBERGLASS</b>			MATERIAL <b>FIBERGLASS</b>			MATERIAL <b>FIBERGLASS</b>					
FORM <b>BATTS</b>			FORM <b>BATTS &amp; BLOW</b>			FORM <b>BATTS</b>					
MANUFACTURER'S PRODUCT I.D.			MANUFACTURER'S PRODUCT I.D.			MANUFACTURER'S PRODUCT I.D.					
MANUFACTURER			MANUFACTURER			MANUFACTURER					
CT	OC	JM	CT	OC	JM	CT	OC	JM			
BAGS											
R - VALUE INSTALLED	APPLIED THICKNESS		R - VALUE INSTALLED	APPLIED THICKNESS	MIN. INSTALLED WEIGHT PER SQUARE FOOT	R - VALUE INSTALLED	APPLIED THICKNESS				
13	3 1/2"		30	9" 12"	—						
<b>KNEE WALLS IF R-VALUE IS OTHER THAN WALLS ABOVE</b>											
MATERIAL <b>FIBERGLASS</b>			FORM <b>BATTS</b>			R VALUE			MANUFACTURER		
									CT	OC	JM
<b>AIR INFILTRATION SEALANT</b>											
MATERIAL <b>foam</b>						MANUFACTURER					
						<b>HILTI</b>			<b>HANDY FOAM</b>		

**THIS IS TO CERTIFY THAT INSULATION AND/OR SEALANT HAS BEEN INSTALLED IN CONFORMANCE WITH APPLICABLE CODES, MATERIAL STANDARDS AND REGULATIONS.**

SIGNATURE -- INSULATION CONTRACTOR	TITLE	DATE
JO	MANAGER	9/07/04
SIGNATURE -- GENERAL CONTRACTOR	TITLE	DATE
REMARKS		

PART I GENERAL

PART II AREAS INSULATED

PART III CERTIFICATION