



124

FROM CONTINUED  
TO 7.1.97  
7.29.97

APPROVED  
BY THE CITY COUNCIL

JUL 29 1997

DEPARTMENT OF  
PUBLIC WORKS  
OFFICE OF THE  
CITY CLERK  
TRANSPORTATION AND  
DEVELOPMENT DIVISION

CITY OF SACRAMENTO  
CALIFORNIA

ADMINISTRATION &  
CIP PLANNING  
1023 J STREET, STE 208  
SACRAMENTO, CA  
95814-2819  
PH 916-264-5707  
FAX 916-264-8357

TRANSPORTATION  
PLANNING AND  
ENTITLEMENTS &  
SPECIAL PROJECTS  
1231 I STREET, STE 300  
SACRAMENTO, CA  
95814-2904  
PH 916-264-7474  
FAX 916-264-7185

ENGINEERING  
SERVICES  
1231 I STREET, STE 200  
SACRAMENTO, CA  
95814-2988  
PH 916-264-7995  
FAX 916-264-7046

June 13, 1997

City Council  
Sacramento, California

Honorable Members In Session:

**SUBJECT:** APPROVAL OF PARCEL MAP ENTITLED "ALL OF PARCEL 3 AS SHOWN ON  
115 PM 25" - (P96-078)

**LOCATION/COUNCIL DISTRICT:**

Southwest corner of Truxel Road and Millcreek Drive  
Council District 1

**RECOMMENDATION:**

This report recommends that the attached resolution for the Parcel Map entitled "All of Parcel 3 as Shown on 115 PM 25" be approved.

**CONTACT PERSON:**

Anwar Ali, Engineering Technician III, 264-7992  
Robert Jones, Senior Engineer, 264-7929

**FOR COUNCIL MEETING OF:**

July 1, 1997

**SUMMARY:**

On February 13, 1997, the Planning Commission approved a Tentative Parcel Map by adopting a Notice of Decision. All conditions of the tentative map have been met by the subdivider, Sierra Holdings, LLC. The Parcel Map requires approval by the City Council.

City Council  
Parcel Map (P96-078)  
June 13, 1997

**COMMITTEE/COMMISSION ACTION:**

None.

**BACKGROUND:**

On February 13, 1997, the Planning Commission approved a Tentative Parcel Map by adopting a Notice of Decision.

Pursuant to Sacramento City Code, Chapter 40.08.813, and Government Code Section 66458, the City Council may, by resolution, approve parcel maps. The map presented conforms to all the requirements of the Government Code and Title 40 of the City Code, applicable at the time of conditional approval of the Tentative Map. The Parcel Map is consistent with the South Natomas Community Plan. All conditions in the staff subdivision report have been met and the Parcel Map is presented for approval.

**FINANCIAL CONSIDERATIONS:**

All subdivision costs are being paid by the subdivider, Sierra Holdings, LLC.

**ENVIRONMENTAL CONSIDERATIONS:**

On February 13, 1997, the Planning Commission ratified the Negative Declaration and approved the mitigation monitoring plan for this project.

**POLICY CONSIDERATIONS:**

Pursuant to Sacramento City Code, Chapter 40.08.813, and Government Code Section 66458, the City Council may, by resolution, approve parcel maps. The map presented conforms to all the requirements of the Government Code and Title 40 of the City Code, applicable at the time of conditional approval of the Tentative Map.

City Council  
Parcel Map (P96-078)  
June 13, 1997

**MBE/WBE:**

None, since no goods or services are being procured with this action.

Respectfully submitted,



Gary Alm  
Supervising Engineer

RECOMMENDATION APPROVED:

APPROVED:

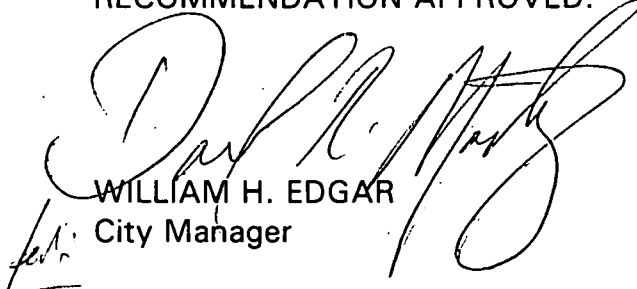

WILLIAM H. EDGAR  
City Manager



Michael Kashiwagi  
Director of Public Works

GA:AA:dt  
ES1-12.B  
06.1397.1

Attachment

**APPROVED**  
BY THE CITY COUNCIL

**JUL 29 1997**

OFFICE OF THE  
CITY CLERK

# RESOLUTION NO. 97-434

ADOPTED BY THE SACRAMENTO CITY COUNCIL

ON DATE OF \_\_\_\_\_

## APPROVING PARCEL MAP ENTITLED "ALL OF PARCEL B AS SHOWN ON 115 PM 25" (P96-078)

**WHEREAS, THE COUNCIL OF THE CITY OF SACRAMENTO FINDS AND DETERMINES AS FOLLOWS:**

- A. The Parcel Map entitled "All of Parcel 3 as Shown on 115 PM 25", located at the southwest corner of Truxel Road and Millcreek Drive, with provisions for its design and improvement, is consistent with the South Natomas Community Plan.
- B. The Parcel Map is in substantial compliance with the previously approved tentative parcel map.

**NOW, THEREFORE, BE IT RESOLVED BY THE COUNCIL OF THE CITY OF SACRAMENTO AS FOLLOWS:**

- 1. The Parcel Map is hereby approved.
- 2. All offers of dedication shown on said map are hereby accepted.

\_\_\_\_\_  
MAYOR

ATTEST:

\_\_\_\_\_  
CITY CLERK

ES1-12.B  
06.1397.1

**FOR CITY CLERK USE ONLY**

RESOLUTION NO.: \_\_\_\_\_

DATE ADOPTED: \_\_\_\_\_

# 148 Child Pre-school/Daycare Facility

Merryhill Country School - South Natomas Campus

City of Sacramento, California

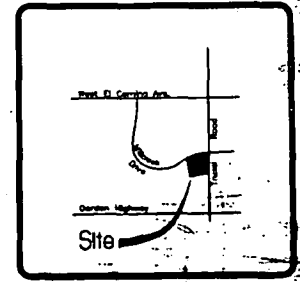

LOCATION MAP

**OWNER:**  
 HOODY GREGG REAL ESTATE DEVELOPMENT CORP.  
 7100 COLLEGE TOWN DRIVE, SUITE 210  
 SACRAMENTO, CA 95816

**DEVELOPER:**  
 HOPE EDUCATION FINANCIAL  
 1400 NORTH PROVIDENCE RD., STE. 3055  
 MESA, CA 90293

**APPLICANT:**  
 TAYLOR & HOOKER  
 1423 ONEY PARK DRIVE, STE. 300  
 SACRAMENTO, CA 95815  
 PH. (916) 937-5345

**ENGINEER:**  
 KENT BAKER & ASSOCIATES  
 7996 CALIFORNIA AVENUE, SUITE 'C'  
 FAIR OAKS, CALIFORNIA 95628  
 PH. (916) 967-7053

**ASSESSOR'S PARCEL NUMBER:**  
 274-0410-015

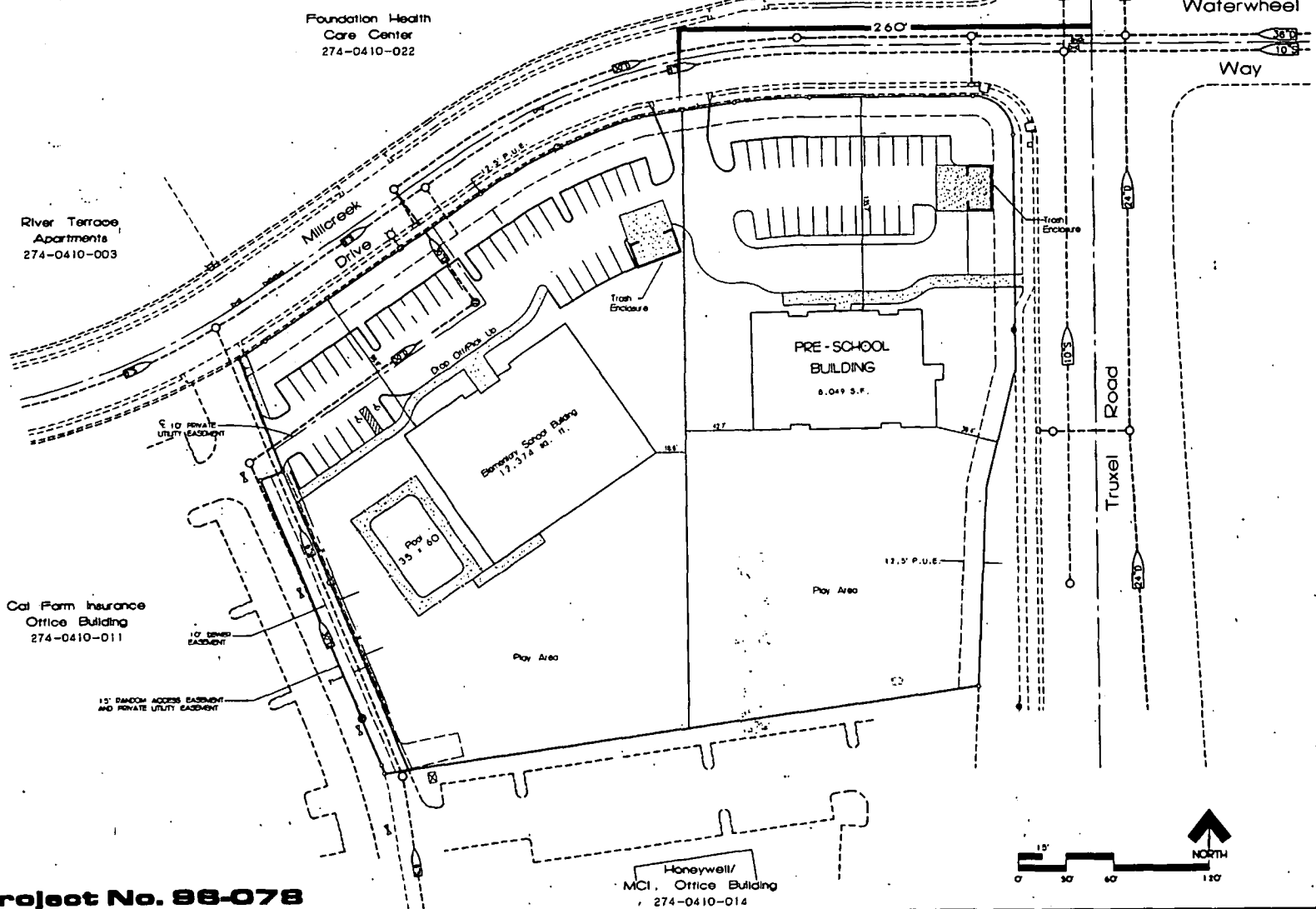

18 February 1997  
 16 January 1997

**KB** ENGINEERING SURVEYING PLANNING  
**KENT BAKER & ASSOCIATES**  
 7996 California Ave., Suite 'C'  
 Fair Oaks, California 95628 (916) 967-7053

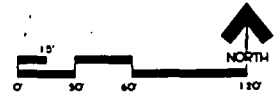

**Project No. 88-078**

"EXHIBIT A"

88020LP

C:\1998\work\88020\plan\88020\plan\88020.dwg 2-15-97 2:33:49 pm PST