

CITY OF SACRAMENTO

1231 I Street, Sacramento, CA 95814

Permit No: 9902267

Insp Area: 4

Site Address: 3711 FAR NIENTE WY SAC

Parcel No: PARUNKN000

GATEWAY WEST LOT 156

Sub-Type: NSFR

Housing (Y/N): N

CONTRACTOR

BEAZER HOMES
3009 DOUGLAS BL #150
ROSEVILLE CA

OWNER

95661

ARCHITECT

BLOODGOOD SHARP BUSTER
2356 GOLD MEADOW WY #201
GOLD RIVER CA

95670

Nature of Work: NEW HOME, MP1659, 8 ROOMS

CONSTRUCTION LENDING AGENCY : I hereby affirm under penalty of perjury that there is a construction lending agency for the performance of the work for which this permit is issued (Sec. 3097, Civ. C).

Lender's Name _____ Lender's Address _____

LICENSED CONTRACTORS DECLARATION: I hereby affirm under penalty of perjury that I am licensed under provisions of Chapter 9 (commencing with section 7000) of Division 3 of the Business and Professions Code and my license is in full force and effect.

License Class 1 License Number 72492 Date 7/17/99 Contractor Signature N. Collins

OWNER-BUILDER DECLARATION: I hereby affirm under penalty of perjury that I am exempt from the contractors License Law for the following reason (Sec. 7031.5, Business and Professions Code; any city or county which requires a permit to construct, alter, improve, demolish, or repair any structure, prior to its issuance, also requires the applicant for such permit to file a signed statement that he or she is licensed pursuant to the provisions of the Contractors License Law (Chapter 9 (commencing with Section 7000) of Division 8 of the Business and Professions Code) or that he or she is exempt therefrom and the basis for the alleged exemption. Any violation of Section 7031.5 by any applicant for a permit subjects the applicant to a civil penalty of not more than five hundred dollars (\$500.00);

____ I, as a owner of the property, or my employees with wages as their sole compensation, will do the work, and the structure is not intended or offered for sale (Sec. 7044, Business and Professional Code: The Contractors License Law does not apply to an owner of property who builds or improves thereon, and who does such work himself or herself or through his/her own employees, provided that such improvements are not intended or offered for sale. If, however, the building or improvement is sold within one year of completion, the owner-builder will have the burden of proving that he/she did not build or improve for the purpose of sale.)

____ I, as owner of the property, am exclusively contracting with licensed contractors to construct the project (Sec. 7044, Business and Professions Code: The Contractors License Law does not apply to an owner of property who builds or improves thereon, and who contracts for such projects with a contractor(s) licensed pursuant to the Contractors License Law).

____ I am exempt under Sec. _____ B & PC for this reason: _____

Date _____ Owner Signature _____

IN ISSUING THIS BUILDING PERMIT, the applicant represents, and the city relies on the representation of the applicant, that the applicant verified all measurements and locations shown on the application or accompanying drawings and that the improvement to be constructed does not violate any law or private agreement relating to permissible or prohibited locations for such improvements. This building permit does not authorize any illegal location of any improvement or the violation of any private agreement relating to location of improvements.

I certify that I have read this application and state that all information is correct. I agree to comply with all city and county ordinances and state laws relating to building construction and hereby authorize representative(s) of this city to enter upon the abovementioned property for inspection purposes.

Date 7/17/99 Applicant/Agent Signature N. Collins

WORKER'S COMPENSATION DECLARATION: I hereby affirm under penalty of perjury one of the following declarations:

____ I have and will maintain a certificate of consent to self-insure for workers' compensation as provided for by Section 3700 of the Labor Code, for the performance of work for which the permit is issued.

____ I have and will maintain workers' compensation insurance, as required by Section 3700 of the Labor Code, for the performance of the work for which this permit is issued. My workers' compensation insurance carrier and policy number are:

Carrier LIBERTY MUTUAL INS CO Policy Number WA2-65D-004147-068 Exp Date 04/01/1999

____ (This section need not be completed if the permit is for \$100 or less) I certify that in the performance of the work for which this permit is issued, I shall not employ any person in any manner so as to become subject to the workers' compensation laws of California and agree that if I should become subject to the workers' compensation provisions of Section 3700 of the Labor Code, I shall forthwith comply with those provisions.

Date _____ Applicant Signature N. Collins

WARNING: FAILURE TO SECURE WORKER'S COMPENSATION COVERAGE IS UNLAWFUL AND SHALL SUBJECT AN EMPLOYER TO CRIMINAL PENALTIES AND CIVIL FINES UP TO ONE HUNDRED THOUSAND DOLLARS (\$100,000) IN ADDITION TO THE COST OF COMPENSATION, DAMAGES AS PROVIDED FOR IN SECTION 3706 OF THE LABOR CODE, INTEREST AND ATTORNEY'S FEE.

THIS PERMIT SHALL EXPIRE BY LIMITATION IF WORK IS NOT COMMENCED WITHIN 180 DAYS.

CERTIFICATION OF INSULATION

PART I GENERAL

LOT # **156**

- P.O. BOX 854, WEST SACRAMENTO, CA 95691 LIC. #202028
- 1453 GARDEN HWY., YUBA CITY, CA 95991 LIC. #202026
- P.O. BOX 9651, FRESNO, CA 93793-9651 LIC. #202026
- P.O. BOX 1631, RENO, NV 89505 LIC. #10675
- 3326 A PONDEROSA WAY, LAS VEGAS, NV 89118 LIC. #10675

DATE INSULATION COMPLETED

6-3-99

PART II AREAS INSULATED

WALLS	CEILINGS	FLOORS
(SQUARE FEET)	(SQUARE FEET)	(SQUARE FEET)
MATERIAL FIBERGLASS	MATERIAL FIBERGLASS	MATERIAL FIBERGLASS
FORM BATTS	FORM BATTS & BLOW	FORM BATTS
MANUFACTURER'S PRODUCT I.D.	MANUFACTURER'S PRODUCT I.D.	MANUFACTURER'S PRODUCT I.D.
OCF	OCF	OCF
	BAGS	
R13	3 7/8	R30
	12	
	1 1/2	

WALLS - R VALUE (OTHER THAN WALLS)			
MATERIAL FIBERGLASS	FORM BATTS	R VALUE	MANUFACTURER OCF

AIR INFILTRATION SEALANT	
MATERIAL FOAM	MANUFACTURER W R GRACE

THIS IS TO CERTIFY THAT INSULATION AND/OR SEALANT HAS BEEN INSTALLED IN CONFORMANCE WITH ALL APPLICABLE CODES, MATERIAL STANDARDS AND REGULATIONS.

SIGNATURE - INSULATION CONTRACTOR <i>[Signature]</i>	TITLE MANAGER	DATE 5/25/99
SIGNATURE - GENERAL CONTRACTOR	TITLE	DATE

REMARKS

COUNTY SANITATION DISTRICT NO. 1
 SACRAMENTO REGIONAL COUNTY SANITATION DISTRICT
SEWER IMPACT FEE ^{PM}
 PERMIT AND CALCULATION SHEET ³⁻¹⁸⁻⁹⁹

APPLICATION NO:	BLDG PERMIT NO: CITY
GENERAL INFORMATION	THIS PERMIT GOOD ONLY WHEN VALIDATED BY THE CASHIER
	- DEPT 26 \$2,413.00 - TRF TRAN 385728 03/18/99 - RECEIPT 689772 C#1 \$2,413.00 250513 3-18-99
	THIS PERMIT TO CONNECT EXPIRES ONE YEAR FROM DATE OF ISSUANCE

FEE CALCULATION		BUILDING USE	
INSPECTION		RESIDENTIAL SF <input type="checkbox"/>	MF <input type="checkbox"/>
CSD-1	28	COMMERCIAL USE	UNITS
SRCSD	2385		
CONSTRUCTION			
IN-LIEU			
TOTAL FEE	2413		

APN: **PARUNK000**

DESCRIPTION/SUBDIVISION: **Gateway West Village 1** LOT: **156**

PROPERTY ADDRESS: **3711 Far Niente Way**

OWNER: **Beazer Homes**

MAILING ADDRESS: **3009 Douglas Blvd., Suite #150;**

CITY-STATE-ZIP: **Roseville, Ca. 95661** PHONE: **(916) 773-3888**

ADDITIONAL FEES MAY BE DUE IF CHANGES IN USE INCREASE SEWER IMPACT.

APPLICANT SIGNATURE *[Signature]*

CONSOLIDATED UTILITY BILLING USE ONLY

ACCT _____ INPUT _____ START _____

INSPECTOR'S COPY

NATOMAS UNIFIED SCHOOL DISTRICT

1515 Sports Drive, #1 • Sacramento, CA 95834

Phone 916/641-3300 • Fax 916/928-1629

CERTIFICATION OF COMPLIANCE

SCHOOL DISTRICT DEVELOPMENT FEES

PART I: TO BE COMPLETED BY APPLICANT																					
PROPERTY OWNER'S NAME	Beazer Homes																				
OWNER'S ADDRESS	3009 Nicolaus Blvd #150, Roseville, Ca. 95661																				
PROJECT ADDRESS	3711 Far Niente Way																				
PARCEL NUMBER	Par 100000																				
SUBDIVISION NAME	Gateway West		Lot 156																		
NUMBER OF UNITS	1																				
PRINT APPLICANT'S NAME	NEHAJAH COLLINS	APPLICANT'S SIGNATURE:	N. Collins																		
TITLE OF APPLICANT	Corporation																				
DATE	1/17/99	TELEPHONE NUMBER	773-3888																		
PART II: TO BE COMPLETED BY BUILDING DEPARTMENT																					
PLAN IDENTIFICATION NUMBER	1659																				
BUILDING TYPE (CHECK ONE)	<input checked="" type="checkbox"/> RESIDENTIAL <input type="checkbox"/> APARTMENT/CONDOMINIUM <input type="checkbox"/> COMMERCIAL/INDUSTRIAL																				
SQUARE FEET OF CHARGEABLE BUILDING AREA	1659																				
SIGNATURE																					
TITLE	BT III	DATE	3-16-92																		
PART III: TO BE COMPLETED BY NATOMAS UNIFIED SCHOOL DISTRICT																					
DISTRICT CERTIFICATION NUMBER	99-179																				
FEES COLLECTED	<table style="width: 100%; border-collapse: collapse;"> <tr> <td style="width: 30%;">RESIDENTIAL</td> <td style="width: 15%;">1659</td> <td style="width: 15%;">SQ. FT. X \$</td> <td style="width: 10%;">4.57</td> <td style="width: 10%;">= \$</td> <td style="width: 20%;">7,581.63</td> </tr> <tr> <td>APARTMENT/CONDOMINIUM</td> <td></td> <td>SQ. FT. X \$</td> <td></td> <td>= \$</td> <td></td> </tr> <tr> <td>COMMERCIAL/INDUSTRIAL</td> <td></td> <td>SQ. FT. X \$</td> <td></td> <td>= \$</td> <td></td> </tr> </table>			RESIDENTIAL	1659	SQ. FT. X \$	4.57	= \$	7,581.63	APARTMENT/CONDOMINIUM		SQ. FT. X \$		= \$		COMMERCIAL/INDUSTRIAL		SQ. FT. X \$		= \$	
RESIDENTIAL	1659	SQ. FT. X \$	4.57	= \$	7,581.63																
APARTMENT/CONDOMINIUM		SQ. FT. X \$		= \$																	
COMMERCIAL/INDUSTRIAL		SQ. FT. X \$		= \$																	

This certification covers only the amount of square footage indicated above. Any additions or corrections to the square footage for this project will require an amendment to the Certificate of Compliance.

As the authorized school district official, I hereby certify that the requirements of Government Code Section 65995 have been complied with by the above signed applicant.

AUTHORIZED SCHOOL DISTRICT OFFICIAL:

SIGNATURE: Linda Duffett
 TITLE: FI Dir DATE: 3/19/99

THIS PLAN IS PREPARED TO SHOW THE DIMENSIONAL RELATIONSHIP FROM BUILDING FOUNDATION TO PROPERTY LINE, DESIGN DRAINAGE CONTROL ELEVATIONS, AND DIRECTION OF DRAINAGE FLOW TO CONFORM WITH LOCAL ORDINANCES FOR THE PURPOSE OF BUILDING PERMIT ISSUANCE. INFORMATION SHOWN IS APPROXIMATE EXCEPT FOR THOSE SETBACKS WHICH ARE MINIMUMS REQUIRED BY ORDINANCE. THIS PLOT DOES NOT REFLECT AS BUILT CONDITIONS WHICH WILL LIKELY VARY FROM THIS PLAN.

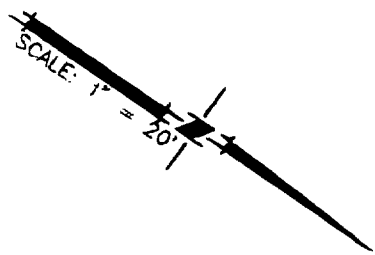

REVISION/APPROVAL		INITIALS
President	✓	
Architect		
Engineer		
Inspector		
Contractor		
City		

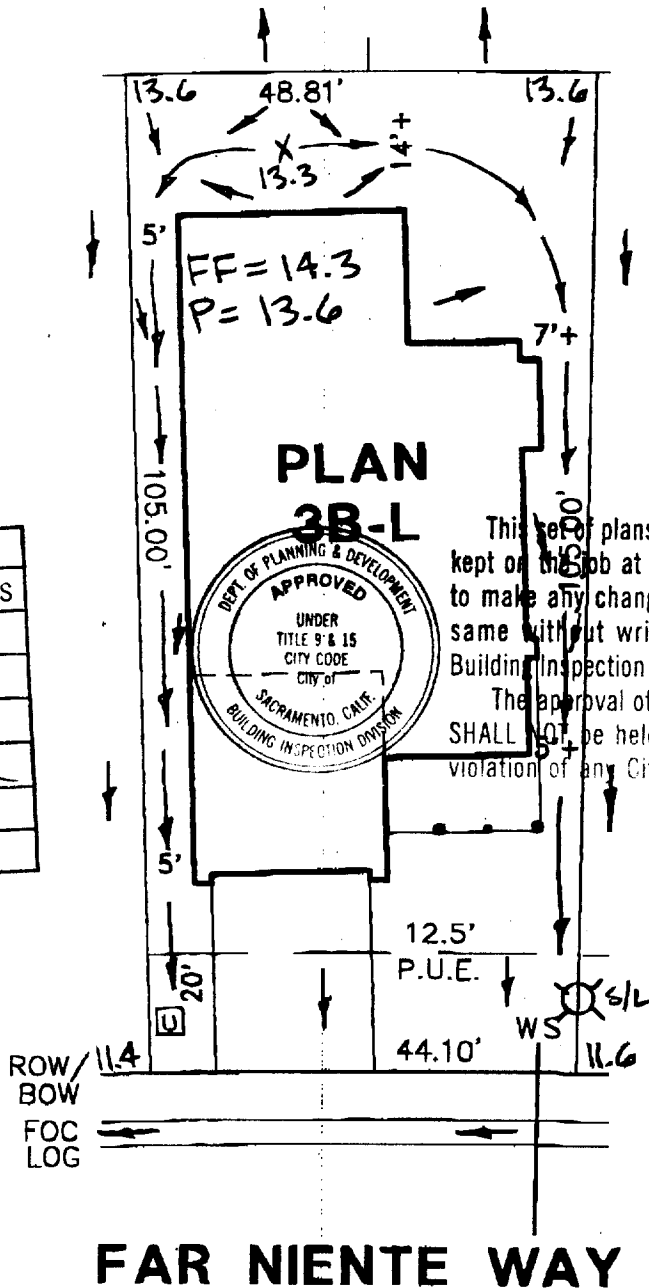

This set of plans and specifications must be kept on the job at all times and it is unlawful to make any changes or alterations from the same without written permission from the Building Inspection Division. The approval of this plan and specifications SHALL NOT be held to permit or violation of any City Ordinance.

☐ = UTILITY SERVICE BOX

PLOT PLAN
LOT 156
GATEWAY WEST-VILLAGE NO. 1
FOR
BEAZER HOMES
SACRAMENTO CALIFORNIA

WOOD-RODGER INC.

DATE: FEB. 1999	DRAWN: SLE	CHECKED: JWR 2-1-99	PROJECT NO: 98BEZ-009
--------------------	---------------	---------------------------	--------------------------

Lot Coverage = 43%